



## SHPK60 - TUBE, PROFILE, FLAT BAR & SECTION BENDING MACHINE

Technical Description	SHPK60	Mechanical Description	Optional Equipment
Shaft, diameter	60 mm	Steel welded construction frame	NC Control
Top Roll, diameter	215 mm	Hydraulic top roll	Kestamid rolls f/Alum. and Stainless steel
Lower Roll, diameter	215 mm	3 rolls are motor driven	
Hydraulic power	16 tons	Vertical and horizontal working position	
Working speed	4 m/min.	Brake motor for precision bending	
Motor power	1,5 kW	Mobile control panel	
Motor rating	380V - 3 phase		
W x L x H (mm)	1400 x 1000 x 1650		
Weight	950 kg		

**Tube Samples**



Ø	t(wall)	Min.Bend Ø
3"	3,2mm	1600mm.
1"	2,6mm	400mm.

**Solidstrip Samples**



Ø	t(wall)	Min.Bend Ø
120	25mm	600mm.
50	10mm	400mm.

### Sample sections Bendable :

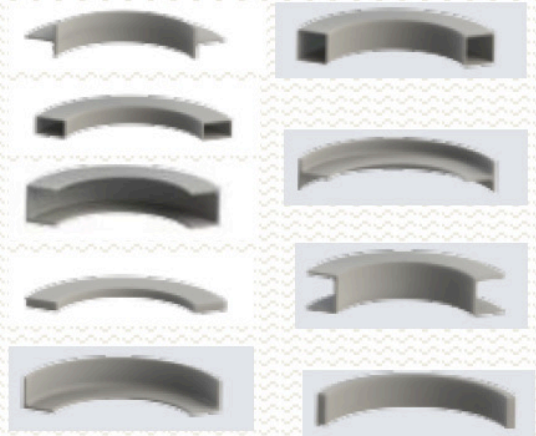

**Solid Round Bar Samples**



Ø	t	Min.Bend Ø
50		800mm.
20		400mm.