

Congratulations on your purchase of the Deluxe Cordless Swivel Sweeper, the quick & agile floor and carpet sweeper that lets you clean dirt and messes faster and easier than ordinary cordless sweepers. The Secret: the Deluxe Swivel Sweeper combines the cleaning power of Quad Brush Technology – powerful rotating cleaning brushes pick up dirt and messes from all four sides of the sweeper head – with a 360° swivel feature to easily maneuver around furniture and other objects. The Deluxe Swivel Sweeper glides effortlessly on four gentle floor sliders while its low-profile design lets you get under couches, beds and other furniture. Its bright LED headlights illuminate the sweeper's cleaning path to make cleaning in dark and hard-to-see areas a cinch. It has an extended pole, is super lightweight and it's bagless too! The reusable dirt tray easily removes for quick disposal of dirt & debris.



**MAKE SURE TO COMPLETELY READ AND UNDERSTAND ALL OF THE FOLLOWING SAFETY INSTRUCTIONS AND WARNINGS IN THIS BOOKLET & ON THE BATTERY CHARGER, PRIOR TO USING SWIVEL SWEEPER.**

## **SAFETY PRECAUTIONS**

- Make sure Swivel Sweeper is securely assembled before use
- Swivel Sweeper is not intended for use by children
- Never use Swivel Sweeper to clean up liquids or wet messes, especially not flammable or combustible liquids
- Swivel Sweeper contains a rechargeable 7.2V Ni-MH (Nickel-Metal Hydride) battery, dispose of battery properly
- Keep fingers, hair, all other body parts and clothing away from rotating cleaning brushes
- Do NOT look directly at the LED lights
- Do NOT use Swivel Sweeper to clean up any burning or lighted materials such as cigarettes, matches and ashes
- Do NOT use on coarse concrete surfaces
- Do NOT use outdoors: patios, decks or rough surfaces
- Swivel Sweeper's mechanical parts are not user-serviceable. Contact a qualified professional for service
- Make sure Swivel Sweeper is turned off and that the battery is removed, before cleaning its rotating brushes of hair, debris etc.
- Do NOT handle or charge battery when hands are wet
- Only use the included charger to charge Swivel Sweeper's battery
- Store your Swivel Sweeper indoors in a dry, safe place

## DELUXE SWIVEL SWEEPER COMPONENTS

1. Handle
2. Heavy Duty Aluminum Pole
3. Rechargeable 7.2V Battery
4. Battery Compartment with LED Headlights
5. On/Off Switch
6. Pole Base
7. Tinted Outer Body Frame
8. Base
9. Outer Body Frame Lock Clips
10. Dirt Tray Lock Clips
11. Dirt Tray
12. Rotating Cleaning Brushes
13. Battery Charger
14. Brush Cleaning Tool & Storage Cover

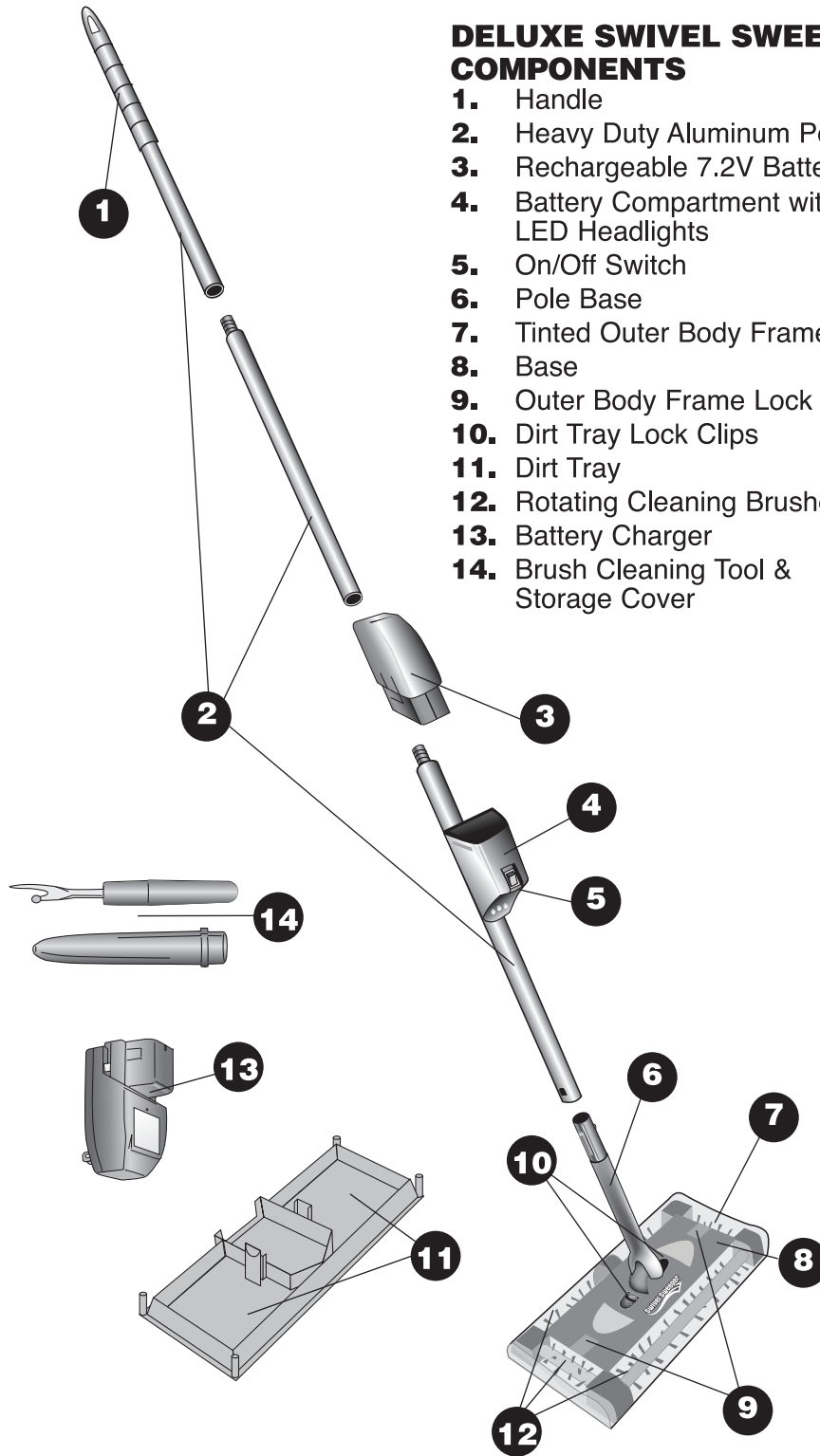

## TO ASSEMBLE SWIVEL SWEEPER:

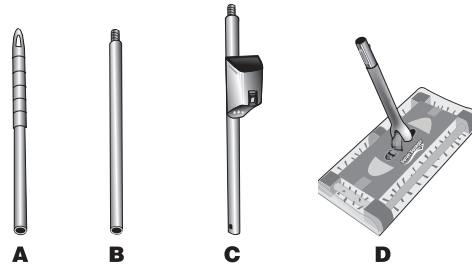

- A. Upper Pole
- B. Middle Pole
- C. Lower Pole
- D. Sweeper Head

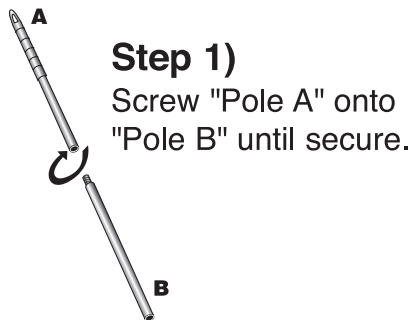

**Step 1)**  
Screw "Pole A" onto  
"Pole B" until secure.

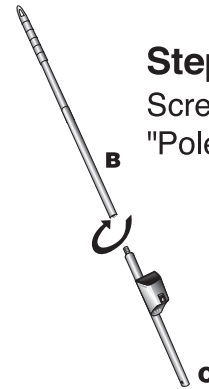

**Step 2)**  
Screw "Pole B" onto  
"Pole C" until secure.

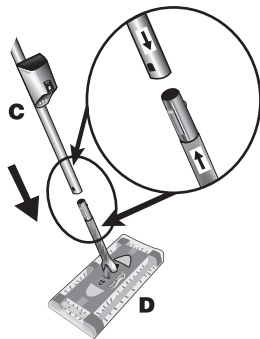

### Step 3)

Align the arrow on "Pole C" with the arrow on "Sweeper Head D." When arrows are aligned, pole will easily slide onto Sweeper Head. Then push firmly together until pole locks into place.

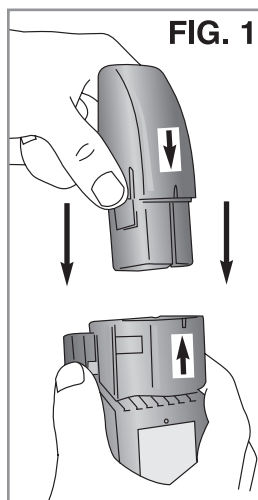

## CHARGING YOUR BATTERY:

**Step 1)** Plug the "Battery Charger" into a standard electrical outlet as below:

UL/CUL: 120V AC 60Hz

TUV/UK: 220-240V AC 50/60Hz

**Step 2)** Align the arrow on the "Rechargeable Battery" with the arrow on the "Battery Charger." Then, insert the "Rechargeable Battery" down into the "Battery Charger." (**SEE FIG. 1**). Red light on the front of the "Battery Charger" should turn on to indicate that the battery is charging.

**IMPORTANT:** For initial battery charge, let battery charge for at least 8 full hours. When recharging, charge time will vary dependent upon the amount of power that is left in the battery after its last use. Recommended recharging time for the battery after completely depleting it is 6-8 hours. Battery may be left in charger for extended periods of time but do NOT exceed 24 consecutive hours. Doing so may lead to shortened overall battery life. It is not necessary to wait until battery power is fully depleted before recharging.

### **USING SWIVEL SWEEPER:**

**Step 1)** Make sure the Swivel Sweeper is turned off. (NOTE: The "On/Off Switch" is located on the front of the "Battery Compartment").

**Step 2)** Make sure the "Dirt Tray" is empty (see following directions on EMPTYING THE DIRT TRAY).

**Step 3)** Insert the "Rechargeable Battery" down into the "Battery Compartment" located on the front of the pole until it locks into place (SEE FIG. 2).

**Step 4)** Turn the Swivel Sweeper on to begin cleaning.

**Step 5)** When you are done cleaning, turn the Swivel Sweeper off, remove the "Dirt Tray" and empty the dirt &

debris into a garbage receptacle. (See the following instructions to empty the "Dirt Tray.") Recharge the battery if necessary.

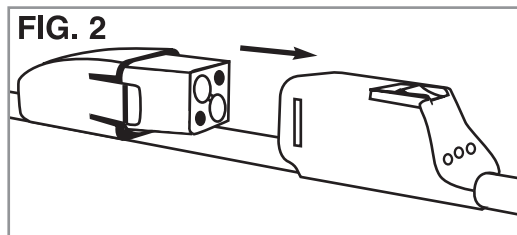

### **IMPORTANT: AUTOMATIC SHUT-OFF FEATURE**

Swivel Sweeper will automatically shut off to protect its moving parts if the brushes become bound by carpets, rugs, hair or other objects.

#### **TO RESET THE SHUT-OFF FEATURE:**

1. Place the "On/Off" switch in the "Off" position.
2. Untangle the sweeper's brushes from the object(s) they are bound by.

**Sweeper will be ready to operate within 10 minutes.**

### **EMPTYING THE DIRT TRAY:**

**Step 1)** Make sure the Swivel Sweeper is turned off.

**Step 2)** With the Swivel Sweeper "Base" sitting on the floor or other flat surface such as a countertop, squeeze and hold the "Dirt Tray Lock Clips" with one hand and lift the Swivel Sweeper up by its aluminum pole with the other hand, to release the "Dirt Tray" (SEE FIG. 3).

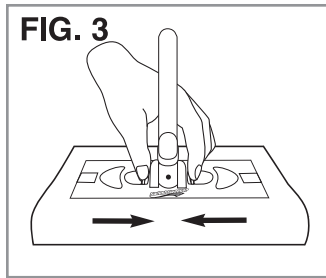

**Step 3)** Empty the dirt and debris into a garbage receptacle.

**Step 4)** Then, place the "Dirt Tray" back on the floor or other flat surface. Lift up and align the "Base" of the Swivel Sweeper over the "Dirt Tray." Properly aligned, the Swivel Sweeper logo on the front of the "Base" of the unit will face in the same direction as the Peak/Front of the dirt tray. Set the "Base" down to connect (**SEE FIG. 4**).

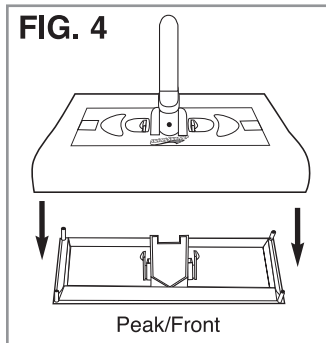

**IMPORTANT:** If "Dirt Tray" does not securely connect back up into the "Base," check to make sure that no small metal debris (e.g. staples, paper clips etc.) has magnetized to the Swivel Sweeper's motor located on the underside of the "Base."

## IMPORTANT MAINTENANCE & CARE:

As with any rotating brush cleaning device, Swivel Sweeper's four cleaning brushes will accumulate fine debris such as hair, thread and other particles. To maintain optimal sweeper performance, clean the sweeper's rotating brushes of hair and debris and dirt as necessary following the directions below.

**Step 1)** Make sure the Swivel Sweeper is turned OFF and remove the battery to ensure unit does not accidentally turn on.

**Step 2)** Unlock the "Tinted Outer Body Frame" by sliding the two "Outer Body Frame Lock Clips" inward towards the pole (**SEE FIG. 5**).

**Step 3)** Next, lift the "Tinted Outer Body Frame" up and over the aluminum pole to remove it. The four rotating brushes are now completely exposed (**SEE FIG. 6**).

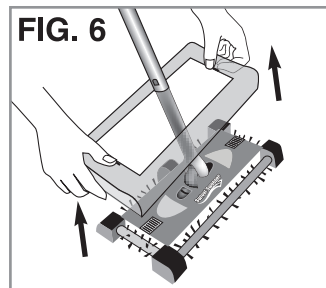
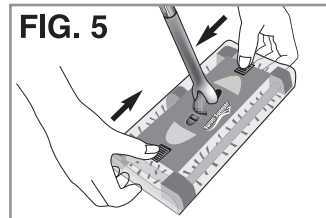

**Caution: Brush Cleaning Tool has sharp tip and ripping blade. Avoid contact with tip and ripping blade.**

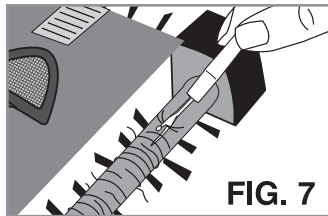

**Step 4)** Use the "Brush Cleaning Tool" to cut and remove tangled debris. Simply guide the blade along the shaft of the "Rotating Cleaning Brushes" (**SEE FIG. 7**). Dispose of debris in garbage.

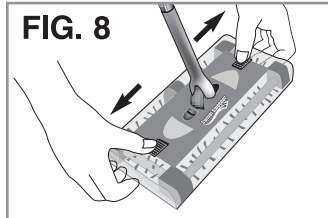

**Step 5)** Replace the "Tinted Outer Body Frame" and lock by sliding the "Outer Body Frame Lock Clips" outward and away from the pole. (**SEE FIG. 8**)

Periodically wipe down your Swivel Sweeper with a dry or damp lint-free cloth. Do not use water, liquid cleansers or abrasive materials to clean Swivel Sweeper.

## **BASIC TROUBLESHOOTING:**

### **1. Swivel Sweeper is sluggish or won't start:**

Make sure the battery is fully charged and securely inserted into the "Battery Compartment" and that the pole section with the "Battery Compartment" is securely connected to the "Pole Base." Check the "Rotating Cleaning Brushes" to make sure they are not entangled with hair, debris, etc.

### **2. Battery not charging:**

Make sure the upper and middle section of the "Battery Charger" is securely attached and that the "Rechargeable Battery" is fully inserted into the "Battery Charger." Also, check to make sure that the red indicator light on the "Battery Charger" comes on when charging.

### **3. Brushes become bound and sweeper shuts off:**

See "Automatic Shut-Off Feature" instructions on pg. 5.

### **4. Swivel Sweeper operating but not picking up mess:**

The "Dirt Tray" may be full. Empty out if necessary (see Emptying The Dirt Tray Instructions on pg. 5). Also, some debris may be lodged in carpeting (such as staples) or be too large/heavy for the sweeper to pick up. Make sure the "Dirt Tray" is attached.

### **5. Dirt & Debris escaping from sweeper during cleaning:**

Make sure the "Dirt Tray" is empty and securely connected to the sweeper. Also, check to see that the "Rotating Cleaning Brushes" are not entangled with debris such as hair, paper, etc. Use the "Brush Cleaning Tool" to clean off, if necessary.

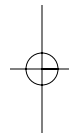
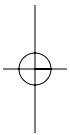

Distributed by:

Thane Direct Canada, Toronto, Canada  
[www.thane.ca](http://www.thane.ca)

Thane Direct UK Ltd., Admail ADM3996, London, W1T 1ZU  
[www.thanedirect.co.uk](http://www.thanedirect.co.uk)

