



Support & Feedback

Thank you for purchasing and for joining us on a journey to protect our bodies and the environment.

If you need any help with any of our products, simply contact us at one of the methods below and we'll be happy to help :)

Email: support@earthswater.com



Under Sink Reverse Osmosis Water Filter with Tap

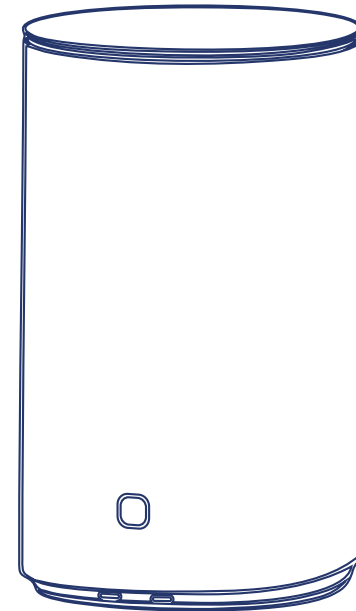

Make Your Water Earthly.

EARTHSWATER.COM

Important - Read Before Use

In order to ensure safety of use and avoid injuries & property losses to you and others, please be sure to observe the following safety precautions. Misuse without observing the safety warnings may lead to accidents.

Always ensure the machine is turned off at the power switch and the inlet water valve is turned when not in use for long periods of time.

1. For IEC: This appliance is not intended for use by persons (including children) with reduced physical, sensory or mental capabilities, or lack of experience and knowledge, unless they have been given supervision or instruction concerning use of the appliance by a person responsible for their safety. Children should be supervised to ensure that they do not play with the appliance by a person responsible for their safety. Children should be supervised to ensure that they do not play with the appliance. If the supply cord is damaged, it must be replaced by the manufacturer, its service agent or similarly qualified persons in order to avoid a hazard.



2. If the supply cord is damaged, it must be replaced by the manufacturer or professional personnel from the maintenance department, so as to avoid danger. Avoid squeezing, folding, knotting or damaging the power line.

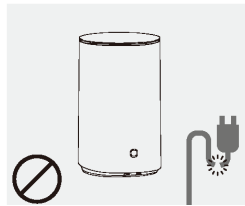

3. Avoid storing the product in places with strong sunlight, which may easily cause aging of product components, and avoid storing or exposing the product in an environment below 0 C

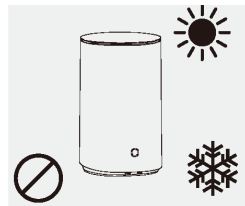

4. The product must be installed or removed by professional personnel. The removal of parts on the product without authorisation is easy to damage the product or cause electric shock. The moving and handling without authorisation may easily caused improper operation and damage the purifier.

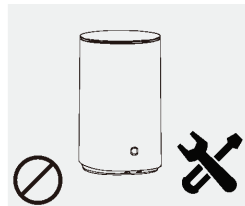

Replacement of Filter Cartridges

1. The filter has indicators that advise of the filter status, there are three colors of blue, orange and red. When the service life of filter element is normal, the blue indicator is on, when the service life remains at 20%, the orange light turns on, and when the service life expires, the red light turns on.

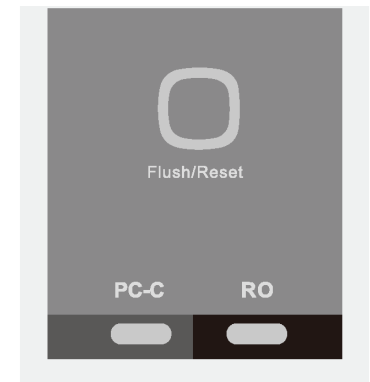

2. Take out the upper cover and pull out the filter element handle.

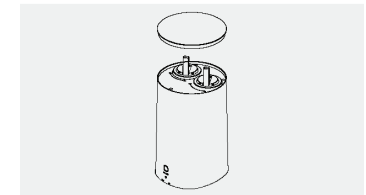

3. Press and hold the end of the filter handle to push it toward the unlocking direction. Do not pull the cartridge up, simply turn to the side until it releases and slides up by itself.

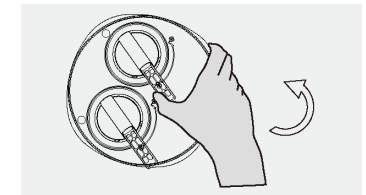

4. Remove the old filter and place the new filter into the appropriate filter cartridge position. Do this by pushing the filter down and twisting it into the locked position.

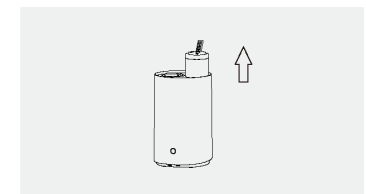

10. Wet or dusty areas may cause circuit damage.



11. Do not place any heavy article on the product.

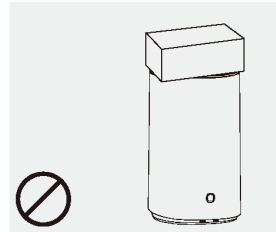

12. Please cut off the power and close the three- way ball valve in case of water failure or pipe maintenance. When restoring water supply, open other taps to drain the silt before opening the three- way ball valve, otherwise a large amount of silt may block the filter element.

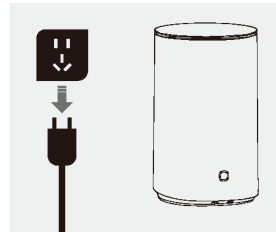

13. Please do not connect the booster transformer to the power plug.

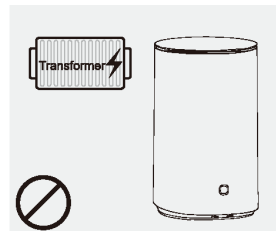

14. When cutting off the power, do not pull out the power line directly so as to avoid breakage.

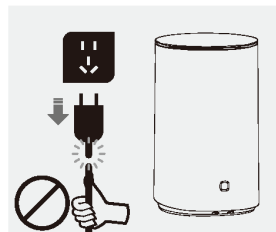

Operation Instructions

Start-up

1. Firstly, open the inlet ball water valve and connect the tap water. Then power up the product.

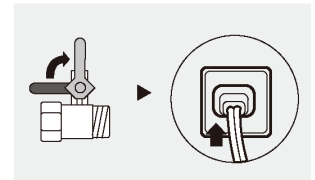

2. When the buzzer sends a sound of “ding”, the blue light will display for 3s and the three cartridge status indicators lights will turn on (blue, orange and red). After 3s, the display restores to a normal state and is ready to use.

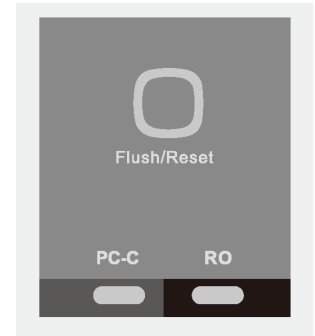

3. Before using the product, press the flush button to flush the filter cartridges for 3-5 minutes before normal use.

Shut down the instrument

Firstly close the inlet ball valve and pull out the power plug.

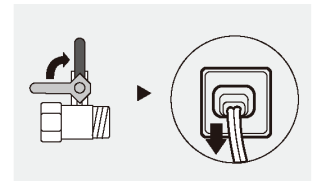

Water dispensing

After the tap is turned on, you may see a small amount of gray water flow out which is very normal.



Note: This happens when the machine starts and flushes the new filter cartridges.

Maintenance Steps

1. Check whether all functions of the machine are normal and power off the machine and turn off the water source.

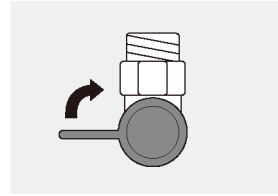

2. Check whether the overall appearance of the machine is deformed.

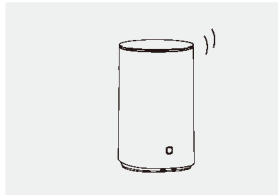

3. Check the connection of key parts and jack the PE pipes at the connection in turn to ensure that the PE pipes are inserted in place.

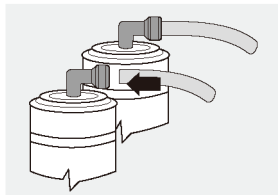

4. For replacement of filter cartridge, check whether the filter element is required to be replaced according to the recommended service life and filter status lights.

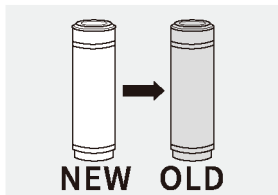

5. Ensure the water source is working correctly so that the product can produce water normally and check whether the connection has any water leakage tissues.

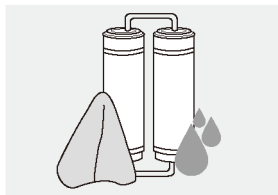

5. If the inflow water does not meet the municipal tap water standard (including large silt content and or organic substances) you may require a pretreatment device.

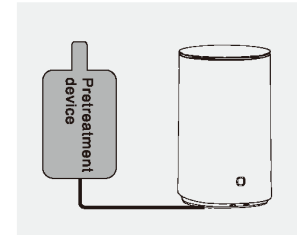

6. The best working pressure of this product is 0.1-0.4Mpa. If this water pressure is higher or lower than this value, please install pressure boosting or reducing device accordingly.

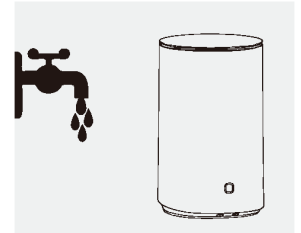

7. In case of any failure, please cut off the water source immediately and contact your local professional personnel.

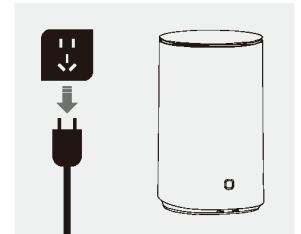

8. When the ambient temperature is too low, the flow rate will decrease, which is an inherent characteristic of RO membrane.

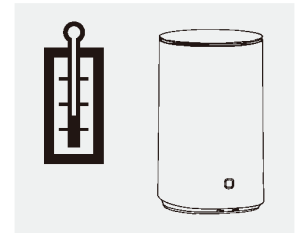

9. Strong magnetic appliances nearby may cause fire, product damage or circuit failure. Avoid installation near these devices.

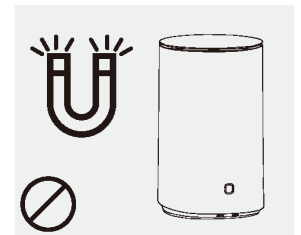

5. Always ensure that your mains pipeline that is connecting to the water purifier is in reasonable condition without defects or rust.

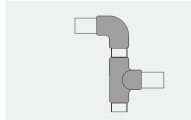

6. Ensure that the insertion depth of PE pipe reaches 15-17mm, measure the PE pipe before installation, mark the PE pipe and the insert it into the machine. The insertion depth should reach the position of the black mark.

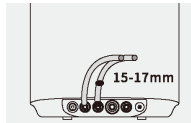

7. Be sure to use the accessories provided by the manufacturer or reputable supplier.



8. Do not miss the tightness inspection of the three-way ball water valve to confirm that there is no water seepage or leakage.

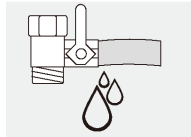

9. Do not put the product sideways, horizontally or upside down.

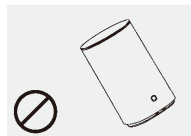

10. Do not use the filter cartridge when not flushed. (The filter element should be flushed for 1-3 min at replacement.)



11. Ensure all connector pin are properly secured and tightened.

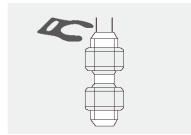

12. Do not fold or bend the pipelines sharply as this will affect water flow.



13. Do not insert the waste pipe into the user's sewer without authorisation and be sure to fix the drainage pipe with ribbon.

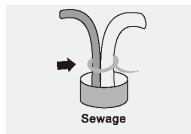

15. Please keep the power plug clean and do not pull out the plug with wet hands.

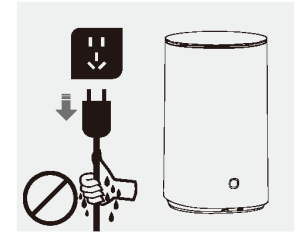

16. Please do not place flammable and volatile substances near this purifier.

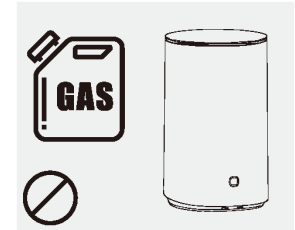

17. Please keep the product away from heat source or open fire.

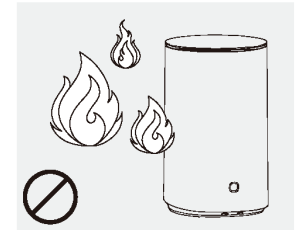

18. Clean and replace filter cartridges regularly.

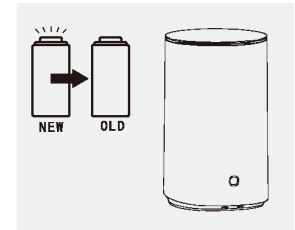

19. Be sure to use the accessories provided by the company.

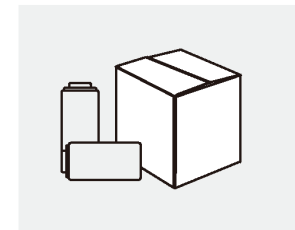

20. It is normal for the product to generate slight vibration and noise when producing water.

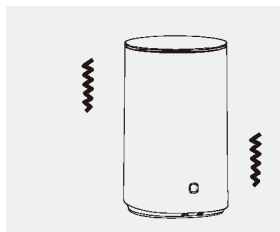

21. Please install the product as close to the floor drains possible when possible.

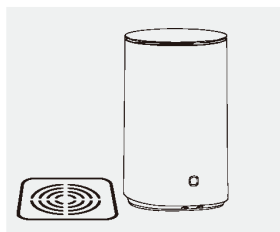

22. If not using the product for a long time, please cut off the power and close the three-way ball water valve. When using the product again, drain water for 3-5 minutes before normal use.



23. This product is a full automatic water production system. It is normal for the product to automatically start water production or cleaning during use or when it is not used for a long time.

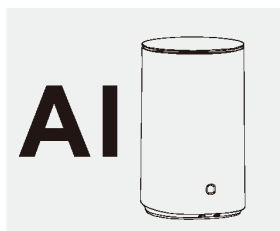

24. A 220V power socket is required within 1.5m of this product. Please ensure that the power socket and the adapter are located indoors to prevent the influence of humid weather on the product.

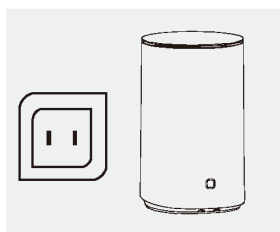

Installation of Complete Machine

1. Take the product out of the packing box and place it under the cabinet.

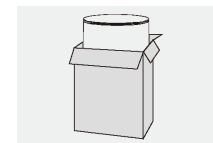

2. Take out the inlet ball water valve and install it on the angle valve.

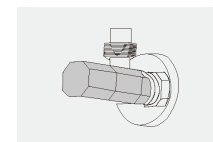

3. Connect the pipeline and install the taps according to the schematic diagram for installation of water way. (As shown in the right figure. See P9 for the large picture)

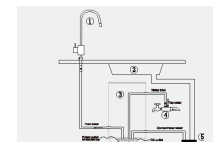

4. The concentrated water can be directly discharged to the sewer or recycled.

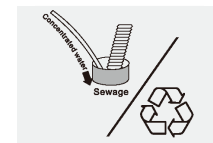

Precautions for Installation

1. Pay attention to confirming the water source and the use range of product: Municipal tap water works best. Tank water or well water may require a pre-filter.



2. Pay attention to confirming the water pressure at the inlet end. The water pressure range is 0.1-0.4Mpa. Pressure reducing valve must be installed if the water pressure exceeds the above range.

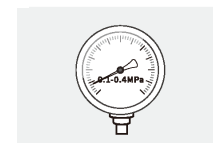

3. Pay attention to confirming the temperature of installation environment. The use temperature of product is 4-38°C.

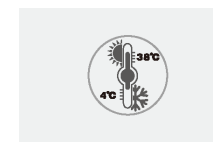

4. Pay attention to the installation position of the product, and choose to install it in the water inlet of cabinets, balconies and other water sources. It is strictly prohibited to install it in the places exposed to direct sunlight or rain.

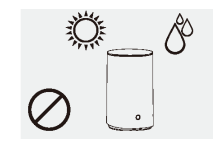

Self-inspection of Abnormalities

The following notes on the inspection of common abnormalities. If simple treatment cannot eliminate them, please do not disassemble and repair the product without authorisation, so as to avoid danger or damage to the water purifier.

1. When the water is purifying the water, the water pump may generate low noise while working, this is absolutely normal.
2. If there is any difficult problem during use, please refer to the following methods for troubleshooting. If the problem cannot be solved, please contact the dealer.

Phenomena	Reason	Solution
No water or less flow	<ol style="list-style-type: none"> 1. The filter replacement is blocked. 2. The tap pressure is lower. 	Please cut off the water source and contact professional personnel.
The filter element indicator flashes	<ol style="list-style-type: none"> 1. The service life of filter cartridge expires. 2. The product has entered the timeout product mode. 	<ol style="list-style-type: none"> 1. If the filter cartridge indicator flashes red, it means that the filter cartridge has expired and needs to be replaced. 2. If the indicator at the reset key flashes red, it means that the product has entered the timeout mode and needs to be powered on again.

Schematic diagram for Installation

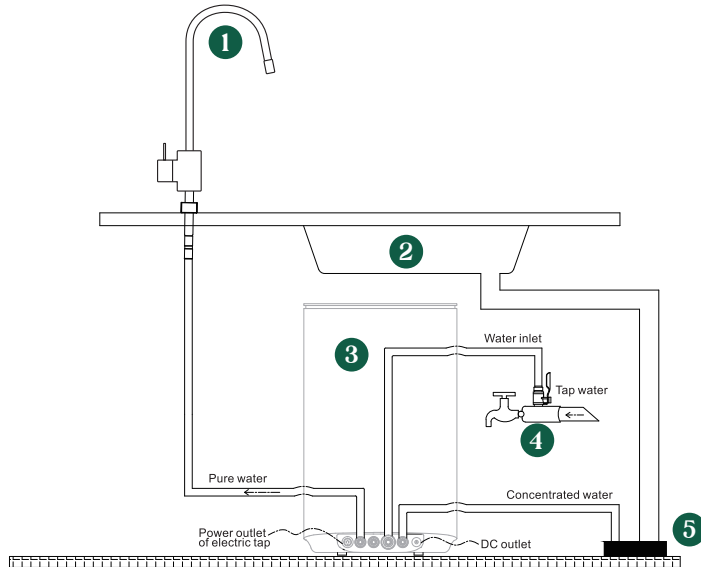

1. Outlet taps 2. Basin 3. Main body 4. Inlet ball valve 5. Sewer

Product Parts

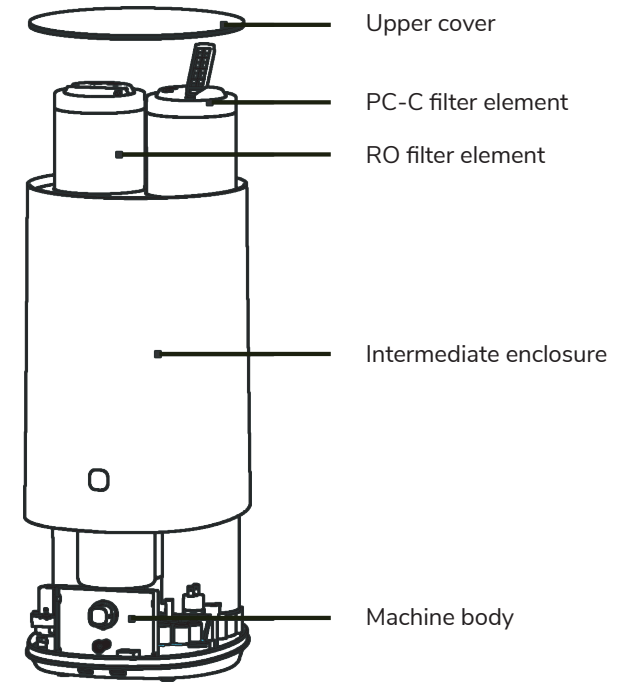

Display Guide

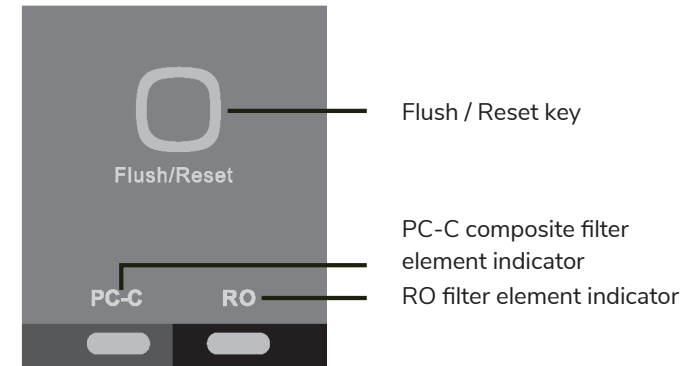

Configuration Filter Cartridge

SN	Abbreviations	Name of filter cartridge	Effect	Life time	Qty
1	PC-C	PP+carbon+carbon composite filter cartridge	Remove sediment, rust and suspended matter, residual chlorine and odor from water and improve the taste	6-12 months	1 pc.
2	RO	Reverse osmosis membrane filter cartridge	Remove bacteria, viruses, organic matters, heavy metals, ions, etc. from water	12-18 months	1 pc.

Special tips:

1. The maintenance period of filter cartridge is not the quality guarantee period, but is an ideal maintenance period for filter cartridge based on raw water meeting the national standard for drinking water and normal household water.
2. The maintenance period of filter cartridge is the expected period. The actual maintenance period varies according to the usage area, water quality, usage amount and season. Only the proper replacement of filter cartridge can ensure the clean drinking water.

Basic Parameters

Water production capacity	400 GPD
Rated total pure water	5000L
Rated voltage	110V-240V~
Rated total power	64W
Purified water flow	>1.0L/min
Working pressure of RO membrane	0.4-0.8MPa
Inlet pressure	0.1-0.4MPa
Applicable water quality	Municipal tap water
Applicable water temperature	5 C-38 C
Environment temperature for using	4 C-40 C
Net weight	7.84kg
Product size	240x395mm

Maintenance

Water purification equipment needs to be maintained in daily use, in order to avoid failure due to improper maintenance. This ensures the integrity of the drinking water remains safe and during the normal operation of product.

1. When cleaning and maintaining the product, do not use highly volatile solvent like soap, detergent, gasoline, ethyl alcohol, etc., or else crack, scratch and discoloration will be caused.
2. Do not clean the purifier by spraying water directly.
3. Check to ensure there is accumulated water around the product and ensure there is no water leakage.
4. Check whether the outlet tap of product has leakage.
5. Check whether the concentrated water pipe is fixed without looseness.
6. Before going away on holidays, ensure the product power and the water inlet switch (three-way ball valve) are closed and turned off.
7. Do not put the product sideways, horizontally or upside down.
8. Do not change the product joints and pipes without authorization.
9. Do not place the product in an environment below 0 C
10. Do not expose the product and the pipelines to direct sunlight.

Flow Chart of Water Treatment

