

# Multi Filter Benchtop Water Filter

## Tap Assembly Instructions

The tap consists of: the tap itself,  
2 x rubber seals and a nut that  
tightens all pieces

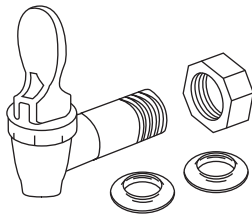
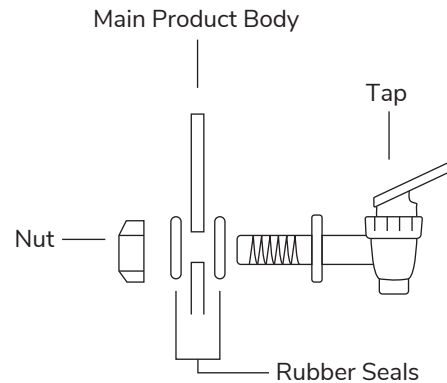

### 1. Separate Parts

Undo the nut and rubber seals from  
the tap and ensure you have the tap,  
2 x rubber seals and a nut  
to fasten the pieces together.

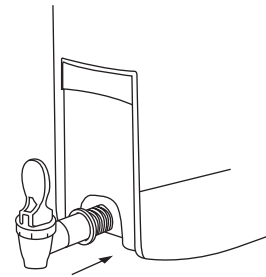

### 2. Insert Tap

Add 1 x rubber seal to the tap thread  
and insert the tap into the product main  
body ensuring the rubber seal is  
on the outside of the product body.

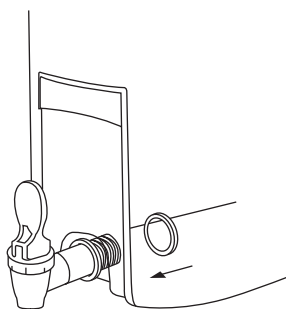

### 3. Ensure Water Seal

Add the second rubber seal to  
the tap from the inside of the main body.  
You should now have a rubber seal  
on each side of the product main body.

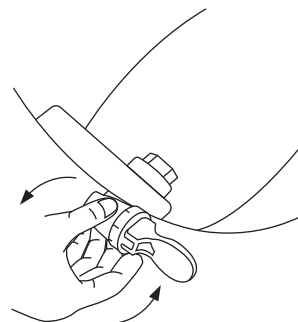

### 3. Tighten Tap

Now add the nut from the inside of the  
main product body and tighten with care  
until a firm grip is achieved and  
the tap does not move.

**Caution: Do not overtighten as this could damage or break the main product body.**