

SP Quick Spool Valve Installation Instructions

1. Take off C-clip on valve arm to allow easy movement of the valve.

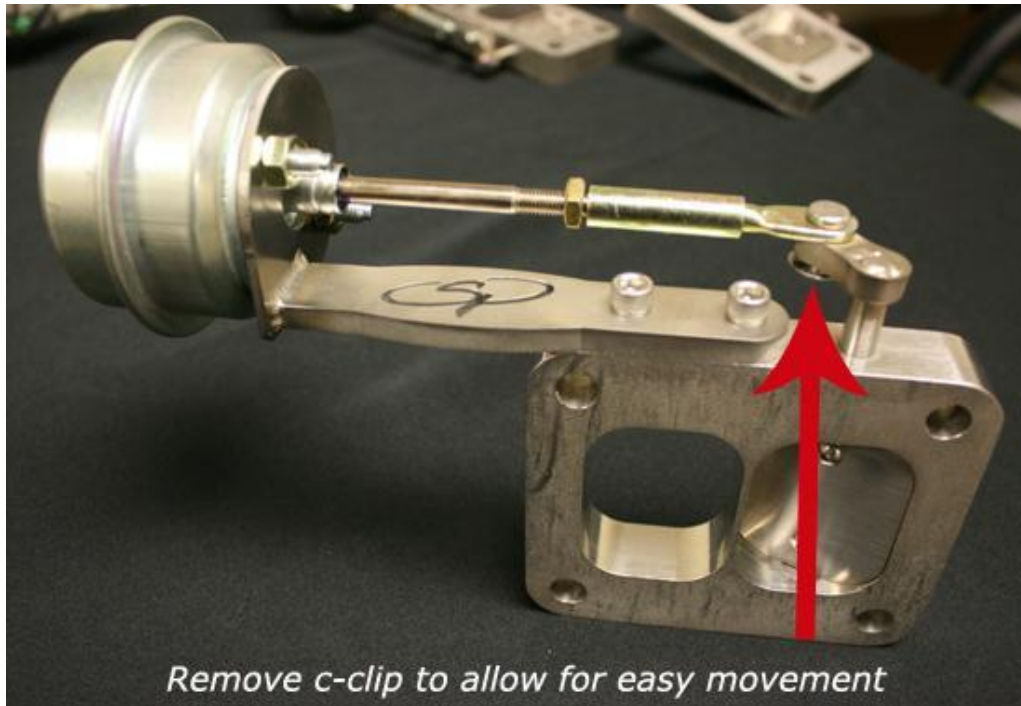

2. Place the SP Valve on the turbo exhaust housing and open the valve fully to ensure proper clearance inside turbine housing as turbine castings will vary. (Some minor grinding of the exhaust housing may be necessary to clear the valve when open)
3. Place the SP Valve on the exhaust manifold to also check for clearance and that the valve does not bind up on anything in the manifold. (Some minor grinding of the exhaust manifold collector may be necessary to clear the valve when open)
4. Once all have been check for clearance you can now install the valve. Place T3, T4, or T6 gaskets on both sides of the valve and bolt down. (may require longer studs for added height)
5. Before reinstalling C-clip, recheck that the valve opens and close fully without any binding or rubbing on the turbine housing, exhaust manifold or gaskets.
6. If there is no binding whatsoever you may now reinstall the C-clip.

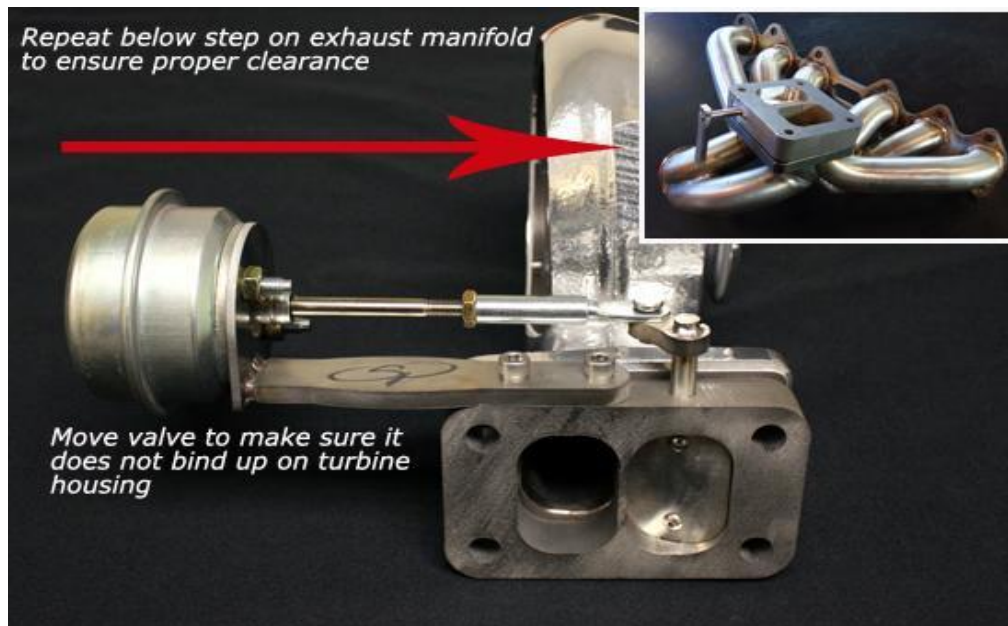

Wiring and Boost Hose Routing

(If using with provided boost valve solenoid and a standalone)

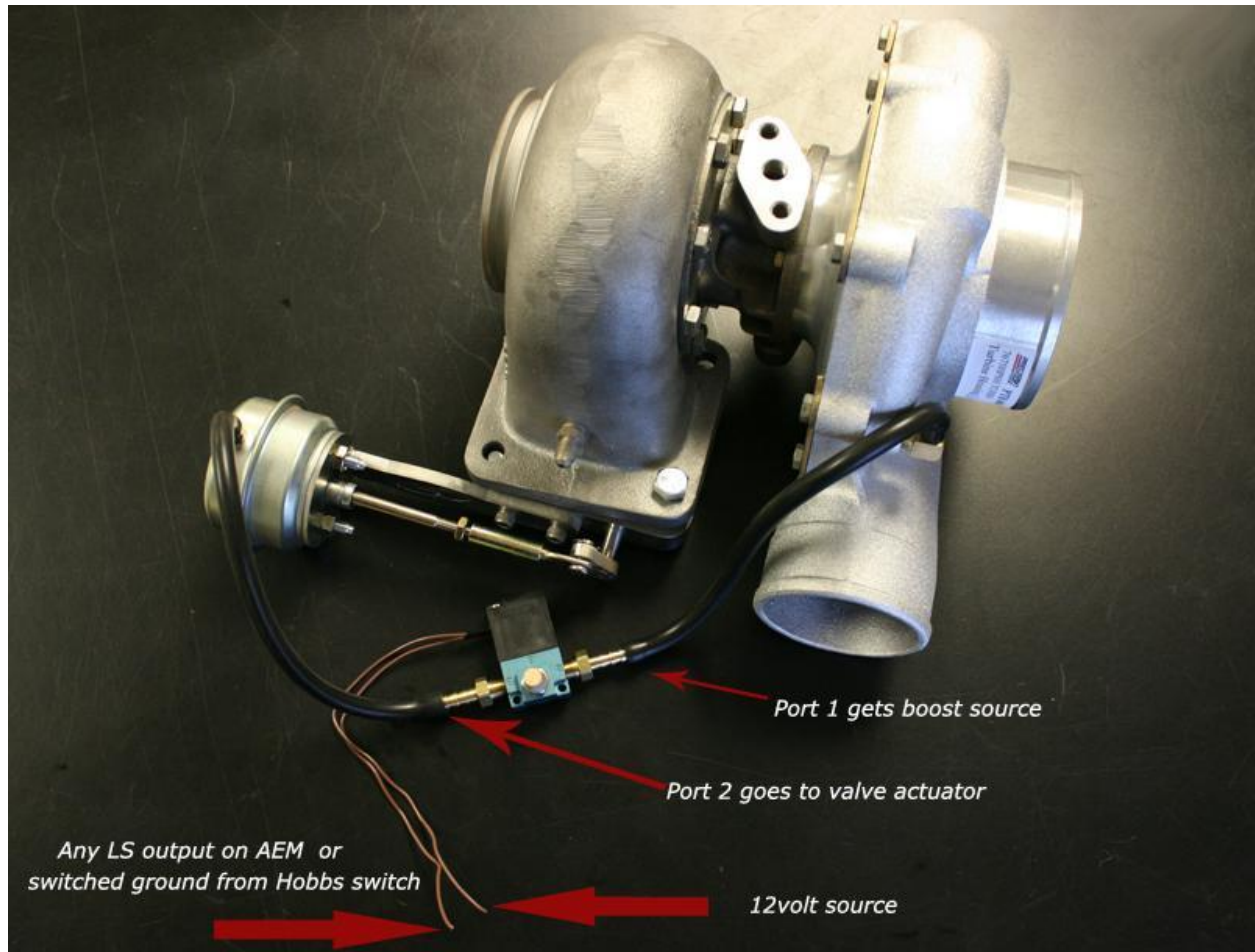

If questions please contact us at

sales@spracingonline.com

630-893-5002

www.spracingonline.com

Thank you and enjoy your new found power!!!!