

ELYSIA

OUTDOOR MODULAR KITCHEN BY **FONTANA**
F O R N I



KAMADO
Instruction Manual



Introduction.....	1
Suggested Tools for Assembly.....	1
Product Dimensions.....	2
Parts List.....	2
Components List.....	3
Instructions.....	4
Adjustment.....	16
Cleaning and Maintenance.....	17

BEFORE YOU START

FONTANA
FORNI

Welcome to your Elysia Outdoor Modular Kitchen

Save these instructions.

- Read these instructions completely and carefully. Do not skip any step. Put all bolts used in a step before tighten them.
- Some parts have sharp edges, care must be taken to avoid injury. Please wear gloves when handling.
- Two or more people should work together to assemble the kitchen modules and FONTANA Appliances.
- During assembly, work on a protected surface to avoid damaging the pieces.

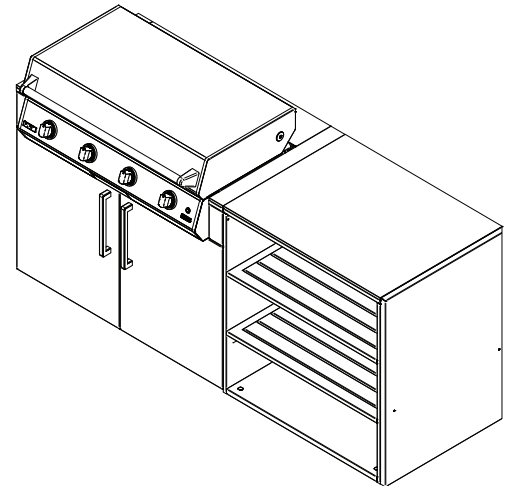

SUGGESTED TOOLS FOR ASSEMBLY

1 - Phillips Head

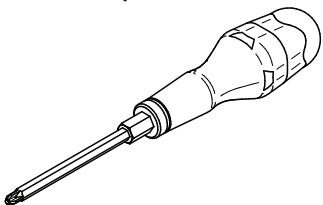

1 - Adjustable wrench
(or 7mm nut driver bit)

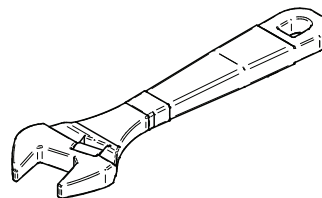

1 - Allen Wrench (CRV-4 Hex Head)

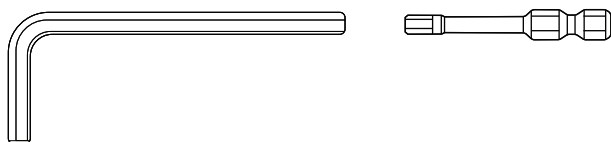

1 - Silicone Adhesive
Suitable for Ceramics

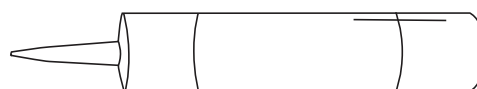

PRODUCT DIMENSIONS

FONTANA
FORNI

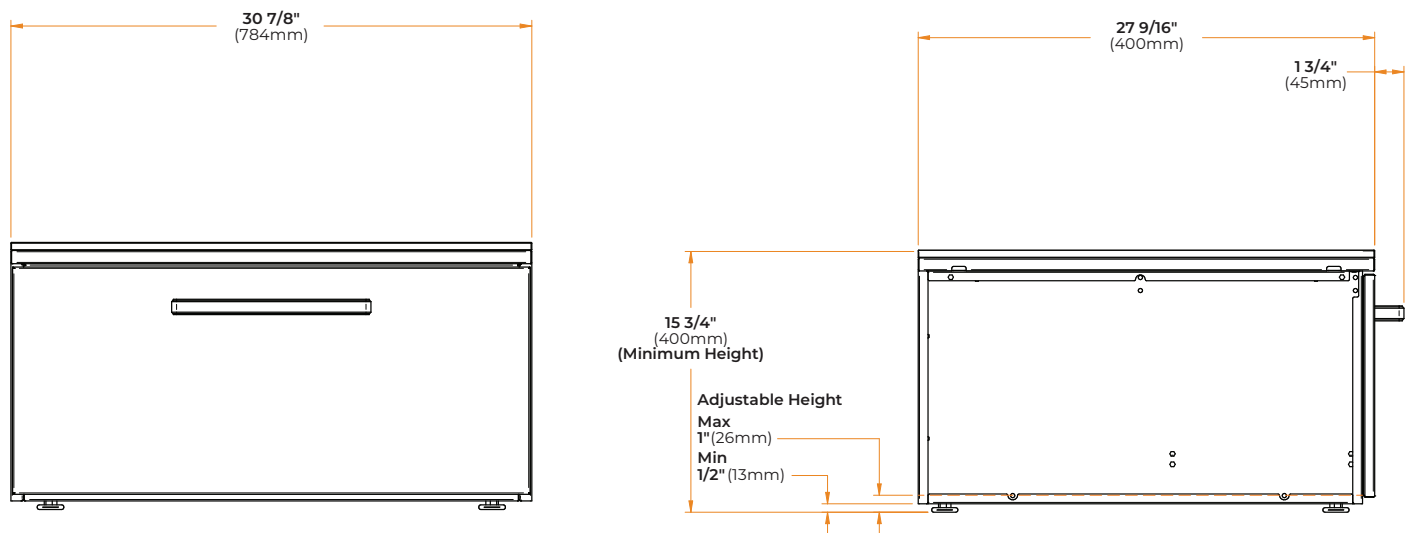

PARTS LIST

#	NAME	QTY
1	BASE	1
2	R-SIDE PANEL	1
3	L-SIDE PANEL	1
4	REAR	1
5	COUNTERTOP	1
6	MID RIB	1
7	FRONT RIB	1
8	STONE	1
9	DRAWER FRONT	1
10	DRAWER BOTTOM	1
11	DRAWER BACK	1

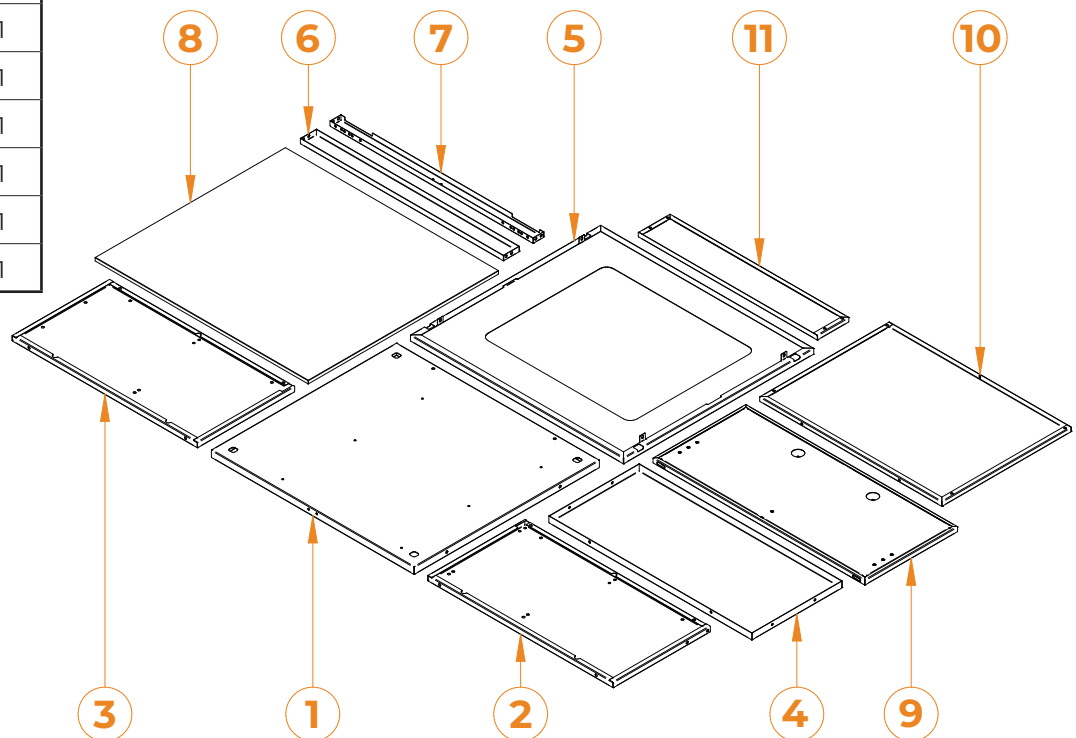

COMPONENTS LIST

#	NAME	QTY
A	L-DRAWER SIDE	1
B	R-DRAWER SIDE	1
C	L-DRAWER SLIDE	1
D	R-DRAWER SLIDE	1
E	L-DRAWER CORNER	1
F	R-DRAWER CORNER	1
G	SIDE-FRONT FIX	2
H	DRAWER HANDLE	1
I	SCREW M4X12	2
J	SCREW M4X10 ROUNDHEAD	11
K	SCREW M5X12	34
L	ADJUSTABLE LEG	4
M	SCREW 4X16 COUNTERSUNK	6

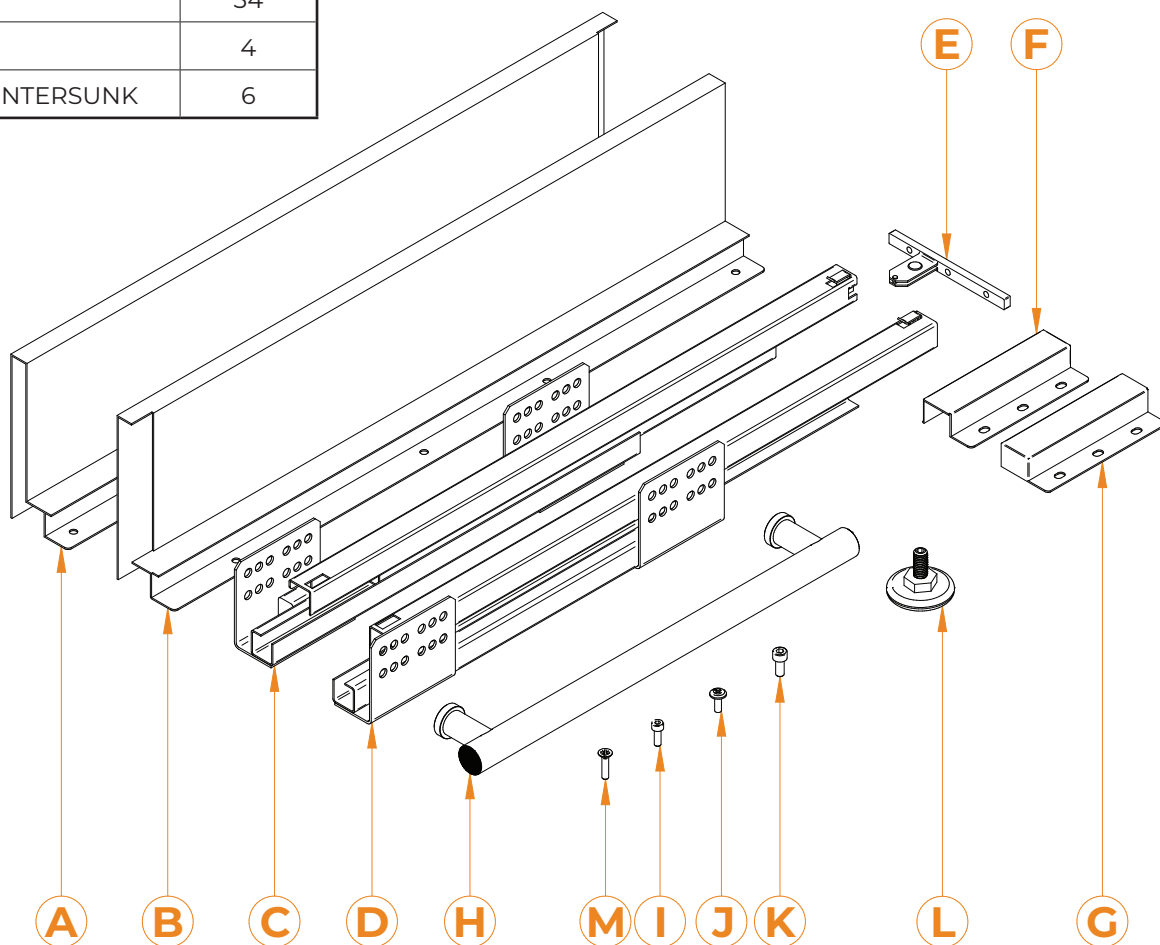

INSTRUCTIONS

FONTANA
FORNI

Step 1 | Insert **Adjustable Legs (L - 4X)** in four corners of the **Base (1)**.

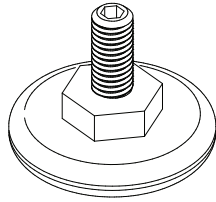

#	COMPONENT	QTY
L	ADJUSTABLE LEG	4

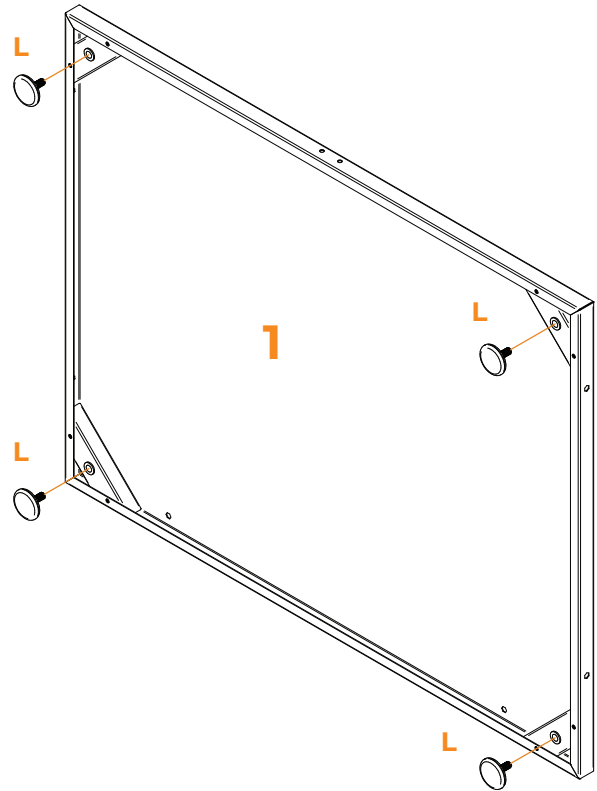

Step 2 | Attach the **Rear (4)** to the Base (1) with **Screw M5x12 (K - 2X)**, secure with an allen wrench (or hex head).

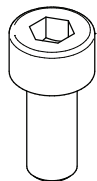

#	COMPONENT	QTY
K	SCREW M5X12	2

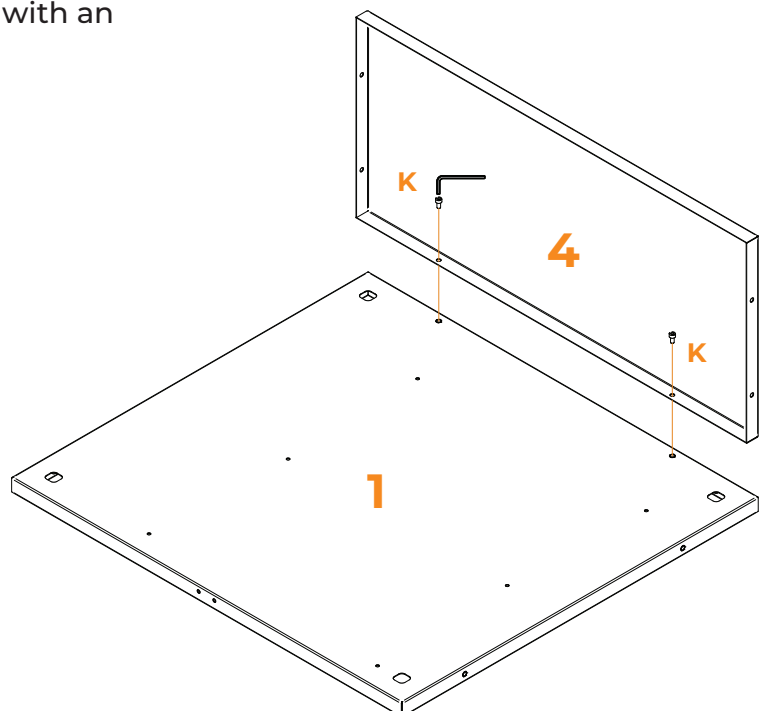

* Example image: STORAGE 90

INSTRUCTIONS

FONTANA
F O R N I

Step 3 | Attach **L-Side Panel (3)** to **Base (1)** and **Rear (4)** with **Screw M5x12 (K - 4X)**, secure with an allen wrench (or hex head).

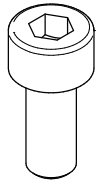

#	COMPONENT	QTY
K	SCREW M5X12	4

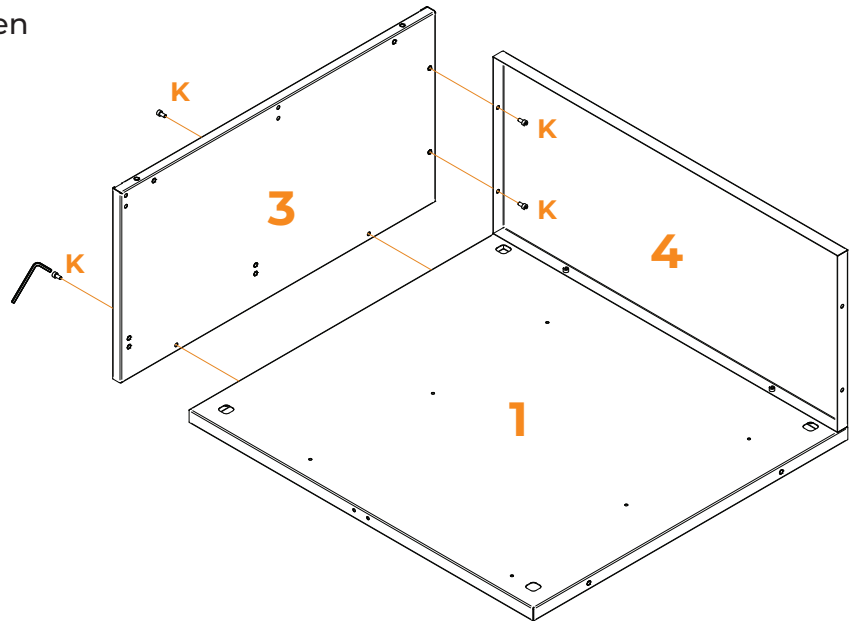

Step 4 | Attach **R-Side Panel (2)** to **Base (1)** and **Rear (5)** with **Screw M5x12 (K - 4X)**, secure with an allen wrench (or hex head).

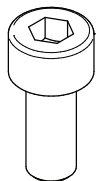

#	COMPONENT	QTY
K	SCREW M5X12	4

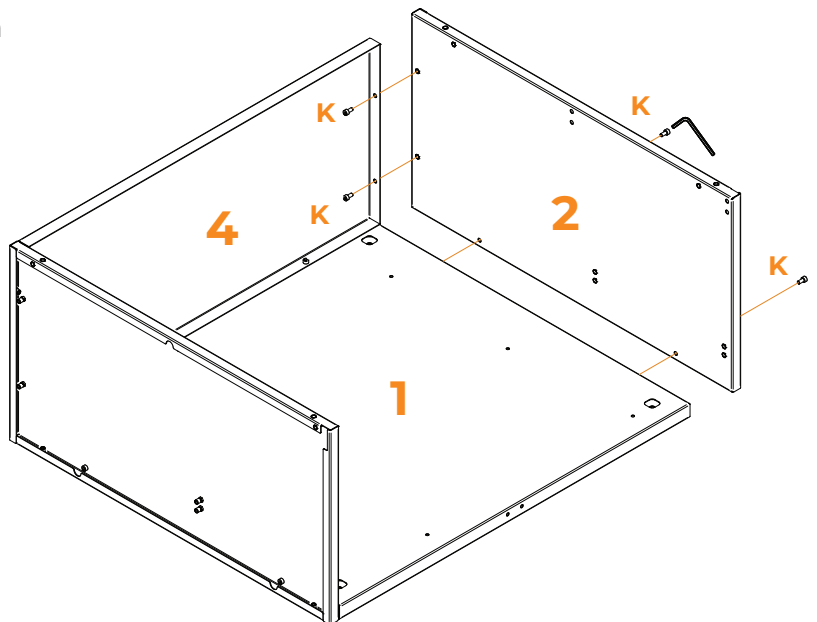

* Example image: STORAGE 90

INSTRUCTIONS

Step 5 | Attach **Mid Rib (6)** and **Front Rib (7)** to **R-Side Panel (2)** and **L-Side Panel (3)** with **Screw M5x12 (K - 8X)**, secure with an allen wrench (or hex head).

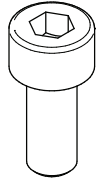

#	COMPONENT	QTY
K	SCREW M5X12	8

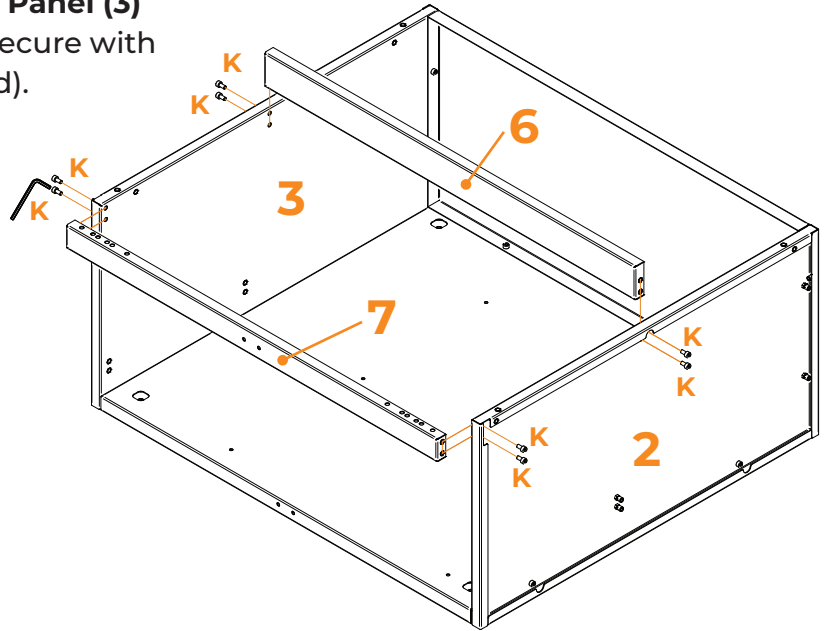

Step 6 | Attach **L-Drawer Slide (C)** to **L-Side Panel (3)** and **R-Drawer Slide (D)** to **R-Side Panel (2)** with **Screw M5x12 (K - 24X)**, secure with an allen wrench (or hex head).

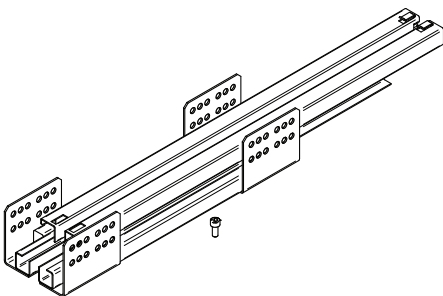

#	COMPONENT	QTY
K	SCREW M5X12	8
C	L-DRAWER SLIDE	1
D	R-DRAWER SLIDE	1

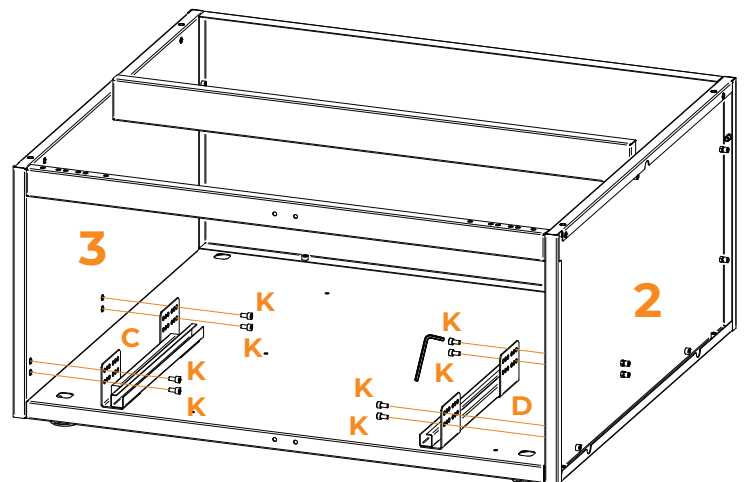

* Example image: STORAGE 65

INSTRUCTIONS

Step 7 | Attach **Countertop (5)** to **L-Side Panel (3)** and **R-Side Panel (2)** with **Screw M5x12 (K - 4X)**, secure with an allen wrench (or hex head).

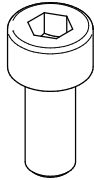

#	COMPONENT	QTY
K	SCREW M5X12	4

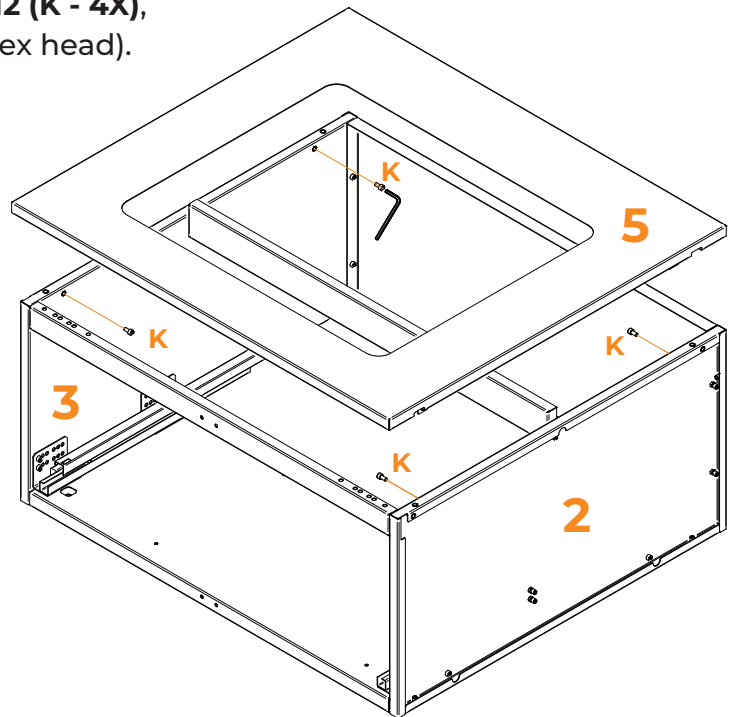

Step 8 | Attach **Side-Front Fix (G - 2X)** to **Drawer Front (9)** with **Screw M4x16 Countersunk (M - 6X)**, secure with phillips head screwdriver. **Repeat for all Drawer Fronts.**

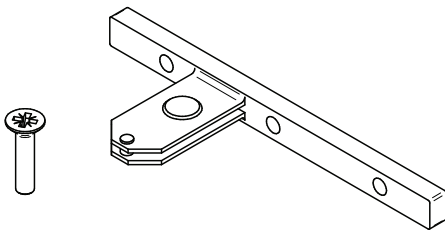

#	COMPONENT	QTY
M	SCREW M4X16 COUNTERSUNK	6
G	SIDE-FRONT FIX	2

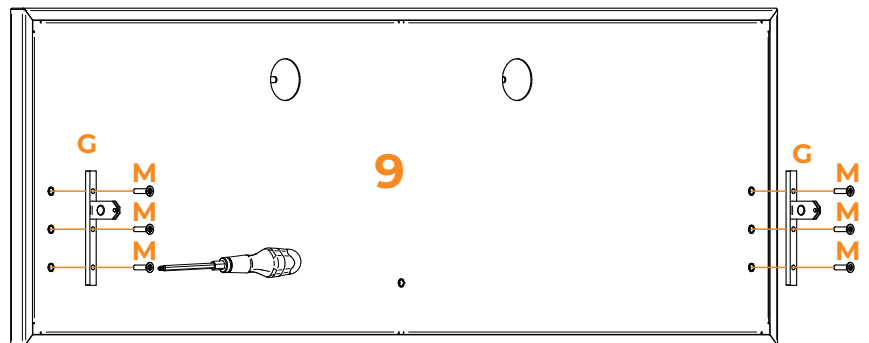

INSTRUCTIONS

Step 9 | Attach **Countertop (4)** to **L-Side Panel (3)** and **R-Side Panel (2)** with **Screw M5x12 (K - 4X)**, secure with an allen wrench (or hex head).

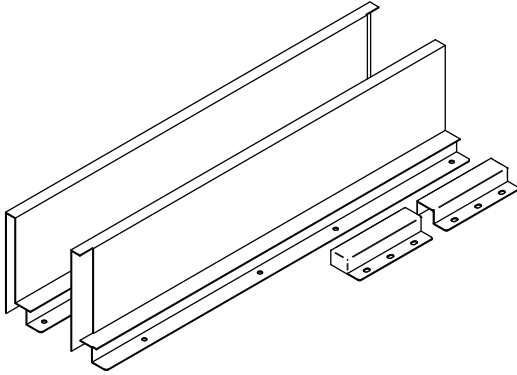

#	COMPONENT	QTY
A	L-DRAWER SIDE	1
B	R-DRAWER SIDE	1
F	L-DRAWER CORNER	1
G	R-DRAWER CORNER	1

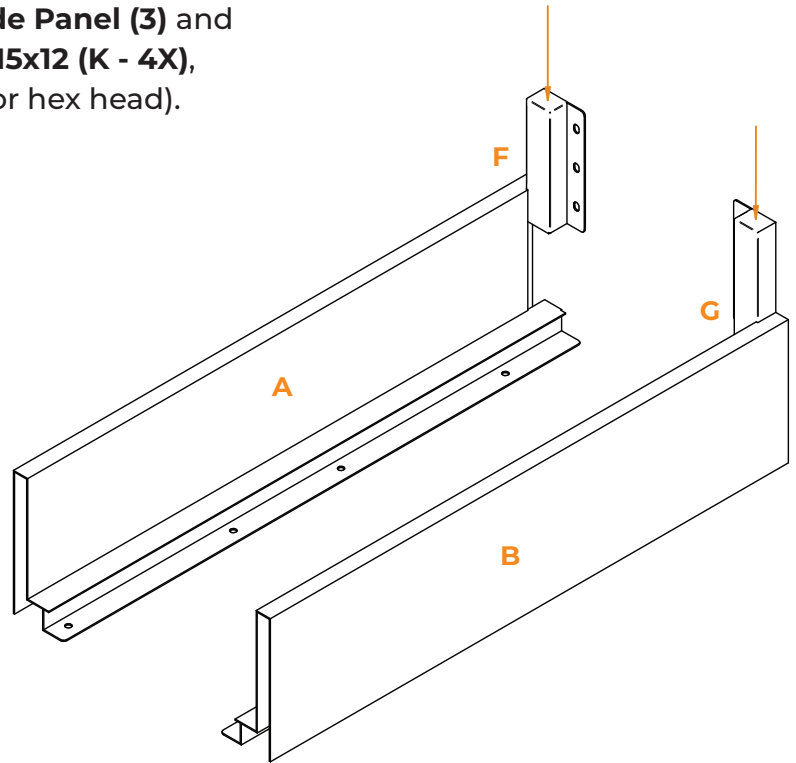

Step 10 | Using **Screw M4x10 (J)** and a phillips head screwdriver, attach **Drawer Bottom (9)** to **L-Drawer Side (A)** and **R-Drawer Side (B)**. Then attach **Drawer Back (10)** to **L-Drawer Corner (F)** and **R-Drawer Corner (G)**. Then attach **Drawer Bottom (10)** to **Drawer Back (11)**.

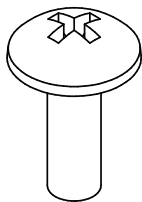

#	COMPONENT	QTY
J	SCREW M4X10 ROUNDHEAD	10

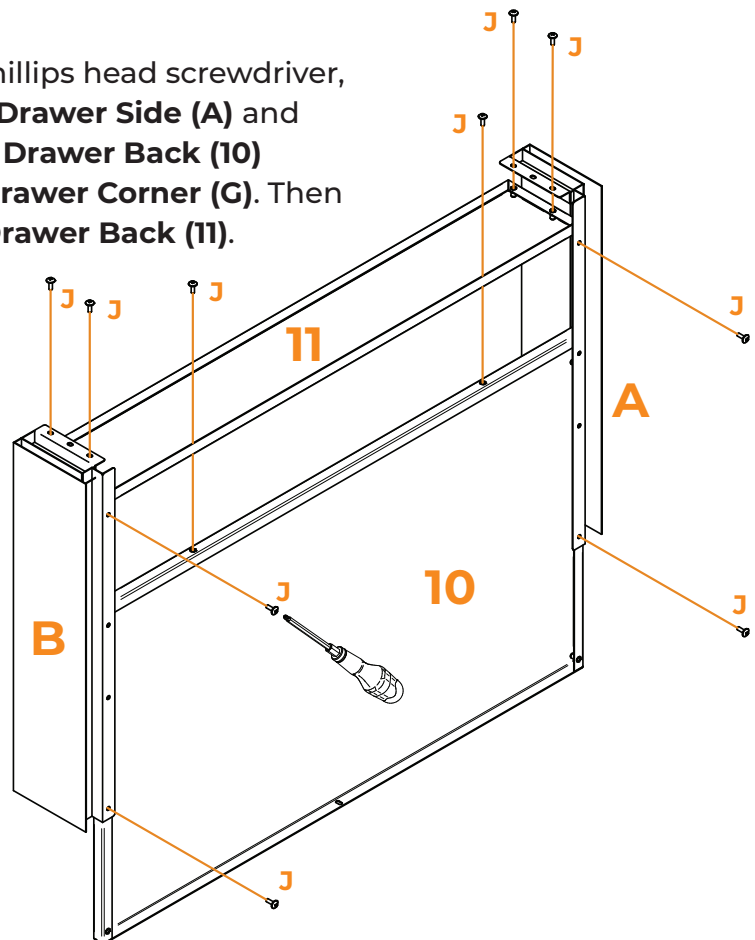

Step 11 | Using **Screw M4x10 (J)** and a phillips head screwdriver, attach **L-Drawer Side (A)** and **R-Drawer Side (B)** to the **Side-Front Fix (G - 2X)**. Then attach the **Drawer Bottom (10)** to the **Drawer Front (9)**.

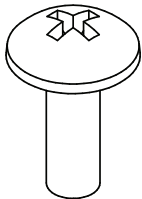

#	COMPONENT	QTY
J	SCREW M4X10 ROUNDHEAD	1

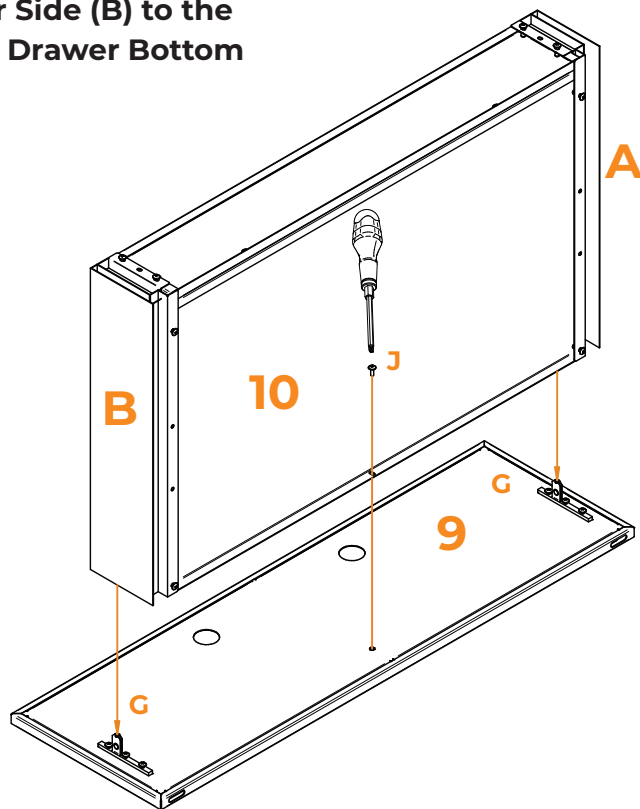

* Example image: STORAGE 65

Neolith Stone Installation

1. Stick the stone to the countertop plate using adequate adhesive to fix the stone in its place.
2. Remove any excess of adhesive using a damp cloth.

RECOMENDATION: When the outdoor kitchen is already mounted and positioned, FONTANA recommends to seal the seams between stones with outdoor suitable adhesive for best performance and results.

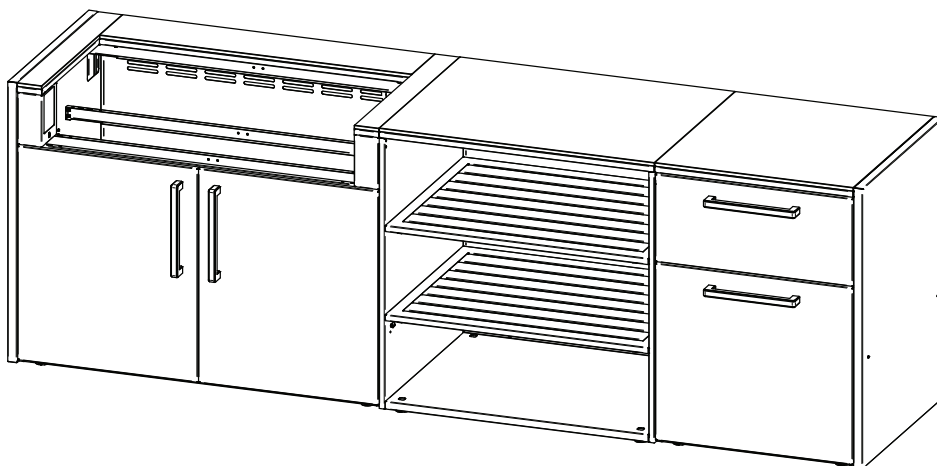
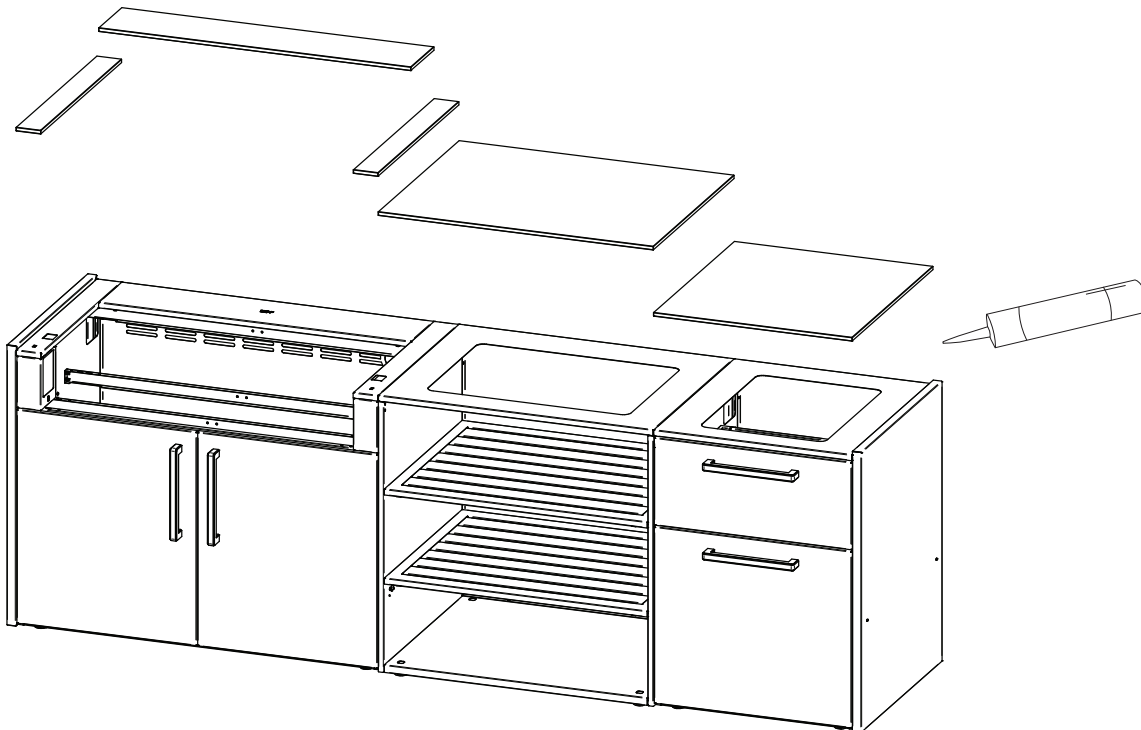

* Example image: MODULE LUMEN 6 / OPEN SHELF / STORAGE 65

Wall Assembly:

Use **M5X12 screws (K - 4X)** to mount the corresponding Wall to the back of the ELYSIA module. Ensure the extra is positioned correctly.

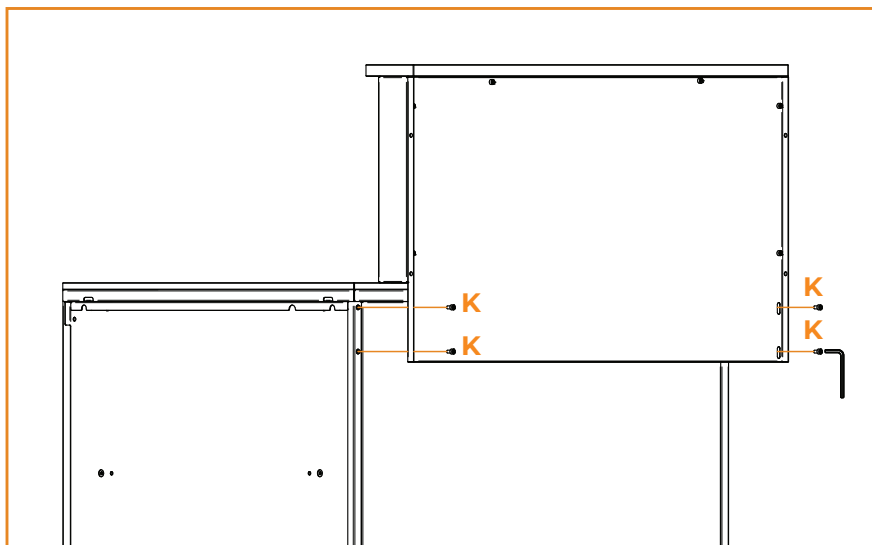

* Example image: WALL 90

Leg Adjustment Screw

There are four visible orifices on top of the bottom plate of every module. Inside you can see the leg regulation screw. Use an Allen wrench to set all the legs until the module is settled and has proper leveling. Must be done with the module positioned in its definitive location.

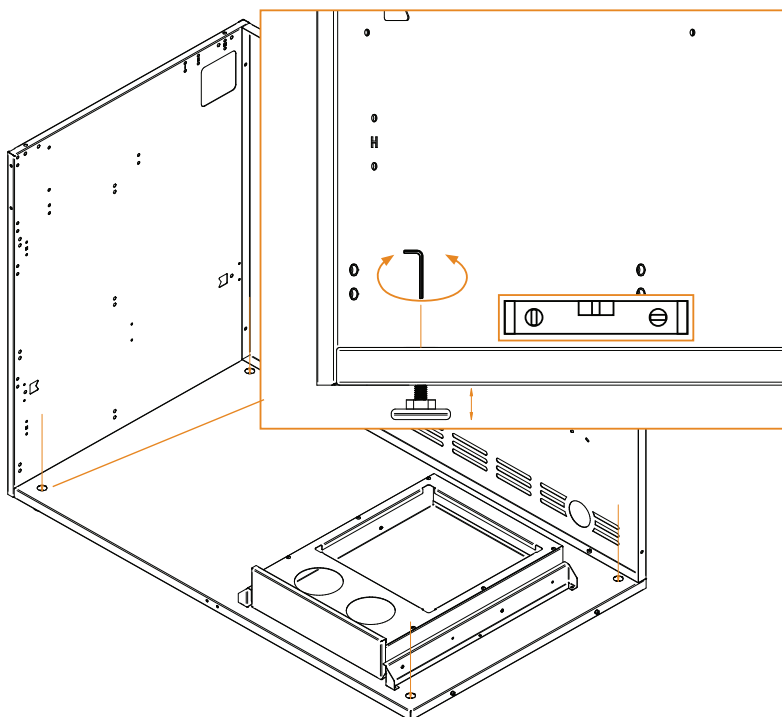

* Example image: MODULE LUMEN 6

Kamado Module Configuration:

A ELYSIA Outdoor Modular Kitchen featuring a Kamado module has two possible configurations:

- Kamado module is situated between two other modules.
- Kamado module is located at the end of the kitchen layout, assembled only to another module.

Depending on how the outdoor kitchen is going to be mounted, the Kamado module needs two

End Panels (**layout no. 1**) or a single End Panel and a Kamado End Panel (**layout no. 2**).

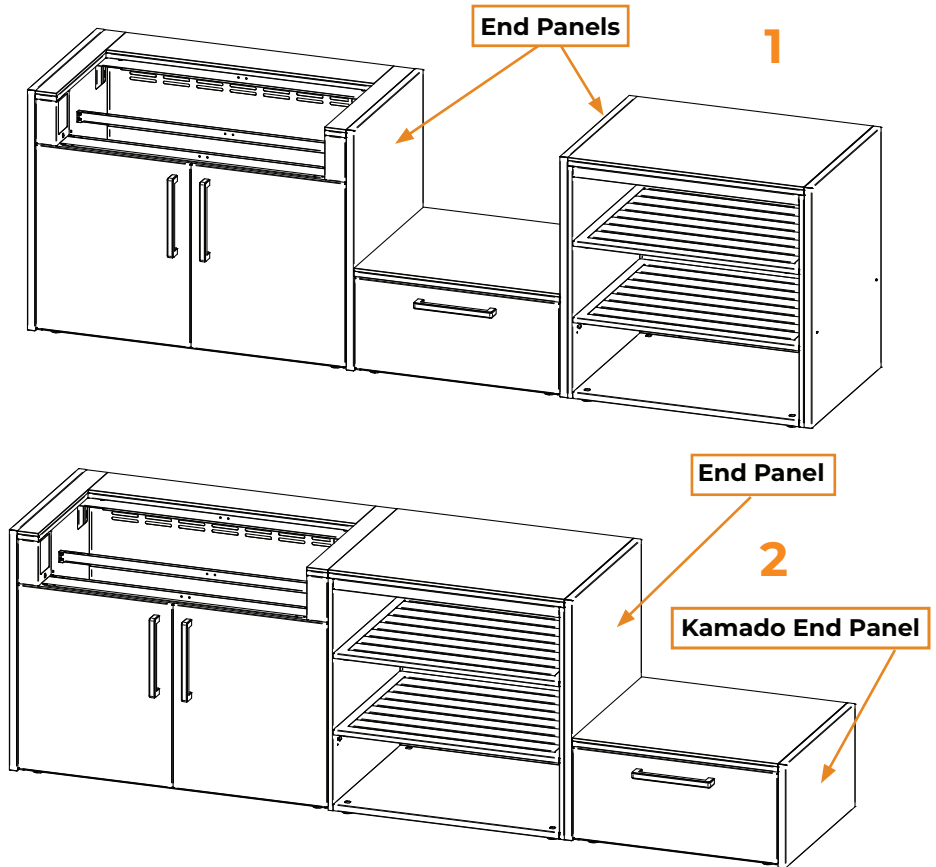

* Example image: MODULE LUMEN 6 | OPEN SHELF | MODULE KAMADO

Kamado to Corner Configuration:

In case your kitchen layout includes a Corner module to which a Kamado module and another ELYSIA Outdoor Modular Kitchen module are assembled, Kamado module must always be mounted first to the Corner module, and then the module yet to be assembled can be joined to the Corner module as to regular modules.

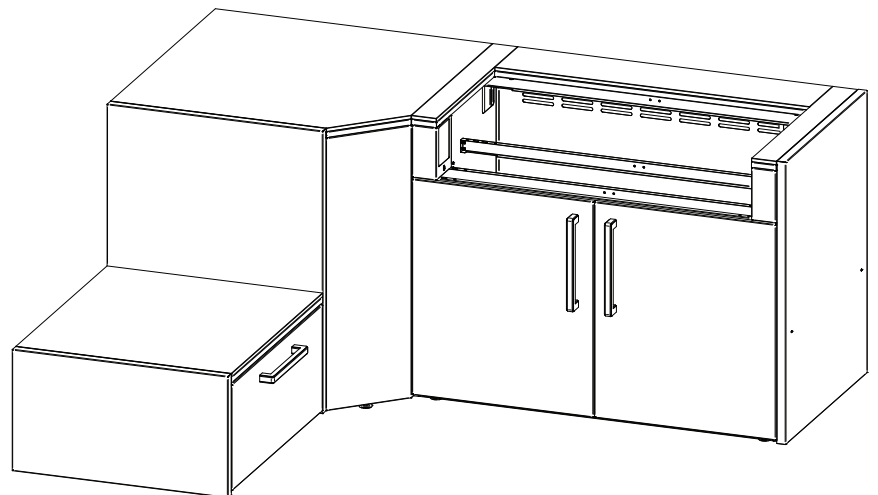

* Example image: LUMEN 6 / MODULE KAMADO / CORNER

Kamado End Panel Mountage:

IMPORTANT: Mount Kamado End Panel BEFORE assembling this module to another.

Step 1

Use **M6X10 screws (i - 2X)** to install upper part of Kamado End Panel to Kamado module.

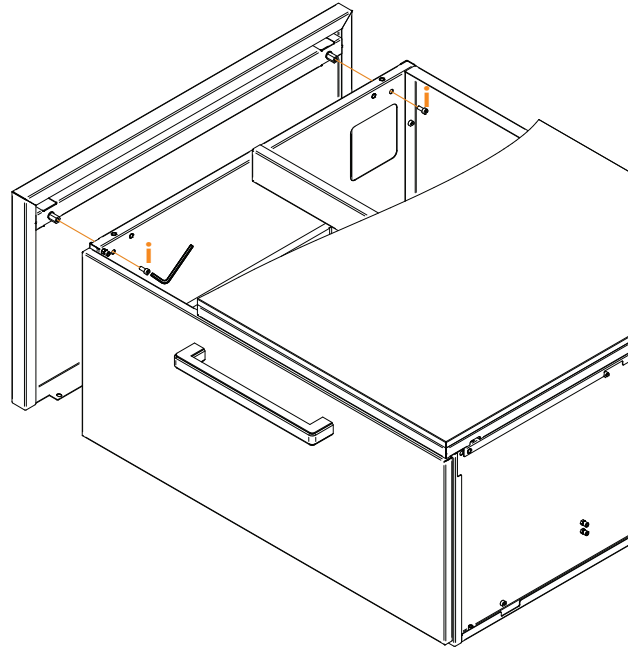

* Example image: MODULE KAMADO / KAMADO END PANEL

Step 2

Use **M5X12 screws (K - 2X)** to install lower part of Kamado End Panel to Kamado module.

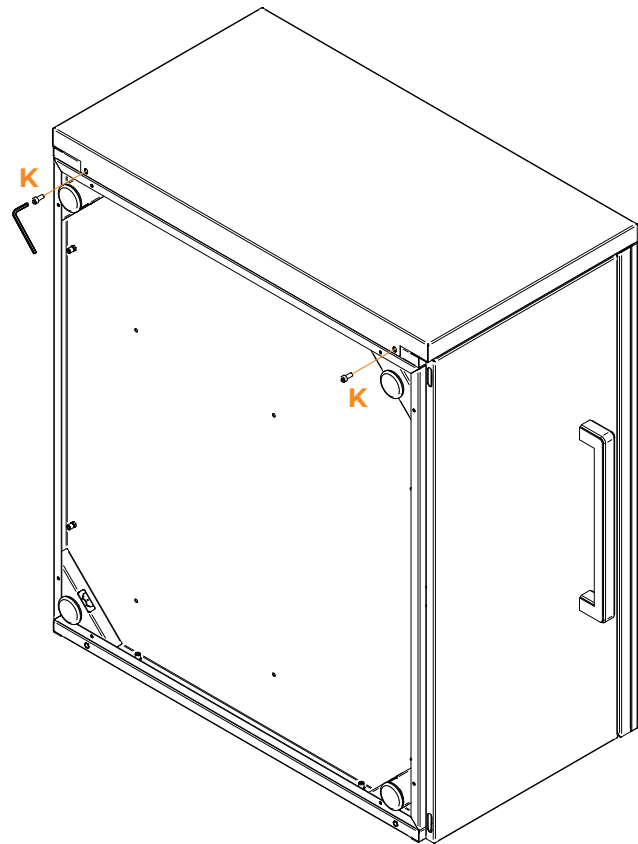

* Example image: MODULE KAMADO / KAMADO END PANEL

Kamado to Module Assembly

Step 1

Use **M5X12 screws (K - 2X)** to fix an End Panel to the Module Kamado.

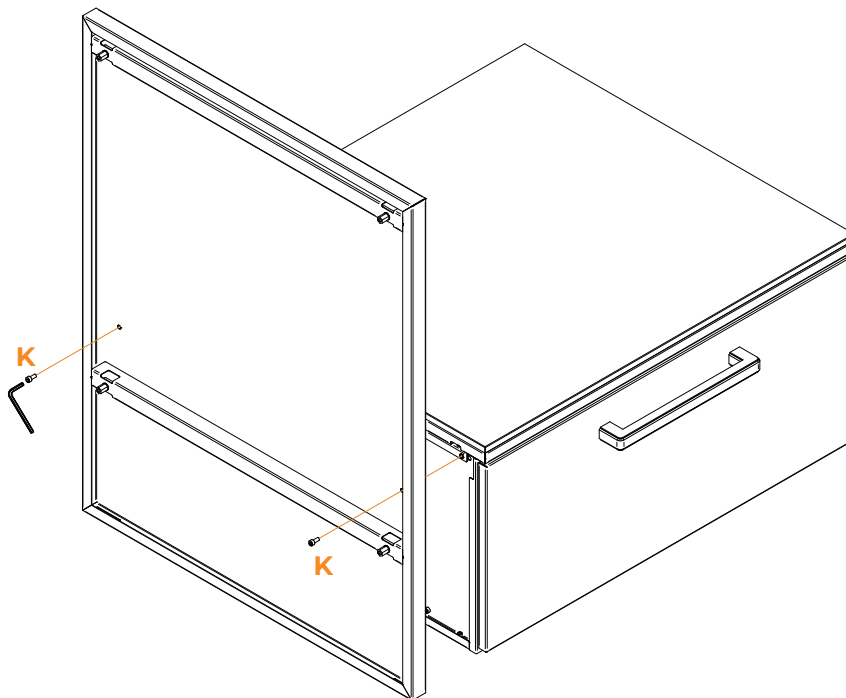

* Example image: MODULE KAMADO / END PANEL

Step 2

Use **M6X16 screws (ii - 4X)** to install the Kamado module with the mounted End Panel to another module. It is assembled as if it was a single End Panel. It is necessary to remove drawers like mentioned in End Panel installation.

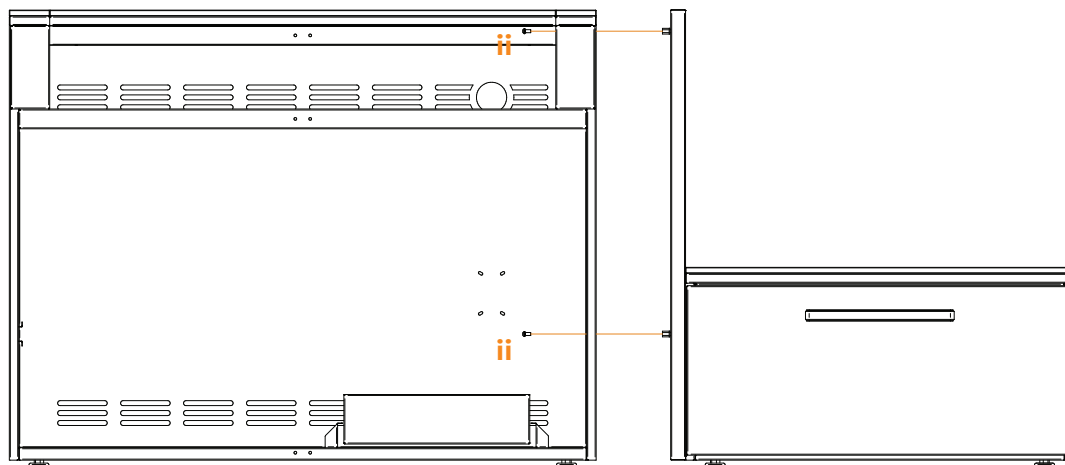

* Example image: MODULE KAMADO / MODULE LUMEN 6

Handles Assembly:

Use **M4x12 bolt (1 - 2X per handle supplied)** to assemble the handles to module doors or drawers front plate.

Handles Available



Black Handle



Stainless Steel Handle

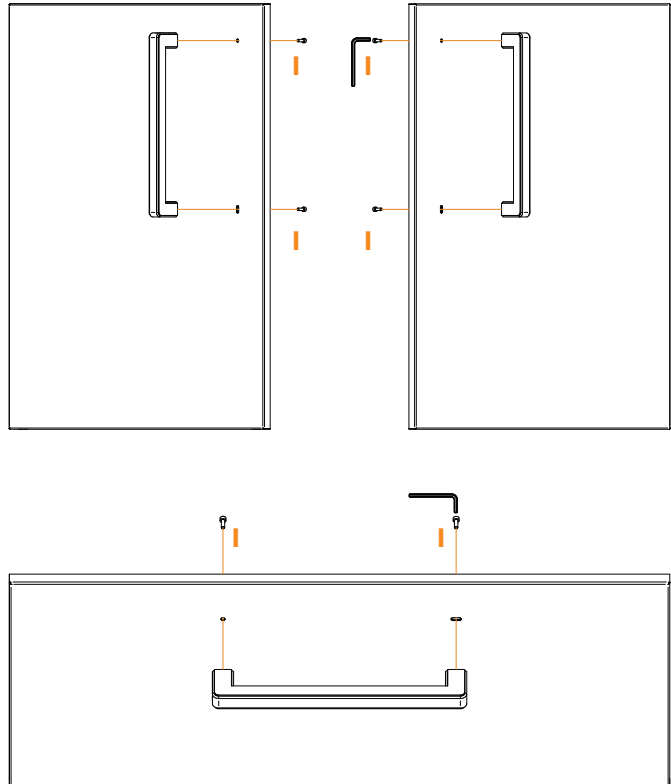

* Example image: MODULE LUME 6 / MODULE KAMADO

Installing Drawer:

To install the drawer of a ELYSIA Outdoor Modular Kitchen module, simply align the channel at the bottom of the drawer with the slides and push the drawer inward.

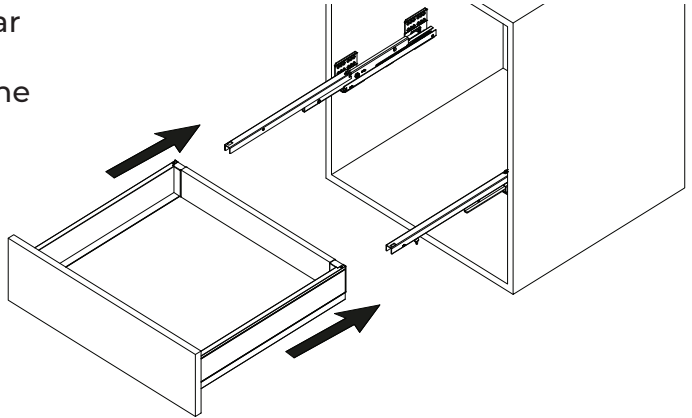

Remove Drawer:

To remove the drawer from a ELYSIA Outdoor Modular Kitchen module, simply engage the tab located at the bottom of the guide and pull the drawer outward.

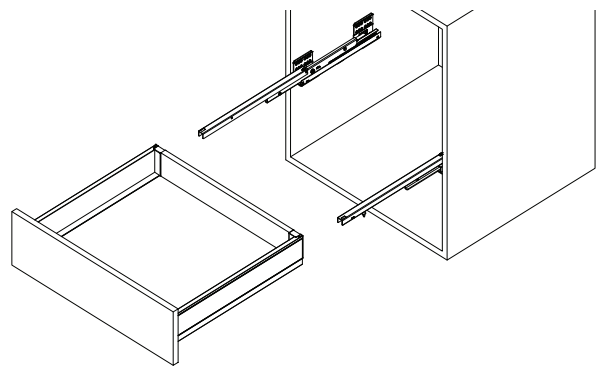
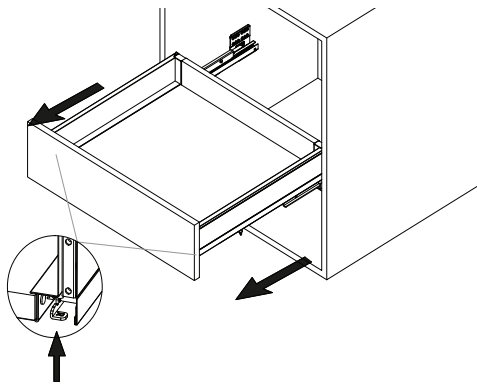

ADJUSTMENT

Guides Adjustment:

Guides can be adjusted using both screw visible at inside lateral of the guide. As it is shown below, lower screw is used for left-right adjust while upper screw is used for updown adjust.

Left-Right Adjustment

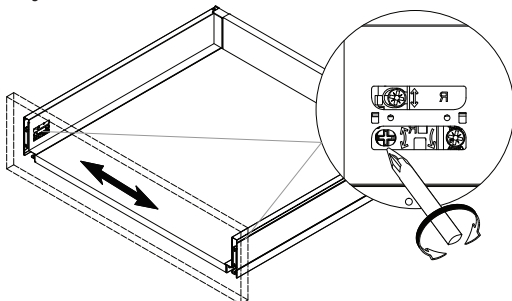

± 1.5 mm

Up-Down Adjustment

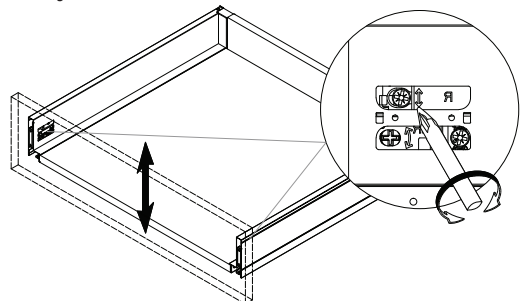

± 1.5 mm

To prolong the life of your ELYSIA Outdoor Modular Kitchen please follow the recommended maintenance instructions:

Powder Coated Surfaces

Scheduled cleaning will benefit and extend the long lasting aesthetics of the finish. This procedure is an integral part of the warranty given for surface finish and color retention and it will minimize the weathering effect of dirt and other airborne pollutants which tend to accumulate on the surface of the coating, dulling its appearance. We suggest the following guidelines:

- Cleaning of the coated surfaces with warm water and mild detergent or non abrasive pH-banaced cleaner solution, and the use of non abrasive brush or sponge.
- The cleaning solution should not be allowed to be in contact with the powder coated surface for more than 30 minutes.
- DO NOT use any chlorides or quaternary salts on the module. DO NOT use any hydrochloric acid (muriatic acid) on modules. Refrain from using harsh chemicals, solvents, or abrasive cleaners, as they can damage the powder coating. Opt for cleaners specifically designed for powder-coated surfaces.
- After cleaning, the surface shall be completely rinsed-off with clean fresh water to remove any cleaning residue. This helps prevent the accumulation of cleaning agents that might affect the powder coating over time.
- A record of all cleaning schedules, frequencies and products should be kept and documented.
- While cleaning is crucial, avoid using high-pressure washers, as the force can damage the powder coating. Stick to gentle cleaning methods to ensure the longevity of the finish.

Hard water deposits can affect the appearance of the powder coating over time. When the outdoor kitchen is not in use, consider using protective covers to shield it from the elements. This helps prevent exposure to harsh sunlight, rain, and other environmental factors that could impact the powder coating. If your area has hard water, consider wiping down the surfaces after rain or watering to prevent water spots.

Neolith Stone Maintenance

Please take extra care when cleaning your top Neolith stone. Although solvents, such as acetone, are often recommended by counter manufacturers and fabricators, these substances your ELYSIA Outdoor Modular Kitchen powder coated finish.

To clean your countertop stone, use soapy water and a damp cloth. If there are stains encrusted/dry, you have to soak the stain with a standard detergent and wait to rub with a damp cloth.

Special consideration with ceramic knives which may scratch Neolith's surface in every finish.

ELYSIA

OUTDOOR MODULAR KITCHEN BY **FONTANA**
F O R N I