

bodywand™

WWW.VERSAWAND.COM

XGEN, LLC | Horsham, PA 19044 | All Rights Reserved

UK Responsible Person: ArangaRanga UK LTD, 20-22 Wenlock Road, London, N17 6UJ, UK.
Phone: +44 2037692960, E-Mail: UKresponsibleperson@arangeranga.com
EU Responsible Person: ArangaRanga SL, Paseo de la Castellana 194, Madrid, 28046, Spain.
Phone: +34 910054258, E-Mail: Euresponsibleperson@arangeranga.com

bodywand™

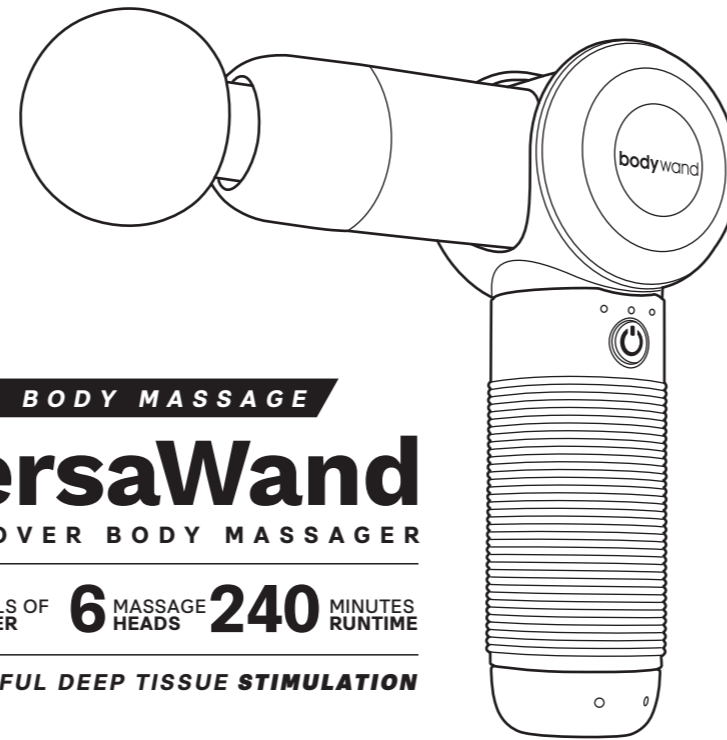

FULL BODY MASSAGE

VersaWand

ALL-OVER BODY MASSAGER

3 LEVELS OF POWER 6 MASSAGE HEADS 240 MINUTES RUNTIME

POWERFUL DEEP TISSUE STIMULATION

INTRODUCTION

IMPORTANT: DO NOT USE THE VersaWand OR ANY VIBRATION DEVICE WITHOUT FIRST OBTAINING APPROVAL FROM YOUR DOCTOR IF ANY OF THE FOLLOWING APPLY TO YOU:

Pregnancy; have diabetes with complications such as neuropathy or retinal damage; have a pace maker; recent surgery; epilepsy or migraines; herniated disks, spondylolisthesis, or spondylosis; recent joint replacements or IUDs; metal pins or plates or if you have any concerns about your physical health. Frail individuals should be accompanied by an adult when using any vibration device. These contraindications do not mean that you are not able to use a vibrational or exercise device, but we advise you to consult a doctor first.

Ongoing research is being conducted to study the effects of vibration exercise for specific medical disorders, which will likely result in the shortening of the list of contraindications shown above. Practical experience has shown that integration of vibration exercise into a treatment plan is advisable in a number of cases. This must be done based on the advice of a doctor, specialist or physiotherapist.

USAGE INSTRUCTIONS

IMPORTANT TO KNOW PRIOR TO USE:

CHARGING

- Fully charge the device's battery for up to two hours before first use.
- LED band on battery light will pulsate to show battery level and to indicate active charging.
- When battery is attached, LED lights on the unit will flash to show battery level and indicate active charging.
- Full charge is indicated when all LED lights stop flashing and remain fully illuminated.
- Battery may be recharged at any battery level.
- It is not recommended to fully deplete the battery to the red LED level.
- The average run-time is about between 240 to 360 minutes, depending on speed level and pressure applied during use.

01

SPECIFICATIONS

90° adjustable

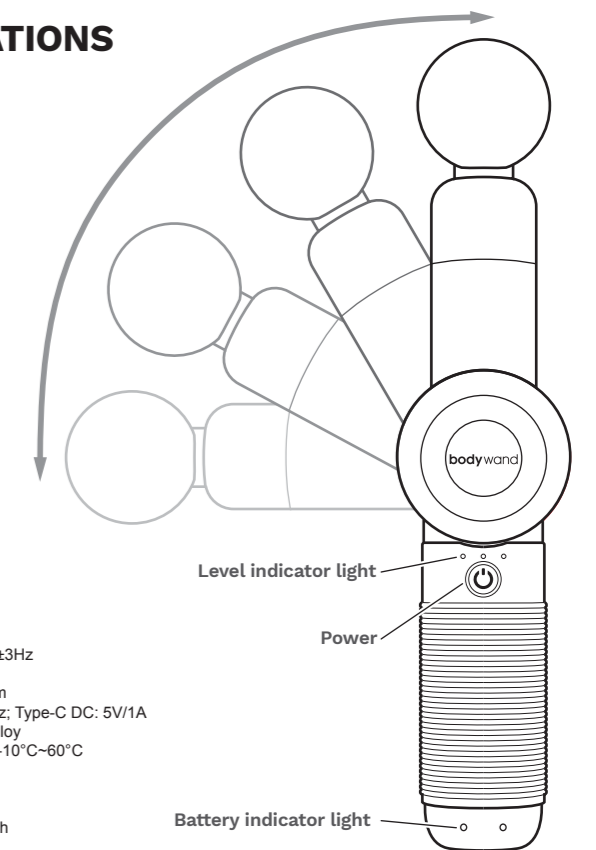

Product weight: 0.64KG
3Levels: 1-3(30-40-50HZ)±3Hz
Amplitude: > 8mm
Product size: 138 x 179mm
Charge: 110-240V 50/60Hz; Type-C DC: 5V/1A
Main material: ABS, Zincalloy
Operational environment: -10°C-60°C
Usage time: Up to 4H
Charging time: Up to 2H
Noise: ≤ 65dB
Battery capacity: 2000 mAh

02

6 INCLUDED ATTACHMENTS

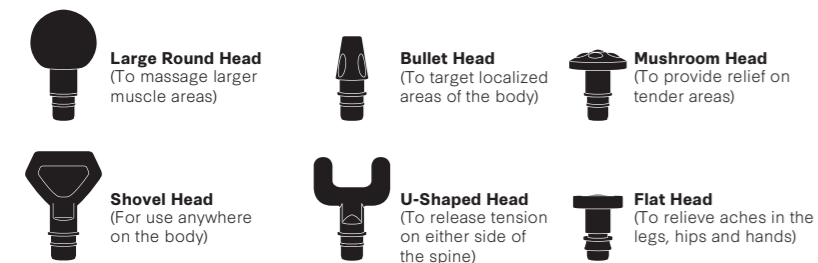

CHANGING THE ATTACHMENTS

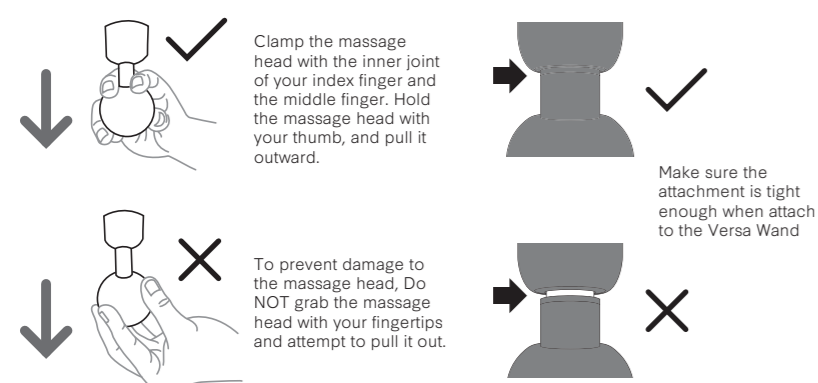

03

USAGE INSTRUCTIONS

USING YOUR VERSAWAND:

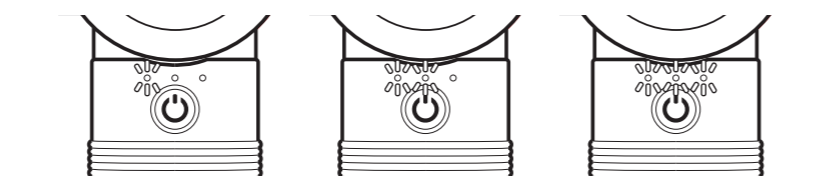
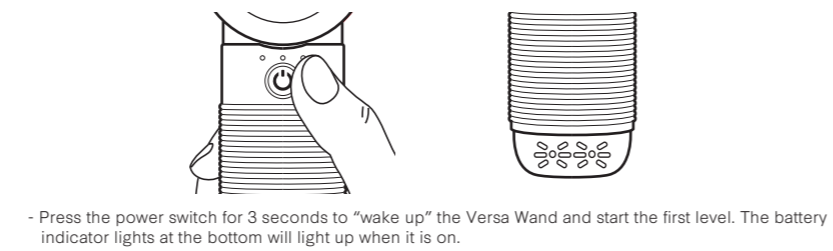

- At the same time, one of the level indicator lights will light up to show that the first level is on. Press the power switch again to start the second level, which will be shown by a second indicator lighting up. Press the power switch again to start the third level, and another level indicator light will light up. Press the power switch again to stop the thrusting. Three of the level indicator lights will then be turned off and the Versa Wand is on standby mode. When you press the power switch again, the Versa Wand will go back to level one.
- To shut down the device, long press the power switch for three seconds while the device is running and that will automatically disconnect the power.
- When the battery power is less than 20%, the battery indicator light will appear red, which means it needs to be recharged to avoid being shutting off.
- When the battery is fully charged, the battery indicator light will be on.
- The Versa Wand would stop even 15 minutes when using continuously for healthy reasons.

04

MAINTENANCE, CLEANING & STORAGE:

- Use a slightly damp towel to clean the device and dry it using a soft cloth.
- For storage and during travel, use the included case to keep your device safe.

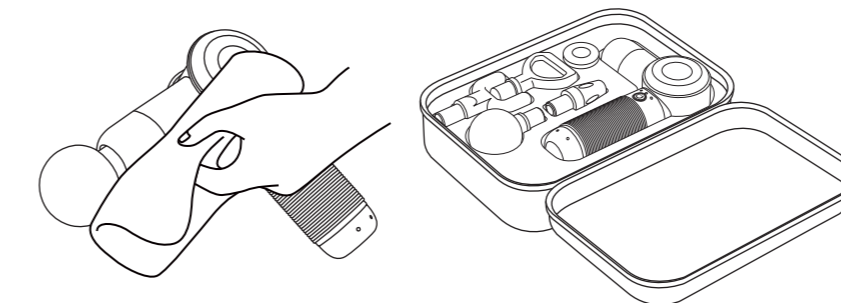

WARNING

WARNINGS & CAUTIONS

- DO NOT SUBMERGE IN WATER. KEEP AWAY FROM LIQUIDS OR HEAT SOURCES. KEEP VENTILATION PORTS FREE FROM DUST AND DEBRIS.
- DO NOT REMOVE THE DEVICE'S SCREWS OR PARTS. DO NOT ATTEMPT TO DISASSEMBLE DEVICE.
- DO NOT OPERATE CONTINUOUSLY FOR MORE THAN ONE HOUR. ALLOW DEVICE TO REST FOR 30 MINUTES BEFORE REPEATING USE.
- UNPLUG THE CHARGER FROM DEVICE'S BATTERY AFTER EACH CHARGE AND PRIOR TO USE.
- FOR ADULT USE ONLY. DO NOT USE THIS DEVICE IF INJURED. CONSULT YOUR DOCTOR BEFORE USING THIS PRODUCT.
- THE VERSA WAND WOULD STOP OPERATE IF FORCED TO COMPRESS TO HARD SURFACE 6 SECONDS SUCH AS THE FLOOR OR WALL.

05

SAFETY INSTRUCTIONS

PREVENT DANGER: TO REDUCE RISKS OF ELECTRIC SHOCK, FIRE, AND PERSONAL INJURY, THIS PRODUCT MUST BE USED IN ACCORDANCE WITH THE FOLLOWING INSTRUCTIONS:

- This device is for adult use only.
- Use only on dry, clean surfaces of the body, over clothing, and by lightly pressing and moving across the body for approximately 60 seconds per region.
- Use this device on the body's soft tissue only as desired, without producing pain or discomfort. Do not use on head or any hard or bony areas of the body.
- Only use the device's attachments and settings that provide the best desired effect.
- Bruising can occur regardless of control setting or pressure applied. Check treated areas frequently and immediately stop use at first sign of pain or discomfort.
- Keep fingers, hair or and other body parts away from the shaft and backside of the applicator as pinching may occur.
- Do not place any objects into the ventilation holes of the Versa Wand.
- Do not immerse device in water, or allow water to enter the ventilation holes of the Versa Wand.
- Do not drop, throw or misuse the Versa Wand to prevent damage and injury.
- Carefully examine the Versa Wand and battery before each use to ensure its proper functioning.
- Do not tamper or attempt to alter the Versa Wand in any way.
- Never leave the Versa Wand unattended while it is operating or while its battery is charging.

NOTE: SPILLAGE OF LUBRICATING PRODUCT ON THE MESSAGE HEAD INTERFACE AND ROTATING PART IS NORMAL, AND CAN BE WIPED OFF WITH A DRY TOWEL. IF YOU HAVE ANY FURTHER QUESTIONS, PLEASE FEEL FREE TO CONTACT US. WE WILL DO OUR BEST TO SOLVE ANY PROBLEMS THAT YOU MAY BE HAVING.



06