

# Clean-Care Rotary Electric Tooth Brush

ET-711

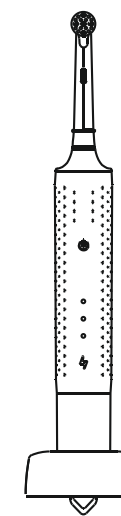

Sensing Health Everywhere

## INTRODUCTION

► Congratulations on taking the first foot forward towards a healthier and brighter smile by purchasing the Healthsense Electric Rotary Toothbrush. Before you begin to enjoy the benefits of sophisticated dental care from the comfort of your home, please take a few moments to glance through this manual completely and also save it for future use.

► Please READ ALL INSTRUCTIONS BEFORE USE and use this product only for its intended usage as described in the manual.

► **INTENDED USE** : For in-home use to maintain overall oral hygiene by cleaning teeth & gums.

## WHAT'S IN THE BOX

- Toothbrush unit
- 2 x Brush Heads
- 2 x Dust Covers
- Charging Unit
- User Manual
- Warranty Card

## KNOW YOUR TOOTHBRUSH

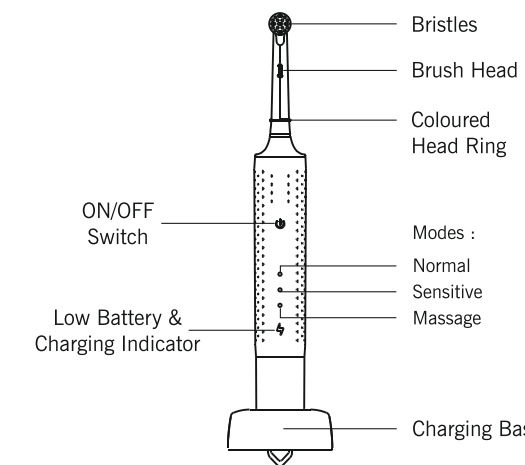

\*Coloured Head Ring  
Removable coloured rings to identify brush heads specific to multiple users or self-usage.

## FEATURES

- 2min Smart Timer & 30Sec Interval Alert
- Precisely Angled Soft DuPont Bristles
- 2 Dust Covers for Hygiene Purpose
- 3 Dynamic Cleaning Modes
- 2 Brush Heads
- 260min Runtime On Full Charge
- Rotary Motor: 7000-9000rpm for Deep Cleaning
- Low Battery & Charging Indicator
- Charging base unit Included
- IPX7 Waterproof
- Low Noise, less than 70 DB
- 1 Year Warranty

## SPECIFICATIONS

Model Name	: Electric Toothbrush
Power	: 1.5 W
Battery Type & Capacity	: Lithium Ion (1200 mAh)
Charging Time	: 10 – 12 Hours
Regular Runtime (in Min.)	: 260 minutes
Product Weight	: Nett.-145g, Gross-200g
Product Dimensions	: 248 x 30mm
Noise	: <70db

## IMPORTANT INSTRUCTIONS

1. After applying toothpaste on bristles, suggested to put it into mouth before switching ON to avoid splash
2. Do not immerse toothbrush completely in water, rinse it under flowing water
3. Do not scrub teeth, apply light pressure to let it do the brushing for you
4. Charge indicator may not come to work instantly when you charge appliance after long period time. It will be back within 6-10 mins
5. Rinse to remove residues after every brushing and let it air dry. Do not rub the bristle to avoid distortion.
6. Discontinue use if this product appears damaged in any way (brush head, handle, charging unit). Refer to chapter 'Warranty & Support' if your toothbrush no longer works properly or needs repair.
7. Consult your dental professional before you use this product if you have had oral or gum surgery or implants in the previous 2 months.

## CHARGING YOUR TOOTHBRUSH

1. If the toothbrush has been unused for more than 6 months, charge it atleast for 12 hours or until it is fully charged
2. Once completely charged the toothbrush runs for a minimum of 45 days – while you brush 2 times a day (morning & night) for about 2 minutes each time.
3. Plug in charging unit to a power socket & place the bottom of the handle to charging unit, so the device sits securely connected, making complete contact in the charging unit.
4. GREEN indicator light starts blinking once charging is initiated. A complete charge takes 10 – 12 hours and once done, the green light remains ON without blinking.
5. It's time to re-charge your device when the indicator light turns RED.

## USING YOUR TOOTHBRUSH

1. Insert brush head firmly to the shaft of the device.
2. Wet the bristles under running water and apply toothpaste on it.
3. To avoid toothpaste to splash, place the brush in your mouth before switching ON and select the desired mode.

## TIMER USAGE FOR PERFECT CLEANING

4. Place bristles against the teeth at 45° angle towards the gumline.
  5. Move bristles slowly in circular motion without scrubbing, but applying light pressure to let the brush do the cleaning.
  6. Ensure to turn the brush OFF before removing from the mouth to avoid splashing. Gargle & rinse your teeth well with water once completed.
- The timer features ensures that all sections of your mouth are evenly and thoroughly cleaned through a short beep alert after 30, 60 & 90 second intervals when using a 2 minute brushing cycle.
- For perfect cleaning, divide your mouth into 4 sections and brush each section for 30 seconds in small circular motions and all directions.
- Choose between 3 brushing intensity levels –  
 a. Normal – for healthy teeth.  
 b. Sensitive – for teeth with dental issues.  
 c. Massage – improves circulation to gum line.

## CLEANING & MAINTENANCE

1. Rinse brush head and bristles thoroughly under running water after each use and let it ONLY air-dry. Do not rub the bristles to avoid distortion.
2. Wipe the entire surface of the handle with damp cloth to remove any residues.
3. Do not immerse the whole toothbrush in water
4. Do not clean the brush with very hot water (more than 40°C) or with any abrasive cleaning agents.
5. Replacing your brush head every 3 months is clinically recommended by dental professionals for best oral hygiene.

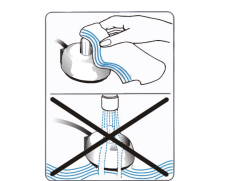
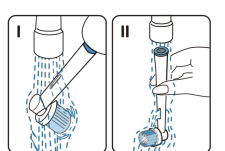

Do not clean charger with water, wipe it with clean cloth

## TROUBLESHOOTING

Problem	Cause	Solution
Rotation is weak	<ul style="list-style-type: none"> <li>• The bristle may have been pressing hard</li> <li>• The brush head is fixed too tight</li> </ul>	<ul style="list-style-type: none"> <li>• Do not apply pressure on the bristles</li> <li>• Reconnect the brush head to the shaft to fix it with a slight gap between head &amp; shaft</li> </ul>
The brush works for only a short duration	<ul style="list-style-type: none"> <li>• Improper charge</li> <li>• Insufficient charging time</li> </ul>	<ul style="list-style-type: none"> <li>• Charge till the indicator stops blinking. Recheck power connections of both charging unit and socket.</li> <li>• Device needs to be charged for atleast 10-12 hours</li> </ul>
The toothbrush does not work	<ul style="list-style-type: none"> <li>• Improper or insufficient charging</li> <li>• Internal technical fault</li> </ul>	<ul style="list-style-type: none"> <li>• Re-Charge as per guidelines</li> <li>• Contact Healthsense Support Team for assistance</li> </ul>
Unpleasant Odour	<ul style="list-style-type: none"> <li>• Inappropriate cleaning</li> <li>• Worn out or aged brush head</li> </ul>	<ul style="list-style-type: none"> <li>• Follow thorough cleaning methods</li> <li>• Replace brush head with new one</li> </ul>

## WARRANTY & SUPPORT

Entitle yourself for the 1 year HealthSense warranty by registering your purchase and easily reach us to submit your product related issues & queries, when you follow these hassle free ways.

At HealthSense our top priority has always been our valued customers. We very well know your HealthSense product is a part and parcel of your everyday life, which is why we are more easily accessible than earlier.

SCAN - For Warranty Registration



( Must register within 30 days from date of purchase )

SCAN - To File Complaint



( Fill & submit form if you are facing any product related issues )

\* For detailed warranty terms please visit the link : [www.healthsense.in/warranty-terms](http://www.healthsense.in/warranty-terms)

\* For additional support :  
 Mail us at : [support@healthsense.in](mailto:support@healthsense.in)  
 Call us on : 080-41262836

[www.healthsense.in](http://www.healthsense.in)

