

## Limited Lifetime Guarantee

N.S.A. RV Products, Inc. warrants to the original owner only that this product will be free from defects in material and workmanship upon original purchase.

The lifetime Guarantee on the Ready Brute Elite unit covers the Ready Brute Elite from front to back 100% replacement to the original owner only. The Lifetime Guarantee does not cover damage resulting from tamper, abuse, unreasonable use, mistreatment, negligence or accidental breakage. The Guarantee also does not cover any hardware, cables or any component of the DL-300 In-Dash Light Monitoring System or the safety cables.

The Lifetime Guarantee does not apply in Australia and New Zealand on any product sold after 4/12/19.

**IN NO EVENT WILL N.S.A. RV PRODUCTS, INC. BE LIABLE FOR ANY SPECIAL, INCIDENTAL, OR CONSEQUENTIAL DAMAGE, RESULTING DIRECTLY FROM POSSESSION, MISUSE OR IMPROPER CARE OF THE READY BRUTE ELITE UNIT.**

## Returns

Anyone wishing to return merchandise must call to obtain authorization to do so.

- 1.) 30 day money back guarantee begins on date of shipment from NSA RV.
- 2.) When we receive a return our Q.C. department will inspect the items and determine a refund amount to be issued.
- 3.) Shipping charges are non-refundable and we do not pay return shipping fees.



**Ready Brute Elite II**  
Towbar & Brake Combo



#RB-9050-2



[www.nsarvproducts.com](http://www.nsarvproducts.com)  
Questions: 620-365-7714  
[sales@nsarvproducts.com](mailto:sales@nsarvproducts.com)

CST 8-5

**Installation  
Instructions**



## Before you get started

To ensure that you get optimum results from your Ready Brute Elite II please read through the instructions. The Ready Brute Elite II provides the towing and braking assistance you need for your towed vehicle, but only when it is used according to the manufacturer's instructions.

**A base plate needs to be installed on your towed vehicle prior to installing the Ready Brute Elite II.**

**N.S.A. Ready Brute Elite II Tow bars are rated for 8,000 lb. towing capacity. Be sure that the towed vehicle mounting brackets, safety chains and hitch pins are also rated higher than the towed vehicle weight. (Tow car base plates are not included)**

## Installing your Ready Brake

Make sure the receiver on your motor home is clean and free from debris before placing the Ready Brake into the receiver tube. Align the holes of the Ready Brake and your hitch's receiver tube. Use a standard 5/8" cross pin to secure the Ready Brake in the receiver. The actuator arm on the Ready Brake can travel 3 1/2" toward the bumper on the motor home, allow for clearance. Most motor homes have a standard 6" deep receiver but some are shorter. In case of a shorter depth, it is ok to cut 1" off the end of the 2" square tube of the Ready Brake to make it to fit a shorter receiver.

**Step 1. Drill a hole in the firewall where the internal cable conduit will be attached.** Depress the brake pedal and mark a spot with chalk on the firewall or floorboard directly across from the depressed brake arm allowing for a straight pull between the brake pedal arm and the hole. (Fig. B)

**Step 2. Make sure there is no obstruction on the engine side of the firewall.** Pull back the carpet and drill a 1/8" pilot hole allowing your drill bit to barely go through the firewall. If anything is interfering with this location, drill another pilot hole. Remember to maintain as straight a line as possible.

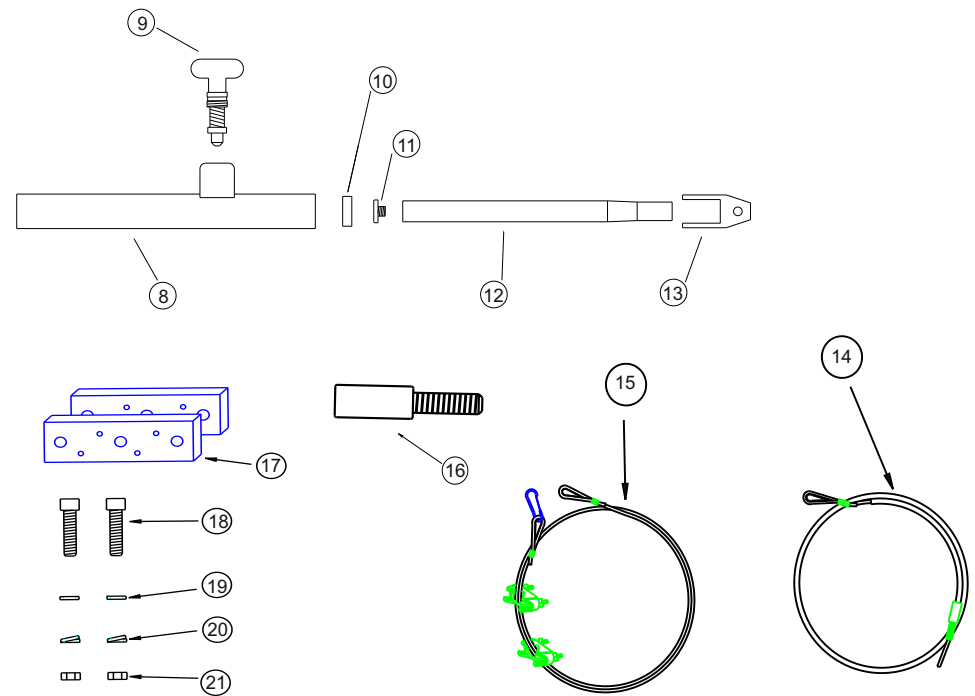

## Available Accessories

**Break-Away System**  
applies towed vehicles  
brake's if it ever break's away  
from motorhome  
# RS-5000 "ReadyStop"



## Drops, Risers and Extensions

2" drop # H-702      4" drop # H-704  
6" drop #H-706      8" drop # H-708  
10" drop #H-710      Extension # H-1800



## De Fuser

Stop Pulling fuses. Install a  
De-Fuser then just flip a switch instead.



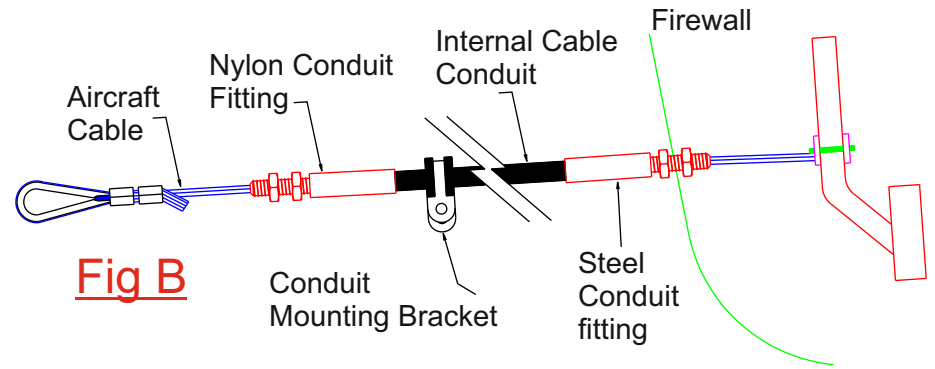
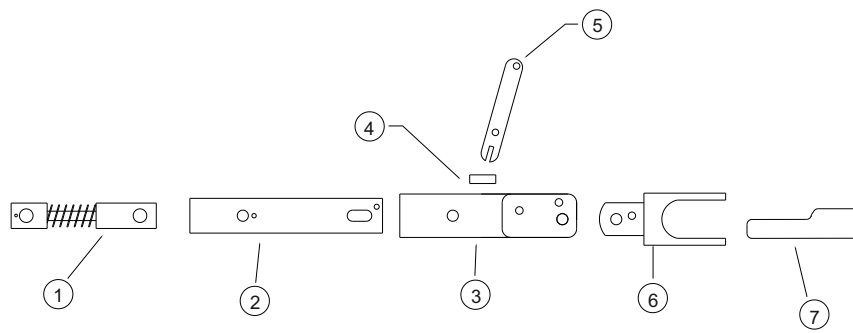

Ref#	Qty	Description
1	1	Shock & Spring Assembly
2	1	Brake Body Inside
3	1	Combo Head
4	1	Pivot Block Clamp
5	1	Actuator Arm
6	1	U-Joint
7	2	Billet Elbow
8	2	Outside tube
9	2	T-Handle
10	2	Internal Washer
11	2	Pull Rod Washer
12	2	Pull Rod
13	2	Tow bar to Baseplate Clevis
14	1	Sling
15	1	Cable Conduit & S.S. Cable w. Thimble
16	1	Nylon Fitting
17	1	Brake Tie
18	2	1/4-20 x 2 1/4 S.H.C.S.
19	2	Washer
20	2	Split Washer
21	2	Nut

**Step 3. Install the Ready Brake conduit fitting.** When you have no obstructions in the firewall, enlarge the hole for the steel conduit fitting using a 5/16" bit. Cut a small slit in the carpet where the hole is and slide the steel conduit fitting through the hole from the engine side of the firewall. Secure the steel conduit fitting with the nuts and washers provided. This should protrude through the firewall as little as possible into the car.(Fig B)

**Tip:** If the area where you have drilled the hole for the black cable conduit is congested, put a small dab of silicone (RTV) between the nut and the washer to keep the parts from falling off during installation.

**Step 4 At the front (near center) of your towed vehicle, select a location for securing the front end of the Ready Brake black internal cable conduit with the provided nylon fitting.** In order to alleviate any slippage of the black conduit, we have added a white nylon fitting to be placed at the front of the towed vehicle.

A. If the fitting can be mounted by pushing it through a 3/8" drilled hole in the bumper, baseplate mount or cross member, use the nylon nut that is supplied to hold the fitting in place.(Ex.#1 pg. 4) Or the fitting may be mounted using the clamp provided by placing the clamp around the threaded part of the fitting and bolting to a flat surface of the bumper, cross member or baseplate bracket (as shown in Ex. #2, page 4).

B. Cut the black conduit approximately 3/4" short of the place that you have selected to connect it at the front of the of the towed vehicle. (A cut-off wheel like a Dremel tool works well for this)

- C. Run about 12" of aircraft cable through the nylon fitting and into the black conduit to get started. (If you don't get it started in this manner it will be difficult to put it through the nylon fitting once the fitting is on the conduit.)
- D. Push the nylon fitting over the cut end of the black conduit, then thread the cable through the black conduit.

**Step 5. Attaching the aircraft cable to your towed vehicle's brake pedal.**

- A. Place the black brake tie on the bottom of the brake pedal arm. Thread the aircraft cable through the small hole of the bottom piece of the brake tie. Loop it around the brake pedal arm then back through the second small hole on the right.(Fig C)
- B. Put the top piece of the brake tie on the front of the brake arm.
- C. Using the 1/4" x 2 1/4" bolts, nuts and lock washers lock the brake tie tightly around the brake pedal arm.(Fig C) Keep in mind if you are working on a vehicle with adjustable pedals to place pedals in highest position. Always tow with pedals in the highest position.
- D. Trim excess aircraft cable from the bottom of the brake tie.

**Note:** The brake tie and cap screws provided fit the brake arm on most vehicles. (You may need a longer bolt), If you experience any difficulty, please call N.S.A. RV Products at 1-800-933-3372.

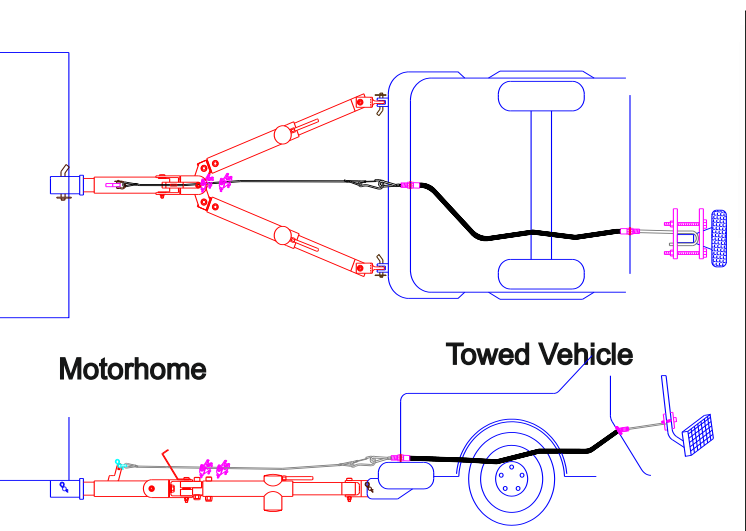

**Maintenance**

The only maintenance needed on this tow bar is wipe down the legs with a dry rag once a month or needed usage.

**How to Install Clevis Connectors on a Ready Brute Elite II Tow Bar**

After removing the tow bar from the box you will see the end of the legs have an clevis adapter with no clevises attached (Fig A). This clevis adapter should be installed loosely enough to freely twist while still being firmly attached. After checking the clevis adapters and confirming it has been installed correctly remove the bolt on the end and install the clevises(Fig B) to the end of the clevis adapters. Clevises are what are used to install the tow bar onto the baseplate. We have these available in Blue Ox - Demco & Roadmaster (These items are not sold with the tow bar they are a separate item)

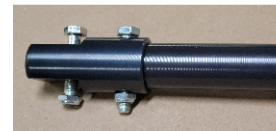

(Fig A)

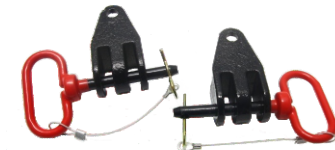

(Fig B)

With 2 3/4" wrench's take the 1/2" bolt out of the endcap. Once the 1/2" bolt is out, slide (Fig A) a clevis onto the endcap and reinsert the 1/2" bolt through the endcap and the clevis. Now put the nylock nut on the bottom of the clevis and tighten the nut down snug with both 3/4" wrench's.



Repeat this process for the other leg and you are ready to tow.

## SAFETY CABLE INSTALLATION:

### **SAFETY CABLES MUST CONNECT THE TOWING VEHICLE TO THE TOWED VEHICLE FRAME TO FRAME. DO NOT USE DAMAGED CABLES!**

1. Using the cable hooks, attach the cables to a solid part of the chassis of the towed vehicle.
2. Wrap each cable once around their respective tow bar leg.
3. Using the cable hooks, attach the opposite ends of the cables to a solid part of the RV's chassis. The preferred method would be to criss cross the cables. For example: Left side of car to right side of RV.
4. When attaching the safety cables it is important to allow enough slack for towbar & towed vehicle's turning radius. It is equally important that the safety cables not be allowed to drag or touch the ground. If this happens, the cables may become damaged and ineffective.
5. Be sure each cable used has the proper length and load rating for the towbar being used.

**\*\*Please Note:** Some vehicles have double-wall or uni-body frame boxes at the point you need to run conduit through the floorboard (Ford-Windstar, Honda-CRV, Etc.). If so, you may be able to go 2-3" in either direction and find only one thickness of floorboard. The easiest way to hook the brake pedal to the aircraft cable is to remove the brake pedal pad (rubber part) and drill a small hole for the cable to go through. Drill a second hole near the brake arm. Pull the cable from the firewall through the hole of the pedal and go across the face of the pedal and push it back through the pedal. Hook to the arm as described in step 5. Then replace pedal pad.

## **Adjusting The Ready Brake**

### **Step 1. Prepare your motor home and towed vehicle for towing.**

- A. Hook the tow vehicle to the motor home as normal. Make sure the vehicles are aligned straight (IMPORTANT) and the tow bar, chains, lights, etc. are connected properly.

### **Step 2. Make sure your towed vehicle's brakes are in an idle position.**

Do not apply pressure to the towed vehicle's brake pedal when you are adjusting the aircraft cable sling that drapes across the tow bar by pulling on the cable.

- A. Fig D #1 This side attaches to the black actuator arm on the Ready Brake. #2 attaches to the loop sticking out of the front bumper. Keep in mind this sling moves so do not allow #3 to come in contact with the tow bar black stow strap. (Fig #13 page 11)

- ### **Step 3.**
- Using an 8mm hex wrench, tighten the two nuts on the cable clamp so that the wire sling length is no longer adjustable. Make sure one clamp is up against the aluminum sleeve and against thimble on one end.

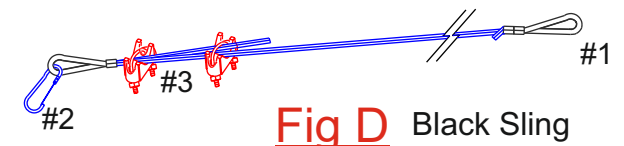
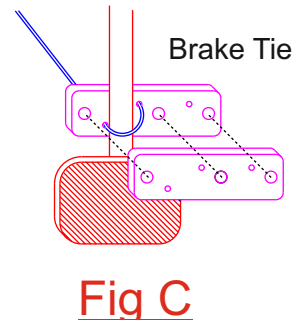



- B. A good way to check your adjustment is to lift up on the cable at the center and see how far it will raise before movement can be seen on the car's side of the cable. There should be about 2 or 3 inches of movement.
- C. After the cable clamp has been tightened, make sure that towed vehicle's brake lights remain off. If the lights are lit, loosen the cable clamp and slacken the cable, again tighten the cable clamp and check the towed vehicle's brake lights. When the adjustment is completed, the brake lights will remain off.  
**Note:** some brake light switches are very sensitive.
- D. The black conduit, when properly installed, should work easily. The cable should go in and out freely when the brake pedal is stepped on.
- E. If desired, connect a bungee cord from the brake pedal to the seat frame while towing. This will allow for added return pull on the brake pedal.

### Installing Ready Brute Elite II Tow bar

1. Place the Ready Brake drawbar portion into the receiver tube on the RV and secure it with a standard 5/8" cross pin. The drawbar is designed to fit in a 6" depth receiver. If yours is 5" it is ok to cut 1" length off the end of the drawbar.
2. The actuator arm on the Ready Brake can travel 3 1/2" towards the bumper on the RV so allow for clearance.
3. **Hooking to the towed vehicle's baseplate**
  - A. Position legs of tow bar out and down in a V position with legs not extended.
  - B. Pull car close enough to connect tow bar to baseplate.
  - C. Grab a clevis and connect it directly to the baseplate using the provided red handled pin and hair pin cotter in the clevis. Repeat this for the other tow bar leg.
  - D. Pull T-Handle up extend inside pull rod and hook to baseplate. Do this for both legs.
  - E. Pull forward in RV to extend and lock legs in the travel position.
  - F. **If only one leg extends out drive motor home forward slowly and turn in direction of leg that needs to lock. (Example: Right leg needs to lock - turn right) \*Always tow with the legs fully extended.**



- G. Always make sure the legs are extended out for towing.
- H. After the legs are extended and locked you can hook up the sling cable for the ReadyBrake. Do not do this until the T-Handle pins are down and locked in.

### UNHOOKING AND STOWING

1. Park the RV with vehicle in tow in a straight line on a flat level surface to ensure minimum pressure is exerted on the tow bar legs. This will aid in the removal of the baseplate pins. Engage the motorhome parking brake. Put the towed vehicle in park for automatic transmissions or securely in first gear for manual transmissions. Disconnect the safety cables, adjustable sling cable, and lighting completely.
2. Tow bar- Pull the T-Handle up to relieve any pressure on the tow bar. Next remove clevis pins from the baseplate on the towed vehicle. Now collapse the legs.
3. To stow tow bar lift legs up and put the 3/8" red handle in the stow hole. (Fig E)
4. Keep the tow bar covered when not in use. NSA- Ready Brute tow bar cover is recommended. This will cut down on the dirt build up on the tow bar.



**IMPORTANT: DO NOT TOW IF TOWBAR IS OVER 2 INCHES FROM LEVEL IN EITHER DIRECTION. IF THE TOWBAR IS MORE THAN 2 INCHES OFF LEVEL WE SUGGEST USING A RECEIVER DROP OR RISER TO LEVEL IT.**