

ASSEMBLY INSTRUCTIONS

PLATINUM SERIES

WALL MOUNTED CABLE TOWER

SKU: CPL-SCT-1102

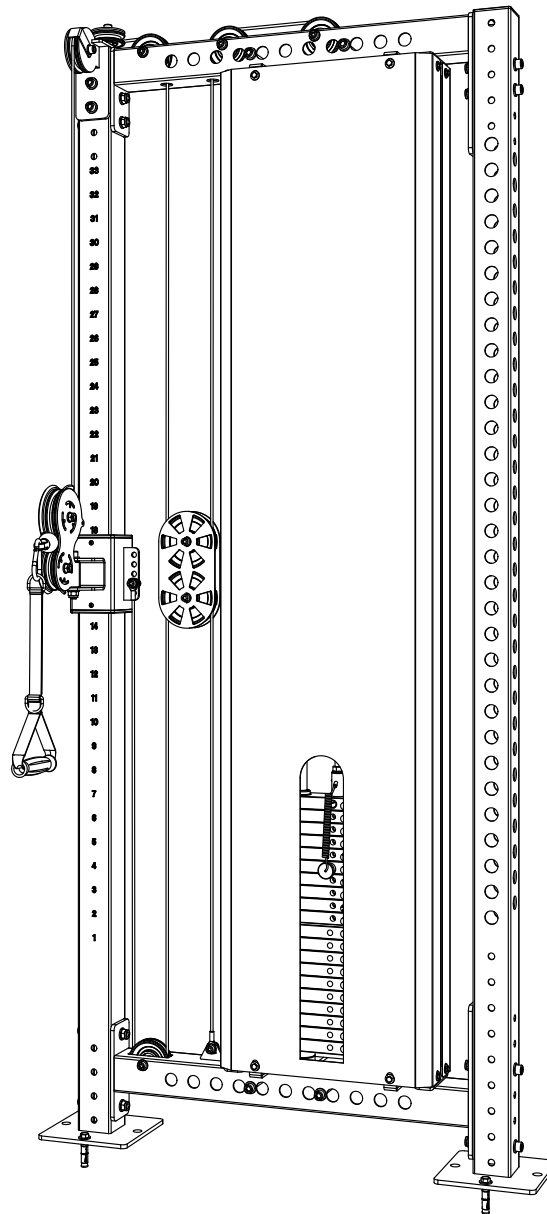

CAUTION: Read all precautions and instructions before using this equipment. Save this manual for future reference.

COMPOUND
FITNESS EQUIPMENT

CONTENTS

02 General warnings and maintenance advice

03-10 Assembly Instructions

Explained as a series of steps, with each step containing:

- Pictures, descriptions and quantities of the parts required
- Notes
- Diagram showing how the parts fit together

11 Part List

Assembly Instructions

Before Your Begin

This exercise equipment is built for optimum safety. Be sure to read the entire manual before you assemble or operate your equipment. Please note the following safety precautions:

1. Keep children and pets away from the equipment at all times. Do not leave children unattended in the same room with the equipment.
2. Only one person at a time should use the equipment.
3. If the user experiences dizziness, nausea, chest pain, or any other abnormal symptoms STOP the workout at once. CONSULT A PHYSICIAN IMMEDIATELY.
4. Position the equipment on a clear, level surface. DO NOT use the equipment near water or outdoors.
5. Keep hands away from all moving parts.
6. Always wear appropriate workout clothing when exercising. DO NOT wear robes or other clothing that could become caught in the equipment.
7. Use the equipment only for its intended use as described in this manual. DO NOT use attachments not recommended by the manufacturer.
8. Before using the equipment, always do stretching exercises to properly warm up.
9. Never operate the equipment if the equipment is not functioning properly.

To Apply Thread Locker

The Fasteners marked by the sign  in the following assembling steps need to be bonded to prevent loosening, or the fasteners are a type of thread locking screws.

How to use

1. Degrease and clean surfaces prior to apply adhesive.
2. For through hole , insert bolt and apply adhesive to the exposed thread. Assemble nut and tighten to the correct torque (FIG 1).
3. Apply several drops of adhesive down the sides of the blind hole filling the lower third. Apply several drops to the bolt, Assemble and tighten (FIG 2).

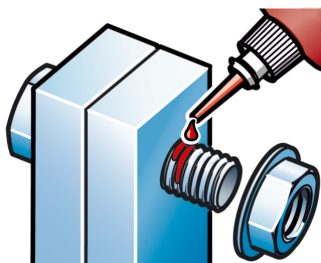

FIG 1

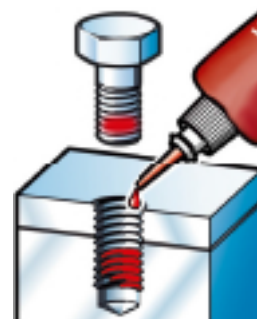
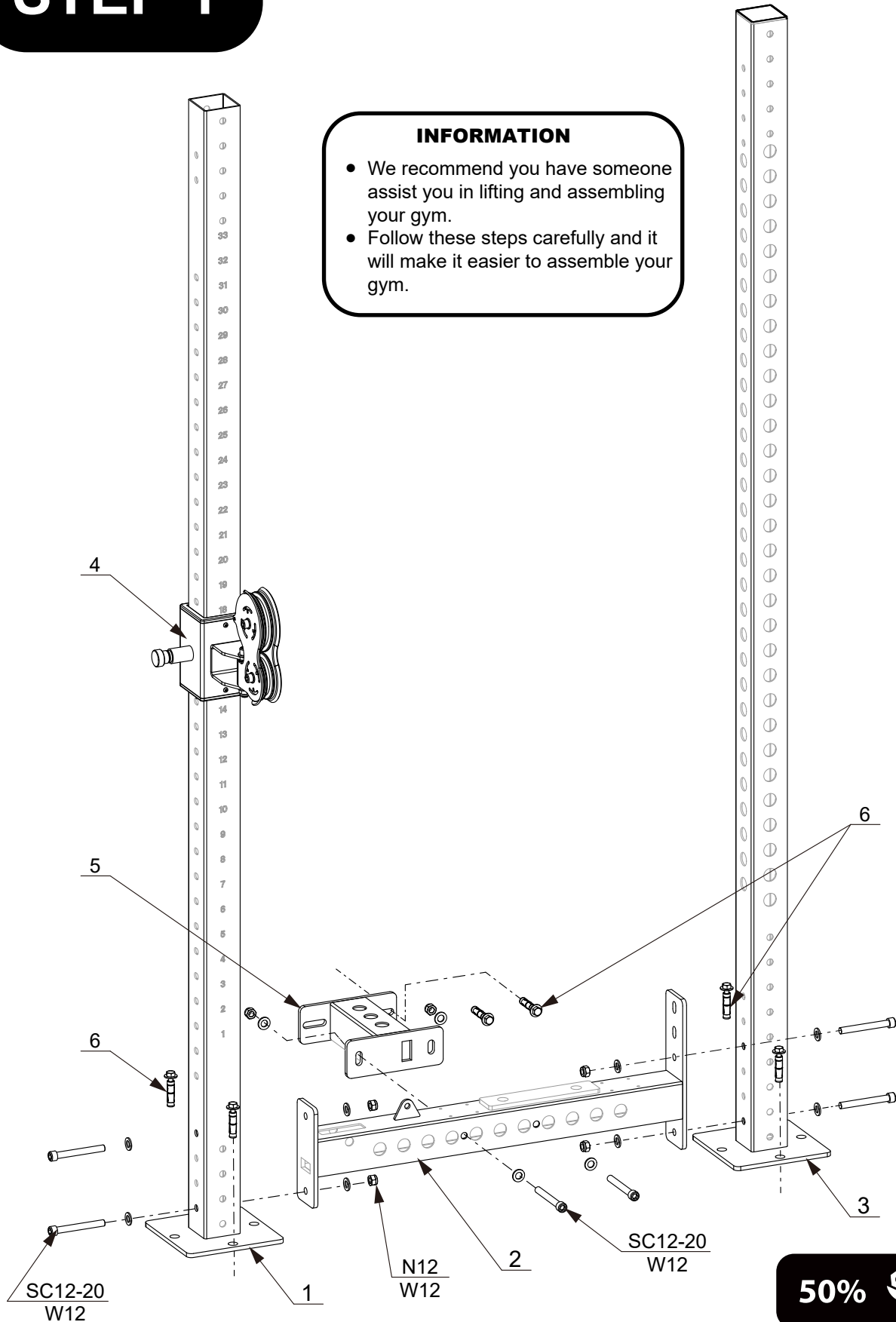

FIG 2

STEP 1

INFORMATION

- We recommend you have someone assist you in lifting and assembling your gym.
- Follow these steps carefully and it will make it easier to assemble your gym.



STEP 2

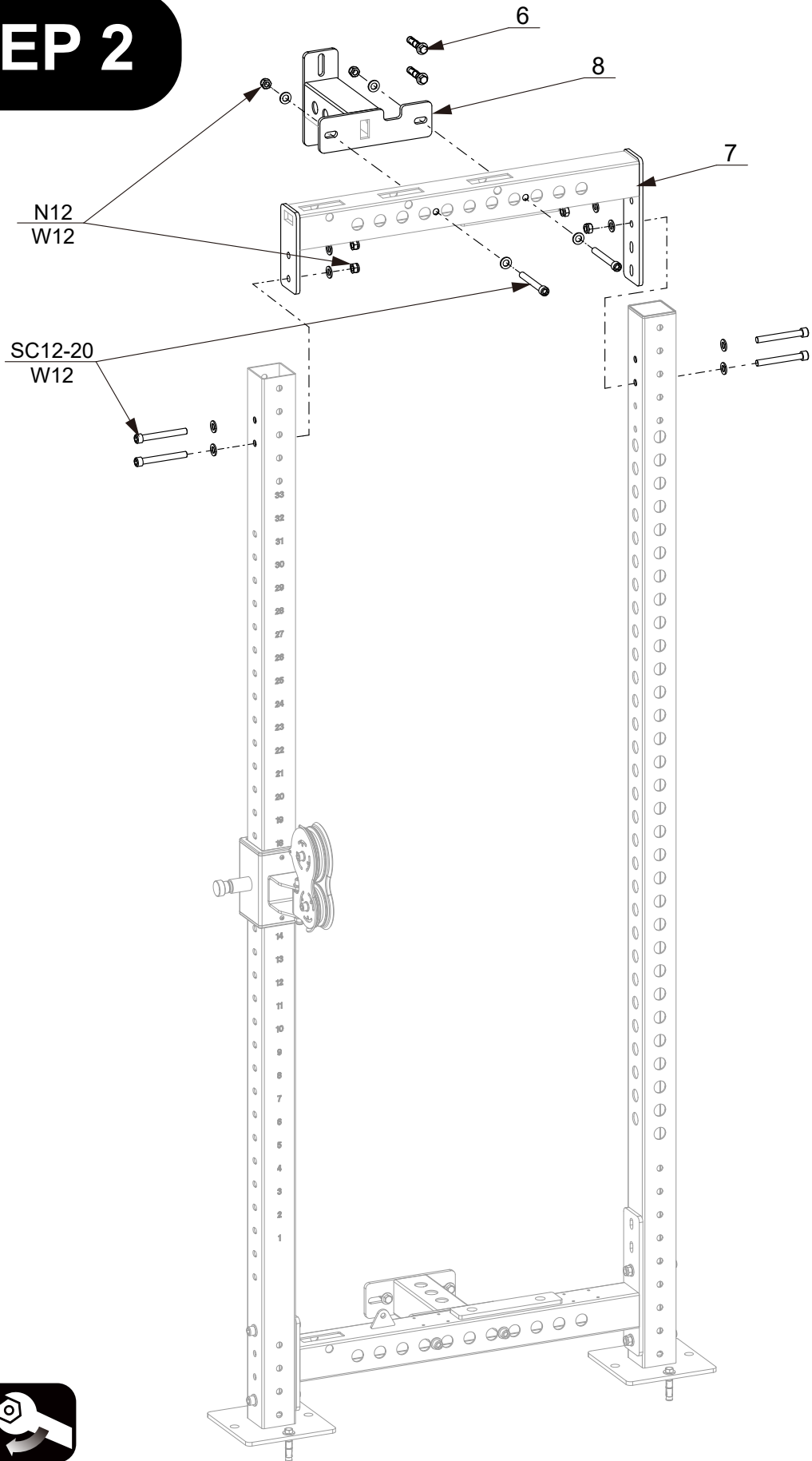

50%



STEP 3

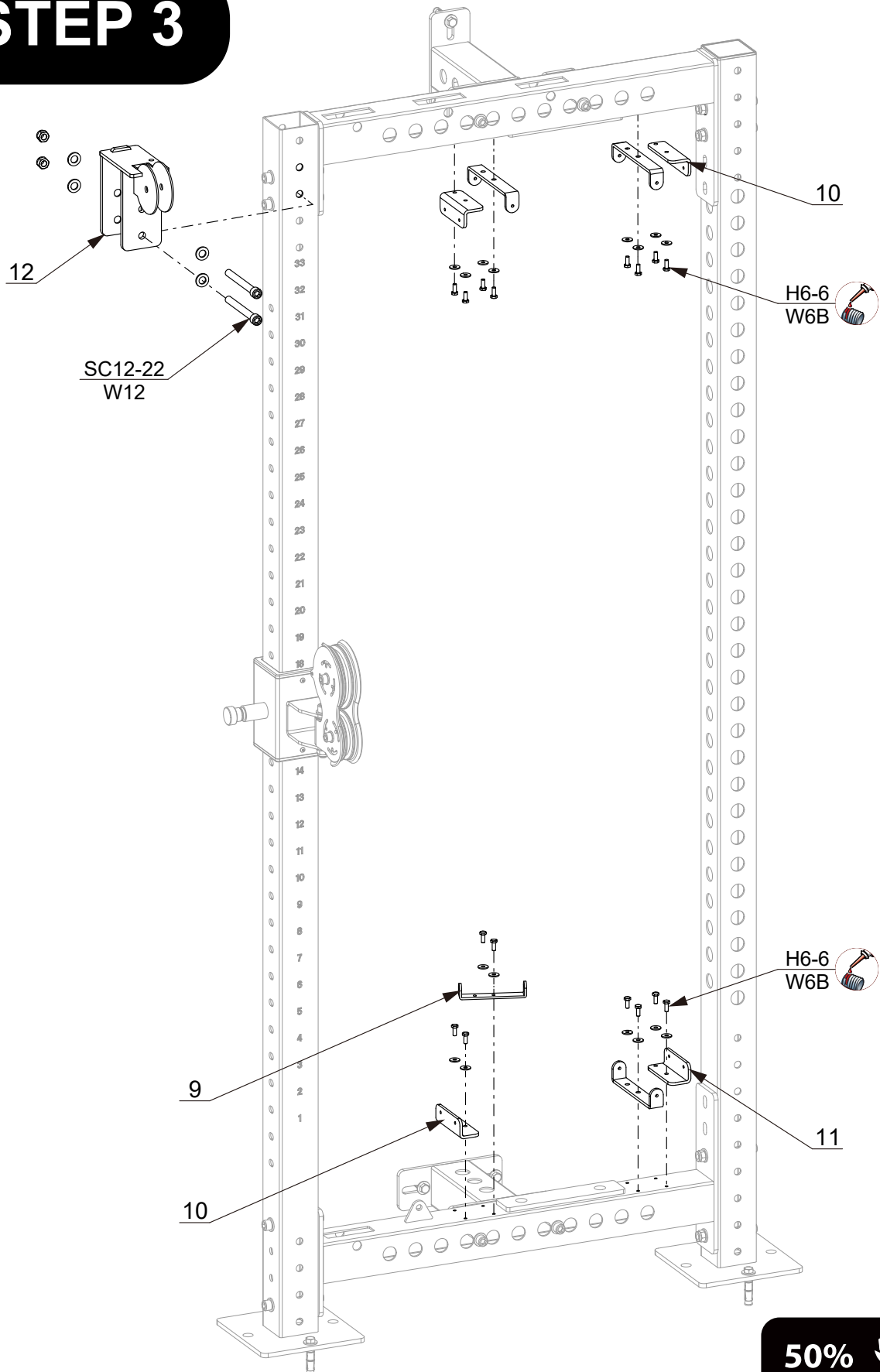

STEP 4

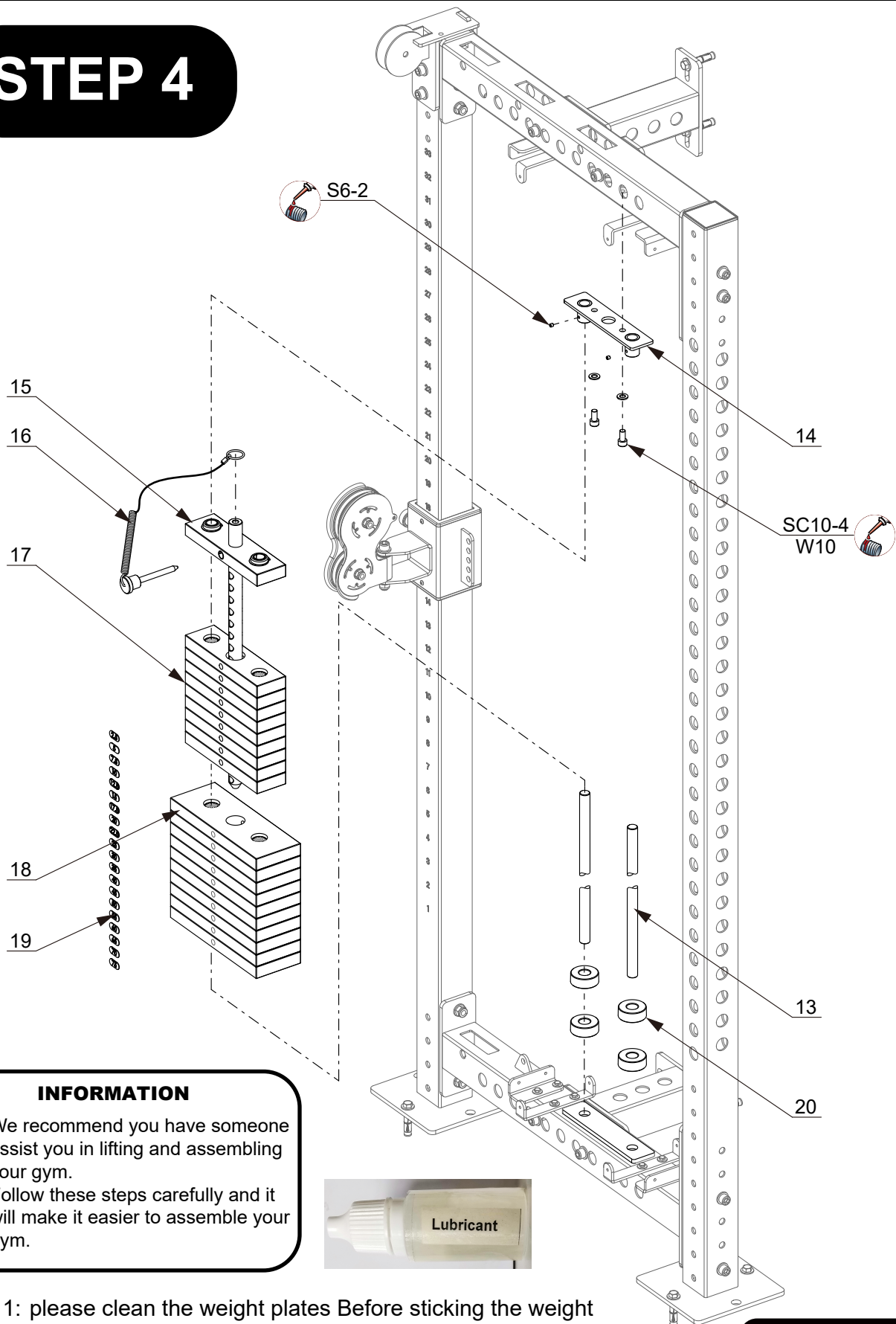

INFORMATION

- We recommend you have someone assist you in lifting and assembling your gym.
- Follow these steps carefully and it will make it easier to assemble your gym.

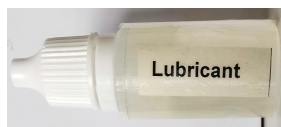

Note 1: please clean the weight plates Before sticking the weight labels , and avoid touching the adhesive of the sticker.

Note 2: If the movement of the weight stack is not smooth during exercising, please lubricate the guide rods.

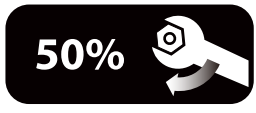

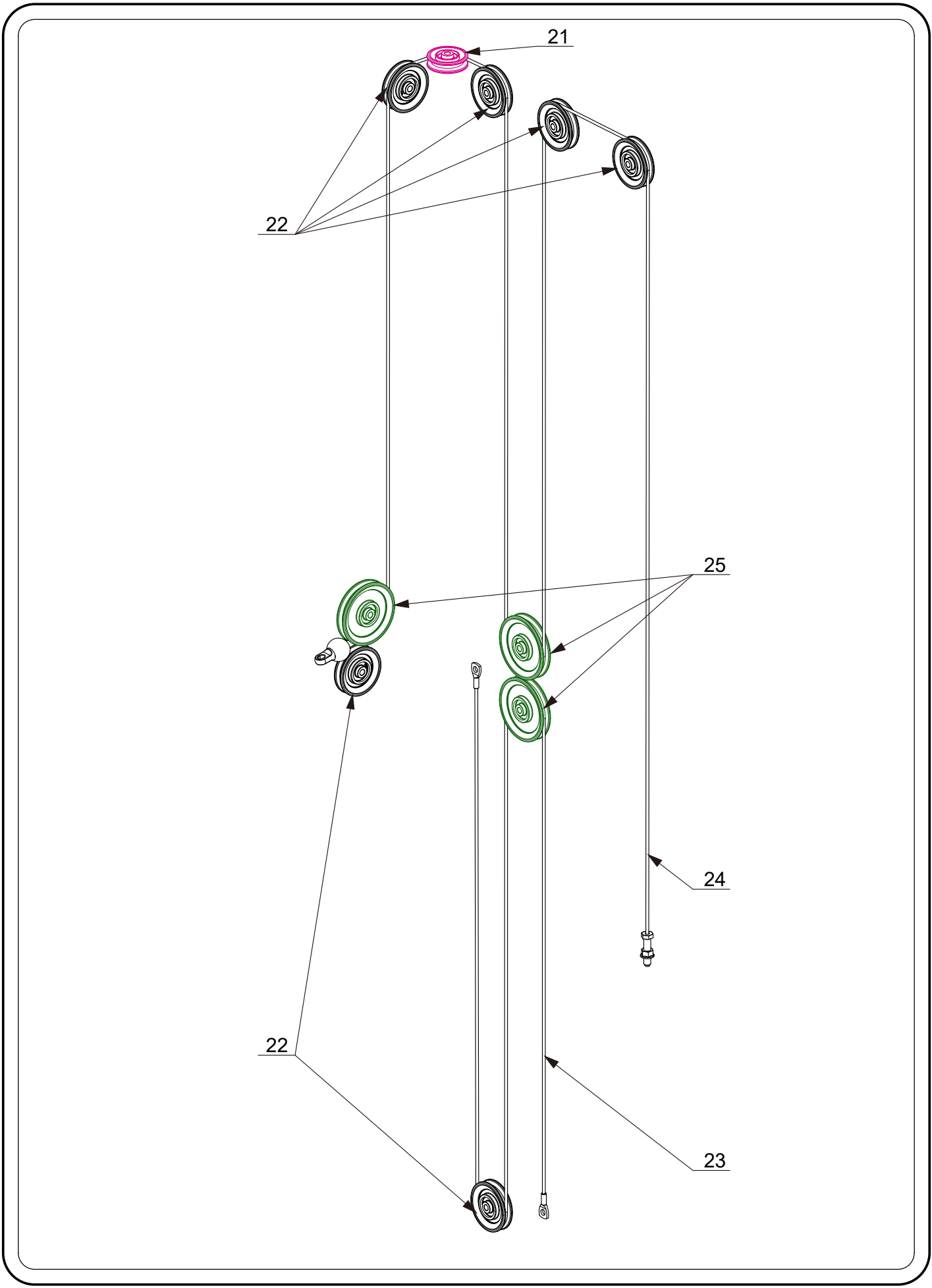

STEP 5

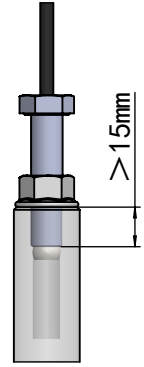
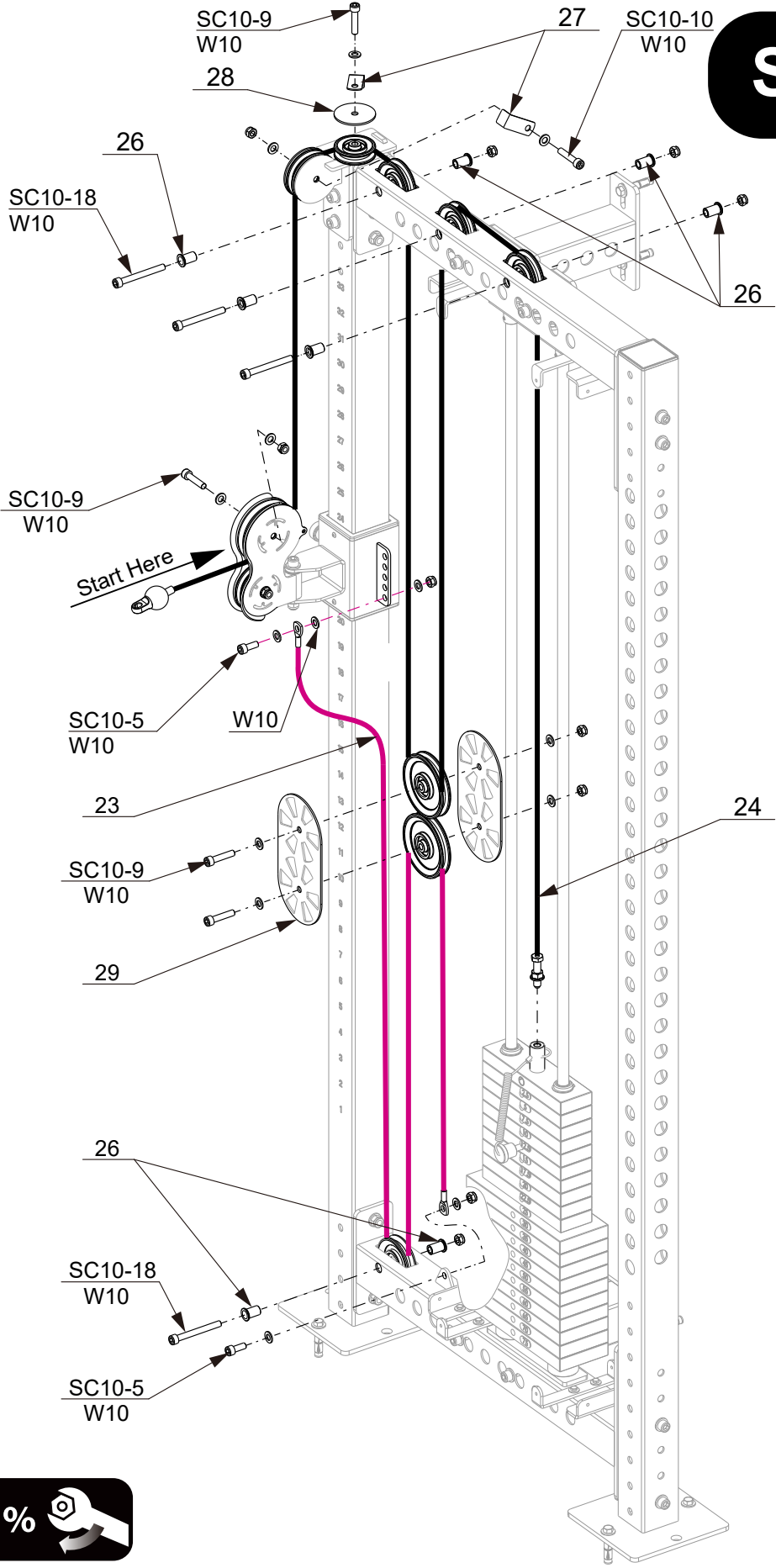

STEP 6

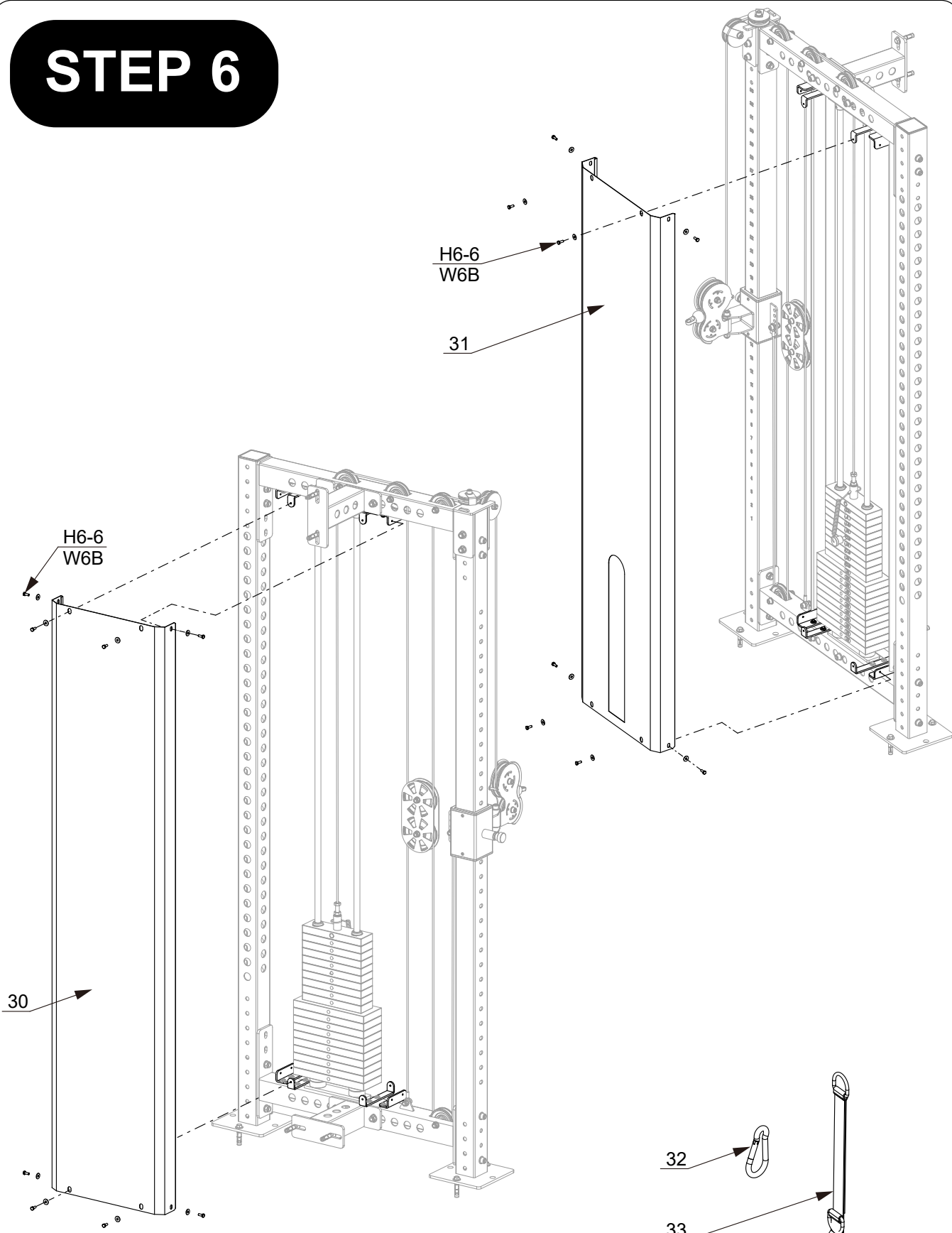

Note : After assembling the equipment, please check and tighten all the fasteners including the screws on the handle.

PARTS LIST⁶

PART#	DESCRIPTION	QTY
1	Left Upright	1
2	Bottom Tube	1
3	Right Upright	1
4	Pulley Carriage	1
5	Bottom Connection Tube	1
6	Expansion Anchor Bolt	8
7	Top Tube	1
8	Top Connection Tube	1
9	U Plate	4
10	Connection L Plate	2
11	Connection L Plate	2
12	Pulley Support	1
13	Guide Rod	2
14	Rod Retainer	1
15	Top Weight Plate	1
16	Weight Pin	1
17	Weight Plate 2.5 Kg	9
18	Weight Plate 5 Kg	10
19	Weight Label	1
20	Rubber Buffer	4
21	Pulley OD 70	1
22	Pulley OD 89	6
23	Lower Cable	1
24	Upper Cable	1
25	Pulley OD 114	3
26	Spacer TL 27	8
27	Limit Plate	2
28	Pulley Cover	1
29	Double Pulley Plate	2
30	Back Shield	1
31	Front Shield	1
32	Carabiner	1
33	Strap Handle	1
H6-6	Hex Head Bolt M6×15	32
N10	Lock Nut M10	10
N12	Lock Nut M12	14
S6-2	Socket Set Screw M6 × 6	2
SC10-4	Socket Head Cap Screw M10 × 20	2
SC10-5	Socket Head Cap Screw M10 × 25	2
SC10-9	Socket Head Cap Screw M10 × 45	4
SC10-10	Socket Head Cap Screw M10 × 50	1
SC10-18	Socket Head Cap Screw M10 × 90	4
SC12-20	Socket Head Cap Screw M12 × 100	12
SC12-22	Socket Head Cap Screw M12 × 110	2
W6B	Big Washer M6	32
W10	Washer 10	15
W12	Washer 12	28