



# PROVAC

## SALES

PHONE: 831-462-8900

FAX: 831-462-3536

WWW.PROVAC.COM

# Edwards iGX-100, 600, 1000

## Technical Specifications

	iGX	100	600	1000
<b>Performance</b>				
Peak speed	m <sup>3</sup> h <sup>-1</sup>	105	620	800
	cfm	62	365	471
	l min <sup>-1</sup>	1750	10333	13333
Ultimate pressure	mbar	5.00E <sup>-03</sup>	7.00E <sup>-04</sup>	1.00E <sup>-03</sup>
	torr	3.75E <sup>-03</sup>	5.25E <sup>-04</sup>	7.50E <sup>-04</sup>
	Pa	0.50	0.07	0.10
<b>Power at 700 torr exhaust</b>				
Ultimate	kW	1.0	1.6	1.6
Green Mode	kW	0.05	0.05	0.05
<b>Water*</b>				
Water flow	slm	1.0	2.0	2.0
<b>Nitrogen</b>				
L variant	slm	0	0	N/A
N variant	slm	4 to 39	4 to 39	4 to 39
M variant	slm	4 to 44	4 to 44	N/A
<b>Installation details</b>				
Footprint (excl. exhaust)	m <sup>2</sup>	0.195	0.195	0.195
Weight	Kg	120	220	230
Inlet connection		ISO63	ISO100	ISO100
Outlet connection		NW25	NW25	NW25
Noise at ultimate	dB(A)	<55	<55	<55

\* Flow with optional Constant Water Flow Valve fitted



# PROVAC

## SALES

PHONE: 831-462-8900

FAX: 831-462-3536

WWW.PROVAC.COM

# Edwards iGX-100, 600, 1000 Pumping Curves

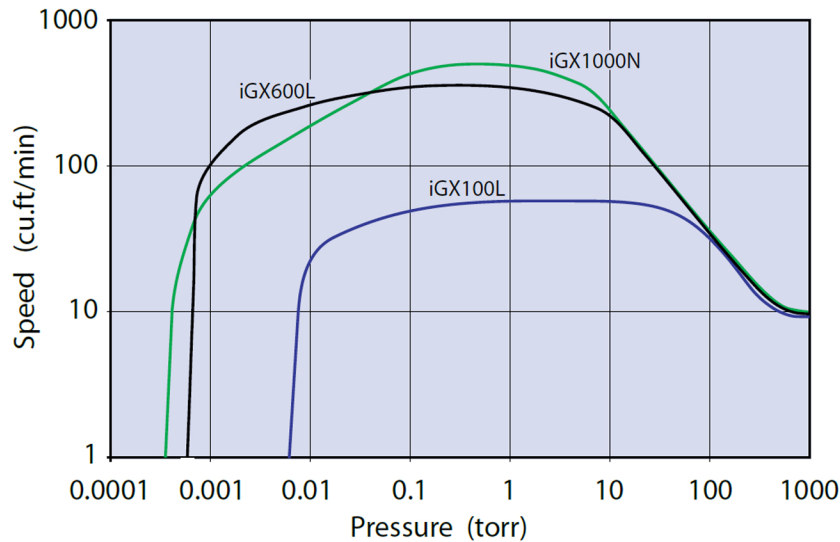

## Dimensions

iGX 600, 1000 Side View

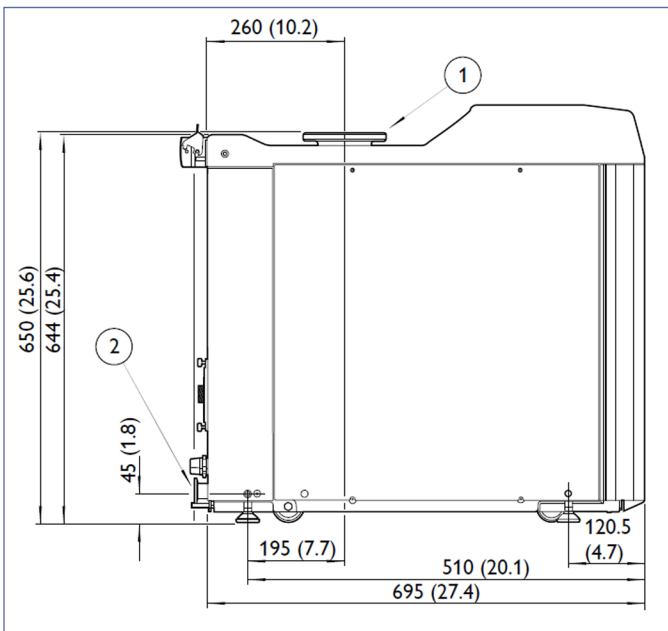

1 Inlet Flange

2 Exhaust Flange

iGX100 Side View

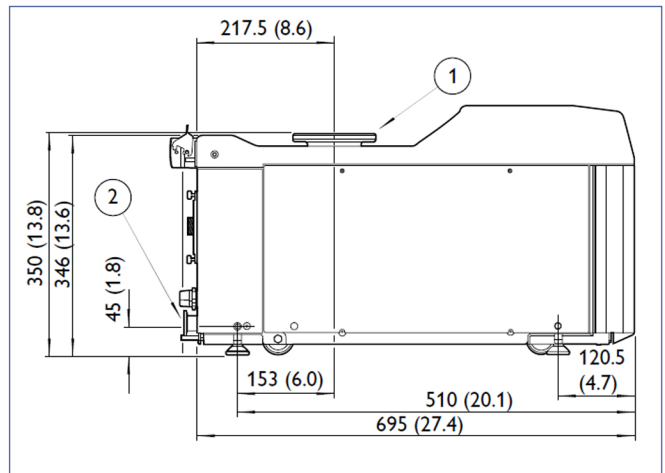

iGX Top View

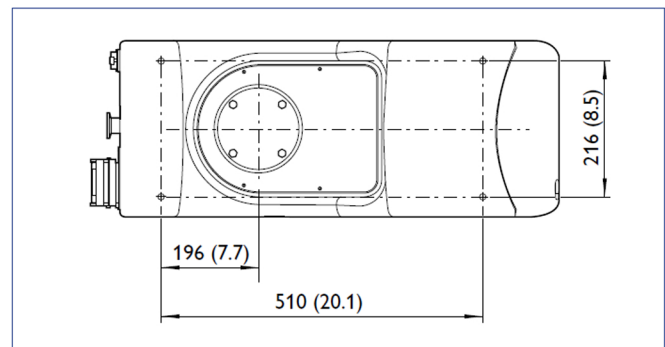



# PROVAC

## S A L E S

PHONE: 831-462-8900

FAX: 831-462-3536

WWW.PROVAC.COM

## Edwards iGX-100, 600, 1000

### Features & Benefits

- zero maintenance between major overhauls
- continuous pumping duty throughout pressure range
- comprehensive set of networking options
- ethernet connectivity allows key data to be viewed via webpages
- modular design allows users to configure pump to suit individual needs
- compact footprint allows on-tool, close proximity & remote installation
- designed for energy efficiency
- high efficient cooling
- low noise & vibration
- low cost of ownership
- precision ceramic bearings

### Applications

- load lock • transfer • metrology • lithography • PVD process • PVD pre-clean • RTA • strip/ashing • oxide etch • silicon etch • metal etch • implant source

