



# Edwards STP-iXA4506C

## Technical Specifications

STP-iXA4506C				
Inlet flange	VG300	ISO320F	VG350	VG400
Backing port size	KF40	KF40	KF40	
Pumping Speed				
N <sub>2</sub>	3800 ls <sup>-1</sup>	4000 ls <sup>-1</sup>	4300 ls <sup>-1</sup>	
H <sub>2</sub>	2700 ls <sup>-1</sup>	2700 ls <sup>-1</sup>	2700 ls <sup>-1</sup>	
Ar	3200 ls <sup>-1</sup>	3400 ls <sup>-1</sup>	3800 ls <sup>-1</sup>	
Compression ratio				
N <sub>2</sub>	>10 <sup>8</sup>	>10 <sup>8</sup>		
H <sub>2</sub>	1 x 10 <sup>3</sup>	1 x 10 <sup>3</sup>		
Ultimate pressure	6.5 x 10 <sup>-6</sup> Pa	10 <sup>-8</sup> Pa		
	5 x 10 <sup>-8</sup> Torr	10 <sup>-10</sup> Torr		
Max working pressure	-			
Allowable backing pressure	266 Pa (2 Torr)			
Rated speed	24240 rpm			
Run-up time to 90% rated speed				
Starting time	≤11 minutes			
Mounting position	Any orientation			
Cooling method	Water cooling			
Lubricating oil	Not necessary			
Backing pump	>1300 lmin <sup>-1</sup>			
Leakage Magnetic Flux				
Axial direction	<100mGauss			
Radial direction	<100mGauss			
Ambient temperature range	0 to 40 °C			
Storage temperature range	-25 to 55°C			
Input voltage	200 to 240 ±10% ACV			
Maximum input power	1700 VA			
Weight	109 kg	111 kg	104 kg	111 kg

\* The maximum gas flow is applicable under conditions that N<sub>2</sub> or Ar gas is pumped continuously with water cooling temperature between 15-25 °C and the backing pump (10,000 lmin<sup>-1</sup> size) is used. It is changed on condition.



# PROVAC

## SALES

PHONE: 831-462-8900

FAX: 831-462-3536

WWW.PROVAC.COM

# Edwards STP-iXA4506C Pumping Curves

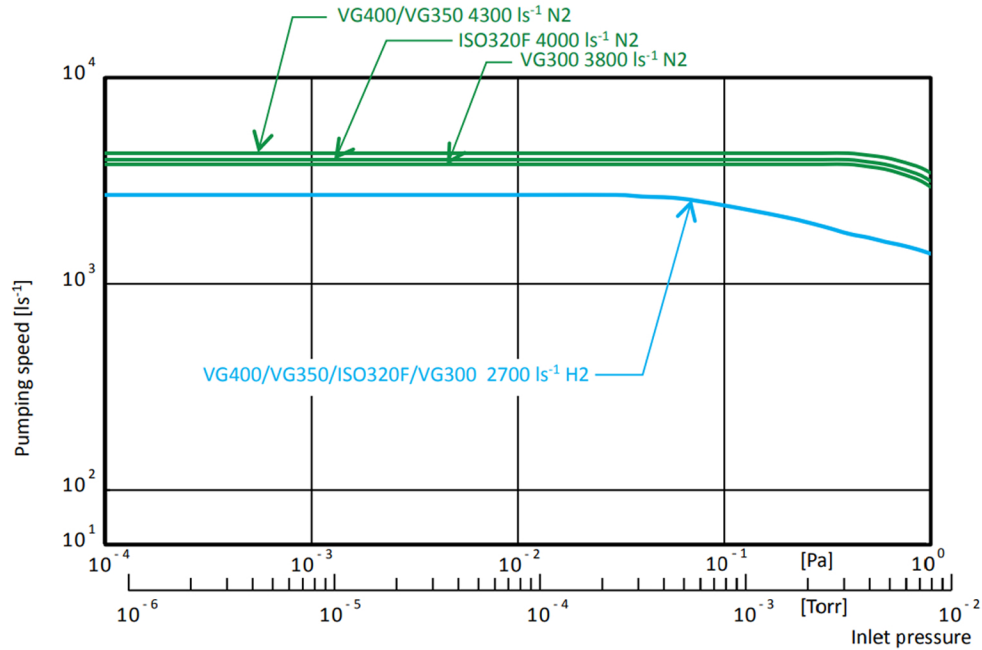

## Dimensions

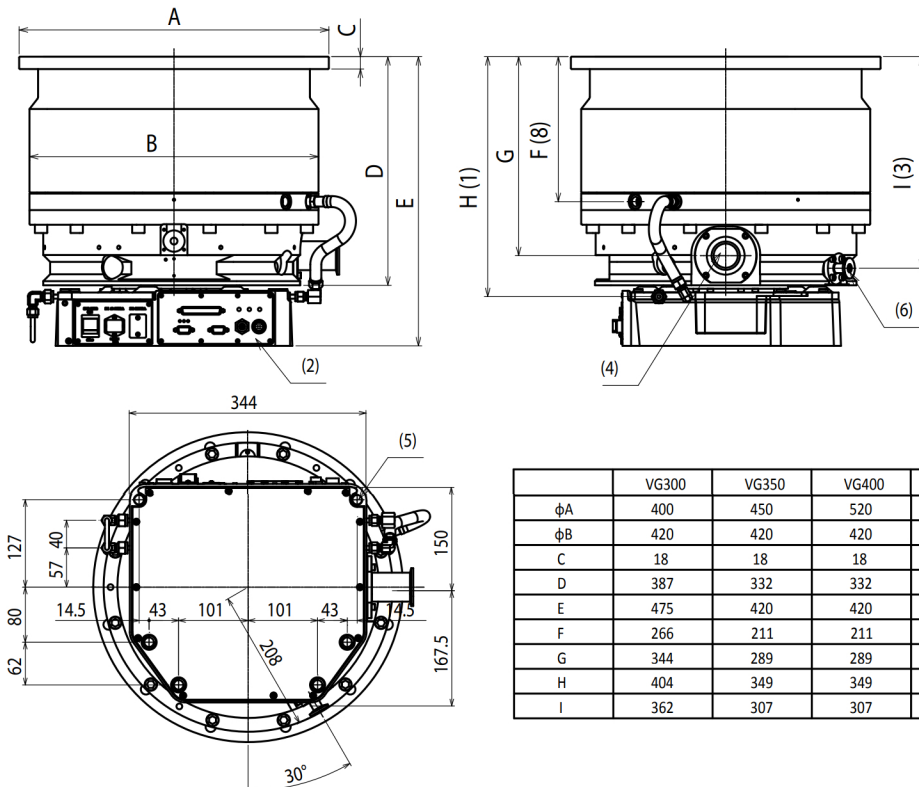



# PROVAC

## SALES

PHONE: 831-462-8900

FAX: 831-462-3536

WWW.PROVAC.COM

## Edwards STP-iXA4506C

### Features & Benefits

- compact design, including fully integrated controller
- innovative, self-sensing magnetic bearing system
- digital 5-axis control
- vibration levels reduced by 50% compared to existing turbos
- can be configured to run corrosive processes
- easy installation, small footprint
- no oil prevents contamination
- improved gas flow capability, high temperature management

### Applications

- semiconductor • LCD etch • glass coating • solar PVD • coating PVD
- high flow applications

