



Seiko Seiki STP-A803, STP-A1303

Technical Specifications

Pump Type		STP-A803C	STP-A1303C	STP-A803CV	STP-A1303CV
TMS unit		Without TMS		With TMS	
Flange size	Inlet port flange	ICF203/VG150 ISO160F	ICF253VG200 ISO200F	ICF203/VG150 ISO160F	ICF253VG200 ISO200F
	Outlet port flange	KF40			
	Purge port flange	KF10			
Pumping speed (L/s) ^{*1} (see chapter 7.1)	N ₂	800	1300	800	1300
	H ₂	520	800	520	800
Compression ratio ^{*1}	N ₂	> 10 ⁸			
	H ₂	10 ³			
Allowable maximum continuous flow rate ^{*1,*2} (sccm)	N ₂	1500		1000	
Ultimate pressure ^{*1,*3}	Pa	10 ⁻⁷ (10 ⁻⁹ Torr) order			
Allowable maximum backing pressure ^{*1}	Pa	270 (2 Torr)			
Enable exhaust gas	Chlorine and Fluorine gas can be used. When you want to use the following gas, please contact Edwards. <ul style="list-style-type: none"> - The gas including alkali metal, but except "Li". - The gas including "Ga", "Hg", "In" and "Sn". - HBr 				
Purge gas flow rate	sccm	20 (see chapter 2.2.2)			
Back pump size	L/min	> 1300			
Rated speed	rpm	32,500 (Allowable speed range: between 16,000 and 32,500)			
Starting time	min	7			
Stopping time	min	8			
Baking temperature	°C	< 120		No baking possible with TMS	
Lubricating oil	Not necessary				
Installation position	Free				
Cooling method	Water cooling			Water cooling controlled by TMS	
TMS temperature setting	°C	-			60
Water Cooling	Flow rate	L/min	2		
	Temperature	°C	5 to 25		
	Pressure	Mpa	< 0.3		
Water cooling fitting	Size	Rc 1/4 (ISO standard)			
	Material	Brass			
Mass	kg	39			
Dimension	mm	See chapter 7.3 Pump Overview Chart			
Ambient air temp. range	°C	0 to 40			
Storage temp. range	°C	-25 to 55			
Connection cable length	m	30 (maximum)			

The data inside above table are the typical measured value. It's not guaranteed performance.

^{*1}: Pumping speed, compression ratio, allowable maximum continuous flow rate, ultimate pressure and allowable maximum backing pressure are measured by Edwards method

^{*2}: Allowable maximum continuous flow rate varies depend on the cooling methods. The pumping speed of 1,300 (L/min) dry pump was used for the measurements.

^{*3}: Ultimate pressure is a value after baking.



Seiko Seiki STP-A803, STP-A1303 Pumping Curves

STP-A803

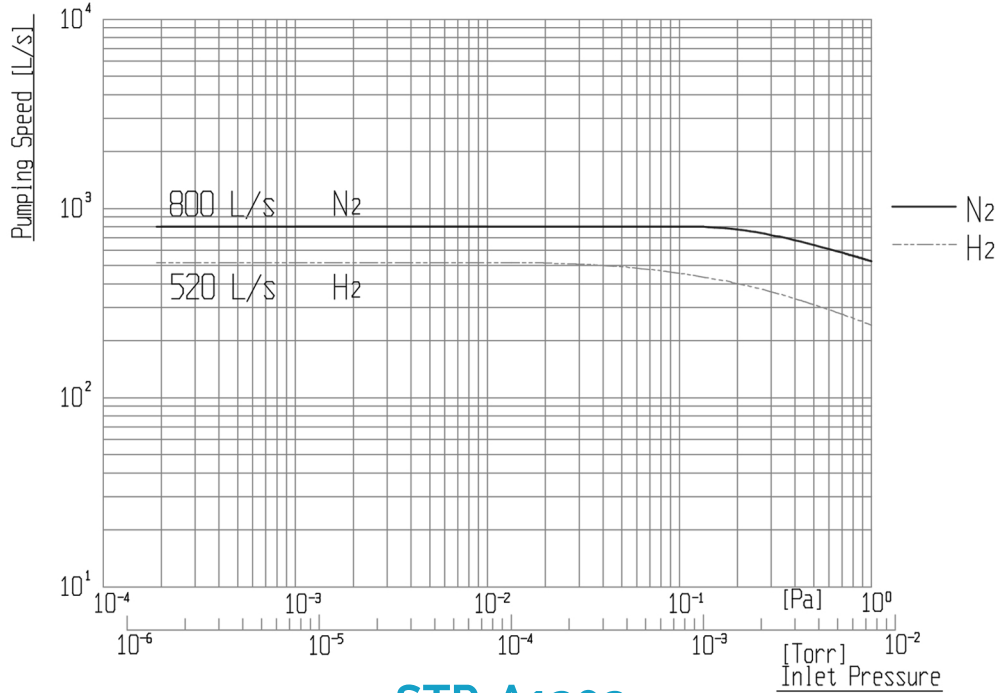

STP-A1303

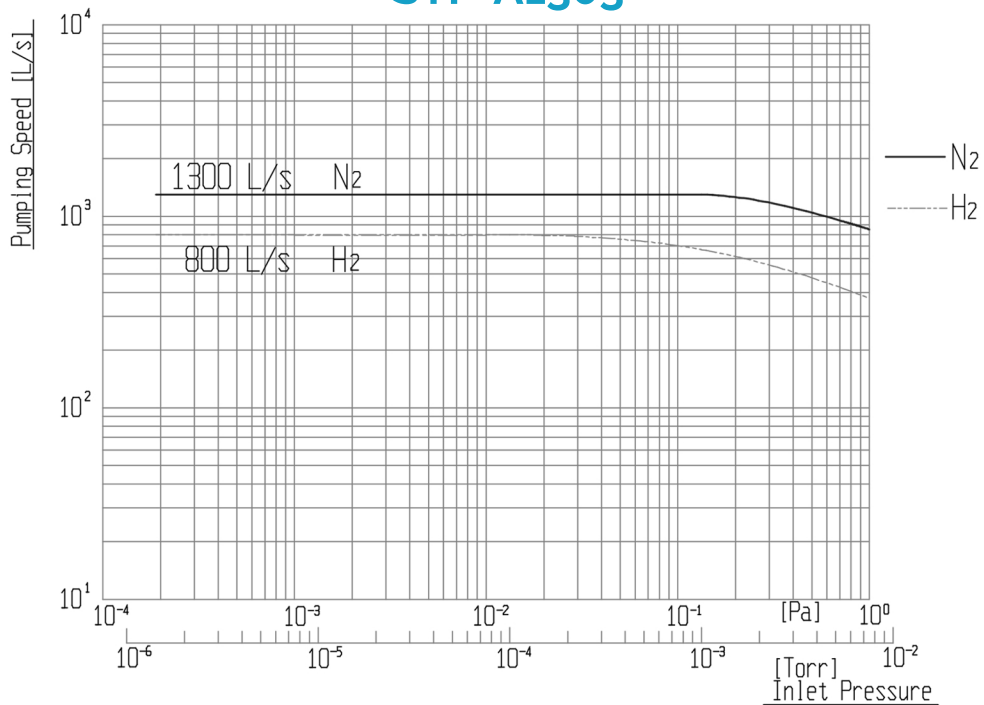



PROVAC

SALES

PHONE: 831-462-8900

FAX: 831-462-3536

WWW.PROVAC.COM

Seiko Seiki STP-A803, STP-A1303 Dimensions

STP-A803

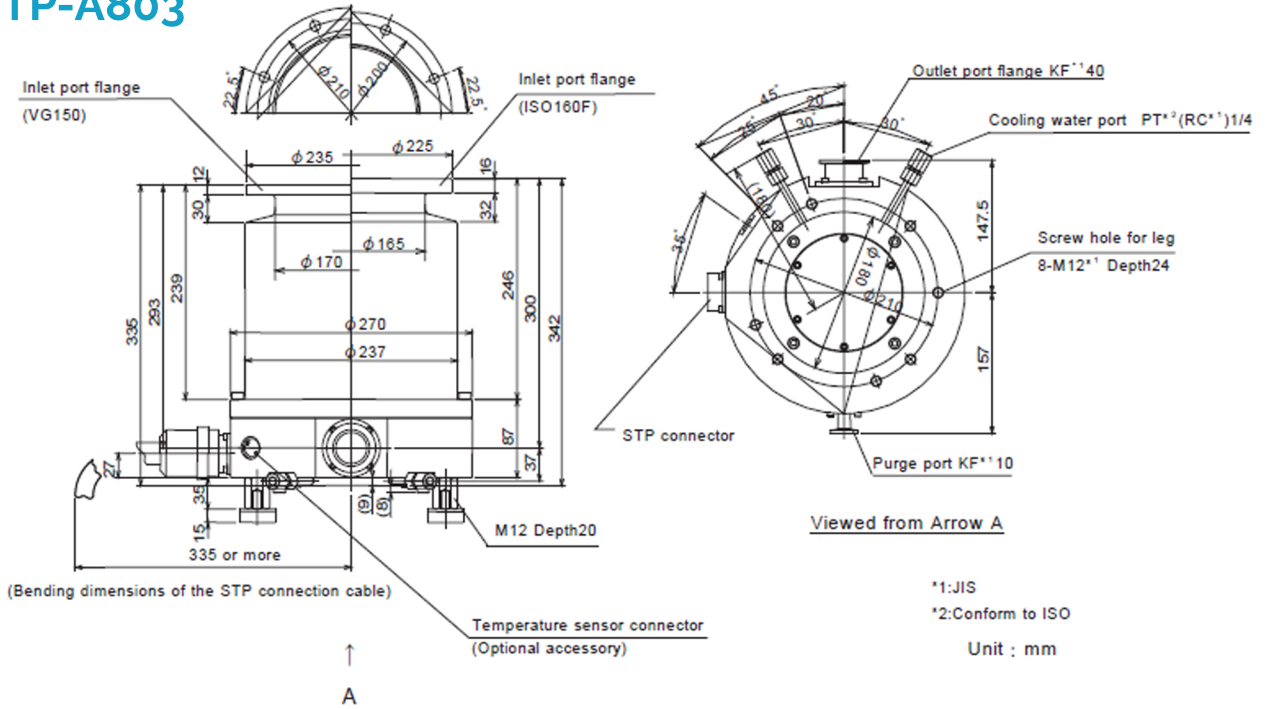

STP-A1303

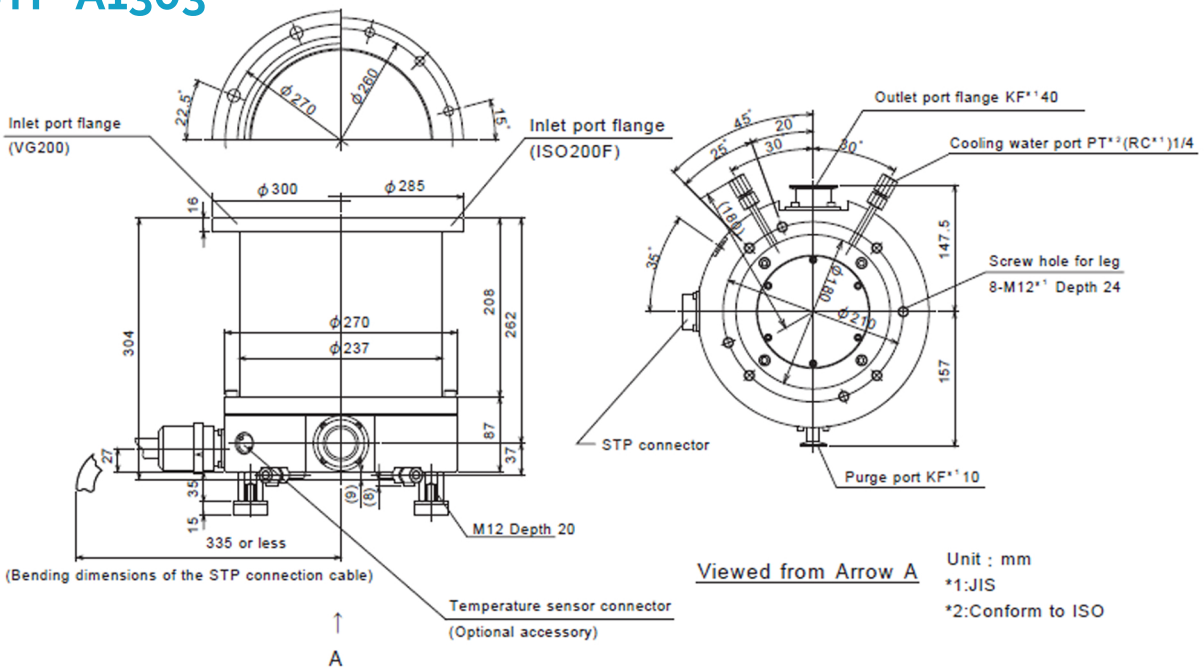



PROVAC

SALES

PHONE: 831-462-8900

FAX: 831-462-3536

WWW.PROVAC.COM

Seiko Seiki STP-A803, STP-A1303

Features & Benefits

- oil free
- low vibration
- high reliability
- maintenance free
- increased life
- advanced controller design
- compact design
- small footprint
- advanced rotor technology
- maximised process flexibility

Applications

- semiconductor • coating • scientific research & development • LED
- metallurgy • solar • flat panel display • plasma etch for metal • ion implantation source • film deposition • diffusion • load lock chambers
- surface analysis • mass spectrometry • high energy physics

Recommended controller

- controller: SCU-800