



Seiko Seiki STP-A1603C

Technical Specifications

Inlet flange size	ISO200F	
Pumping speed N ₂ /H ₂	1600/1200	Litres/second
Compression ratio N ₂ /H ₂	>10 ⁸ / 7 x 10 ³	
Ultimate pressure	10 ⁻⁷ (10 ⁻⁹)	Pa (Torr)
Maximum allowable backing pressure	266 (2.0)	Pa (Torr)
Maximum allowable gas flow N ₂	2500 (4.23)	sccm (Pa m ³ /sec)
Rated speed	36000	rpm
Starting time	7	minutes
Maximum inlet flange temperature [‡]	120	°C
Input voltage ± 10%	200-240	AC V
Typical power consumption	1500	VA
Weight, pump/controller	35/9	kg

[‡] with cooling





PROVAC

SALES

PHONE: 831-462-8900

FAX: 831-462-3536

WWW.PROVAC.COM

Seiko Seiki STP-A1603C Pumping Curves

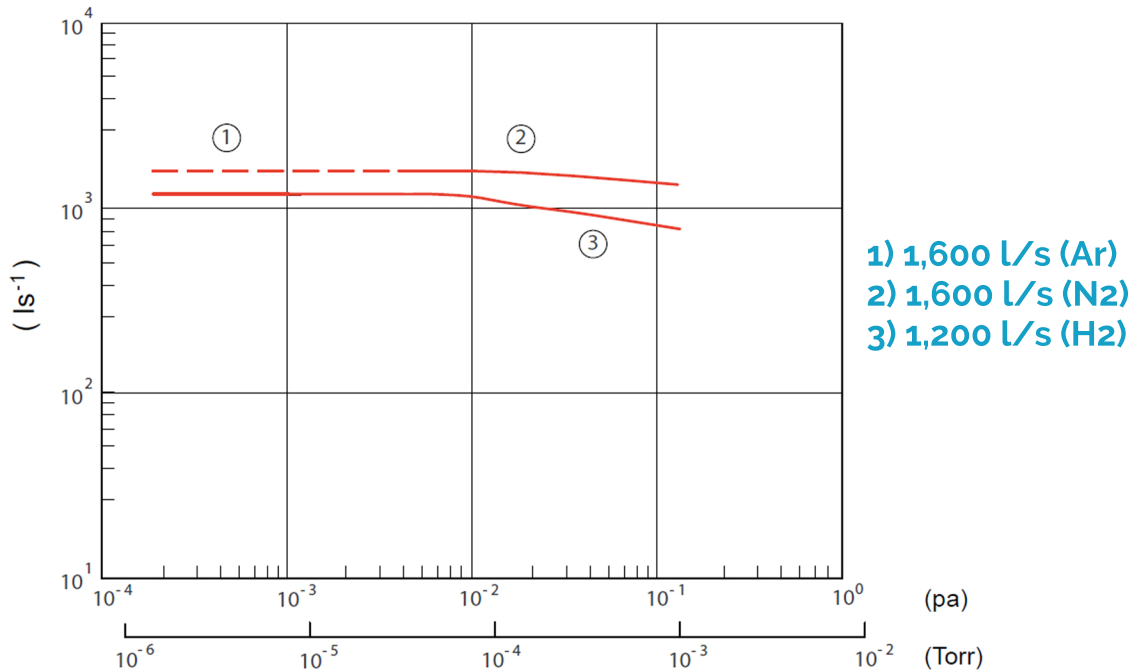

Dimensions

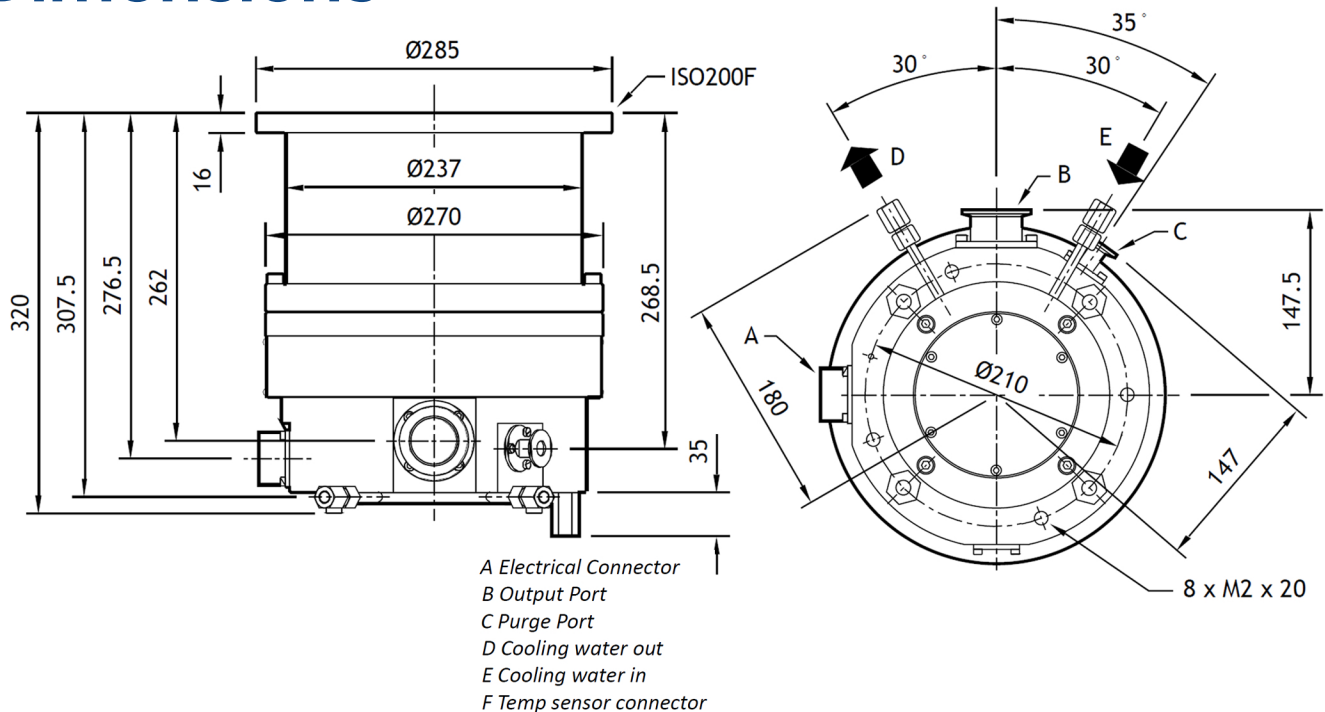



PROVAC

S A L E S

PHONE: 831-462-8900

FAX: 831-462-3536

WWW.PROVAC.COM

Seiko Seiki STP-A1603C

Features & Benefits

- high throughput with maximum reliability
- space saving compact design, small footprint
- corrosion resistant
- 5 axis magnetic suspension system
- low vibration & noise
- zero contamination
- maintenance free
- low cost of ownership
- advanced controller design
- clean, oil-free high vacuum

Applications

- semiconductor • plasma etch • ECR etch • film deposition • sputtering
- ion implantation source • beam line pumping end station • MBE
- diffusion • photo resist stripping • crystal/epitaxial growth • wafer inspection • load lock chambers • surface analysis • mass spectrometry • electron microscopy • high energy physics
- radioactive applications