



# Leybold NT-151/361

## Technical Specifications

Mains voltage ranges, selectable

100/120/220/240 V,  $\pm 10\%$

Mains frequency

50/60 Hz

Power consumption of the TURBOVAC

During acceleration (max. 30 min.)

680 VA

Continuously, max.

480 VA

Briefly (0.5 s)

750 VA

Output for the motor nominal voltage

3 x 42 V<sub>rms</sub>

Current limiting (intermediate circuit current)

5 A

Nominal speed of the TURBOVAC

150/151

50,000 min<sup>-1</sup> = 833 Hz

360/361

45,000 min<sup>-1</sup> = 750 Hz

Max. loading of the relay contacts

50 V AC/4 A, 30 V DC/1 A

Dimensions

1/2 19", 3 HU\*

Weight

8.5 kg

Operating temperature, with sufficient convection

0 - 40°C

Storage temperature

-25°C to +70°C





# PROVAC

## SALES

PHONE: 831-462-8900

FAX: 831-462-3536

WWW.PROVAC.COM

# Leybold NT-151/361

## Dimensions

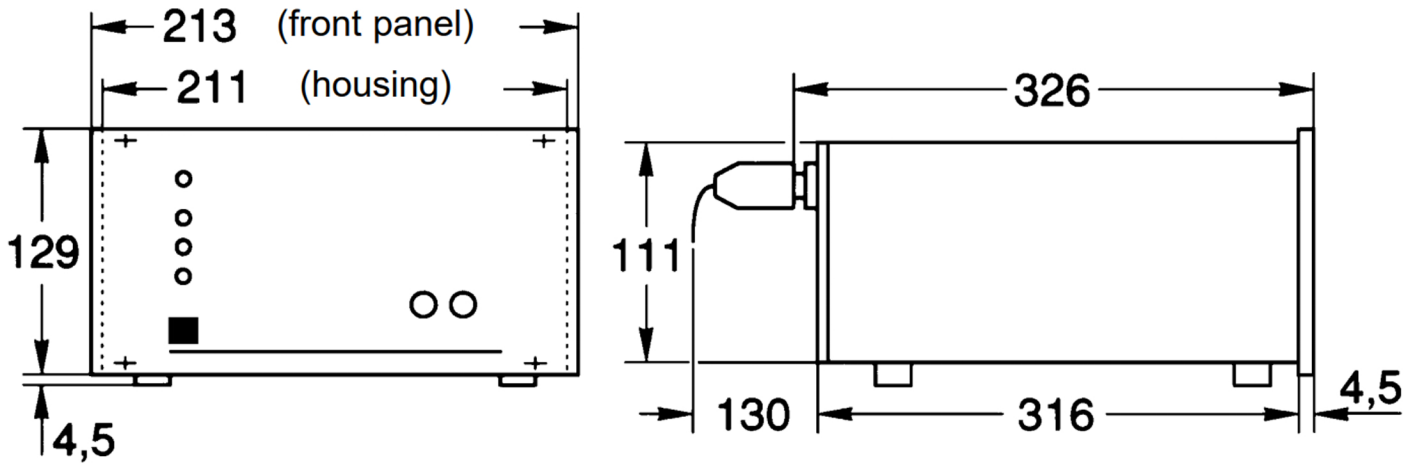

Key to fig. 4

- 1 Plug for the TURBOVAC connection line
- 2 Earth connection
- 3 Mains voltage settings and fuse; see fig. 3
- 4 Terminals for remote control; see fig. 5
- 5 Terminals for relays
- 6 Fuse
- 7 Plug for the mains cable

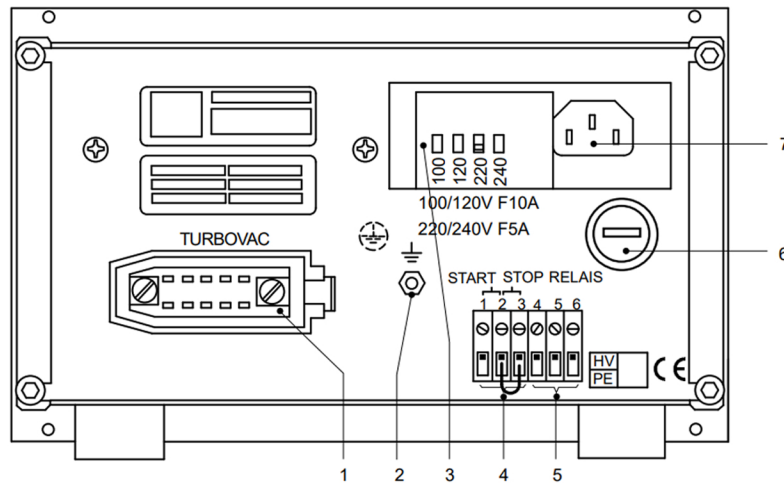

Key to fig. 3

- 1 Fuse holder
- 2 Fuse, 6.3 x 32 mm
- 3 Hinged cover
- 4 Plug for mains cable
- 5 Printed circuit board

