



PROVAC

SALES

PHONE: 831-462-8900

FAX: 831-462-3536

WWW.PROVAC.COM

Airtech SCS, LCS Systems Technical Specifications

SCS Standard Central System	LCS Laboratory Central System			
Model #	Model #	CFM	HP	Tank Size
Simplex Systems				
SCS-L25-1TAN	LCS-L25-1TAN	21	1.5	80
SCS-L40-1TAN	LCS-L40-1TAN	31	2.0	80
SCS-L63-1TAN	LCS-L63-1TAN	45	3.0	120
SCS-L100-1TAN	LCS-L100-1TAN	70	5.0	120
SCS-L160-1TAN	LCS-L160-1TAN	112	5.0	200
SCS-L230-1TAN	LCS-L230-1TAN	155	7.5	200
SCS-L250-1TAN	LCS-L250-1TAN	180	10.0	200
Duplex Expandable Systems				
SCS-L25-2TAN	LCS-L25-2TAN	21	1.5	80
SCS-L40-2TAN	LCS-L40-2TAN	31	2.0	80
SCS-L63-2TAN	LCS-L63-2TAN	45	3.0	120
SCS-L100-2TAN	LCS-L100-2TAN	70	5.0	120
SCS-L160-2TAN	LCS-L160-2TAN	112	5.0	200
SCS-L230-2TAN	LCS-L230-2TAN	155	7.5	200
SCS-L250-2TAN	LCS-L250-2TAN	180	10.0	200





PROVAC

SALES

PHONE: 831-462-8900

FAX: 831-462-3536

WWW.PROVAC.COM

Airtech SCS, LCS Systems

Features & Benefits

- air cooled standard (water cooled available)
 - auto purging on laboratory systems
 - automatic alternation to facilitate even pump wear
 - redundancy will eliminate downtime
 - lower operating & energy costs
 - vertical tank mounted available up to duplex 5HP
 - optional low vacuum alarm
- INCLUDED: • rotary vane pumps with direct coupled motors • ASME coded receivers • isolation valves • check valves • flexible connectors
- vibration isolators • inlet filters • vacuum gauges • UL approved control panel with thru-the-door disconnects

System Layout

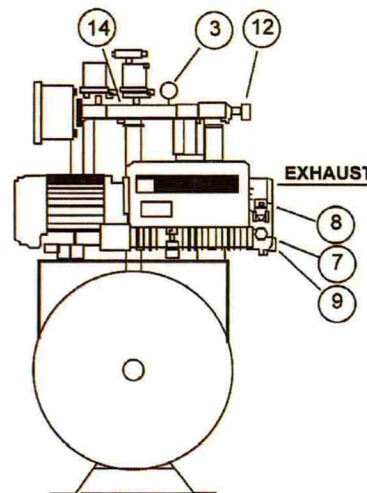
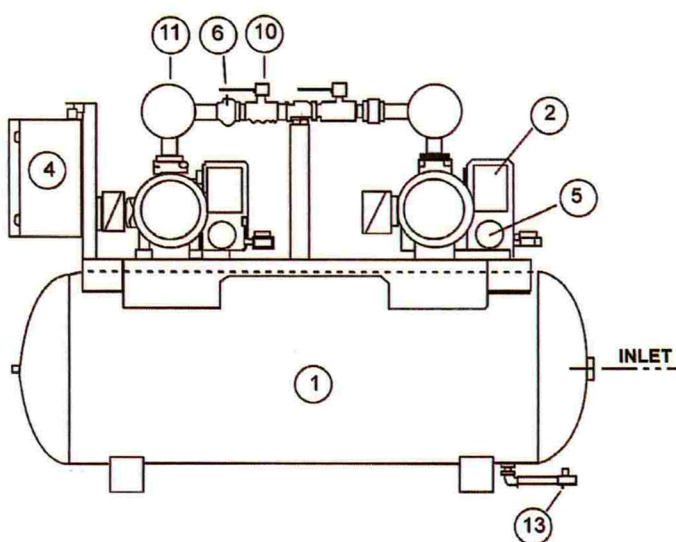

- ① Tank
- ② Vacuum Pump
- ③ Vacuum Gauge
- ④ Motor Control Center
- ⑤ Oil Filter
- ⑥ Check Valve
- ⑦ Oil Sight Glass
- ⑧ Oil Fill Cap
- ⑨ Oil Drain Valve
- ⑩ Pump Isolation Valve
- ⑪ Inlet Filter
- ⑫ Vacuum Gauge
- ⑬ Tank Drain Valve
- ⑭ Flex Connector