

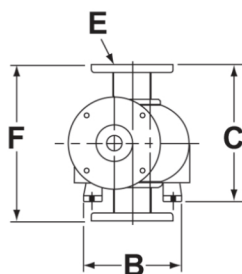

Kinney KMBD Series

Technical Specifications

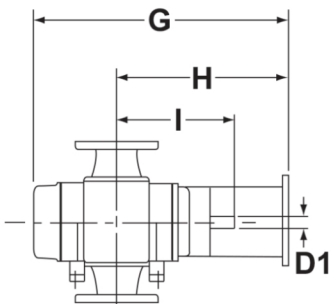
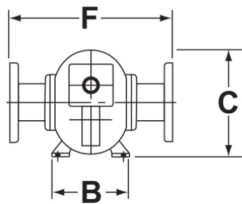
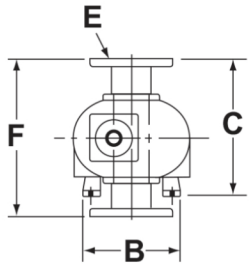
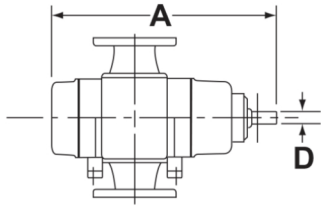

	DISPL. CFM / m ³ /h	A	B	C	D Ø	D1* Ø	E	F	G	H	I
KMBD 200/400	400 / 680	24.63	9.00	12.94	1.125	.875	4" ANSI	14.88	26.69	17.06	14.00
		25.25	7.00	10.06							
KMBD 540	540 / 918	27.69	12.00	15.50	1.125	.9995	4" ANSI	15.00	27.63	16.56	13.88
		27.69	9.00	12.25							
KMBD 720	720 / 1223	30.69	12.00	15.50	1.125	.9995	4" ANSI	15.00	30.63	18.06	15.38
		30.69	9.00	12.25							
KMBD 850	800 / 1359	29.19	16.00	20.50	1.375	1.375	6" ANSI	20.00	29.00	17.63	14.13
		29.81	12.25	16.38							
KMBD 1200	1200 / 2039	32.69	16.00	20.50	1.375	1.375	6" ANSI	20.00	32.50	19.38	15.88
		33.31	12.25	16.38							
KMBD 1600	1600 / 2720	35.69	16.00	20.50	1.375	1.375	6" ANSI	20.00	35.50	20.88	17.38
		36.31	12.25	16.38							
KMBD 2000	2000 / 3400	39.69	16.00	20.50	1.375	1.375	8" ANSI	20.00	39.50	22.88	19.38
		40.31	12.25	16.38							
KMBD 2700	2700 / 4590	45.69	16.00	20.50	1.375	1.375	10" ANSI	20.00	45.50	25.88	22.38
		46.31	12.25	16.38							
KMBD 2900	3000 / 5100	51.69	17.50	25.63	2.375	1.875	10" ANSI	23.50	45.31	19.94	23.38
				25.75							
KMBD 3600	3600 / 6117	55.69	17.50	25.63	2.375	1.875	12" ANSI	23.50	49.31	21.94	25.38
				25.75							
KMBD 4500	4600 / 7816	60.69	17.50	25.63	3.125	1.875	12" ANSI	23.50	54.31	24.44	27.88
				25.75							
KMBD 5400	5500 / 9400	61.50	22.88	28.25	3.125	—	14" ANSI	30.69	—	—	—
			13.81	32.69							
KMBD 7300	7300 / 12400	70.19	22.88	28.25	3.125	—	16" ANSI	30.69	—	—	—
			13.81	32.69							
KMBD 8000	9400 / 16000	86.75	33.75	29.31	3.500	—	18" ANSI	26.00	—	—	—
			20.38	40.50							
KMBD 10000	12700 / 21600	98.75	33.75	29.31	3.500	—	20" ANSI	26.00	—	—	—
			20.38	40.50							

* The shaft diameters identified as "D1" apply only to C-Face vacuum boosters.



PROVAC

SALES

PHONE: 831-462-8900

FAX: 831-462-3536

WWW.PROVAC.COM

Kinney KMBD Series Features & Benefits

- optional materials & coatings available
- low mechanical noise
- versatile drive configurations
- water-cooled end plates
- reduced oil vapor backstreaming
- lower discharge temperatures
- increased pumping speed
- higher staging ratios
- extended oil, bearing, gear & seal life

Applications

- food processing • vacuum furnaces • manufacturing of chemicals & petrochemicals • plastic • semiconductor • wood composite

