



Pfeiffer HiPace 300P

Technical Specifications

	HiPace® 300 P with TC 400
Bearing	Hybrid
Compression ratio for Ar	$> 1 \cdot 10^7$
Compression ratio for H ₂	$3 \cdot 10^2$
Compression ratio for He	$2.2 \cdot 10^3$
Compression ratio for N ₂	$> 1 \cdot 10^6$
Cooling method, optional	Air
Cooling method, standard	Water
Cooling water flow	50 l/h
Cooling water temperature	15-35 °C 59-95 °F 288-308 K
Current max.	12,5 A
Electronic drive unit	with TC 400
Flange (in)	DN 100 ISO-K
Flange (out)	DN 16 ISO-KF/G ¼"
Fore-vacuum max. for N ₂	1 hPa 0.75 Torr 1 mbar
Gas throughput at full rotational speed for Ar	4.4 hPa·l/s
Gas throughput at full rotational speed for H ₂	> 50 hPa·l/s
Gas throughput at full rotational speed for He	> 20 hPa·l/s
Gas throughput at full rotational speed for N ₂	17 hPa·l/s
I/O interfaces	RS-485, Remote
Mounting orientation	Any
Operating voltage: V DC	24 (± 5 %) V DC
Particulate matter	YES
Permissible magnetic field max.	5.5 mT
Power consumption max.	300 W
Protection category	IP54
Pumping speed for Ar	250 l/s
Pumping speed for H ₂	125 l/s
Pumping speed for He	220 l/s
Pumping speed for N ₂	245 l/s
Rotation speed ± 2 %	60,000 rpm 60,000 min ⁻¹
Rotation speed variable	35 – 100 %
Run-up time	1.2 min
Sound pressure level	≤50 dB(A)
Ultimate pressure according to PNEUROP	$< 1 \cdot 10^{-7}$ hPa $< 7.5 \cdot 10^{-8}$ Torr $< 1 \cdot 10^{-7}$ mbar
Ultimate pressure without gas ballast	$1 \cdot 10^{-7}$ hPa $7.5 \cdot 10^{-8}$ Torr $1 \cdot 10^{-7}$ mbar
Venting connection	G 1/8"
Weight	6.4 kg 14.11 lb



PROVAC

SALES

PHONE: 831-462-8900

FAX: 831-462-3536

WWW.PROVAC.COM

Pfeiffer HiPace 300P Pumping Curves

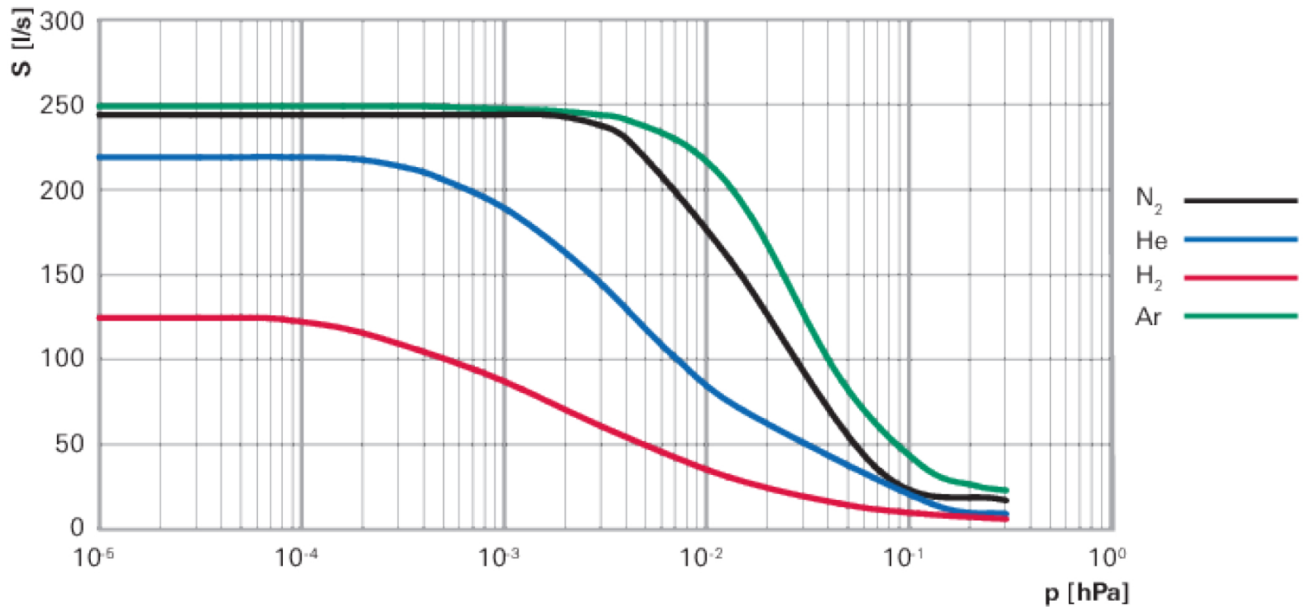

Dimensions

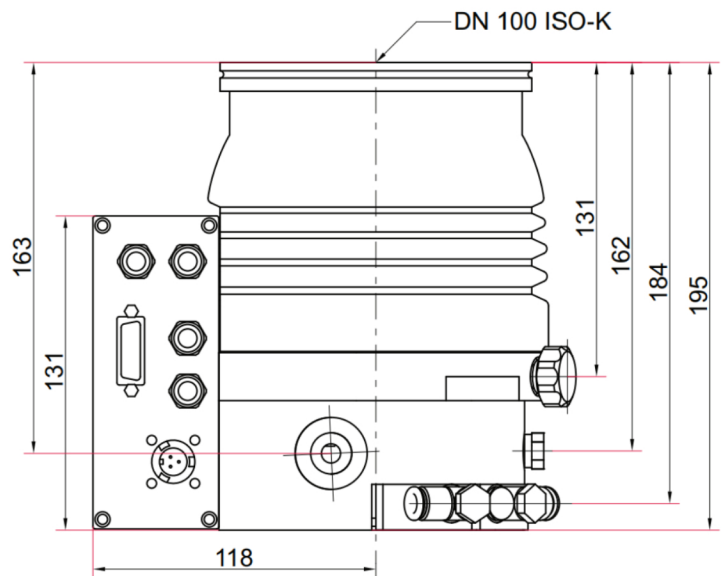
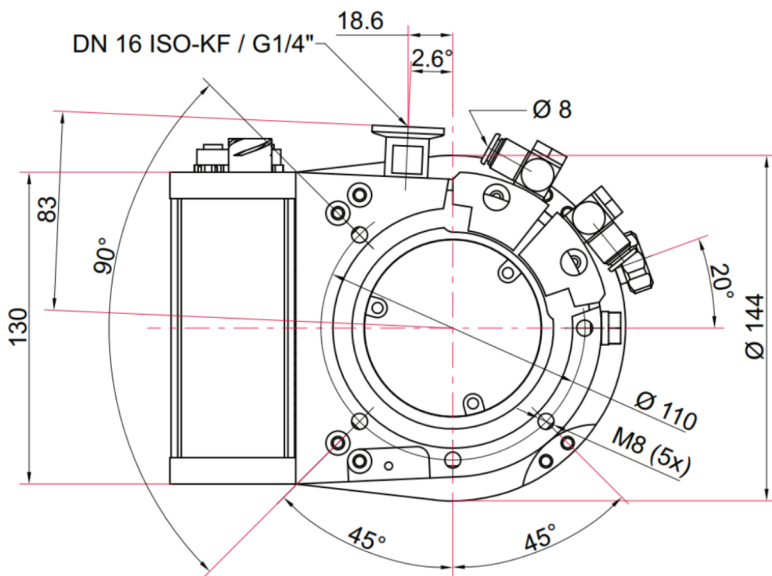



PROVAC

SALES

PHONE: 831-462-8900

FAX: 831-462-3536

WWW.PROVAC.COM

Pfeiffer HiPace 300P Features & Benefits

- process-oriented, rugged & powerful
- ideal for fast cycles
- insensitive to dust
- integrated drive electronics
- installation in any orientation
- integrated water cooling for maximum gas throughput
- flexible through ability to employ up to 4 accessories

Applications

- coating • semiconductor • electron beam welding • dusty industrial applications

