



Atlas Copco DVS series

Technical Specifications

		Unit	DVS 5	DVS 8	DVS 16	DVS 25	DVS 40	DVS 60	DVS 80	DVS 100	DVS 140
Nominal Flow	50Hz	m ³ /hr (cfm)	5 (3)	8 (4.7)	16 (9.4)	25 (14.7)	40 (23.5)	60 (35.3)	80 (47)	100 (59)	130 (76.5)
	60Hz		6 (3.5)	9 (5.3)	19 (11)	29 (17)	48 (28)	70 (41)	90 (53)	115 (67.7)	150 (88)
Ultimate vacuum level	50Hz	mbar(a) (Torr)	120 (90)	150 (112.5)	120 (90)	120 (90)	120 (90)	150 (112.5)	150 (112.5)	150 (112.5)	150 (112.5)
	60Hz		200 (150)								
Maximum discharge pressure	50Hz	mbar(g) (Torr)	0.8 (0.6)	0.8 (0.6)	1.0 (0.75)	1.0 (0.75)	1.0 (0.75)	-	-	-	-
	60Hz										
Nominal motor power	50Hz	kW (hp)	0.12 (0.16)	0.25 (0.33)	0.75 (1.0)		1.3 (1.7)	1.5 (2.0)	2.2 (2.9)	3.4 (4.5)	
	60Hz		0.15 (0.2)	0.3 (0.4)	0.9 (1.2)		1.5 (2.0)	1.8 (2.4)	3.0 (4.0)	4 (5.3)	
Motor speed	50Hz	rpm	2800			1400					
	60Hz		3300			1700					
Inlet connection	Thread	G	1/8"	3/8"	1/2"	3/4"	1"	1"	1"	1 1/2"	1 1/2"
Outlet connection	Thread	G	1/8"	1/2"	1/2"	1/2"	1"	1"	1"	1 1/2"	1 1/2"
Dimensions W x H x L	1ph version	mm	139 x 138 x 226	167 x 160 x 253	206 x 270 x 412	206 x 270 x 412	230 x 309 x 485	N/A x N/A x 692	N/A x N/A x 722	N/A x N/A x 820	N/A x N/A x 820
	3ph version		120 x 138 x 226	167 x 147 x 253	206 x 244 x 412	206 x 244 x 412	230 x 270 x 485	365 x 382 x 692	365 x 382 x 722	365 x 382 x 820	365 x 382 x 820
Weight	1ph version	kg (lbs)	5.4 (11.9)	8.5 (18.7)	31 (68.3)	31 (68.3)	42 (92.5)	N/A	N/A	N/A	N/A
	3ph version		5.4 (11.9)	8.5 (18.7)	33 (72.7)	33 (72.7)	45 (99.2)	66 (145.5)	71 (156.5)	87 (191.8)	95 (209.4)





PROVAC

SALES

PHONE: 831-462-8900

FAX: 831-462-3536

WWW.PROVAC.COM

Atlas Copco DVS series Pumping Curves

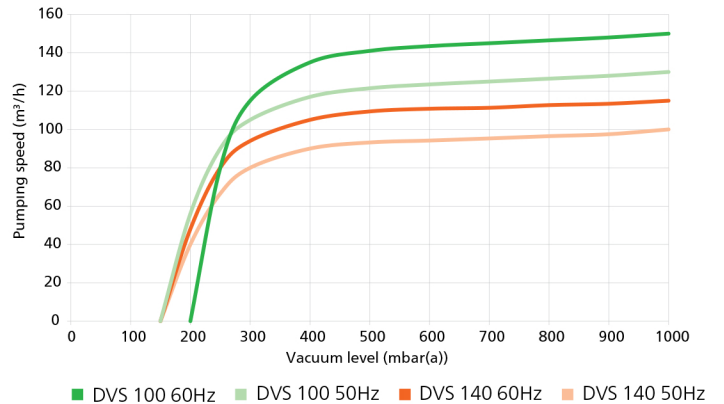
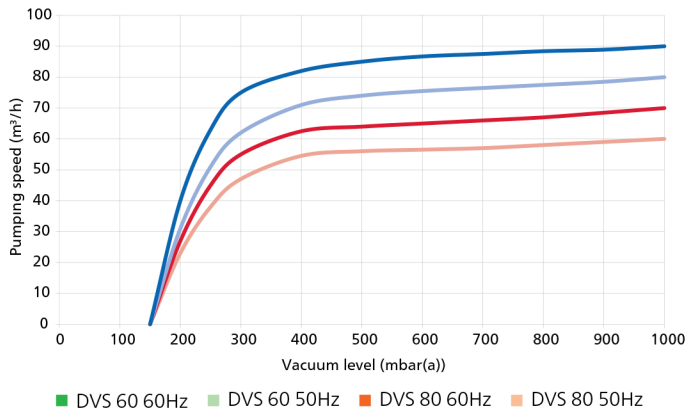
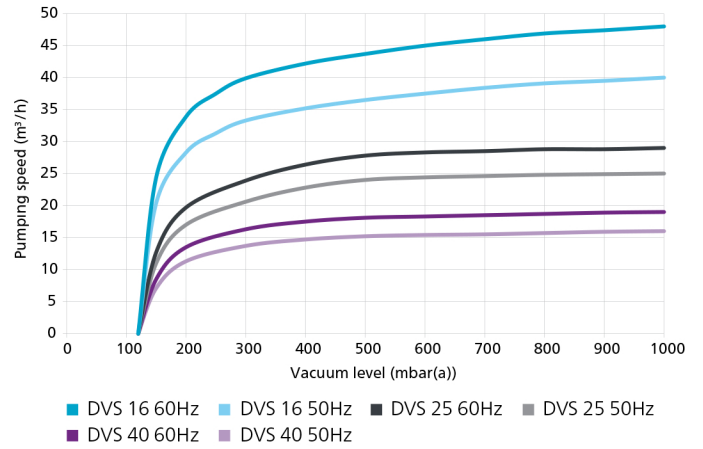
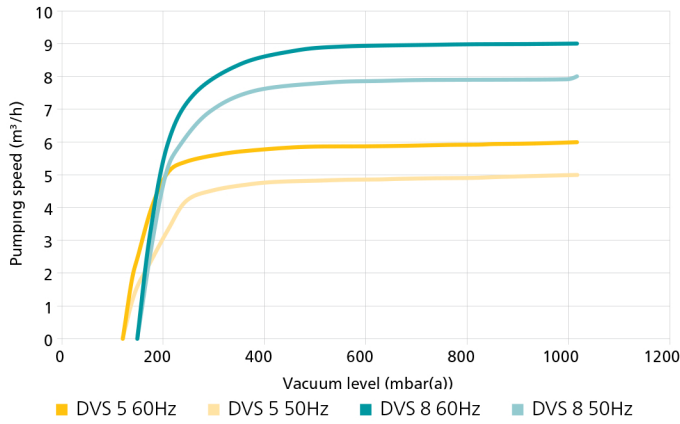

Dimensions

DVS 5

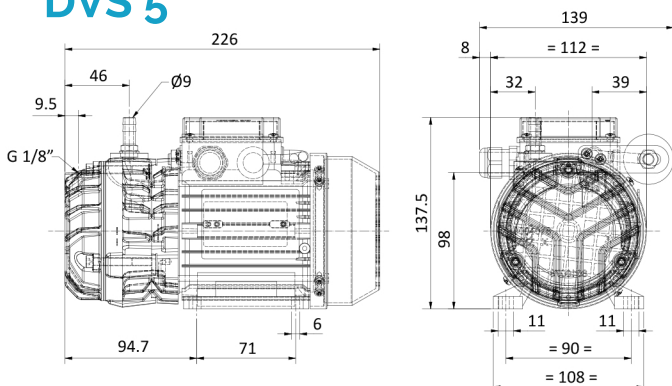

DVS 8

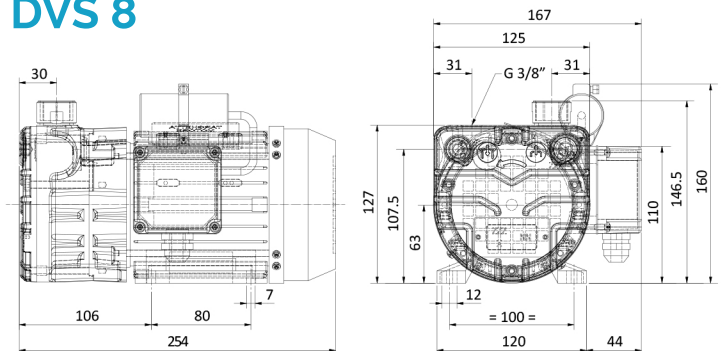



PROVAC

SALES

PHONE: 831-462-8900

FAX: 831-462-3536

WWW.PROVAC.COM

Atlas Copco DVS series Dimensions cont.

DVS 16

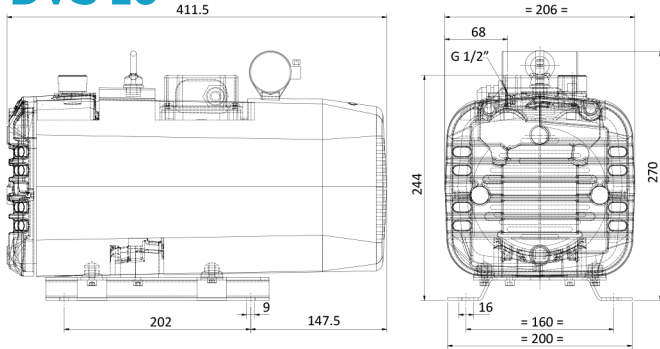

DVS 25

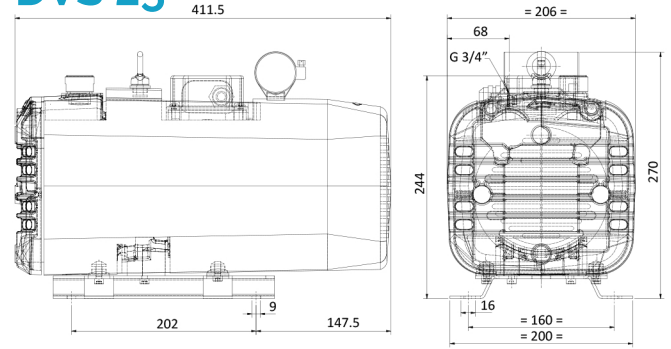

DVS 40

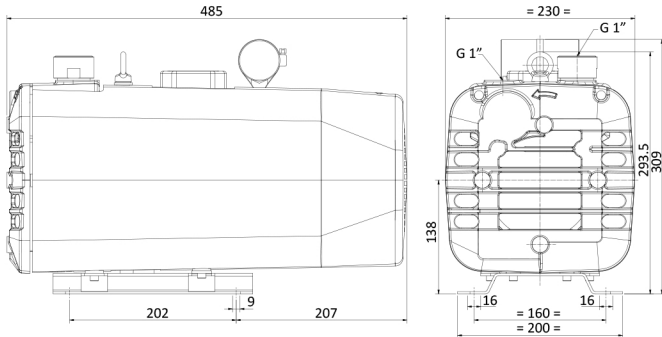

DVS 60

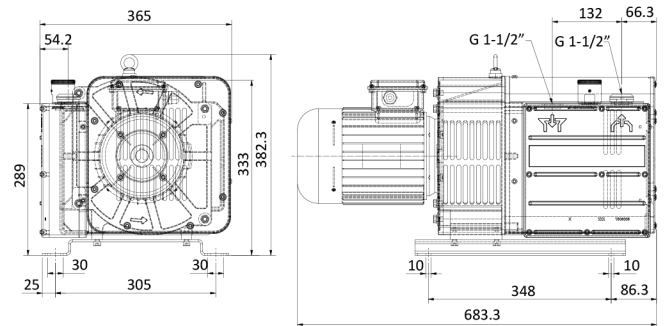

DVS 80

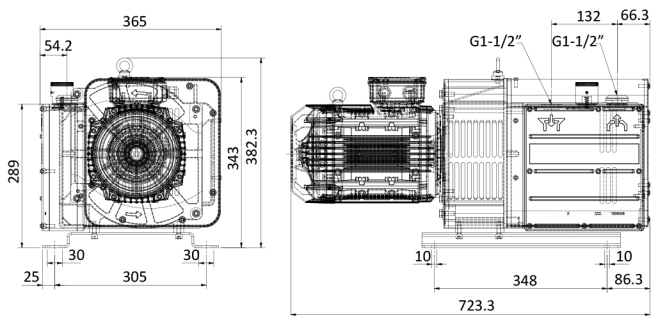

DVS 100

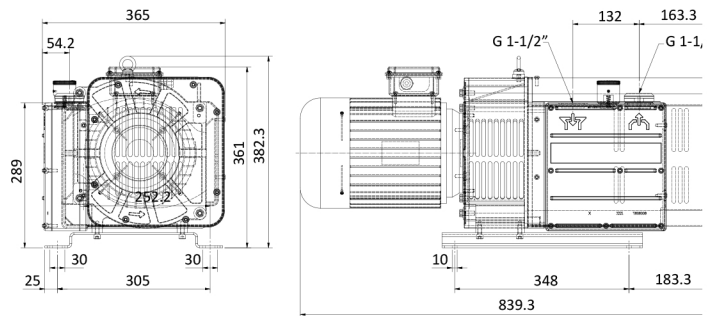



PROVAC

SALES

PHONE: 831-462-8900

FAX: 831-462-3536

WWW.PROVAC.COM

Atlas Copco DVS series Dimensions cont.

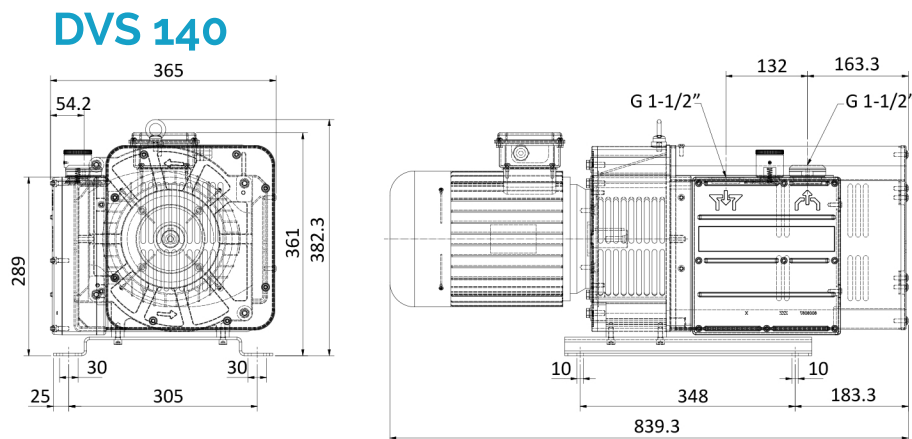

Features & Benefits

- single-stage dry vane vacuum pump
- clean operation, free of emissions, no contamination
- suited for rough industrial applications
- high efficiency & competitive initial investment costs
- low noise level, small footprint
- inside inlet filter, non-return valve, exhaust silencer
- direct drive motor
- reliable graphite vanes

Applications

- packaging • medical systems • pick & place • CNC clamping
- laboratory vacuum • holding, lifting, moving • pneumatic conveying
- printing • woodworking