



PROVAC

SALES

PHONE: 831-462-8900

FAX: 831-462-3536

WWW.PROVAC.COM

MD Pneumatics Competitor Plus

Technical Specifications

MODEL	MAXIMUM RPM	MAXIMUM PRESSURE DIFFERENTIAL*	MAXIMUM VACUUM*	MAXIMUM TEMPERATURE RISE*	MAWP
2002	5,275	12 psi (827 mbar)	16 inch-Hg (542 mbar)	225°F (125°C)	15 psi (1,034 bar)
2004	5,275	7 psi (483 mbar)	16 inch-Hg (542 mbar)	185°F (103°C)	15 psi (1,034 bar)
3002	3,600	15 psi (1,034 mbar)	16 inch-Hg (542 mbar)	210°F (117°C)	15 psi (1,034 bar)
3003 (2-lobe)	3,600	15 psi (827 mbar)	15 inch-Hg (508 mbar)	260°F (100°C)	15 psi (1,034 bar)
3003 (3-lobe)	3,600	12 psi (827 mbar)	15 inch-Hg (508 mbar)	260°F (100°C)	15 psi (1,034 bar)
3006	3,600	7 psi (483 mbar)	15 inch-Hg (508 mbar)	170°F (94°C)	15 psi (1,034 bar)
4002	3,600	15 psi (1,034 mbar)	16 inch-Hg (542 mbar)	220°F (122°C)	17 psi (1,172 bar)
4005	3,600	10 psi (690 mbar)	16 inch-Hg (542 mbar)	210°F (117°C)	15 psi (1,034 bar)
4007 (2-lobe)	3,600	17 psi (483 mbar)	15 inch-Hg (508 mbar)	260°F (94°C)	15 psi (1,034 bar)
4007 (3-lobe)	3,600	7 psi (483 mbar)	15 inch-Hg (508 mbar)	260°F (94°C)	15 psi (1,034 bar)
5003	2,850	15 psi (1,034 mbar)	16 inch-Hg (542 mbar)	260°F (108°C)	17 psi (1,172 bar)
5006 (2-lobe)	2,850	18 psi (896 mbar)	16 inch-Hg (542 mbar)	195°F (108°C)	15 psi (1,034 bar)
5006 (3-lobe)	2,850	15 psi (896 mbar)	16 inch-Hg (542 mbar)	195°F (108°C)	15 psi (1,034 bar)
5009 (2-lobe)	2,850	14 psi (483 mbar)	15 inch-Hg (508 mbar)	250°F (89°C)	15 psi (1,034 bar)
5009 (3-lobe)	2,850	8 psi (483 mbar)	15 inch-Hg (508 mbar)	250°F (89°C)	15 psi (1,034 bar)
6005	2,350	15 psi (1,034 mbar)	16 inch-Hg (542 mbar)	260°F (139°C)	17 psi (1,172 bar)
6008	2,350	14 psi (965 mbar)	16 inch-Hg (542 mbar)	260°F (133°C)	15 psi (1,034 bar)
6015	2,350	7 psi (483 mbar)	12 inch-Hg (406 mbar)	180°F (100°C)	15 psi (1,034 bar)
7006	2,050	15 psi (1,034 mbar)	16 inch-Hg (542 mbar)	235°F (131°C)	17 psi (1,172 bar)
7011	2,050	10 psi (690 mbar)	16 inch-Hg (542 mbar)	210°F (117°C)	15 psi (1,034 bar)
7018	2,050	6 psi (414 mbar)	12 inch-Hg (406 mbar)	120°F (67°C)	15 psi (1,034 bar)

* Maximum conditions based upon 70°F (21°C) inlet temperature and 14.7 psi (1 bar) absolute inlet pressure.



PROVAC

SALES

PHONE: 831-462-8900

FAX: 831-462-3536

WWW.PROVAC.COM

MD Pneumatics Competitor Plus

Dimensions

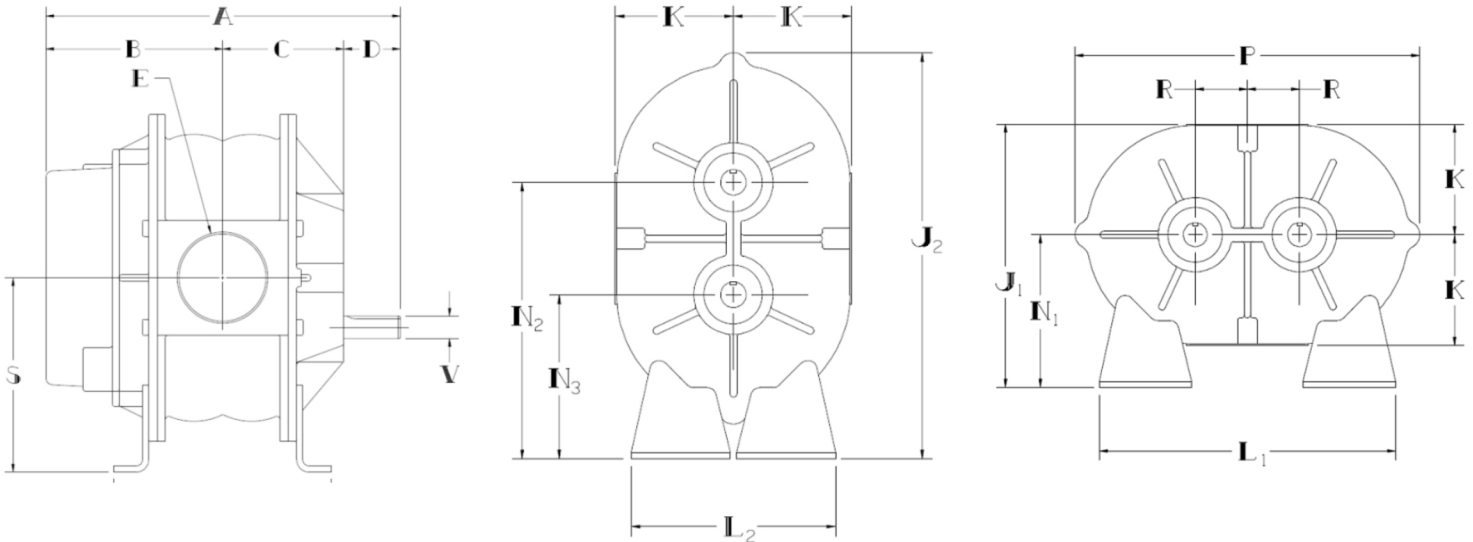

Model Size	A	B	C	D	E	H	J1	J2	K	L1	L2	N1	N2	N3	P	R	S	V
2002	10.00	4.88	2.63		1" NPT	5.00												
2004	12.00	5.88	3.63	2.50	2" NPT	7.00	6.88	9.69	3.13	5.13	5.13	3.75	6.25	3.75	9.38	1.25	5.00	.625
3002	11.56	5.69	3.38		1 1/4" NPT	6.75												
3003	12.44	6.19	3.75		2" NPT	7.63	8.94	12.81										
3006	14.81	7.38	4.94	2.50	2 1/2" NPT	10.00			3.94	7.25	7.25	5.00	8.50	5.00	12.19	1.75	6.75	.875*
4002	12.94	6.25	3.69		1 1/2" NPT	7.25												
4005	15.69	7.63	5.06		2 1/2" NPT	10.00	10.63	15.13										
4007	17.44	8.50	5.94	3.00	3" NPT	11.75			4.38	8.00	8.00	6.25	10.25	6.25	13.69	2.00	8.25	.875
5003	15.25	7.38	4.50		2 1/2" NPT	8.38												
5006	17.88	8.69	5.81		4" NPT	11.00	12.13	17.38										
5009	20.88	10.19	7.31	3.38	4" NPT	14.00			5.38	10.50	10.50	6.75	11.25	6.25	17.19	2.50	8.75	1.125
6005	18.75	9.44	5.63		3" NPT	10.13	15.06		6.25									
6008	21.75	10.94	7.13		5" NPT	13.13	15.06	21.69	6.25									
6015	28.75	14.44	10.63	3.69	6" FLG	20.13	16.44		7.50	17.00	11.00	8.75	14.75	8.75	19.81	3.00	11.75	1.375
7006	20.31	10.31	5.94		4" NPT	11.75	20.63		9.63									
7011	25.31	12.69	8.44		6" FLG	16.75	19.50	26.13	8.50	21.00	14.00	11.00	18.00	11.00				
7018	32.31	16.31	11.94	4.06	8" FLG	23.75	19.50		8.50						23.25	3.50	14.50	1.562

Values shown are approximate and should not be used for construction.

Certified drawings are available through your local Tuthill Vacuum & Blower Systems Sales Professional.



PROVAC
SALES

PHONE: 831-462-8900

FAX: 831-462-3536

WWW.PROVAC.COM

MD Pneumatics Competitor Plus

Features & Benefits

- timed with precision helical gears, which are quieter
- double-row ball bearings at the gear end
- 50% longer life than models from other manufacturers
- strong bearings & rotors with integral shafts
- reduced noise versions available
- can be field converted from horizontal to vertical flow

Applications

- pneumatic conveying • carpet cleaning • dairy milking • mosquito fogging • wastewater aeration • trenchless drilling • air sparging
- vacuum excavation • dust collection

