



Alcatel ACT-600M, ACT-1000M

Technical Specifications

Model characteristics		ACT 600M	ACT 1000M
Weight	kg	8.5	
Dimensions HxWxD	mm	132.5 x 219 x 453 1/2 Rack 19"	
Power supply			
Nominal voltage	V	85 to 132 - 170 to 264	
Frequency	Hz	48/63	
Maximum power consumption	VA	750	
Customer main circuit breaker rating		10 A	
Ambient operating temperature °C		T ≤ 50	

Dimensions

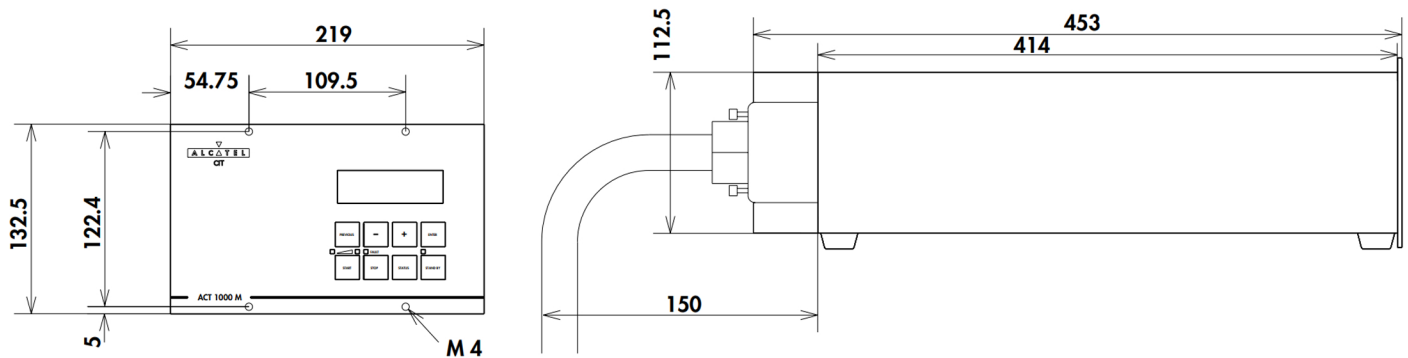

Features & Benefits

- automatic power supply detection 85-265V, 48/63Hz, 1 Phase
- alphanumeric display
- handy keyboard
- light & small
- battery free