



## Alcatel A200L

### Technical Specifications

	A 200 L
Rotational speed	5,400 rpm
Peak pumping speed	200 m <sup>3</sup> /h
Typical pump down time to 300 mTorr, 20 liters chamber	6.0 s
Max. ultimate pressure	1 · 10 <sup>-2</sup> torr / 1.3 · 10 <sup>-2</sup> hPa
Typical ultimate pressure	6 · 10 <sup>-3</sup> torr / 8 · 10 <sup>-3</sup> hPa
Power supply voltage	200 – 230 V, 3 phases, 50/60 Hz
Power consumption	0.7 <sup>1)</sup> kW
Max. volume size	1 m <sup>3</sup>
Max. cycling frequency (20 l volume)	300 cycle/hour
Max. continuous inlet flow	25 SLM
Max noise level at full speed	< 58 dB (A)
Typical vibration level at inlet flange 10 – 1,000 Hz	< 0.14 g
Cooling water	100 to 200 <sup>2)</sup> l/h
Cooling water connection	1/4 NPT Quick connectors
Dimensions l x w x h	600 x 280 x 300 mm
Weight	100 kg
Ambient temperature	5 to 40 °C
Inlet/exhaust size	NW 50 / NW 25
Tool interface	16 or 19 pins I/O
RS-232/485 interface	optional
Variable speed	20 to 100 % max speed
Stackable	Yes <sup>3)</sup>
Interchangeable & backward compatible with A 100 L	Yes
<sup>1)</sup> Ultimate pressure	
<sup>2)</sup> Cycle dependent	
<sup>3)</sup> Horizontal inlet only	



# PROVAC

## SALES

PHONE: 831-462-8900

FAX: 831-462-3536

WWW.PROVAC.COM

## Alcatel A200L Pumping Curves

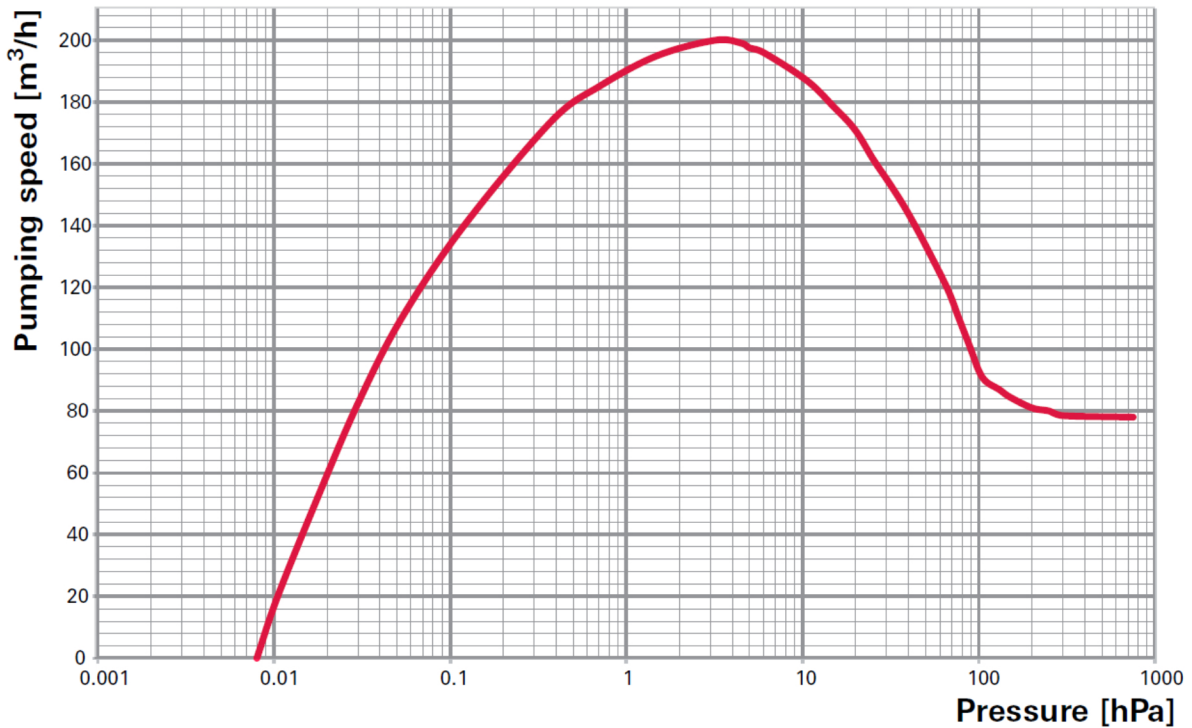

## Dimensions

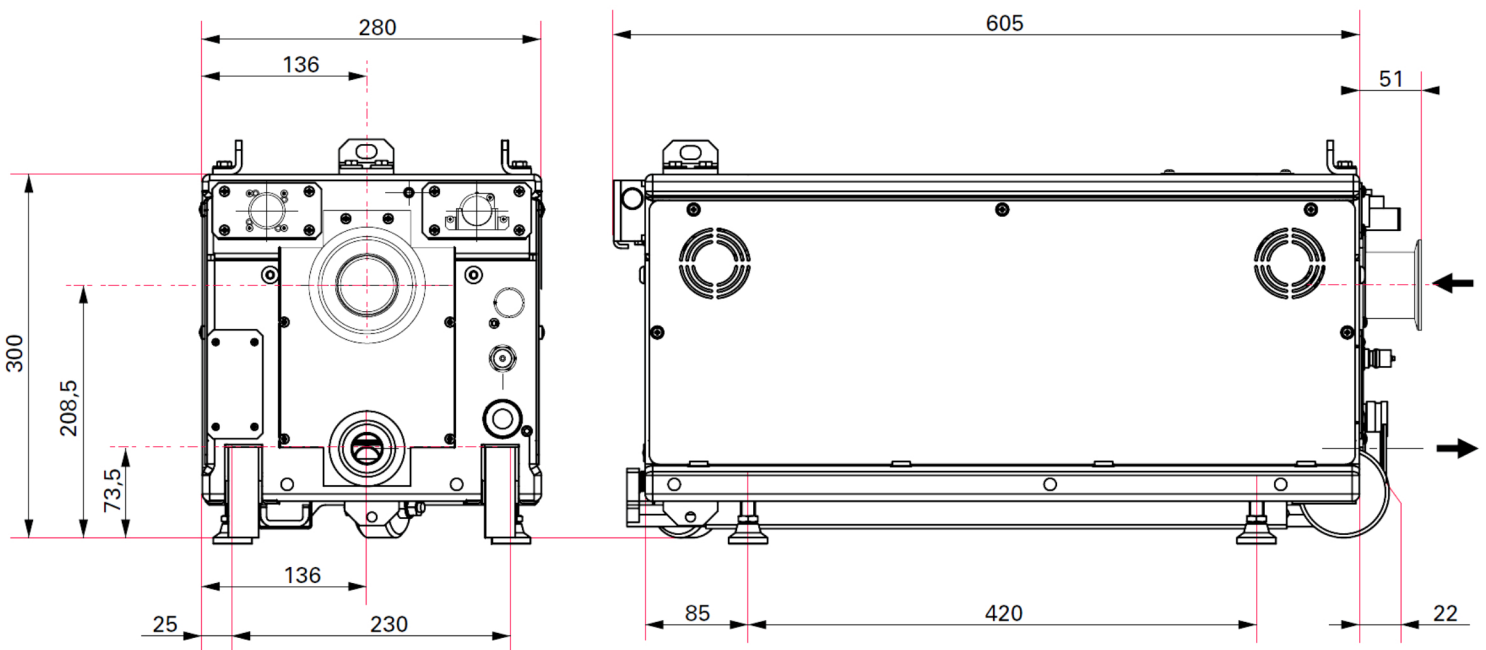



# PROVAC

## SALES

PHONE: 831-462-8900

FAX: 831-462-3536

WWW.PROVAC.COM

## Alcatel A200L Features & Benefits

- low cost of ownership
- power consumption reduced by 55%
- easily integrated into existing equipment
- very compact design
- inlet position can be flexibly adjusted to the application requirement
- can easily replace A100L if higher performance is needed
- top performance & unrivaled throughput
- high cleanroom compatibility
- integrated self-monitoring system
- no preventative maintenance required

## Applications

- wafer • PVD • cleanroom

