



Alcatel A100L

Technical Specifications

A 100 L Standard Version, Low Voltage, 16- Pin I/O	
Continuous inlet flow, max.	20 Slm
Cooling	Water
Cooling water flow	Minimum: 96 l/h
Cycling period, max.	On 25 liters volume: 40 s
Flange (in)	DN 50 ISO-KF
Flange (out)	DN 25 ISO-KF
Frequency	50/60 Hz
I/O interfaces	SPI 16 pins
Noise level, max.	58 dB(A)
Power consumption at ultimate pressure	1.6 kW
Power consumption in standby mode	0.5 – 1.2 kW
Power supply voltage, 3 phases	200 – 230 V
Processes	Light Duty Applications
Pumping speed	100 m ³ /h
Typical ultimate pressure without gas ballast or purge	6.6 · 10 ⁻³ hPa 4.95 · 10 ⁻³ Torr 6.6 · 10 ⁻³ mbar
Typical vibration acceleration (at inlet flange 10-1000 Hz)	0.1 m.s ⁻²
Typical vibration displacement (at inlet flange 10-1000 Hz)	1.5 µm
Typical vibration speed (at inlet flange 10-1000 Hz)	1 mm.s ⁻¹
Version	Standard
Volume size, max.	1 m ³
Water connection	1/4 NPT Quick Connect
Weight	100 kg 220.46 lb



PROVAC

SALES

PHONE: 831-462-8900

FAX: 831-462-3536

WWW.PROVAC.COM

Alcatel A100L Pumping Curves

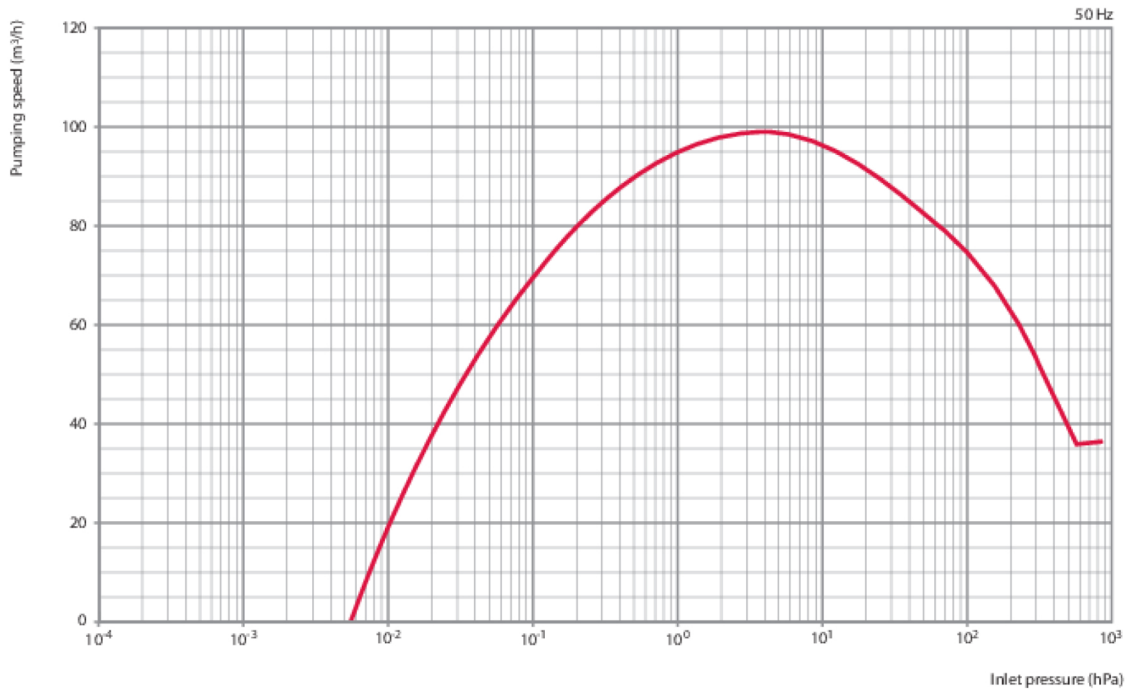

Dimensions

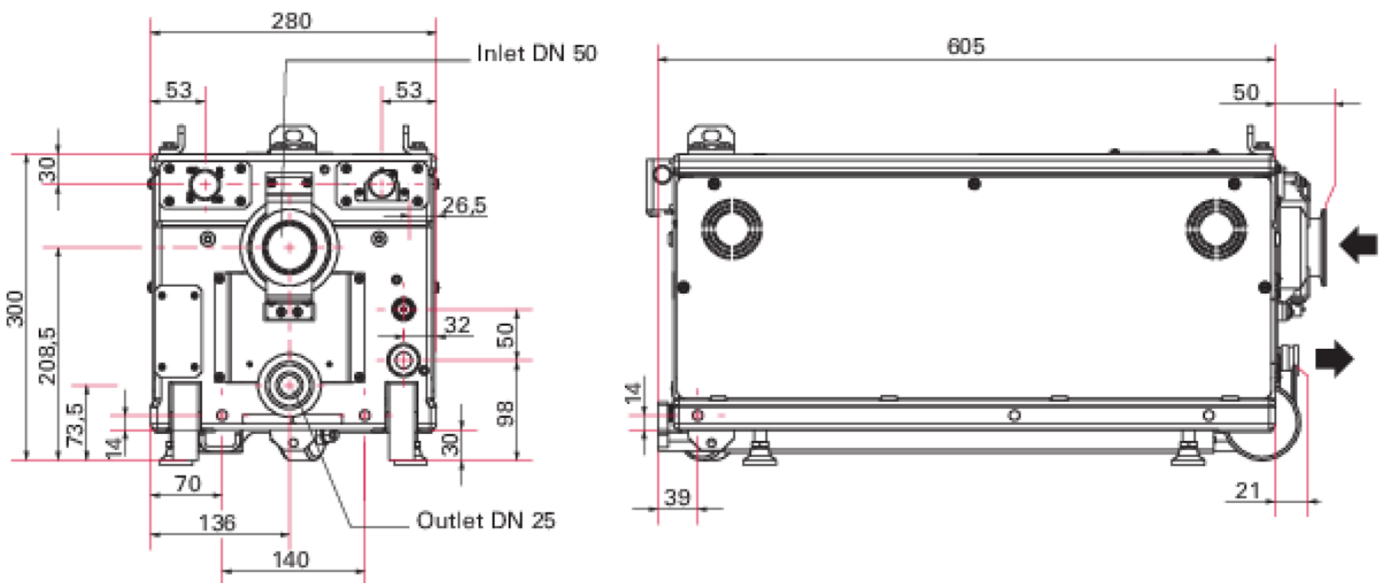



PROVAC

S A L E S

PHONE: 831-462-8900

FAX: 831-462-3536

WWW.PROVAC.COM

Alcatel A100L

Features & Benefits

- plug & play system: integrated monitoring
- optional RS232/RS485 interface
- low vibration & noise level
- compact, stackable
- high performance
- energy efficient
- reliable



Applications

- load lock/transfer chamber for semiconductor
- load lock/sputtering chamber for solar photovoltaic applications
- cryogenic use in fundamental research labs
- analytical instrumentation