



## Stokes 61B

### Technical Specifications

Displacement	
V belt (2750 rpm)	3375m <sup>3</sup> h <sup>-1</sup> / 2000ft <sup>3</sup> min <sup>-1</sup>
Direct drive (3000 rpm)	3685m <sup>3</sup> h <sup>-1</sup> / 2170ft <sup>3</sup> min <sup>-1</sup>
Direct drive (3600 rpm)	4420m <sup>3</sup> h <sup>-1</sup> / 2600ft <sup>3</sup> min <sup>-1</sup>
Inlet/outlet flanges	8" ASA/ANSI flange
Motor power EU/Asia	18.5kW
Motor power US TEFC	25 hp
By-pass available	Yes
Cooling water	7.6 - 11.4l min <sup>-1</sup> / 2 - 3gal min <sup>-1</sup>
Oil capacity (horizontal flow)	1.9 litre / 4.1gal
Oil capacity (vertical flow)	4.1 litre / 8.8gal
Max temp rise	135°C / 275°F
Max discharge temp	191°C / 375°F
Weight bare shaft	284kg / 625lbs
Weight TEFC direct drive	538kg / 1185lbs
Recommended Oil	V- Lube H





# Stokes 61B

## Dimensions

Direct drive H (horizontal) booster pump with bypass valve dimensions

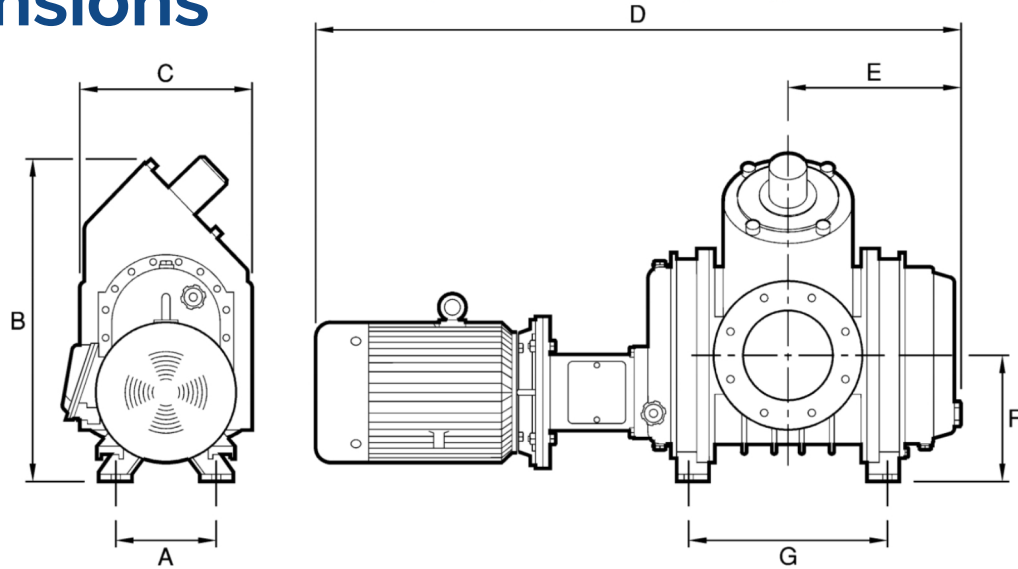

Pump	Dimensions: mm (inch)						
	A	B	C	D	E	F	G
900-61B-MH10	229 (9.0)	763 (30.0)	406 (16.0)	1367 (53.8)	409 (16.1)	292 (11.5)	471 (18.5)
900-61B-MH25	229 (9.0)	763 (30.0)	406 (16.0)	1479 (58.2)	409 (16.1)	292 (11.5)	471 (18.5)
90061BMHR601	229 (9.0)	763 (30.0)	406 (16.0)	1515 (59.6)	409 (16.1)	292 (11.5)	471 (18.5)
90061BMHR602	229 (9.0)	763 (30.0)	406 (16.0)	1445 (57.0)	409 (16.1)	292 (11.5)	471 (18.5)

Direct drive V (vertical) booster pump with bypass valve dimensions

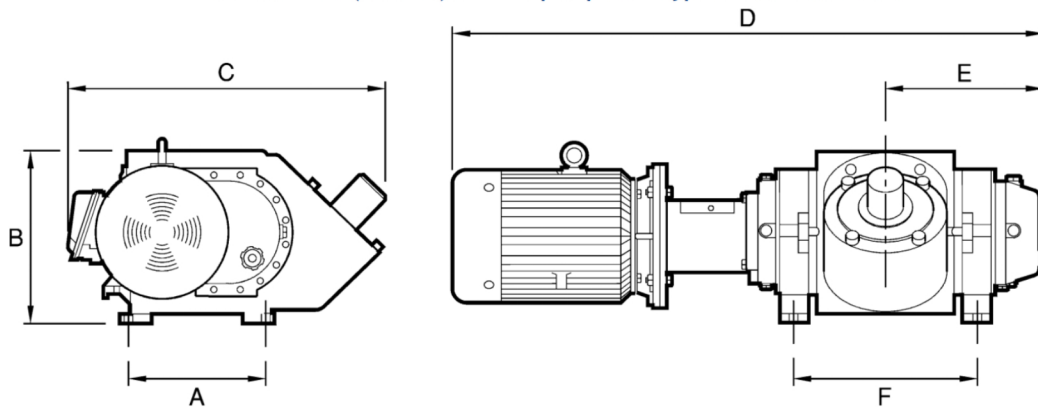

Pump	Dimensions: mm (inch)					
	A	B	C	D	E	F
900-61B-5V10	349 (13.8)	406 (16.0)	722 (28.4)	1367 (53.8)	409 (16.1)	454 (17.9)
900-61B-MV10	349 (13.8)	406 (16.0)	722 (28.4)	1367 (53.8)	409 (16.1)	454 (17.9)
900-61B-MV25	349 (13.8)	406 (16.0)	722 (28.4)	1479 (58.2)	409 (16.1)	454 (17.9)
90061BMVR601	349 (13.8)	406 (16.0)	791 (31.1)	1520 (59.9)	413 (16.3)	454 (17.9)
90061BMVR602	349 (13.8)	406 (16.0)	791 (31.1)	1719 (67.6)	409 (16.1)	454 (17.9)



# PROVAC

## SALES

PHONE: 831-462-8900

FAX: 831-462-3536

WWW.PROVAC.COM

---

## Stokes 61B

### Features & Benefits

- designed to be used in conjunction with rotary-piston, dry vacuum, rotary vane & liquid ring pumps
- mechanical seals protect against dust & particulate contamination
- integral by-pass valve enables the booster to start from atmosphere
- can be mounted separately or on the inlet of the backing pump
- extra large diameter shaft
- uniquely rugged & durable mechanical booster

### Applications

- automotive • chemical processing • heat treatment • leak detection
- metallurgy • pet processing • pharmaceuticals • thermal processing
- transformer drying & cable fluid conditioning • vacuum coating
- vacuum melting