

290mm Flat Truss Data Sheet

Titan AV

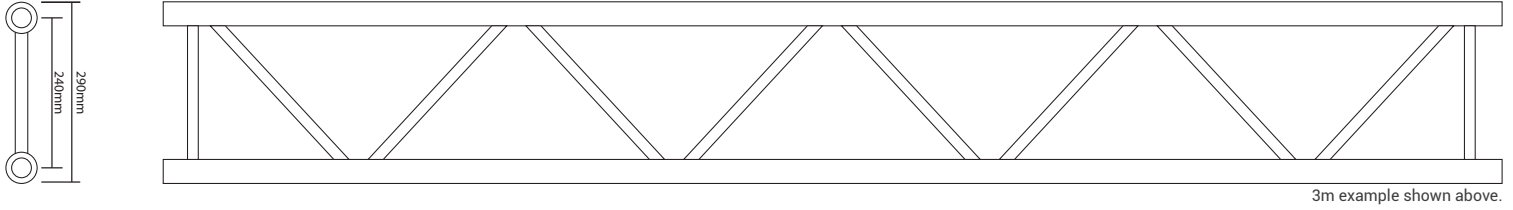

3m example shown above.

Certifications and compliance

Report No: 20164068M01
 Independent Inspection & Testing Company: Alfa Test (ISO17025 & Nata Accreditation)
 Location of Test: Alfa Test, Brisbane Laboratory, Qld

Static load test & results

Test Procedure: TP 230
 Test Spec: TP 230
 Requirements: Uniformly loaded with 25kg weights at 1-meter increments & Centre point loaded with 53kg weights.
 Tested length: Uniformly loaded over 6m span, Centre point loaded over 6m span.
 Test Results: PASS

Product specification

Description: Aluminium Flat Truss System 300 x 50mm (Industry standard 290 truss)
 Brand: Titan AV
 Model Number: TR-SF30
 Product Specification:

- Connecting Cross Section: 240mm x 25mm
- Material (Main Tube, Brace & End connector): Aluminium 6082-T6
- Main Tubes: 50mm x 2 mm
- Braces: 20mm x 2mm



Titan AV 290mm Flat Truss Allowable Loading* (TR-SF30)

| Span | Uniformly Distributed Load (UDL) | Deflection | Centre Point Load (CPL) | Deflection |
|------|----------------------------------|------------|-------------------------|------------|
| M | KG/M | MM | KG | MM |
| 1 | 845.0 | 0.0 | 845.0 | 0.0 |
| 2 | 418.0 | 3.0 | 623.0 | 2.0 |
| 3 | 218.0 | 6.0 | 345.0 | 5.0 |
| 4 | 95.0 | 13.0 | 202.0 | 11.0 |
| 5 | 43.0 | 21.0 | 114.0 | 17.0 |
| 6 | 25.0 | 30.0 | 53.0 | 24.0 |

Titan AV 290mm Flat Truss Product Range

| VFM Part ID | Length | Weight of Length | Approved For Rigging |
|-------------|--------|------------------|----------------------|
| TR-SF30-050 | 0.5 m | 3.0 kg | Y |
| TR-SF30-100 | 1.0 m | 4.0 kg | Y |
| TR-SF30-150 | 1.5 m | 5.0 kg | Y |
| TR-SF30-200 | 2.0 m | 7.0 kg | Y |
| TR-SF30-250 | 2.5 m | 8.0 kg | Y |
| TR-SF30-300 | 3.0 m | 9.0 kg | Y |

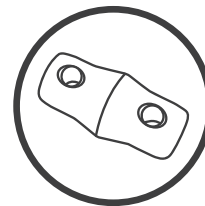

2 x Spigots included as standard

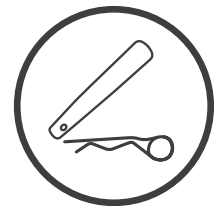

4 x Clips and Pins included as standard

* PLEASE NOTE: Load table information is supplied as a guide only. Please consult your structural engineer for advice related to your application.