



Graywind
Beyond shading

58515

SMART BLINDS

USER GUIDE

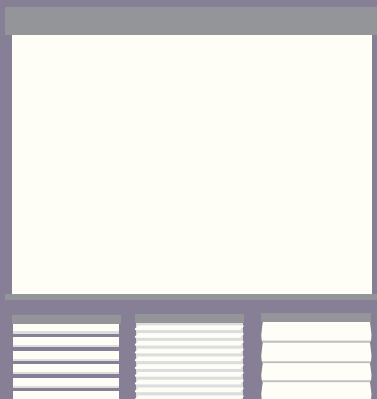

WHY GRAYWIND?

We are a group of seekers for perfect life, looking for inspiration from the purest light and shadows. What we want to share is not only window decoration, but also technology, art and customization. We are committed to bringing convenient, pleasant and elegant life experience to every customer.



Ultra Smart Life

Graywind embraces technology and persists in continual innovation as well as creating a brand new smart life experience, bringing our user a more convenient, safer and more enjoyable living environment.



Explore Pure Beauty

Graywind represents the harmony between light and shadows, which grants the space graceful versatility and artistical sight. Our users can seek for the beauty of life and enjoy happiness.



Enjoy Freedom

Graywind refuses to be mediocre and releases unique true self. We offer stylish designed product to our users. They can delight themselves, show themselves and release themselves without restriction of rule and enjoy from the freedom.



SOCIALIZE WITH US



SATISFIED

If your motorized blinds are running without any issues, we invite you to activate your product warranty.

1. Search **graywindblinds.com** or scan **QR code** to visit our website.
2. Register and click account to enter personal page.
3. Choose Product Activation tab, fill in info & order id, then submit.
4. Activation done.
 - You also can purchase extended warranty service before the warranty expires, even though the free 2-year warranty has been activated.
 - This section is only convenient for recording, whether it is activated or not will not affect the actual warranty period.



DISSATISFIED

- We will pre-program and double check before shipment. For battery motors, please charge them for 8-10 hours before first use.
- If the parcel you received isn't in good condition, please take photos and confirm whether they still work.
- Any after-sales questions, please scan the **QR code** and contact us. We are always at service 24/7.
- **Customer Service:**
service@graywindhome.com



CONTENTS

A

INSTALLATION

A-1. Preparation	1
A-2. Accessories	2
A-3. Installation Of Blind With Valance	
Inside Mount	3-4
Outside Mount	5-7
A-4. Installation Of Blind Without Valance	
Inside Mount	8-9
Outside Mount	10-11
A-5. Take Down The Blind	12

A. INSTALLATION

A-1 PREPARATION



* Drilling hole size 6mm
Recommended size of drill bit: 15/64"

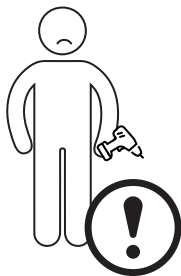

A-2 ACCESSORIES

2

WITH VALANCE

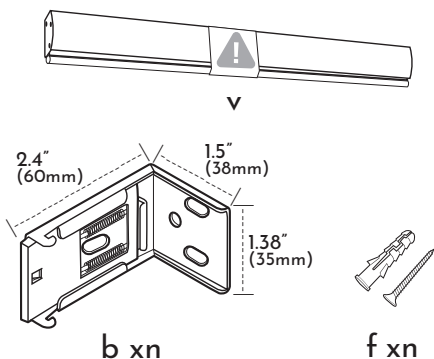

NO VALANCE

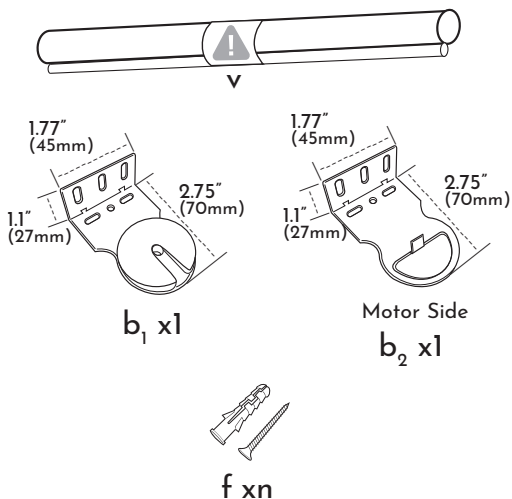

A-3 INSTALLATION OF BLIND WITH VALANCE

INSIDE MOUNT

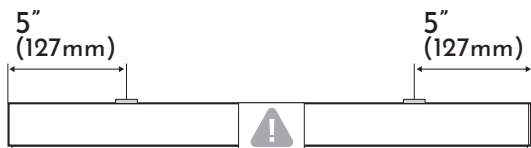

- 1 Mark punch positions.

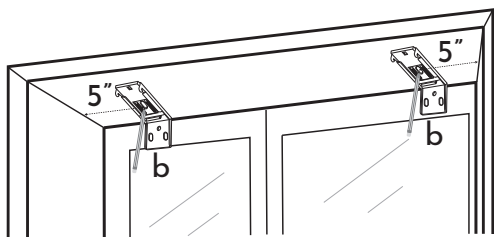

- 2 Drill holes & install mounting brackets.

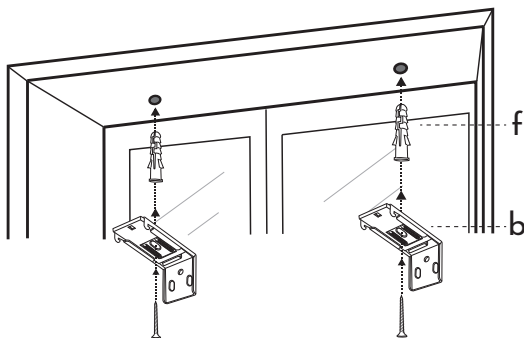

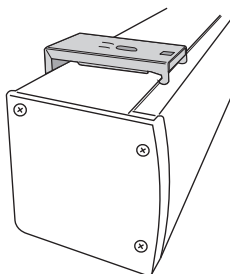
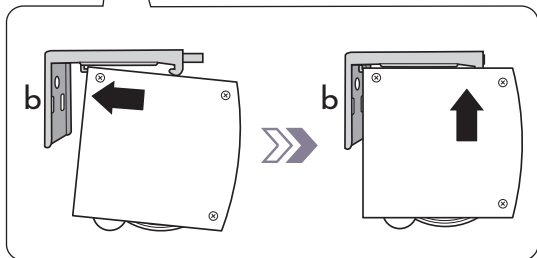
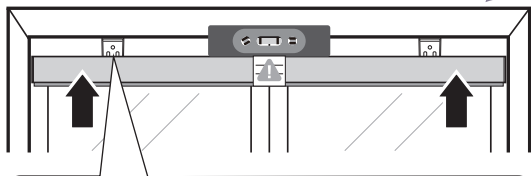
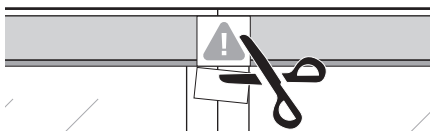
3 Install the blind.**4** Remove paper seal.**5**

Your blind has been programmed,
please use directly.



OUTSIDE MOUNT

5

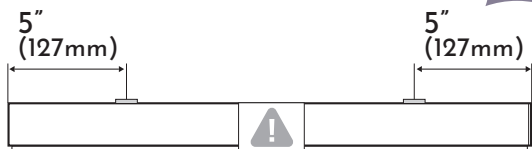

- ① Clamp mounting brackets on the valance.

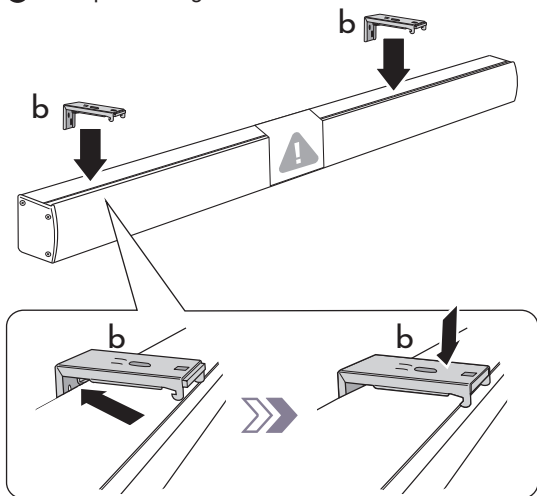

- ② Mark bracket positions.

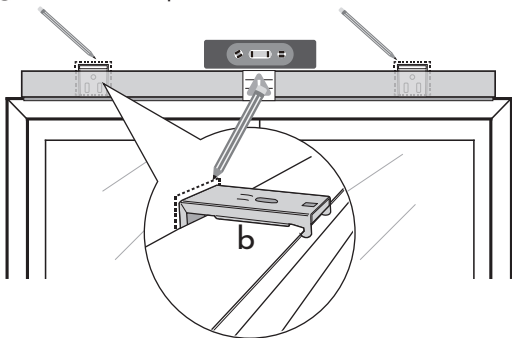

- ③ Take down mounting brackets.

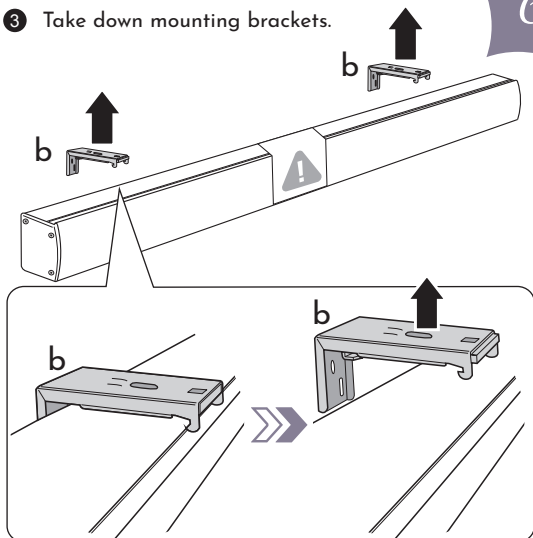

- ④ Mark punch positions.

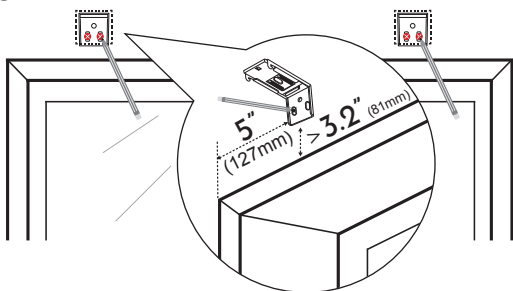

- ⑤ Drill holes & install mounting brackets.

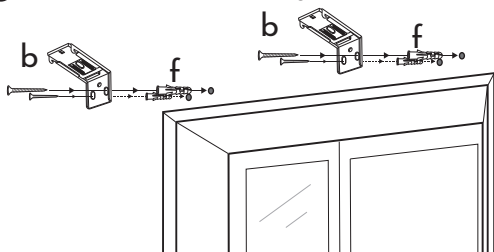

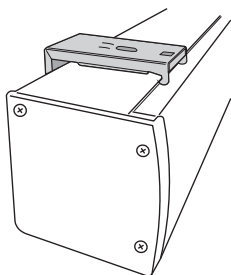
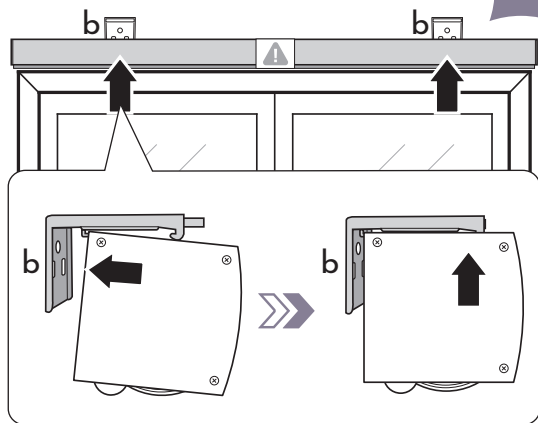
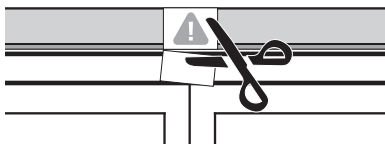
6 Install the blind.**7** Remove paper seal.**8**

Your blind has been programmed,
please use directly.



A-4 INSTALLATION OF BLIND WITHOUT VALANCE

INSIDE MOUNT

- 1 Mark punch positions.

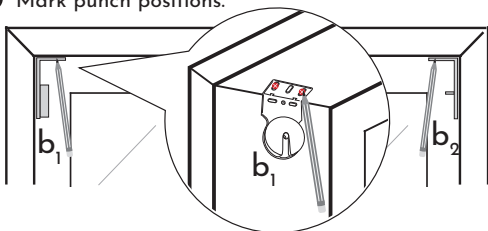

- 2 Drill holes & install mounting brackets.

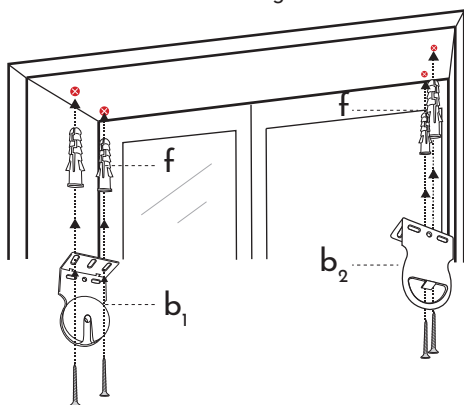

- 3 Install the side where the motor is located.

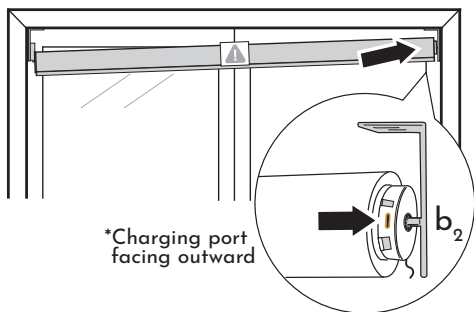

4 Install the other side.

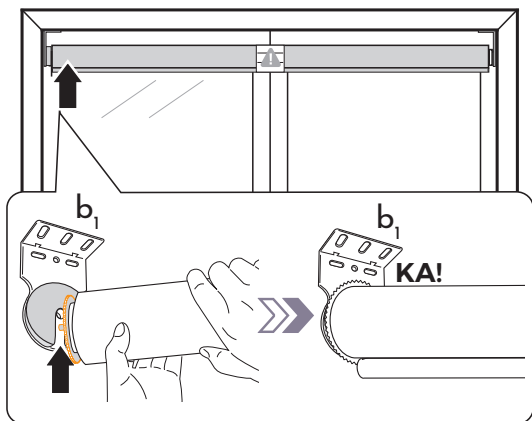

5 Remove paper seal.

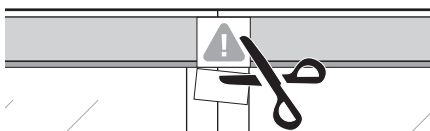

6

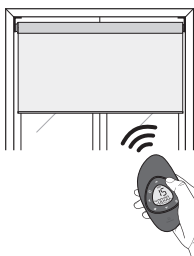

Your blind has been programmed,
please use directly.



OUTSIDE MOUNT

10

- ① Put mounting brackets on both sides of the blind.



- ② Mark bracket positions

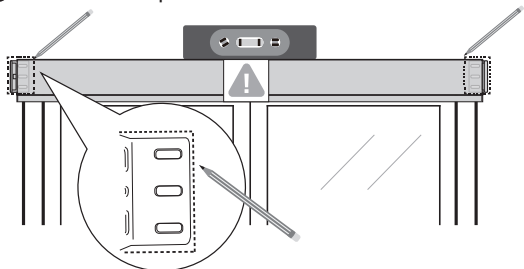

- ③ Remove mounting brackets.

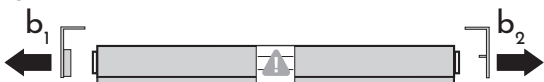

- ④ Mark punch positions.

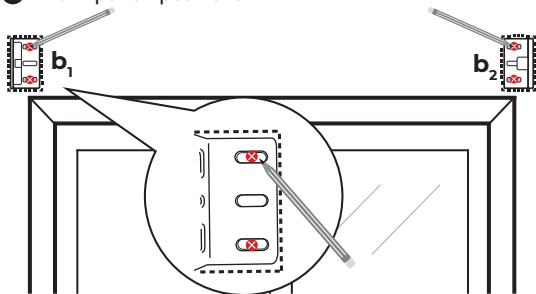

- ⑤ Drill holes & install mounting brackets.

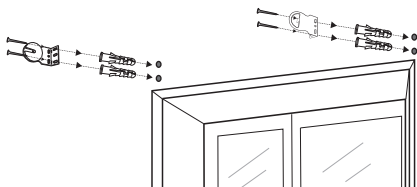

- ⑥ Install the side where the motor is located.

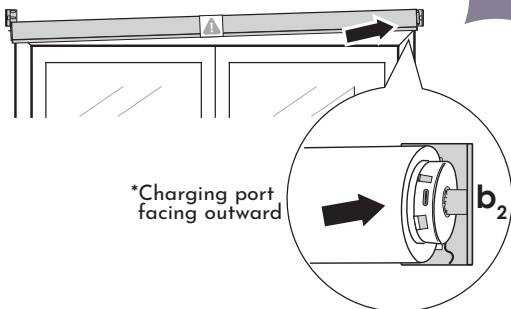

- ⑦ Install the other side.

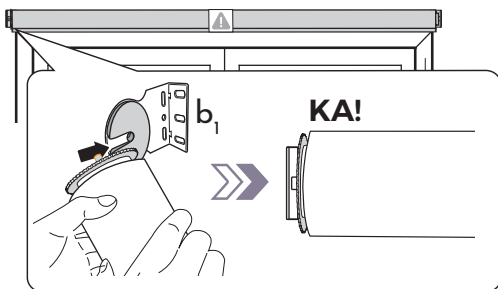

- ⑧ Remove paper seal.

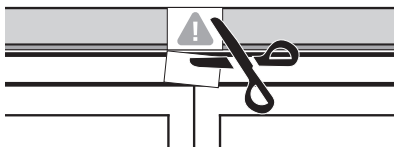

- ⑨

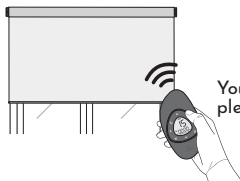

Your blind has been programmed,
please use directly.



A-5 TAKE DOWN THE BLIND

12

WITH VALANCE

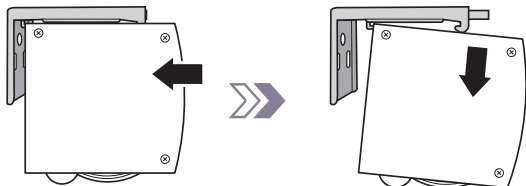

*Push the blind inward

NO VALANCE

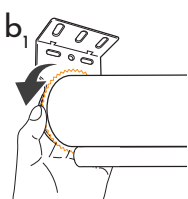
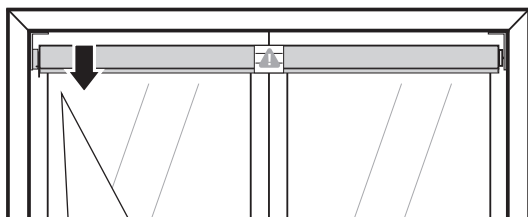

Rotate the gear by 45° vigorously.

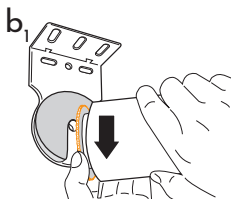

Keep rotating by 45° and take it out.



🔗 ENGLISH VERSION |

Please scan the QR code below to get the PDF manual in English.

🔗 GERMAN VERSION |

Bitte scannen Sie den untenstehenden QR-Code, um die PDF-Broschüre auf Deutsch zu erhalten.

🔗 JAPANESE VERSION |

以下の QR コードをスキャンして、日本語の PDF マニュアルを入手してください。

