

# Meet your **tweetycam** User Manual



5" HD VIDEO BABY MONITOR

## Warning and safety instructions

### Warnings

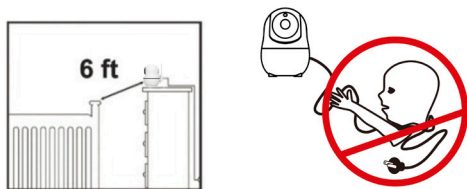

**STRANGULATION HAZARD:** Children can become entangled in cords. Make sure the Tweetycam camera, Tweetycam monitor, and mains adapter cables are always kept out of reach of your baby and other young children, and at least 6 feet away.

**CHOKING HAZARD:** This product contains small parts which may cause choking. Exercise care when unpacking and assembling the product and keep the small parts away from children.

**RISK OF SUFFOCATION:** Keep all packaging materials and protective foils out of reach of children.

**DANGER FROM POWER CORDS:** To avoid danger from the power cords the cords should be secured and never hung on or near the crib. Never place the Tweetycam camera or Tweetycam monitor inside your baby's crib, bed, or playpen.

**DO NOT HANDLE ROUGHLY, DROP OR THROW:** This baby monitor is a high-quality electronic device which must be handled with care.

**WATER AND MOISTURE:** The product should not be exposed to rain, moisture, or splashing. Never use or place the product in or near moisture or water.

**THIS PRODUCT CANNOT REPLACE RESPONSIBLE ADULT SUPERVISION:** Your video monitor is designed to be an aid and should not be used as a substitute for responsible and proper adult supervision of a child.

**VENTILATION:** This product should not be used on a bed, sofa, rug, or similar surface that may block the ventilation or speaker openings, or be placed in an enclosed area, such as a bookcase or drawer that may impede airflow. Never cover the product with clothes, towels, blankets, or any other item.

**THIS PRODUCT IS NOT A TOY:** It should be kept out of children's reach.

**KEEP AWAY FROM SOURCES OF HEAT:** This unit should not be exposed to direct heat sources such as a candle, stove, radiator, heat register or other appliance that emit heat. The unit should not be left in direct sunlight.

**BATTERY:** Before you use the product, we recommend you fully charge the battery of the Tweetycam monitor so that it continues to work if you disconnect it from the power supply and can carry it to another location.

**INSTALLATION LOCATION:** The installation location plays an important role in ensuring proper operation. Therefore, maintain a distance of at least 5 feet from other electronic equipment, such as microwave ovens or Wi-Fi routers, otherwise they could cause interference. If this occurs, move the Tweetycam camera/s and Tweetycam monitors to another location.

**RANGE:** Range of all baby monitors is always measured in an open space. The actual range may be shortened due to environmental obstacles (such as concrete walls).

**DAMAGE REQUIRING SERVICE:** This product should be serviced by qualified personnel only.

**DO NOT TRY TO OPEN AND REPAIR THE PRODUCT:** If you have any problems with the product, please contact Tweetycam Support. In case of unusual noises or smells originating from the device, immediately disconnect the product from the power outlet and contact Tweetycam Support. If the product becomes dirty, use a lightly damp soft cloth to wipe surfaces, taking care to not allow water into any openings.

**IMPORTANT:** This baby monitor is designed only for hearing the baby's voice and seeing the images of the baby. This product is not a medical device and should not be used as a substitute for responsible adult supervision. It is important that you regularly check on your baby personally.

## Safety instructions for AC power adapter

- The adapter should not be exposed to direct heat sources such as a candle, stove, radiator, heat register or other appliance that emits heat.
- During continual use, the power adapters may become warm to the touch. This is normal and should not be a cause for concern. Examine intactness of the power cord and its plug.
- The adapter must be handled with care: Do not handle roughly, drop or throw.
- When removing the power adapter from the wall outlet, hold and pull from the receptacle.
- Do not pull on the cable itself or bend the cable as that will put additional stress on the cable and could lead to damage. Do not touch the power adapter with wet hands or allow liquids to spill on it.
- Make sure the mains adapter cables are always kept out of reach of your baby and other young children.
- To avoid danger from power cords, the cords should be secured and never hung on or near the crib.
- Do not replace the plugs or cable on your power adapter. This product should only be used with the AC power adapter supplied by the manufacturer, as included in this package.
- Never cut, damage, or bend the power cord.
- Do not put any objects on top of the power cord, which could cause overheating, damage, combustion, and electrocution. Do not leave the power adapter connected to the wall outlet when it is not plugged into the Tweetycam camera or Tweetycam monitor.

### WARNING:

Do not replace the power cord with non-original substitutes. Improper connection may cause electrocution. Do not place the AC adaptor cable in a high wear and tear location. Never use a frayed or compromised cord.

Intended for indoor use only.

## Safety instructions for li-ion battery (non-removable pre-installed battery)

- Do not attempt to repair or adjust any of the electrical or mechanical functions of the unit.
- Do not dismantle, cut, open, crush, bend, puncture, or shred cells or batteries.
- If a battery leaks, do not let the battery liquid touch skin or eyes. If this happens, immediately flush the affected areas with water, and seek medical assistance.
- The battery should not be exposed to direct sunlight or heat sources such as a candle, stove, radiator, heat register or other appliances that emit heat.
- Do not modify, re-manufacture, attempt to insert foreign objects into the battery, or immerse or expose it to water or other liquids. Batteries may explode if damaged.
- Use only the battery pack supplied with the product or the same type sold by the manufacturer or Tweetycam. Improper use or use of unapproved batteries may present a risk of fire, explosion, or other hazards, and may invalidate the warranty.
- If you believe the battery is damaged, remove the product from the charge and stop using the product. Never use a damaged battery.

## Information on disposal of product

Always dispose of your product (with the non-removable pre-installed battery) at the end of their life in an environmentally responsible way and in accordance with your local waste disposal requirements. All cardboard and paper packaging materials should be recycled in accordance with your local council waste regulations.

## What's in the box

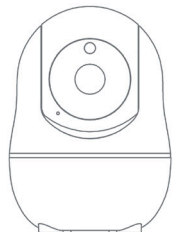

1 x Tweetycam camera



1 x Tweetycam monitor



1 x User Manual



1 x Wall Mount Shim



2 x Screw Set

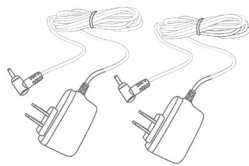

2 x AC Power Adapter

## Your Tweetycam monitor

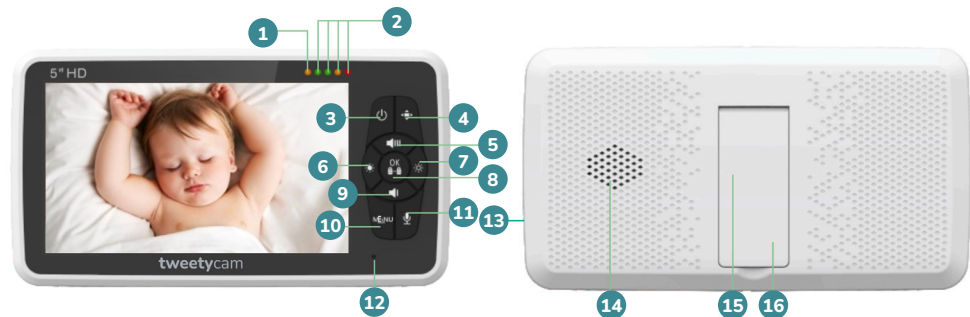

1 Power/Charging LED

2 Volume LEC

3 Power on/off

4 Pan/Tilt

5 Volume+/Up

6 Brightness-/Left

7 Brightness+/Right

8 OK/Switch

9 Volume-/Down

10 Menu

11 Push to Talk

12 Mic

13 DC-jack

14 Speaker

15 Stand

16 Reset (under the stand)

## Your Tweetycam camera

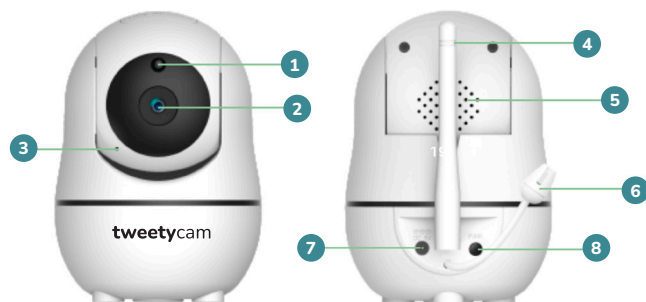

- 1 Light sensor
- 2 CMOS sensor
- 3 MIC
- 4 Antenna
- 5 Speaker
- 6 Temperature Sensor
- 7 DC Jack
- 8 PAIR

## Camera placement (wall mount):

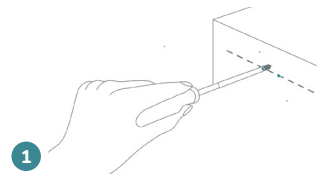

1

Use a screwdriver to make two horizontal holes in the wall. The distance between the two holes should be equal to the distance between the two holes of the wall mount shim.

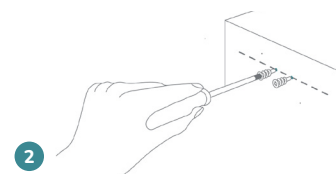

2

Push the wall anchors into the hole and screw them until they are flush.

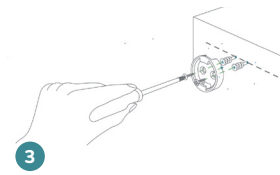

3

Position the wall mount over the holes of the anchors, screw the screws into the holes and secure the wall mount until flush with the wall.

NOTE: Do not overtighten.

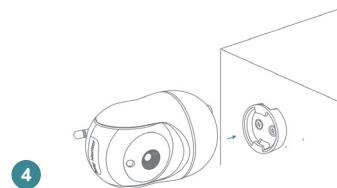

4

Put the Tweetycam camera into the wall mount.  
NOTE: Align the center of the Tweetycam camera to the center of the wall mount shim in the direction shown.

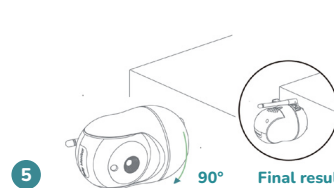

5

Rotate the base of the Tweetycam camera about 90° until it clicks.



90° Final result

## Quick start guide



**Step 1**  
Connect the AC power adapter to the Tweetycam camera. Plug the AC power adapter into a power socket.



**Step 3**  
Press **MENU** button to access the menu. Choose  and press **OK**. Select  + and select the camera you want to pair. Press **OK** to confirm.



**Step 2**  
Press  for two seconds to turn on the Tweetycam monitor.



**Step 4**  
Follow the on-screen prompts and press and hold the **PAIR** button on the Tweetycam camera for 2 seconds, or until there is a ★ next to the paired .

## Tweetycam feature overview

### Voice activation (VOX)

Our voice activation feature detects noise in your baby's room. VOX has 3 settings (low, medium, and high) allowing you to set the level of noise sensitivity that will activate both the monitor and sound.

### Split screen

Allows you to see two cameras at the same time on the large 5" screen.

### Scan mode

Useful if you have more than one camera. Scan mode will display both the sound and video of each camera in rotation every 15 seconds.

### Scan mode with split screen

Plays the sound of each camera in rotation every 15 seconds when you are in split screen mode.

### 360° Pan/tilt

Gives you a 360° panoramic view of your baby's room from the comfort of the Tweetycam monitor.

### 180° Flip

Need to hang your Tweetycam camera upside down to get the best view? No problem. Use the flip setting to set your camera rotation to 180°.

### Advanced night vision

Allows you to see your baby clearly at night. Can be set to On/Off/Auto from the Tweetycam monitor.

### Digital zoom

2X and 4X zoom capability, operated from the Tweetycam monitor.

### Temperature monitor

Allows you to create the perfect ambience for your baby when you select on the monitor a minimum and maximum temperature threshold

### Temperature alert settings

If the temperature of your baby's room moves above or below your pre-set temperature thresholds, the monitor will alert you.

### Sweet lullabies

Calm your baby with Tweetycam's playlist of soothing sounds, lullabies, and white noise selected directly on the Tweetycam monitor.

### Push to talk

Communicate with your baby from anywhere in your home with Tweetycam's 2-way communication feature.

### Frequency setting

This is the frame rate per second of the Tweetycam monitor. At 50Hz the monitor generates 50 image frames per second, while at 60Hz the monitor produces up to 60 image frames per second. 60 Hz produces smoother video results.



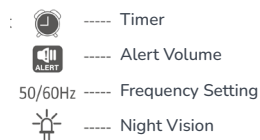
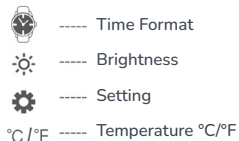
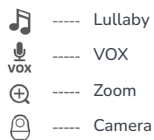

## Icons overview

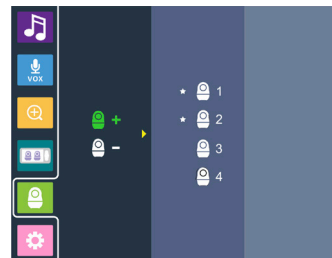

## Features set-up



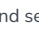

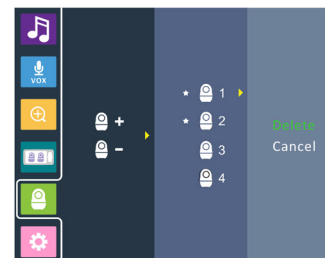

### Pair Tweetycam camera and monitor

1. Press **MENU** button to access the menu. Choose  and press .
2. Navigate with  to select  and select the camera you want to pair. Press  to confirm.
3. Follow the on-screen prompts and press and hold the **PAIR** button on the Tweetycam camera for 2 seconds, or until there is a ★ next to the paired .
4. Press **MENU** to exit the menu.





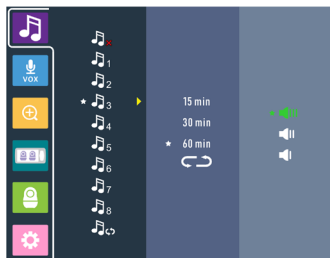

### Un-pair Tweetycam camera

1. Press **MENU** button to access the menu. Choose  and press .
2. Navigate with  to select the  and then navigate to the camera you want to un-pair. Navigate to OK and press the  button to confirm.
3. Press **MENU** to exit the menu.

NOTE: Before you begin pairing, make sure to have the Tweetycam camera and monitor side by side and switched on.





### Sweet sweet lullabies

1. Press **MENU** button to access the menu. Choose  and press .
2. Select the lullaby you want to play.
3. Navigate with  to select the duration and music volume and press  to set.
4. To stop the lullaby playback select  from the lullaby menu.
5. Press **MENU** to exit the menu.

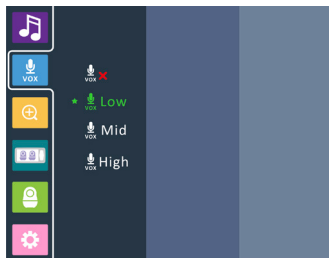
NOTE: The lullaby default setting is off.





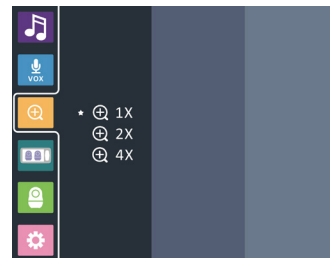

### Voice activation (VOX) mode

1. Press **MENU** button to access the menu. Choose  and press.
2. Navigate with  to select the desired VOX sensitivity setting (Low / Mid / High) and press  to set.
3. Press **MENU** to exit the menu.

NOTE: To resume the video and audio signal manually on your Tweetycam monitor when VOX Mode is on, lightly press any key on your Tweetycam monitor to activate the monitor.





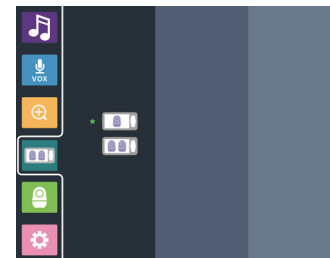

### Digital zoom

1. Press **MENU** button to access the menu. Choose  and press .
2. Navigate with  button to select the desired zoom amount and press  to set.
3. Press **MENU** to exit the menu.



### Split screen

1. Press **MENU** button to access the menu. Choose  and press .
2. Navigate with  to select the split screen function as follows: , and press  to confirm.
3. Press **MENU** to exit the menu.

NOTE: This function is only available when two or more cameras are paired.





### 360° Pan/tilt mode

1. Press the button to enter pan/tilt mode.
2. Press the buttons to pan and tilt the camera up/down/left/right as desired.
3. Press to exit pan/tilt mode.

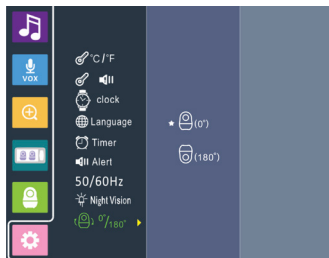

### 180° Flip

1. Press **MENU** button to access the menu. Choose and press .
2. Select and press .
3. Navigate with to select the desired camera rotation and press to set.
4. Press **MENU** to exit the menu.

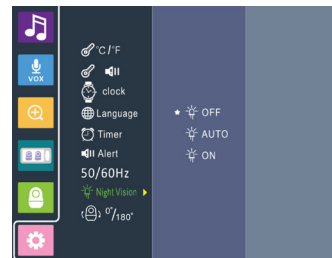





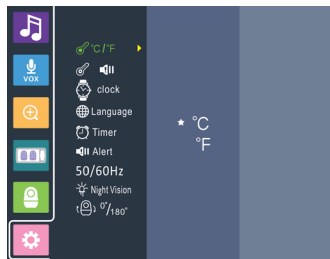

### Advanced night vision

1. Press **MENU** button to access the menu. Choose and press .
2. Select and press .
3. Navigate with to select the desired night vision status and press to set.
4. Press **MENU** to exit the menu.

## Tweetycam monitor set-up







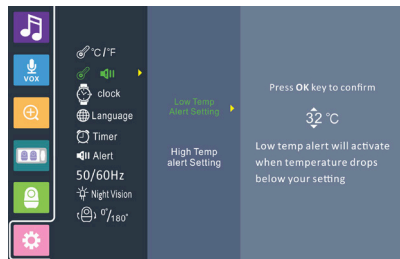

### Temperature scale setting

1. Press **MENU** button to access the menu. Choose  and press .
2. Select  and press .
3. Navigate with  to select the desired temperature scale, i.e., °C/°F, and press  to set.
4. Press **MENU** to exit the menu.





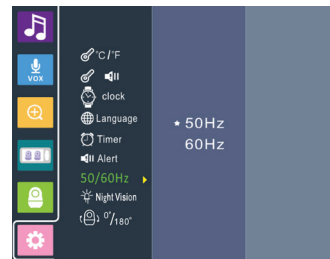

### Temperature alert settings

1. Press **MENU** button to access the menu. Choose  and press .
2. Select  and press .
3. Navigate with  to select a Low or High temperature alert setting and set the desired temperature. Press  to set.
4. Press **MENU** to exit the menu.







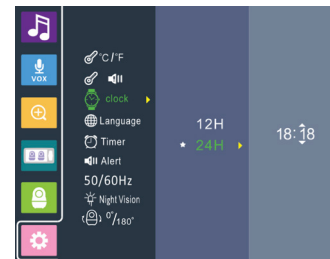

### Frequency setting

1. Press **MENU** button to access the menu. Choose  and press .
2. Select **50/60Hz** and press .
3. Navigate with  to select the desired frequency and press  to set.
4. Press **MENU** to exit the menu.







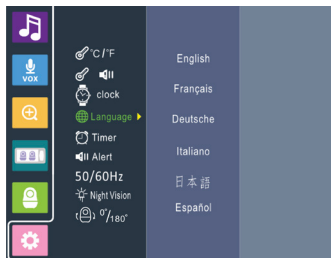

### Time settings

1. Press **MENU** button to access the menu. Choose  and press .
2. Select  and press .
3. Navigate with  to select the desired time format and to set the time. Press  to set.
4. Press **MENU** to exit the menu.

NOTE: Do not position the temperature sensor too close to the camera body as it may affect the correct temperature reading. It is recommended to stretch out the sensor, so it is as far away from the camera body as possible. Place the camera in an area where there is good air circulation and not in a closed area where the temperature tends to be higher.







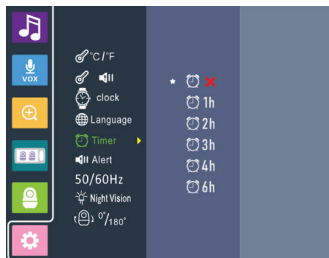

### Language settings

1. Press **MENU** button to access the menu. Choose  and press .
2. Select  and press .
3. Navigate with  to select the desired language and press  to set.
4. Press **MENU** to exit the menu.







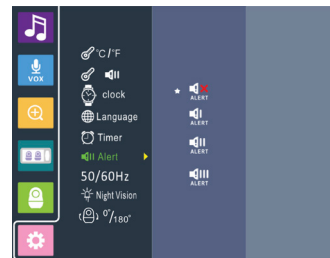

### Timer setting

1. Press **MENU** button to access the menu. Choose  and press .
2. Select  and press .
3. Navigate with  to select the desired timer and press  to set.
4. Press **MENU** to exit the menu.



### Warning alert volume setting

1. Press **MENU** button to access the menu. Choose  and press .
2. Select  and press .
3. Navigate with  to select the desired alert volume and press  to set.
4. Press **MENU** to exit the menu.

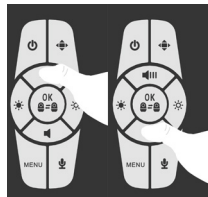

### Volume/brightness adjustments

Press or to increase/decrease the sound of the Tweetycam monitor.

Press or to increase/decrease the brightness of the Tweetycam monitor.



### Scan mode

Press and hold the button to activate and deactivate scan mode.



### Switching between two paired cameras

Lightly press the button on your Tweetycam monitor.



### Push to talk

Press and hold the button to talk to your baby. Release the button to stop talking.

## Karen's pro tips to get the most out of your Tweetycam battery

These tips from Tweetycam's creator and mum of two, Karen, will help you maximise the battery life of your Tweetycam monitor:



### Dim that brightness

Just like your smartphone, your monitor's screen brightness can be a battery drainer. By keeping it down a notch, you can enjoy up to 12 hours of monitoring time.



### Activate VOX mode

When silence reigns the screen goes black, and the moment there's a peep from your baby the screen comes back to life. VOX mode keeps you connected for over 12 hours by activating the monitor only when it is needed most.



### Blackout by choice

Give your screen a break by manually turning it black with a light tap of the ON/OFF button. But here's the cool part; even when the screen is black the sound remains active, so you can still hear your baby and know when you need to check in. This is a great alternative to VOX mode if you have multiple cameras connected to the monitor.

## Troubleshooting

### No reception on the Tweetycam monitor

The power adapters may not be properly connected.  
Ensure that the Tweetycam camera and monitor are on.  
Make sure the Tweetycam camera and monitor are not far away from each other.  
Tweetycam camera and monitor may not be properly paired. Please follow pairing instructions.

### Interference or poor reception

Move the Tweetycam camera closer to the Tweetycam monitor.  
Use of other 2.4GHz product, such as wireless networks (Wi-Fi routers), Bluetooth systems, or microwave ovens, may cause interference with this product, so keep the Tweetycam monitor at least 5ft (1.5m) away from these types of products or turn them off if they appear to be causing interference.  
The Tweetycam camera or monitor may be too close to metal objects.  
The battery power may be too low.

### Picture is black and white

Automatic night vision mode may be on. Increase lighting in the room where the camera is located to force the monitor out of night vision mode.

### Image frozen on the Tweetycam monitor

Restart the Tweetycam camera; unplug the power adapter from the wall outlet, wait for approx. 5 seconds and plug it back into the wall outlet.  
Reset the Tweetycam monitor by pressing and holding for 15 seconds the Reset button (page 5, item 16), located at the back of the Tweetycam monitor, under the stand.

### A high-pitched sound is audible from the Tweetycam monitor (feedback, static)

The Tweetycam camera and monitor may be too close to each other. Move them further apart.  
The volume on the Tweetycam monitor may be set too high. Lower the volume.

### Cannot hear the baby sounds on the Tweetycam monitor

The volume setting on the Tweetycam monitor may be too low. Increase the volume.  
Battery power may be too low. Recharge the battery.

### Background noises

In a quiet environment, surrounding the Tweetycam monitor, decrease the volume on your Tweetycam monitor to level 3 and below.  
In a loud environment, surrounding the Tweetycam monitor, increase the volume to the maximum level.

## Product specifications and technical data sheet

<b>Frequency</b>	2.4GHz FHSS
<b>Type of Modulation</b>	GFSK
<b>Data Rate</b>	4 Mbps
<b>Channel Bandwidth</b>	3.3758 MHz
<b>Transmission Range</b>	Up to 960 feet/300 meters (open space with no obstructions)
<b>Input Voltage</b>	5V,1A
<b>Power Adapter Input</b>	100-240VAC50/60Hz
<b>LCD Screen</b>	5.0HD TFT LCD (1280*720 pixels)
<b>Rechargeable Battery (pre-installed in Tweetycam monitor)</b>	Model: YB905560 3.7V,4000mAh
<b>Transmission Power</b>	18dB
<b>Image Sensor Type</b>	1/4"Color CMOS
<b>IR LED Type</b>	940nm
<b>Optimal Environment</b>	Indoor use only, Temperature: 32-104°F/0-40°C, Humidity: 5%-90%rh (relative humidity)

## Maintenance and warranty

### Maintenance

- All the following maintenance procedures should be performed only when the Tweetycam camera/s and Tweetycam monitors are unplugged and off.
- Clean the surfaces of the Tweetycam camera/s and Tweetycam monitors with a soft, fluff-free cloth.
- Never use cleaning agents or solvents.
- If the units become dirty use a lightly damp cloth to wipe surfaces, taking care not to allow water into any openings.

### Warranty terms

We take quality very seriously. This is why all our products come with a 12-month warranty and lifetime technical support. The warranty terms do not apply to any product that has been subject to abuse, misuse, negligence, or accident.

If you have warranty or support issues, please contact Tweetycam Support before leaving your review.

### Information on disposal of product

Always dispose of your product (with the non-removeable pre-installed battery) at the end of their life in an environmentally responsible way and in accordance with your local waste disposal requirements. All cardboard and paper packaging materials should be recycled in accordance with your local council waste regulations.

**Need help?**

Tweetycam support is a dream.

We take great pride in providing exceptional consumer service. No question is too small.

Contact us at **support@tweetycam.zohodesk.com** or on the phone  
**0424 681 859.**

### **Follow us**

Stay updated with the latest tips and tricks to improve your little ones' sleep, get product updates, and catch a glimpse of what the Tweetycam family is doing by following us.

 **/tweetycam**

 **/tweety.cam**