



Model: **FB-300-120M12**

**Nightpower Transformer**

**SPECIFICATION FEATURES**

The Forever Bright landscape lighting transformer series. Featuring multiple voltage outputs from 12-15 volts.

Stainless steel enclosure is rain-tight with hinged lockable cover and multiple knockouts throughout bottom and sides. Features include removable timer and field installed photocell. All units "plug and go" ready for field install accessories.

**FEATURES & OPTIONS:**

- STAINLESS STEEL NEMA STYLE RAIN-TIGHT KEYHOLE MOUNT ENCLOSURE
- LARGE WIRING VOLTAGE TAP LUGS
- COMPLETE WIRING INSTRUCTIONS
- TIMER, 24 HOUR REMOVABLE
- PHOTOCELL, FIELD INSTALL
- 6' OUTDOOR LINE CORD
- LOW VOLTAGE CIRCUIT BREAKER. ONE BREAKER PROTECTING EACH OUTPUT CIRCUIT
- ETL 1838
- LIFETIME WARRANTY

**DESCRIPTION**

**Model#:** FB-300-120M12  
**Shown:** Stainless Steel  
**Electrical Input:** 120V  
**Electrical Output:** 12-15V  
**Max. Watts:** 300 Watts  
**Circuit:** 1 Circuit  
**Dimmable:** Yes

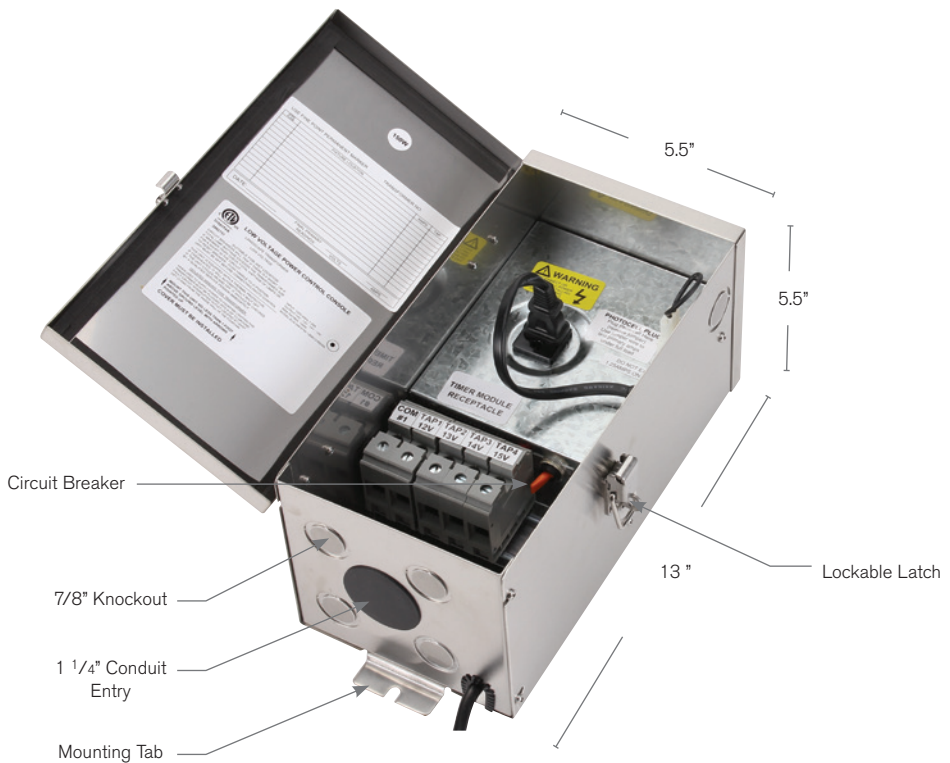

Wet Listed

**ORDERING INFORMATION**

Model#	Electrical Input	Electrical Output	Wattage	Circuit
<b>FB-300-120M12</b>	<b>120V</b>	<b>12-15V</b>	<b>300W</b>	<b>1</b>
	120V	12-15V	300W	1