

SPEED BAG BLADDER: REPLACEMENT INSTRUCTIONS

In Cleto Reyes, we use the highest quality standards to fulfill your expectations. We continuously look for raw materials to increase the longevity of our products. To extend the life of your speed bag, we are including a bladder replacement. Below are the steps to replace the bladder and we also recommend that you read it completely before begin the replacement.

Materials:

- Speed bag
- Replacement Bladder
- Sandpaper
- Contact glue
- Pump, valve and oil
- Lace and scissors
- Stick with blunt end

1

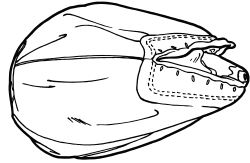

Deflate the speed bag and take off the lace.

4

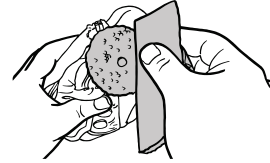

Sand the circular leather base to remove any residue which will ensure proper glue adhesion.

7

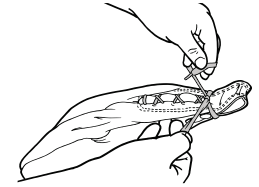

Turn over the speed bag and place inside the bladder carefully to avoid a misshapen speed bag.

Cross the laces firmly on the speed bag.

2

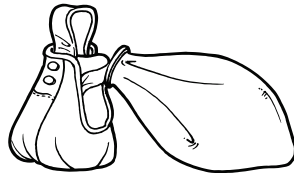

Push the speed bag base with the blunt end of the stick to remove the old bladder. **Be careful no to push too hard.**

5

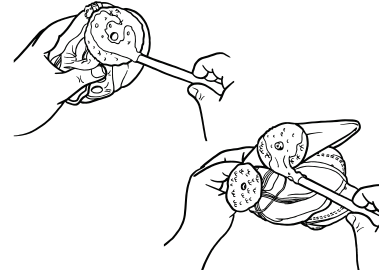

Apply a thin layer of glue over the bladder base and over the circular leather base.

8

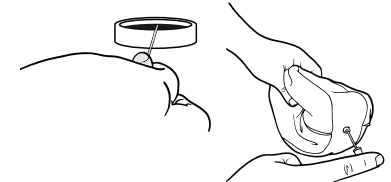

Lubricate the valve with oil.

Introduce the valve into the pivot of the latex bladder. Insert smoothly and add additional lubricant when needed until the entire valve is inserted into the bladder.

3

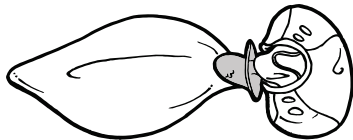

Separate the old bladder from the circular leather base of the speed bag, making sure to avoid removing the leather base.

6

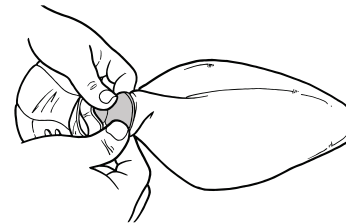

Press both surfaces together for a minute to ensure adhesion.

9



Inflate until obtain 10lb. pressure (recommended)

CAUTION: Be very careful to introduce the valve slowly into the bladder, otherwise, a tear could be caused in the rubber of the pivot and therefore produce a leak.