



INSTALLATION INSTRUCTIONS

PART No.

FB25103

**Jeep® TJ Wrangler
Wheel Well Storage Bins**

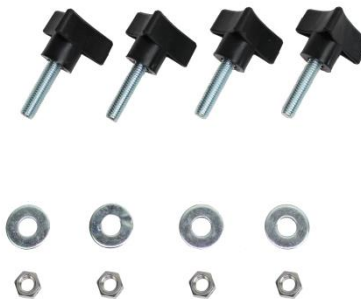

REQUIRED TOOLS

12MM Socket/ Wrench
(OPTIONAL)
T40 Torx Bit
Drill (for '97 - '02)

KIT CONTAINS

Storage bins (Left and Right)
Quick Install Knobs
Washers
Nuts (for soft-tops only)

QTY

1 EA
4
4
4

There are three (3) installation methods depending on your Jeep's current configuration. Please follow the instructions accordingly:

- A. Hard top with top on
- B. Hard top with top off
- C. Soft top* – with top up or down

*** NOTE: Soft top Jeeps did not come from the factory with the hard top nut with clip. This configuration will need to use the supplied extra four (4) washers and four (4) nuts to complete installation.**



'97-'02 Models will require this hole to be drilled & created

2510300

Jeep® TJ Wrangler Wheel Well Storage Bins



A. FOR HARD TOP MODELS WITH TOP ON:

1) **UNBOLT YOUR HARD TOP**

Inside your lift gate your hardtop will be bolted down by 6 bolts, with 3 on either side. Remove them using a T40 Torx bit.

2) **INSTALL STORAGE BINS**

Place the corresponding bin below the tub rail and align below the factory holes.

Either using all of your OEM hardware, or the supplied four (4) knobs and washers, secure the storage bins in place. Reuse your factory hardware to finish securing your hard top.

NOTE: Hard top Jeeps will not use the supplied nuts, and only the four (4) washers.

B. FOR HARD TOP MODELS WITH TOP OFF:

1) **INSTALL STORAGE BINS**

With the top already off the Jeep, simply place the storage bins below the Jeep tub rail and align below the factory holes. Secure in place using the supplied knobs and washers and utilize the OEM hard top nut with clip.

C. FOR SOFT TOP MODELS

1) **INSTALL STORAGE BINS**

With or without the soft top on (or down), simply place the storage bins below the Jeep tub rail and align below the factory holes.

Using the supplied four (4) knobs, four (4) washers, and four (4) nuts, securely fasten the storage bins in place.



You may find it easier to hold the nut in place with a 12mm socket or wrench. You should only hand tighten the knob.

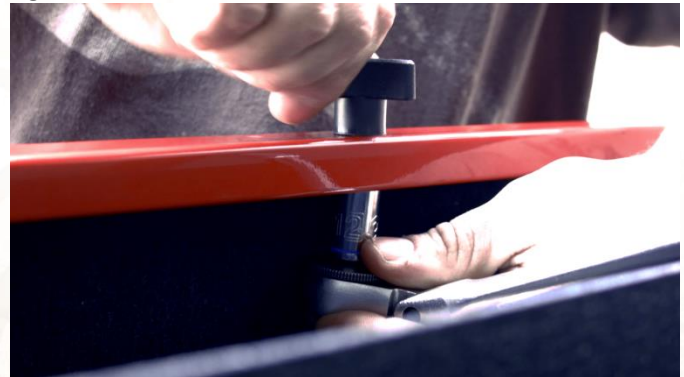

***NOTE: On 1997 - 2002 Models the front most hole will need to be drilled.**

ENJOY YOUR NEW SET OF WHEEL WELL STORAGE BINS!