

MASKELL RIGGING



**2195 RAILROAD ST
CORONA, CA 92878**

(951) 900-7460

**(SDB)
(WBE)
(WOSB)
(WBE)**

WWW.MASKELL-RIGGING.COM



(951) 900-7460

2195 RAILROAD ST. CORONA, CA 92878



Maskell Rigging is a family business and continues to provide excellent service to our customers in the crane, transport, underground, and construction industries. Our capabilities include repair, manufacturing, and testing of chain and wire rope assemblies. We offer a variety of rigging products from overhead lifting hooks and chain, transport chain and binders, eye and eye straps, round slings, wire rope and chain assemblies, and more. We are your number one supplier for all your rigging needs.



Standard Eye
Machine Swaged



Thimble Eye
Machine Swaged



Soft Eye
Hand Spliced



Thimble Eye
Hand Spliced



Steel Ferrule
Machine Swaged



Closed Swage
Socket



Open Swage
Socket



Closed Spelter
Socket

GENERAL PURPOSE & ROTATION RESISTANT WIRE ROPE

GENERAL CLASSIFICATION CROSS-SECTION ACTUAL CONSTRUCTIONS

6 X 19



6 x 25 Filler Wire*



6 x 21 Filler Wire



6 x 19 Seale*

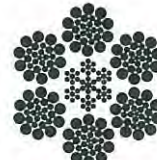

6 x 26 Warrington Seale

6 strands containing 15 through 26 wires, with a maximum of 12 outside wires.

**Construction Count
(Inside to Outside)**

6 x 25 (FW):	1 - 6 - (6) - 12
6 x 21 (FW):	1 - 5 - (5) - 10
6 x 19 (S):	1 - 9 - 9
6 x 26 (WS):	1 - 5 - (5+5)-10

*Also available in Fiber Core

6 X 37



6 x 36 Warrington Seale*



6 x 41 Warrington Seale



6 x 31 Warrington Seale

6 strands containing 27 through 49 wires, with a maximum of 18 outside wires.

**Construction Count
(Inside to Outside)**

6 x 36 (WS):	1 - 7 - (7+7) - 14
6 x 41 (WS):	1 - 8 - (8+8) - 16
6 x 31 (WS):	1 - 6 - (6+6) - 12

*Also available in Fiber Core

19 X 7
Rotation-
Resistant



19 x 7

19 strands containing 7 wires each. The 7 x 7 core is left lang lay, the 12 outer strands are right regular lay. These directional changes result in a rotation-resistant characteristic.

8 x 19
Rotation-
Resistant



8 x 25 Filler Wire

8 strands containing 15 through 26 wires each. Using a 7 x 7 wire core in left lang lay, coupled with 8 outer strands of right regular lay again promote rotation-resistant properties.

General-Purpose Wire Rope

DIA. INCHES	6 x 19 • 6 x 37 CLASS Fibre Core - I.P.S.		6 x 19 • 6 x 37 CLASS Independent Wire Rope Core-E.I.P.S.		
	Weight Lbs./Ft	Nominal Strength Tons-BRT.	Weight Lbs./Ft	Nominal Strength-Tons	
				BRT.	GALV.
3/16	.059	1.55	—	—	—
1/4	.105	2.74	.116	3.40	3.06
5/16	.164	4.26	.18	5.27	4.74
3/8	.236	6.10	.26	7.55	6.80
7/16	.32	8.27	.35	10.2	9.18
1/2	.42	10.7	.46	13.3	12.00
9/16	.53	13.5	.59	16.8	—
5/8	.66	16.7	.72	20.6	18.50
3/4	.95	23.8	1.04	29.4	26.50
7/8	1.29	32.2	1.42	39.8	35.80
1	1.68	41.8	1.85	51.7	46.50
1 1/8	2.13	52.6	2.34	65.0	—
1 1/4	2.63	64.6	2.89	79.9	—
1 3/8	—	—	3.50	96.0	—
1 1/2	3.78	92.0	4.16	114.0	—

Rotation Resistant Wire Rope

DIA. INCHES	19 x 7 E.I.P.S.		8 x 25 I.W.R.C. • E.I.P.S.	
	Weight Lbs./Ft	Nominal Strength- Tons	Weight Lbs./Ft	Nominal Strength-Tons
3/16	.064	1.57	—	—
1/4	.113	2.77	—	—
5/16	.177	4.30	—	—
3/8	.252	6.15	—	—
7/16	.346	8.33	—	—
1/2	.431	10.8	.47	11.6
9/16	.577	13.6	.60	14.7
5/8	.714	16.8	.73	18.1
3/4	1.02	24.0	1.06	25.9
7/8	1.39	32.5	1.44	35.0
1	1.82	42.2	1.88	45.5
1 1/8	2.30	53.1	—	—

WARNING: The nominal strengths listed throughout this publication are the results of testing under ideal conditions: straight pull, no bending, ambient temperatures, with loading applied at a gradual speed. In most applications, the applied load should not exceed 20% of the nominal strengths.

Diameter Tolerance

Nominal Diameter	Tolerance In. (-0)	Maximum Dia.-In.
3/64"	+.008	.055
1/16"	+.010	.073
3/32"	+.012	.106
1/8"	+.014	.139
5/32"	+.016	.172
3/16"	+.018	.206
7/32"	+.018	.237
1/4"	+.015	.265
5/16"	+.015	.328
3/8"	+.019	.394
7/16"	+.021	.459
1/2"	+.025	.525
9/16"	+.028	.591
5/8"	+.031	.656
3/4"	+.038	.788
7/8"	+.044	.919
1"	+.050	1.050
1 1/8"	+.056	1.181
1 1/4"	+.063	1.313
1 3/8"	+.069	1.444
1 1/2"	+.075	1.575

Above tolerances refer to: Aircraft Cable, 3/64" thru 7/32" Wire Rope, 1/4" thru 1 1/2".

HOW TO MEASURE WIRE ROPE

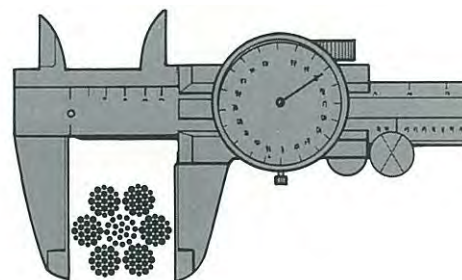

The true diameter of wire rope is measured at it's largest point.

WIRE ROPE SLING WORKING LOAD LIMITS

6X19 AND 6X36 CLASS

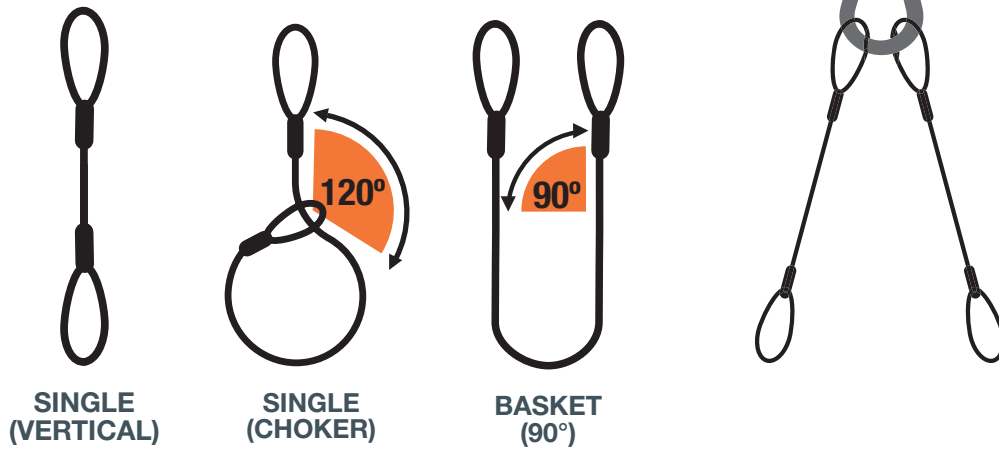

Wire Rope Size	WORKING LOAD LIMIT (TONS)					
	Single (1 Leg) Vertical	Single Choker	Basket 90°	2 Leg Bridle		
				30°	45°	60°
EIPS-MS-IWRC (EXTRA IMPROVED PLOW STEEL, MECHANICAL, SPLICE, INDEPENDENT WIRE ROPE CORE)						
1/4"	0.65	0.48	1.3	0.65	0.91	1.1
5/16"	1	0.74	2	1	1.4	1.7
3/8"	1.4	1.1	2.9	1.4	2	2.5
7/16"	1.9	1.4	3.9	1.9	2.7	3.4
1/2"	2.5	1.9	5.1	2.5	3.6	4.4
9/16"	3.2	2.4	6.4	3.2	5.5	6.8
5/8"	3.9	2.9	7.8	3.9	5.5	6.8
3/4"	5.6	4.1	11	5.6	7.9	9.7
7/8"	7.6	5.6	15	7.6	11	13
1"	9.8	7.2	20	9.8	14	17
1-1/8"	12	9.1	24	12	17	21
1-1/4"	15	11	30	15	21	26
1-3/8"	18	13	36	18	25	31
1-1/2"	21	16	42	21	30	37
1-5/8"	24	18	49	24	35	42
1-3/4"	28	21	57	28	40	49
1-7/8"	32	24	64	32	46	56
2"	37	28	73	37	52	63

Chart is for reference only.

Based on OSHA standards - Always use the sling tag for the working load limits or consult sling manufacturer. Note: Rated loads based on a minimum D/d of 25:1

6 Values listed in US tons.

3-LEGBRIDLE

6X19 AND 6X36 CLASS

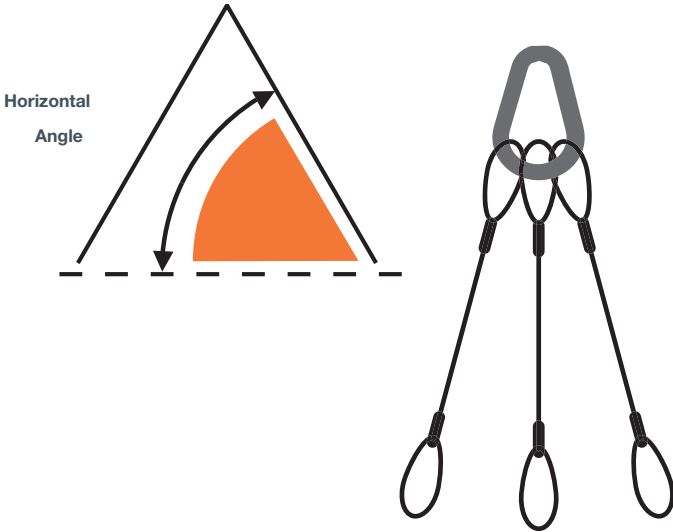

Wire Rope Size (in.)	WORKING LOAD LIMIT (TONS)			
	Vertical	60°	45°	30°
EIPS-MS-IWRC (EXTRA IMPROVED PLOW STEEL, MECHANICAL SPLICE, INDEPENDENT WIRE ROPE CORE)				
1/4	1.90	1.70	1.40	0.97
5/16	3.00	2.60	2.10	1.50
3/8	4.30	3.70	3.00	2.20
7/16	5.80	5.00	4.10	2.90
1/2	7.60	6.60	5.40	3.80
9/16	9.60	8.30	6.80	4.80
5/8	12.00	10.00	8.30	5.90
3/4	17.00	15.00	12.00	8.40
7/8	23.00	20.00	16.00	11.00
1	29.00	26.00	21.00	15.00
1-1/8	36.00	31.00	26.00	18.00
1-1/4	44.00	38.00	31.00	22.00
1-3/8	53.00	46.00	38.00	27.00
1-1/2	63.00	55.00	45.00	32.00
1-5/8	73.00	63.00	52.00	37.00
1-3/4	85.00	74.00	60.00	42.00
1-7/8	97.00	84.00	68.00	48.00
2	110.00	95.00	78.00	55.00

4-LEGBRIDLE

6X19 AND 6X36 CLASS

Wire Rope Size (in.)	WORKING LOAD LIMIT (TONS)			
	Vertical	60°	45°	30°
EIPS-MS-IWRC (EXTRA IMPROVED PLOW STEEL, MECHANICAL SPLICE, INDEPENDENT WIRE ROPE CORE)				
1/4	2.6	2.2	1.8	1.3
5/16	4.0	3.5	2.8	2.0
3/8	5.7	5.0	4.1	2.9
7/16	7.8	6.7	5.5	3.9
1/2	10.0	8.8	7.1	5.1
9/16	13.0	11.0	9.0	6.4
5/8	16.0	14.0	11.0	7.8
3/4	22.0	19.0	16.0	11.0
7/8	30.0	26.0	21.0	15.0
1	39.0	34.0	28.0	20.0
1-1/8	48.0	42.0	34.0	24.0
1-1/4	59.0	51.0	42.0	30.0
1-3/8	71.0	62.0	50.0	36.0
1-1/2	84.0	73.0	60.0	42.0
1-5/8	98.0	85.0	69.0	49.0
1-3/4	113.0	98.0	80.0	57.0
1-7/8	129.0	112.0	91.0	64.0
2	147.0	127.0	104.0	73.0

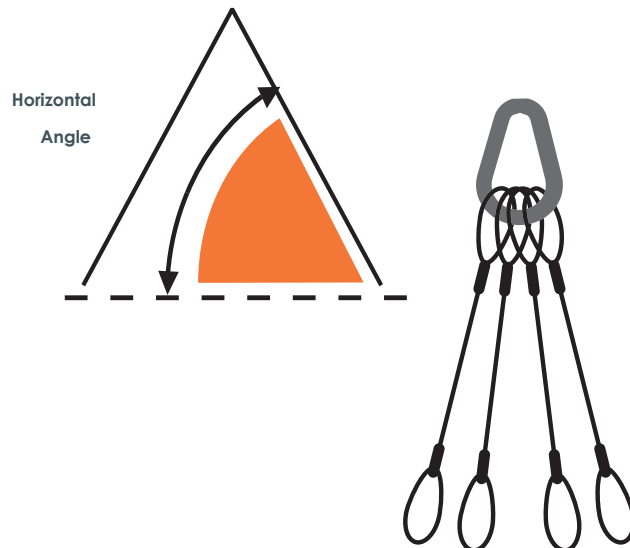



WIRE ROPE CLIPS

SIZES: 1/8 TO 1-1/2 IN.

BENEFITS & FEATURES

- Precision manufactured and galvanized to meet federal specifications (FF-C-450 Type 1 Class 1) on 1/4" and larger.
- Drop forged base
- Forged saddles include size, USA and CM logo
- Drop-forged base for superior function and wearability

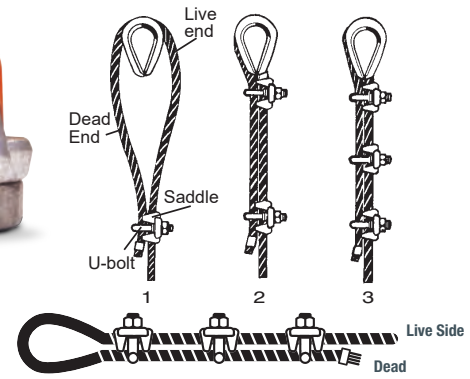
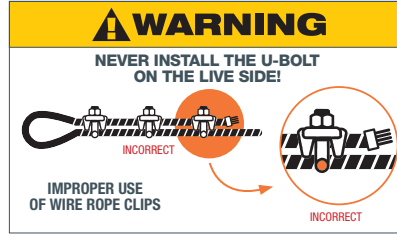
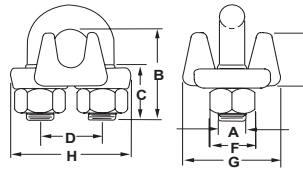

NOTE: Mechanical spliced or flitched eyes slings are the preferred method of wire rope sling construction. OSHA does not allow the use of clips to form the eyes of wire rope slings.

Size (in.)	Standard Package	Product Code	Dimensions (in.)								Minimum Number of Clips	Torque (ft./lbs.)	Rope Turnback	Weight (lbs.)
			A	B	C	D	E	F	G	H				
1/8	50	M244	1/8-24UNC	0.72	0.44	0.47	0.42	0.38	0.81	1.09	2	4-1/2	3-1/4	0.08
3/16	50	M245	1/4-20UNC	0.94	0.56	0.59	0.50	0.50	0.94	1.19	2	7-1/2	3-3/4	0.12
1/4	50	M246	5/16-18UNC	1.03	0.50	0.75	0.66	0.56	1.19	1.44	2	15	4-3/4	0.18
5/16	50	M247	3/8-16UNC	1.38	0.75	0.88	0.72	0.69	1.31	1.69	2	30	5-1/4	0.30
3/8	50	M248	7/16-14UNC	1.50	0.75	1.00	0.91	0.75	1.63	1.94	2	45	6-1/2	0.42
7/16	50	M249	1/2-13UNC	1.88	1.00	1.19	1.06	0.88	1.78	2.31	2	65	7	0.70
1/2	20	M250	1/2-13UNC	1.88	1.00	1.19	1.16	0.88	1.91	2.31	3	65	11-1/2	0.85
9/16	20	M296	9/16-12UNC	2.38	1.25	1.31	1.24	0.94	1.94	2.50	3	95	12 12	1.00
5/8	20	M251	9/16-12UNC	2.38	1.25	1.31	1.34	0.94	2.00	2.49	3	130	18 20	1.00
3/4	10	M252	5/8-11UNC	2.75	1.44	1.50	1.44	1.06	2.34	2.81	4	225	26 34	1.53
7/8	10	M253	3/4-10UNC	3.13	1.63	1.75	1.63	1.25	2.44	3.16	4	225	37 44	2.40
1	10	M254	3/4-10UNC	3.50	1.81	1.88	1.78	1.25	2.63	3.47	5	225	48	2.50
1-1/8	5	M255	3/4-10UNC	3.88	2.00	2.00	1.88	1.25	2.81	3.59	6	360		3.10
1-1/4	5	M256	7/8-9UNC	4.25	2.13	2.31	2.19	1.44	3.15	4.22	7	360		4.10
1-3/8	5	M257	7/8-9UNC	4.63	2.31	2.38	2.25	1.44	3.08	4.25	7	360		4.50
1-1/2	5	M258	7/8-9UNC	4.94	2.38	2.59	2.50	1.44	3.41	4.47	8			5.40

NOTE: 1/8" through 5/8" packed 1 piece per poly bag. 3/4" & larger shipped assembled in factory packs and tagged.

PROPER USE OF WIRE ROPE CLIPS

1. Refer to the chart above when following these instructions. Turn back specified amount of rope from thimble or loop. Apply first clip one base width from dead end of rope. Apply U-bolt over dead end of wire rope, ensuring live end rests in saddle. Tighten nuts evenly, alternate from one nut to the other until reaching the recommended torque.
2. When two clips are required, apply the second clip as near the thimble or loop as possible. Tighten nuts evenly, alternating until reaching the recommended torque. When more than two clips are required, apply the second clip as near the loop or thimble as possible and turn nuts on second clip firmly, but do not tighten. Proceed to Step 3.
3. When three or more clips are required, space additional clips equally between the first two and take up rope slack. Then tighten nuts on each U-bolt evenly, alternating from one nut to the other until reaching the recommended torque.
4. Apply an initial load equal to loads expected in use. Inspect for proper orientation and spacing of clips and retighten the nuts to recommended torque.

INSPECTION

- Visually inspect wire rope clips before each use.
- Be certain threads are not stripped and that nuts are tight.
- Check torque of nuts periodically.
- Replace distorted thimbles.
- Shorten wire rope and form new loop if damaged.
- Replace distorted thimbles.



CARE

- Care should be exercised in the installation and use of wire rope clips so that the clip, wire rope, or thimble is not damaged.
- Do not over torque or under torque the nuts. Too much torque can result in damage to the clip and/or the wire rope. Too little torque can result in the wire rope slipping. Torque nuts to the value specified in the accompanying instructions.
- Clips should not be subjected to bending or come in contact with sharp object.
- Avoid exposure to corrosive mediums.

Rope Diameter	Part No.	Dimensions - Inches				Weight Per 100
		Length		Width		
		Overall	Inside	Inside	Inside score	
1/4"	22105 4	2-3/16"	1-5/8"	7/8"	1/4"	6.5
5/16"	22110 8	2-1/2"	1-7/8"	1-1/16"	11/32"	11.8
3/8"	22115 3	2-7/8"	2-1/8"	1-1/8"	13/32"	21.6
7/16"	22120 7	3-1/4"	2-3/8"	1-1/4"	15/32"	34.7
1/2"	22125 2	3-5/8"	2-3/4"	1-1/2"	17/32"	51
9/16"-5/8"	22130 6	4-1/4"	3-1/4"	1-3/4"	21/32"	51
3/4"	22135 1	5"	3-3/4"	2"	25/32"	158
7/8"	22140 5	5-1/2"	4-1/4"	2-1/4"	15/16"	178
1"	22145 0	6-1/8"	4-1/2"	2-1/2"	1-1/16"	314
1-1/8"-1-1/4"	22150 4	7"	5-1/8"	2-7/8"	1-5/16"	400
1-3/8"-1-1/2"	22155 9	9"	6-1/4"	3-1/2"	1-9/16"	1295

Recommended for heavy duty applications.

GRADE 100 CHAIN

WORKING LOAD LIMIT: 2,700 TO 35,300 LBS.

BENEFITS & FEATURES

- Meets ASTM A973 & NACM standards
- 25% higher working load limit when compared to Grade 80
- Environmentally friendly black coating for distinct appearance and ease of identification
- Certification included with every drum
- 100% proof tested
- 4:1 design factor

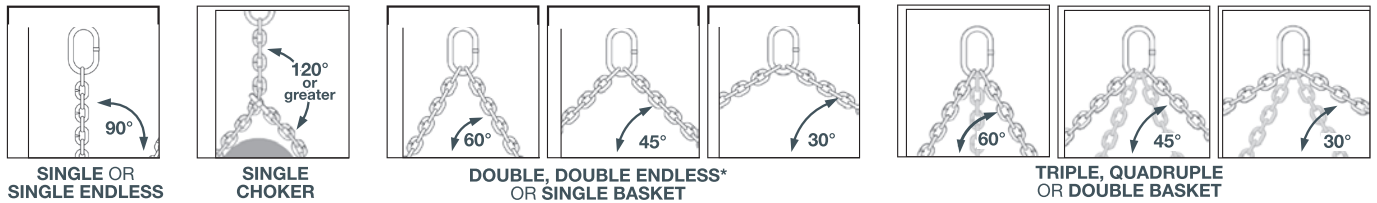
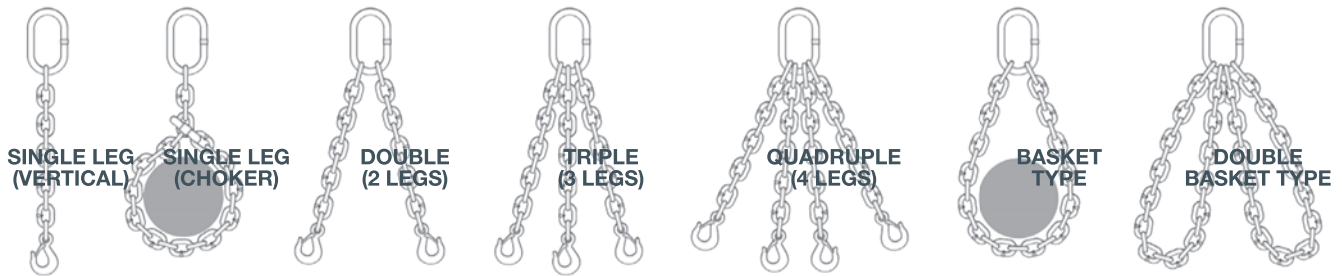
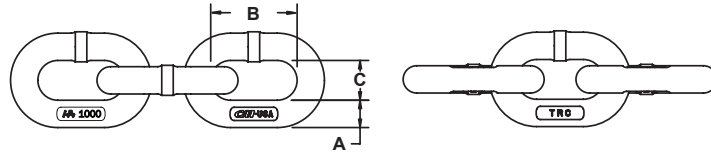

Chain Size (in.)	Working Load Limits for Sling Types Show Above														
	Single (1 leg)	Single Choker	Double (2 legs)			Triple (3 legs)			Quad (4 legs)			Single Basket	Double Basket	Single Endless	Double Endless*
	90° (lbs.)	90° (lbs.)	60° (lbs.)	45° (lbs.)	30° (lbs.)	60° (lbs.)	45° (lbs.)	30° (lbs.)	60° (lbs.)	45° (lbs.)	30° (lbs.)	60° (lbs.)	60° (lbs.)	90° (lbs.)	60° (lbs.)
GRADE 100 CHAIN SLINGS															
7/32	2,700	2,100	4,700	3,800	2,700	7,000	5,700	4,000	7,000	5,700	4,000	4,700	7,000	2,700	4,700
9/32	4,300	3,500	7,400	6,100	4,300	11,200	9,100	6,400	11,200	9,100	6,400	7,400	11,200	4,300	7,400
5/16	5,700	4,500	9,900	8,100	5,700	14,800	12,100	8,500	14,800	12,100	8,500	9,900	14,800	5,700	9,900
3/8	8,800	7,100	15,200	12,400	8,800	22,900	18,700	13,200	22,900	18,700	13,200	15,200	22,900	8,800	15,200
1/2	15,000	12,000	26,000	21,200	15,000	39,000	31,800	22,500	39,000	31,800	22,500	26,000	39,000	15,000	26,000
5/8	22,600	18,100	39,100	32,000	22,600	58,700	47,900	33,900	58,700	47,900	33,900	39,100	58,700	22,600	39,100
3/4	35,300	28,300	61,100	49,900	35,300	91,700	74,900	53,000	91,700	74,900	53,000	61,100	91,700	35,300	61,100
7/8	42,700	34,200	74,000	60,400	42,700	110,900	90,600	64,000	110,900	90,600	64,000	74,000	110,900	42,700	74,000
1	59,700	47,800	103,400	84,400	59,700	155,100	126,600	89,600	155,100	126,600	89,600	103,400	155,100	59,700	103,400
1-1/4	90,400	72,300	156,600	127,800	90,400	234,900	191,700	135,600	234,900	191,700	135,600	156,600	234,900	90,400	156,600

TRANSPORT (BINDING) CHAIN GRADE 70 STANDARD & SHORT LINK

WORKING LOAD LIMIT: 3,150 TO 11,300 LBS.

BENEFITS & FEATURES

- Do not use for overhead lifting
- High-carbon steel, heat treated
- Zinc plated with yellow chromate finish
- Meets ASTM & NACM standards
- Meets FMCSA & CVSA requirements
- Thermal heat treated using advanced technology
- Heat treated for superior wear and toughness
- 100% proof tested
- Permanent identification on chain (embossed with G70, plus 3 letter trace code)
- Full weld trim
- Design factor 4:1

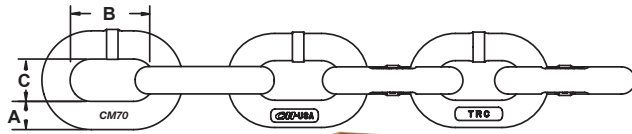

T-316 Stainless Steel Chain



TRADE SIZE INCHES	WIRE DIAMETER INCHES	Nominal DIMENSIONS INSIDE LINK		WEIGHT PER 100 FT LBS.	WORKING LOAD LIMIT LBS.
		LENGTH INCHES	WIDTH INCHES		
1/8	0.156	0.94	0.25	18	500
3/16	0.218	0.98	0.30	41	1200
1/4	0.276	1.24	0.34	64	2000
5/16	0.315	1.29	0.40	84	2400
3/8	0.394	1.38	0.55	138	3500
1/2	0.512	1.79	0.62	278	6500

Uses - T-316 is designed for use in the textile, paper and chemical industries.
Nominal weights and dimensions are subject to a plus or minus tolerance of 4%.

Caution: Do not use for overhead lifting. Working load limit must not be exceeded.



MASTERLINK DUAL RATED FOR USE WITH HA800 OR HA1000

WORKINGLOADLIMIT:5,400 TO 105,900LBS.

BENEFITS&FEATURES

- Accepts both Herc-Alloy® 1000 & 800 chain and components
- Durable orange powder coated finish
- May be used for mechanical and welded sling assemblies
- 100% proof tested
- 4:1 design factor

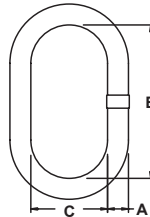
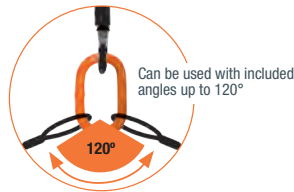

Trade Size (in.)	Working Load Limit (lbs.)	Product Code	Nominal Dimensions (in.)			Weight (lbs.)	Type and Size of Chain Sling on Which Used (in.)			
			Material Diameter A	Inside Length B	Inside Width C		Single	Double	Triple	Quad
13/32	5,400	555231	0.41	3.00	1.50	0.33	7/32	7/32	-	-
1/2	8,600	555232	0.56	5.00	2.50	1.02	9/32	9/32	7/32*	7/32*
3/4	17,600	555235	0.75	5.50	2.75	2.08	3/8	3/8	9/32*	9/32*
1	30,000	555238	1.00	7.00	3.50	4.59	1/2 & 5/8	1/2	3/8*	3/8*
1-1/4	45,200	555240	1.25	8.75	4.38	9.31	3/4	5/8	1/2*	1/2*
1-1/2	70,600	555243	1.50	10.50	5.25	15.60	-	3/4	5/8*	5/8*
1-3/4	105,900	555246	1.75	12.00	6.00	24.40	-	-	3/4*	3/4*

* Additional step down hardware required when using hammerlocks

SUB-ASSEMBLY DUAL RATED FOR USE WITH HA800 OR HA1000

WORKINGLOADLIMIT:7,000 TO 91,700LBS.

BENEFITS&FEATURES

- Designed for triple and quad branch Herc-Alloy® chain slings
- Consists of an oblong master link and two welded master coupling links
- Accepts both Herc-Alloy 1000 & 800 chain and components
- Durable orange powder coated finish
- May be used for mechanical or welded sling assemblies
- 100% proof tested
- 4:1 design factor

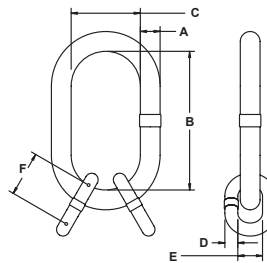
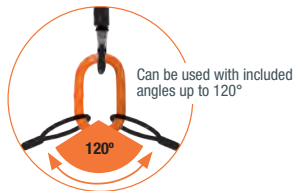

Trade Size (in.)	Working Load Limit at 60° (lbs.)	Product Code	Master Link Nominal Dimensions (in.)			Intermediate Link Nominal Dimensions (in.)			Weight (lbs.)	Type and Size of Chain Sling on Which Used (in.)	
			Material Diameter A	Inside Length B	Inside Width C	Material Diameter D	Inside Width E	Inside Length F		Triple	Quad
1/2	7,000	555274	0.56	5.00	2.50	0.44	1.06	1.75	1.35	7/32	7/32
3/4	11,200	555275	0.75	5.50	2.75	0.47	0.88	1.56	2.64	9/32	9/32
1	22,900	555276	1.00	7.00	3.50	0.78	1.50	2.63	7.25	3/8	3/8
1-1/4	39,000	555277	1.25	8.75	4.38	0.91	1.75	3.13	13.51	1/2	1/2
1-1/2	58,700	555278	1.50	10.50	5.25	1.13	2.25	4.00	24.28	5/8	5/8
1-3/4	91,700	555279	1.75	12.00	6.00	1.50	2.75	5.25	44.58	3/4	3/4

HAMMERLOK®

WORKING LOAD LIMIT: 2,700 TO 35,300 LBS.

BENEFITS & FEATURES

- Used for overhead lifting slings to connect chain branches to the master link and the hook to attachments
- Constructed of drop forged alloy steel
- Must be matched to chain size
- Do not use for chain repair or splicing
- Meets ASTM A952 standards
- 4:1 design factor

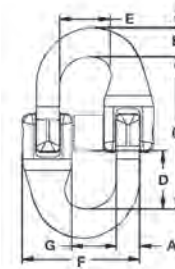

Size (in.)	Working Load Limit (lbs.)	Product Code	Load Pin Kit Product Code	Dimensions (in.)							Weight (lbs.)
				A (Max)	B (Max)	C	D	E	F	G	
7/32	2,700	667021-2	R667021-2	0.29	0.28	1.85	0.69	0.61	1.44	0.52	0.27
9/32	4,300	667028-2	R667028-2	0.37	0.44	1.94	0.69	0.68	1.58	0.61	0.28
3/8	8,800	667038-2	R667038-2	0.52	0.50	3.02	1.15	1.05	2.33	0.81	0.84
1/2	15,000	667050-2	R667050-2	0.64	0.68	3.79	1.43	1.29	2.98	1.10	1.87
5/8	22,600	667062-2	R667062-2	0.81	0.91	4.50	1.70	1.54	3.57	1.32	3.13
3/4	35,300	667075-2	R667075-2	0.97	1.07	5.36	2.06	1.78	4.69	1.52	5.75

CHAIN SHORTENER HERC-ALLOY® 1000

WORKING LOAD LIMIT: 4,300 TO 22,600 LBS.

BENEFITS & FEATURES

- Quickly and easily adjust chain length of sling when the load has uneven pick points Durable orange powder coated finish
- Forged alloy steel – quenched & tempered
- Mechanically attaches directly to master ring
- 4:1 design factor
- Marked with both fraction and metric sizes

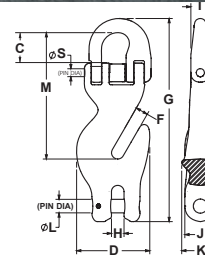

Size (in.)	Working Load Limit (lbs.)	Product Code	Standard Package	Dimensions (in.)											Weight (lbs.)
				C	D	G	H	J	K	L	F	M	S	T	
9/32	4,300	M71805A-2	10	0.69	2.16	5.86	0.38	0.80	1.00	0.36	0.38	3.38	0.21	0.54	1.20
3/8	8,800	M71806A-2	10	1.15	2.74	7.61	0.47	1.17	1.41	0.51	0.47	4.74	0.31	0.71	2.50
1/2	15,000	M71808A-2	10	1.43	3.34	9.36	0.65	1.38	2.07	0.63	0.65	5.82	0.41	0.93	4.80
5/8	22,600	M71810A-2	5	1.74	4.19	11.56	0.79	1.53	2.46	0.75	0.79	7.04	0.48	1.06	8.20

Note: If used as a choker, working load limit should be reduced by 20%.



RIGGING HOOK

WORKING LOAD LIMIT: 3/4 TO 22 TONS

BENEFITS & FEATURES

- Load rating marked on each hook body
- Design factor 5:1
- Hook tips are pre-drilled to allow securement of the latch
- Powder coated orange
- Meets ASME B30.10

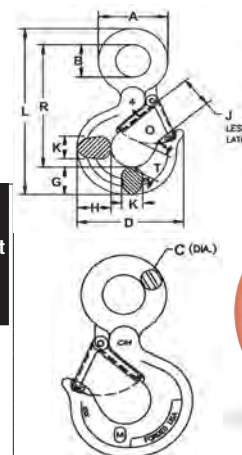

WLL* (tons)	Alloy		Zinc Plated Latch Kit (optional)	Dimensions (in.)													Weight (lbs.)
	Painted Orange			Product Code	A	B	C	D	G	H	J	K	L	O	R	T	
	without Latch	with Latch			A	B	C	D	G	H	J	K	L	O	R	T	
1	M6402A	M6502A	4X1302	1.50	0.75	0.38	3.12	0.87	1.01	0.93	0.63	4.37	0.93	3.13	0.87	0.66	
1-1/2	M6403A	M6503A	4X1303	1.75	0.88	0.44	3.37	0.94	1.11	0.97	0.71	5.04	0.97	3.66	0.97	1.12	
2	M6404A	M6504A	4X1304	2.13	1.10	0.50	3.80	1.06	1.21	1.02	0.74	5.65	1.02	4.09	1.03	1.46	
3	M6405A	M6505A	4X1305	2.50	1.25	0.64	4.20	1.26	1.43	1.19	0.94	6.55	1.16	4.67	1.16	2.42	
5	M6407A	M6507A	4X1307	3.08	1.56	0.77	5.11	1.44	1.63	1.50	1.38	7.97	1.41	5.78	1.53	4.10	
7	M6409A	M6509A	4X1309	3.88	1.98	0.94	6.24	1.82	2.01	1.78	1.68	10.07	1.69	7.31	1.94	8.16	
11	M6411A	M6511A	4X1311	4.69	2.44	1.13	7.89	2.25	2.63	2.38	1.88	12.41	2.19	9.03	2.52	15.60	
15	M6415A	M6515A	4X1315	5.34	2.84	1.25	8.53	2.75	3.10	2.50	2.03	14.05	2.30	10.21	2.54	21.58	

Other finishes are available as special orders.
* Working Load Limits in Metric Tons.

WIRE ROPE
CHAINS
RIGGING HARDWARE
TRANSPORT TIE-DOWNS
SYNTHETIC SLINGS
WIRE ROPE FITTINGS
CLAMPS
PPE
HOISTS
BLOCKS
SPREADER BARS

CLEVLOK® CRADLEGRABHOOK

DUAL RATED FOR USE WITH HA800 OR HA1000

WORKING LOAD LIMIT: 2,700 TO 35,300 LBS.

BENEFITS & FEATURES

- For use with both Grade 80 & 100 chain
- Meets ASTM A952 standards
- 100% proof tested
- Durable orange powder coated finish
- Fraction and metric markings
- 4:1 design factor
- Meets ASME B30.10

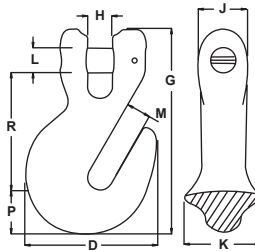

Size (in.)	Working Load Limit (lbs.)	Product Code	Standard Package Quantity	Dimensions (in.)									Weight (lbs.)
				D	G	H	J	K	L	M	P	R	
7/32	2,700	659718	10	1.62	3.21	0.31	0.75	0.94	0.28	0.31	0.62	1.98	0.50
9/32	4,300	659722	10	2.18	3.39	0.38	0.82	0.97	0.36	0.38	0.82	1.86	0.63
3/8	8,800	659725	10	2.72	4.33	0.47	1.18	1.29	0.51	0.74	1.03	2.47	1.30
1/2	15,000	659728	5	3.65	5.27	0.65	1.39	2.01	0.63	0.60	1.19	3.04	2.10
5/8	22,600	659729	5	4.50	6.54	0.77	1.55	2.42	0.75	0.77	1.41	3.76	4.20
3/4	35,300	659730	Bulk	5.40	8.80	0.88	2.05	2.69	0.88	0.91	1.89	5.30	10.50

Note: If used as a choker, working load limit should be reduced by 20%. Reference CM Rigging Guide for more details.

SORTINGHOOK HERC-ALLOY 800®

WORKINGLOADLIMIT:7-1/2 TONS

BENEFITS & FEATURES

- Quenched and tempered alloy steel
- Long tapered point designed for easy grab in rings, pear links, eye bolts or lifting holes
- Most useful for efficient handling of cylindrical shapes
- Durable orange powder coated finish
- Design factor 5:1
- Meets ASME B30.10
- May be loaded within 1 in. of the tip. The working load limit with the load sitting in the bowl (or saddle) of the the hook is 7-1/2 tons, whereas the working load limit is 2 tons if the hook is being loaded 1 in. from the tip. **DO NOT LOAD THE LAST ONE INCH OF THE TIP.**

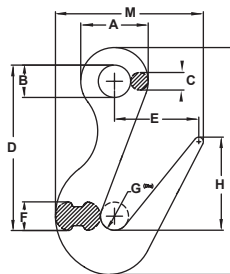

Working Load Limit (lbs.)		With Handle		Without Handle		Dimensions (in.)									
At Tip (ton)	At bottom of Hook (ton)	Product Code	Weight (lbs.)	Product Code	Weight (lbs.)	A	B	C	D	E	F	G	H	I	M
2	7-1/2	M129H	7.0	M129	6.8	3	1.44	0.78	7.34	3.75	1.28	1.25	3.93	10.09	6.58

CLEVLOK® FOUNDRYHOOK HERC-ALLOY® 1000

WORKINGLOADLIMIT:4,300 TO 35,300LBS.



BENEFITS & FEATURES

- Clevlok® head designed for easy assembly
- “J” beam body design increases grip when removing from load
- Meets ASTM A952 standards
- Quenched & tempered alloy steel
- Individually proof tested
- Durable orange powder coated finish
- 4:1 design factor
- Meets ASME B30.10

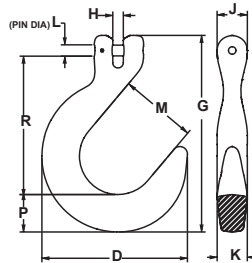

Size (in.)	Working Load Limit (lbs.)	Clevlok Foundry Hook			Alloy Load Pin Product Code	Retaining Pin Product Code	Dimensions (in.)									
		Product Code	Standard Package Quantity	Weight (lbs.)			D	G	H	J	K	L	M	P	R	
9/32	4,300	475798	5	2.43	595780SP	602306	4.82	6.52	0.35	1.00	1.00	0.36	2.55	1.24	4.59	
3/8	8,800	475799	5	4.14	595781	495828	5.73	7.87	0.47	1.16	1.27	0.51	3.05	1.43	5.59	
1/2	15,000	475800	5	7.10	SP595782P	495829	6.83	9.40	0.59	1.50	1.50	0.63	3.55	1.75	6.58	
5/8	22,600	475801	5	12.03	595785	495824	7.94	10.98	0.70	1.74	1.81	0.75	4.07	2.03	7.69	
3/4	35,300	475802	5	21.00	595786	495824	9.17	13.20	0.88	2.05	2.00	0.91	4.50	2.63	8.87	

EYEFOUNDRYHOOK

DUAL RATED FOR USE WITH HA800 OR HA1000

WORKINGLOADLIMIT:4,300 TO 35,300LBS.



BENEFITS & FEATURES

- For use with both Grade 80 & 100 chain
- Throat opening to 4.5" (114 mm)
- Meets ASTM A952 standards
- Durable orange powder coated finish
- 100% proof tested
- For welded 7/32" chain sling use 9/32" eye foundry hook
- 4:1 design factor
- Meets ASME B30.10

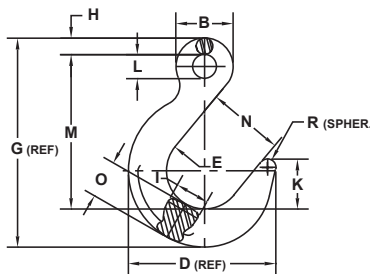

Size (in.)	Working Load Limit (lbs.)	Product Code	Standard Package Quantity	Dimensions (in.)												Weight (lbs.)
				B	D	E	G	H	I	K	L	M	N	O	R	
9/32	4,300	474798	5	1.56	4.73	2.50	6.45	0.47	1.00	1.56	0.63	4.75	2.50	1.23	0.25	2.4
3/8	8,800	474799	5	2.00	5.72	3.00	7.88	0.63	1.27	1.88	0.80	5.77	3.00	1.50	0.31	4.5
1/2	15,000	474800	5	2.50	6.74	3.50	9.38	0.75	1.50	2.22	1.00	6.88	3.50	1.75	0.38	7.1
5/8	22,600	474801	5	3.00	7.79	4.00	10.97	0.88	1.81	2.63	1.13	8.06	4.00	2.03	0.44	11.6
3/4	35,300	474802	Bulk	3.50	9.07	4.50	12.81	1.00	2.20	3.00	1.50	9.25	4.50	2.56	0.50	20.0

WIRE ROPE
CHAINS
RIGGING HARDWARE
TRANSPORT TIE-DOWNS
SYNTHETIC SLINGS
WIRE ROPE FITTINGS
CLAMPS
PPE
HOISTS
BLOCKS
SPREADER BARS

SWIVEL STYLE LATCHLOK® HOOKS HERC-ALLOY® 1000

WORKING LOAD LIMIT: 4,300 TO 22,600 LBS.

BENEFITS & FEATURES OF BOTH STYLES

- The eye easily positions to attach to the load
- 100% proof tested
- Meets ASTM A952 standards
- Certification of test available
- Durable orange powder coated finish For welded 7/32" chain sling use 9/32" swivel Lodelok hook
- Positive locking hook
- 4:1 design factor

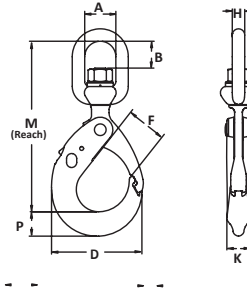

BUSHING STYLE SWIVEL HOOK

BUSHING

Size (in.)	Working Load Limit (lbs.)	Replace Latch Kit Part #	Dimensions (in.)								Weight (lbs.)
			H	M	P	D	F	A	B	K	
9/32	4,300	656005	0.62	7.43	0.88	3.77	1.64	1.50	1.31	0.91	3.5
3/8	8,800	656010	0.77	9.11	1.07	4.76	2.26	1.75	1.62	1.15	4.8
1/2	15,000	656015	0.93	11.49	1.58	6.26	2.91	2.25	1.82	1.47	10.7
5/8	22,600	656020	1.00	13.73	1.97	7.37	3.22	2.50	2.16	1.85	17.4

CLEVOK® STYLE LATCHLOK® HOOK HERC-ALLOY® 1000

WORKING LOAD LIMIT: 4,300 TO 22,600 LBS.

BENEFITS & FEATURES

- High-cycling, long-life spring
- 100% proof tested
- Meets ASTM A952 standards
- Durable orange powder coated finish
- Positive locking hook
- 4:1 design factor
- Meets ASME B30.10

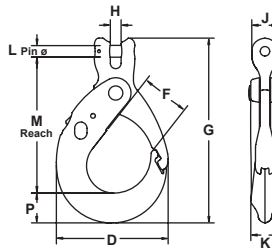

Size (in.)	Working Load Limit (lbs.)	Product Code	Replace Latch Kit Part #	Dimensions (in.)									Weight (lbs.)
				H	M	P	D	F	J	K	G	L	
9/32	4,300	M616005	656005	0.35	5.05	0.88	3.77	1.64	1.00	0.91	6.61	0.36	2.40
3/8	8,800	M616010	656010	0.45	6.08	1.07	4.76	2.26	1.17	1.15	7.98	0.51	4.20
1/2	15,000	M616015	656015	0.59	7.88	1.58	6.26	2.91	1.50	1.47	10.54	0.63	9.00
5/8	22,600	M616020	656020	0.71	8.96	1.97	7.37	3.22	1.74	1.85	12.19	0.75	14.00

EYESTYLE LATCHLOK® HOOK HERC-ALLOY® 1000

WORKING LOAD LIMIT: 4,300 TO 22,600 LBS.

BENEFITS & FEATURES

- Large eye design for use with chain, wire rope and synthetic material
- 100% proof tested
- Meets ASTM A952 standards
- Durable orange powder coated finish
- For welded 7/32" chain sling use 9/32" eye Lodelok hook
- Positive locking hook
- 4:1 design factor
- Meets ASME B30.10

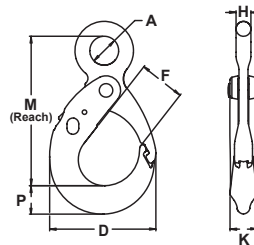

Size (in.)	Working Load Limit (lbs.)	Product Code	Replace Latch Kit Part #	Dimensions (in.)							Weight (lbs.)
				A	M	P	D	F	H	K	
9/32	4,300	M626005	656005	1.09	5.37	0.88	3.77	1.64	0.47	0.91	2.50
3/8	8,800	M626010	656010	1.36	6.65	1.07	4.74	2.27	0.59	1.15	4.74
1/2	15,000	M626015	656015	1.57	8.79	1.58	6.26	2.91	0.80	1.47	10.00
5/8	22,600	M626020	656020	2.00	10.37	1.97	7.37	3.22	1.03	1.85	16.00

SWIVEL RIGGING HOOK

WORKING LOAD LIMIT: 1 TO 22 TONS

BENEFITS & FEATURES

- Design factor 5:1
- Pre-drilled for latches Hooks furnished with or without latches
- Powder coated orange Hooks are heat treated, quenched and tempered
- Meets ASME B30.10

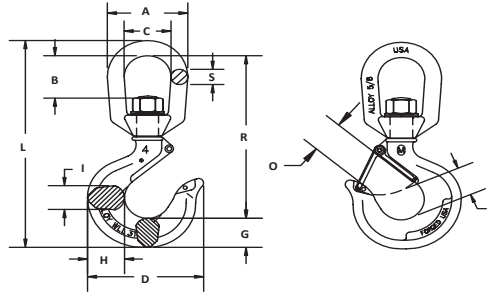

Standard Package	Alloy			Zinc Plated Latch Kit (optional) Product Code	Dimensions (in.)											Latch Kit	Weight (lbs.)	
	WLL* (tons)	Product Code			A	B	C	D	G	H	I	L	R	S	T			O
		without Latch	with Latch															
10	1	M3402A	M3502A	4X1302	2.00	1.11	1.31	3.06	0.87	1.05	0.63	5.83	4.63	0.38	0.87	0.93	4X1302	1.05
10	1-1/2	M3403A	M3503A	4X1303	2.50	1.38	1.50	3.33	0.94	1.11	0.71	6.83	5.44	0.50	0.97	0.97	4X1303	1.56
10	2	M3404A	M3504A	4X1304	3.00	1.65	1.75	3.67	1.06	1.21	0.88	7.76	6.25	0.63	1.03	1.06	4X1304	2.50
10	3	M3405A	M3505A	4X1305	3.00	1.65	1.75	4.20	1.27	1.43	0.94	8.40	6.49	0.63	1.16	1.16	4X1305	3.20
10	5	M3407A	M3507A	4X1307	3.50	1.77	2.00	5.11	1.44	1.63	1.31	9.76	7.53	0.75	1.53	1.41	4X1307	5.36
Bulk	7	M3409A	M3509A	4X1309	4.75	2.39	2.75	6.24	1.82	2.01	1.68	12.42	9.67	1.00	1.94	1.69	4X1309	10.56
Bulk	11	M3411A	M3511A	4X1311	5.50	2.55	3.25	7.69	2.25	2.63	1.88	14.89	12.06	1.13	2.46	2.22	4X1311	19.00
Bulk	15	M3415A	M3515A	4X1315	6.00	2.47	3.50	8.37	2.59	2.94	2.19	15.79	11.95	1.25	2.62	2.23	4X1315	26.75
Bulk	22	M3422A	M3522A	4X1322	7.75	3.82	4.75	10.19	3.00	3.50	2.69	21.18	16.68	1.50	2.74	3.05	4X1322	51.80

REPLACEMENT LATCHES FOR SWIVEL, RIGGING & SHANK HOOKS

Working Load Limit (tons)		Product Code			
Alloy	Carbon	Old Style Stainless	New Style		
			Zinc	Stainless	Locking
1	3/4	4X405	4X1302	4X1302S	4X1302M
1-1/2	1	4X405	4X1303	4X1303S	4X1303M
2	1-1/2	4X406	4X1304	4X1304S	4X1304M
3	2	4X406	4X1305	4X1305S	4X1305M
5	3	4X410	4X1307	4X1307S	4X1307M
7	5	4X412	4X1309	4X1309S	4X1309M
11	7-1/2	4X414	4X1311	4X1311S	4X1311M
15	10	595530	4X1315	-	4X1315M
22	15	595533	4X1322	-	4X1322M



Old Style



New Style

WIRE ROPE
 CHAINS
 RIGGING HARDWARE
 TRANSPORT TIE-DOWNS
 SYNTHETIC SLINGS
 WIRE ROPE FITTINGS
 CLAMPS
 PPE
 HOISTS
 BLOCKS
 SPREADER BARS

WIRE GRIPS



SPECIFICATIONS

Capacity (lbs.)	Model	Product Code	Applicable Cable Types			Wire Size				Grip Type & Features						Jaw & Teeth Configurations				Weight lbs. (kg)	
			Bare & Stranded Copper	ACSR & Aluminum Conductor	EHS & Messenger Guy Wire	Minimum		Maximum		Model Type		Gate Style		Handle		Jaw Type	Teeth Type	Jaw Length			Handle Eye Opening Diameter (in.)
						Size in. (mm)	Gauge	Size in. (mm)	Gauge	Standard	Hot Line	Non-Spring Loaded	Spring Loaded	Un-Notched	Notched			Teeth (in.)	Mount (in.)		
1,000	LMG1000	04451W			✓	.04 (1.02)	18AWG	.394 (10.01)	1/0AWG	✓			✓	✓		Bulldog	Aggressive	1.38	1.55	Ø1.02	1 (0.45)
2,000	LMG2000	04452W	✓	✓	✓	.109 (2.77)	8AWG	.594 (15.09)	4/0AWG	✓			✓	✓		Bulldog	Aggressive	1.34	1.86	1.0 x 1.5	1.5 (0.68)
5,000	LMG4500	04453W	✓	✓		.18 (4.57)	6AWG	.60 (15.24)	4/0AWG	✓			✓	✓		Parallel	Fine	4.10	3.64	1.25 x 2.0	3.6 (1.63)
5,000	LMG4500A	04478W			✓	.18 (4.57)	6AWG	.60 (15.24)	4/0AWG	✓			✓	✓		Parallel	Aggressive	4.10	3.64	1.25 x 2.0	3.6 (1.63)
5,000	LMG4501	04454W	✓	✓		.18 (4.57)	6AWG	.60 (15.24)	4/0AWG		✓		✓		✓	Parallel	Fine	4.10	3.64	1.25 x 2.0	3.7 (1.68)
5,000	LMG4501A	04499W			✓	.18 (4.57)	6AWG	.60 (15.24)	4/0AWG		✓		✓		✓	Parallel	Aggressive	4.10	3.64	1.25 x 2.0	3.7 (1.68)
5,000	LMG4502	04455W	✓	✓		.18 (4.57)	6AWG	.60 (15.24)	4/0AWG		✓	✓		✓		Parallel	Fine	4.10	3.64	1.25 x 2.0	3.7 (1.68)
5,000	LMG4503	04456W	✓	✓		.18 (4.57)	6AWG	.60 (15.24)	4/0AWG		✓	✓		✓		Parallel	Aggressive	4.10	3.64	1.25 x 2.0	3.7 (1.68)
10,000	LMG4600	04459W	✓	✓		.30 (7.62)	1AWG	.80 (20.32)	450MCM	✓			✓	✓		Parallel	Fine	5.08	5.03	1.35 x 2.25	6.7 (3.04)
10,000	LMG4600A	04479W			✓	.30 (7.62)	1AWG	.80 (20.32)	450MCM	✓			✓	✓		Parallel	Aggressive	5.08	5.03	1.35 x 2.25	6.7 (3.04)
10,000	LMG4601	04460W	✓	✓		.30 (7.62)	1AWG	.80 (20.32)	450MCM		✓		✓		✓	Parallel	Fine	5.08	5.03	1.35 x 2.25	7 (3.18)
10,000	LMG4601A	04457W			✓	.30 (7.62)	1AWG	.80 (20.32)	450MCM		✓		✓		✓	Parallel	Aggressive	5.08	5.03	1.35 x 2.25	7 (3.18)
10,000	LMG4602	04461	✓	✓		.30 (7.62)	1AWG	.80 (20.32)	450MCM		✓	✓		✓		Parallel	Fine	5.08	5.03	1.35 x 2.25	7 (3.18)
12,000	LMG4800	04471W	✓	✓		.70 (17.77)	397MCM	1.25 (32)	1130MCM	✓			✓	✓		Parallel	Fine	5.57	5.64	1.35 x 2.25	8.1 (3.67)
12,000	LMG4800A	04449W			✓	.70 (17.77)	397MCM	1.25 (32)	1130MCM	✓			✓	✓		Parallel	Aggressive	5.57	5.64	1.35 x 2.25	8.1 (3.67)
12,000	LMG4801	04472W	✓	✓		.70 (17.77)	397MCM	1.25 (32)	1130MCM		✓		✓		✓	Parallel	Fine	5.57	5.64	1.35 x 2.25	8.3 (3.76)
12,000	LMG4801A	04450W			✓	.70 (17.77)	397MCM	1.25 (32)	1130MCM		✓		✓		✓	Parallel	Aggressive	5.57	5.64	1.35 x 2.25	8.3 (3.76)
12,000	LMG4802	04473	✓	✓		.70 (17.77)	397MCM	1.25 (32)	1130MCM		✓	✓		✓		Parallel	Fine	5.57	5.64	1.35 x 2.25	8.3 (3.76)

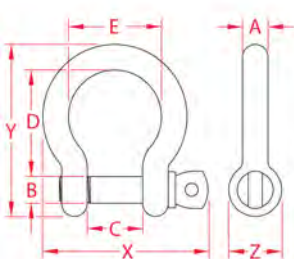

A (size)	B	C	D	E	X (height)	Y (length)	Z (width)	WLL (lb)	WT (lb)
3/16"	0.19"	0.41"	0.78"	0.67"	1.23"	1.25"	0.41"	500	0.03
1/4"	0.23"	0.52"	0.93"	0.83"	1.48"	1.50"	0.47"	750	0.06
5/16"	0.31"	0.66"	1.25"	1.11"	1.95"	2.05"	0.62"	1,000	0.14
3/8"	0.39"	0.83"	1.57"	1.28"	2.43"	2.52"	0.78"	2,000	0.26
15/32"	0.47"	0.98"	1.96"	1.50"	2.86"	3.07"	0.94"	3,000	0.46
5/8"	0.62"	1.31"	2.49"	2.20"	3.96"	3.93"	1.20"	4,000	1.09
3/4"	0.77"	1.62"	3.10"	2.55"	4.72"	5.13"	1.57"	5,500	2.09

NOTE:
PIN DIAMETER MATCHES THE SHACKLE BODY DIAMETER.
ALL DIMENSIONS ARE NOMINAL (+/- 3%) AND ARE SUBJECT TO CHANGE WITHOUT NOTICE.



CARBON ANCHOR SHACKLES (INDUSTRIAL/GOVERNMENT-RATED)

WORKING LOAD LIMIT: 1/3 TO 85 TONS

CM Industrial/Government-Rated Carbon Shackles are designed with a 6:1 design factor. Anchor shackles can be side loaded or used for multiple connections.

BENEFITS & FEATURES

- Manufactured from technically advanced domestic (U.S.A.) micro alloy steel with optimal hardness for strength and ductility.
- All shackles have alloy quenched and tempered pins
- Working load limit and traceability codes shown as permanent markings on body
- Available in sizes 3/16" to 3"
- Available finishes include powder coated, self-colored or galvanized per ASTM A153
- All bolt, nut & cotter shackles have thread-protected ends
- Shackles meet dimensional, marking and performance requirements of RR-C-271
- Standard industry tolerances apply
- Design factor 6:1 (2-1/2" and 3" carbon shackles have a 5:1 design factor)
- Screw pin & bolt/nut/cotter shackles meet ASME B30.26

▶ DID YOU KNOW?

CM INDUSTRIAL/GOVERNMENT VS. CM SUPER STRONG SHACKLES

An Industrial/Government shackle is a Super Strong shackle de-rated to meet, not exceed, the Federal Specification RR-C-271.

That means it has the same dimensions and performance characteristics as a Super Strong shackle but is marked with specifications to meet government requirements.

Example:

- **1" Super Strong shackle will be marked 10 Ton WLL**
- **1" Industrial/Government shackle will be marked 8-1/2 Ton WLL**



Screw Pin



Bolt, Nut & Cotter

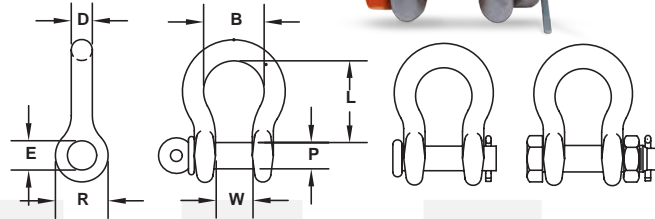

Size D (in.)	Working Load Limit (Ton)	Weight (lbs.)	Product Code				Dimensions (in.)					
			Screw Pin		Round Pin	Bolt, Nut & Cotter	P	E	W	R	L	B (min.)
			Galvanized	Orange Powder Coated	Galvanized	Galvanized						
3/16	1/3	0.06	MC645G	-	MC345G	-	0.25	0.29	0.38	0.57	0.88	0.58
1/4	1/2	0.12	MC646G	MC646P	MC346G	MC846G	0.31	0.36	0.47	0.75	1.13	0.75
5/16	3/4	0.20	MC647G	MC647P	MC347G	MC847G	0.38	0.45	0.53	0.84	1.25	0.81
3/8	1	0.30	MC648G	MC648P	MC348G	MC848G	0.44	0.52	0.66	1.00	1.40	1.00
7/16	1-1/2	0.50	MC649G	MC649P	MC349G	MC849G	0.50	0.58	0.72	1.15	1.69	1.19
1/2	2	0.75	MC650G	MC650P	MC350G	MC850G	0.63	0.70	0.84	1.34	1.94	1.38
5/8	3-1/4	1.30	MC651G	MC651P	MC351G	MC851G	0.75	0.83	1.06	1.66	2.41	1.63
3/4	4-3/4	2.25	MC652G	MC652P	MC352G	MC852G	0.88	0.95	1.28	1.94	2.84	1.89
7/8	6-1/2	3.50	MC653G	MC653P	MC353G	MC853G	1.00	1.09	1.44	2.14	3.31	2.06
1	8-1/2	5.00	MC654G	MC654P	MC354G	MC854G	1.13	1.22	1.72	2.44	3.75	2.52
1-1/8	9-1/2	7.00	MC655G	-	MC355G	MC855G	1.25	1.36	1.84	2.66	4.02	2.69
1-1/4	12	9.00	MC656G	-	MC356G	MC856G	1.38	1.52	2.03	3.15	4.63	2.88
1-3/8	13-1/2	12.50	MC666G	-	MC366G	MC866G	1.50	1.65	2.25	3.25	5.19	3.25
1-1/2	17	17.20	MC657G	-	MC357G	MC857G	1.63	1.77	2.41	3.50	5.63	3.50
1-5/8	20	23.50	MC685G	-	MC385G	MC885G	1.75	1.88	2.66	3.91	6.13	4.13
1-3/4	25	27.70	MC677G	-	MC377G	MC877G	2.00	2.13	2.94	4.06	6.97	4.75
2	35	39.00	M658G	M658P	M358G	-	2.25	2.38	3.28	4.51	7.44	5.50
2-1/2	55	90.00	-	-	-	MC860G	2.75	2.91	4.13	6.25	10.48	6.75
3	85	138.00	-	-	-	MC862G	3.25	3.41	5.00	6.75	13.00	7.38

WIRE ROPE
CHAINS
RIGGING HARDWARE
TRANSPORT TIE-DOWNS
SYNTHETIC SLINGS
WIRE ROPE FITTINGS
CLAMPS
PPE
HOISTS
BLOCKS
SPREADER BARS



ALLOY ANCHOR SHACKLES

WORKING LOAD LIMIT: 2 TO 120 TONS

CM Alloy Shackles are designed with a 5:1 design factor and have a strength rating approximately 50% higher than a comparable-sized carbon shackle and about 25% stronger than super strong shackles. Anchor shackles can be side loaded or used for multiple connections.

BENEFITS & FEATURES

- 3/8" to 2" sizes made in the U.S.A. from domestic (U.S.A.) Special Bar Quality (SBQ) steel having fine grain, reduced sulfur and phosphorus.
- Shackles show major deformation before failure
- Working load limit and traceability codes shown as permanent markings on body
- All shackles have alloy quenched and tempered pins
- Available in sizes 3/8" to 3"
- Available finishes include powder coated, galvanized or self-colored
- Shackles meet dimensional, marking and performance requirements of RR-C-271
- Special testing and certification is available if requested at the time of the order
- Design factor 5:1
- Screw pin & bolt/nut/cotter shackles meet ASME B30.26



Size D (in.)	Working Load Limit (Ton)	Std. Pkg.	Weight (lbs.)	Product Code									Dimensions (in.)					
				Screw Pin			Round Pin			Bolt, Nut & Cotter			P	E	W	R	L	B min
				Self Colored	Galva-nized	Orange Powder Coated	Self Colored	Galva-nized	Orange Powder Coated	Self Colored	Galva-nized	Orange Powder Coated						
3/8	2	50	0.30	M648A	M648AG	M648AP	-	-	-	M848A	M848AG	M848AP	0.44	0.52	0.66	1.00	1.40	1.00
7/16	2.6	50	0.50	M649A	M649AG	M649AP	-	-	-	M849A	M849AG	M849AP	0.50	0.58	0.72	1.15	1.69	1.19
1/2	3.3	50	0.75	M650A	M650AG	M650AP	M350A	M350AG	M350AP	M850A	M850AG	M850AP	0.63	0.70	0.84	1.34	1.94	1.38
5/8	5	25	1.30	M651A	M651AG	M651AP	M351A	M351AG	M351AP	M851A	M851AG	M851AP	0.75	0.83	1.06	1.66	2.41	1.63
3/4	7	10	2.30	M652A	M652AG	M652AP	M352A	M352AG	M352AP	M852A	M852AG	M852AP	0.88	0.95	1.28	1.94	2.84	1.89
7/8	9.5	10	3.50	M653A	M653AG	M653AP	M353A	M353AG	M353AP	M853A	M853AG	M853AP	1.00	1.09	1.44	2.14	3.31	2.06
1	12.5	5	5.00	M654A	M654AG	M654AP	M354A	M354AG	M354AP	M854A	M854AG	M854AP	1.13	1.22	1.72	2.44	3.75	2.52
1-1/8	15	Bulk	7.00	M655A	M655AG	M655AP	M355A	M355AG	M355AP	M855A	M855AG	M855AP	1.25	1.36	1.84	2.66	4.02	2.69
1-1/4	18	Bulk	9.50	M656A	M656AG	M656AP	M356A	M356AG	M356AP	M856A	M856AG	M856AP	1.38	1.52	2.03	3.15	4.63	2.88
1-3/8	21	Bulk	12.50	M666A	M666AG	M666AP	M366A	M366AG	M366AP	M866A	M866AG	M866AP	1.50	1.65	2.25	3.25	5.19	3.25
1-1/2	25	Bulk	17.20	M657A	M657AG	M657AP	M357A	M357AG	M357AP	-	-	-	1.63	1.77	2.41	3.50	5.63	3.50
1-1/2	30	Bulk	17.20	-	-	-	-	-	-	M857A	M857AG	M857AP	1.63	1.77	2.41	3.50	5.63	3.50
1-5/8	29	Bulk	23.50	M685A	M685AG	M685AP	M385A	M385AG	M385AP	-	-	-	1.75	1.88	2.66	3.91	6.13	4.13
1-5/8	35	Bulk	23.50	-	-	-	-	-	-	M885A	M885AG	M885AP	1.75	1.88	2.66	3.91	6.13	4.13
1-3/4	34	Bulk	27.70	M677A	M677AG	M677AP	M377A	M377AG	M377AP	-	-	-	2.00	2.13	2.94	4.06	6.97	4.75
1-3/4	40	Bulk	27.70	-	-	-	-	-	-	M877A	M877AG	M877AP	2.00	2.13	2.94	4.06	6.97	4.75
2	43	Bulk	39.00	M658A	M658AG	M658AP	M358A	M358AG	M358AP	-	-	-	2.25	2.38	3.28	4.51	7.44	5.50
2	50	Bulk	39.00	-	-	-	-	-	-	M858A	M858AG	M858AP	2.25	2.38	3.28	4.51	7.44	5.50
2-1/2	85	Bulk	109.00	-	-	-	-	-	-	MC860AG	-	-	2.75	2.99	4.13	6.13	10.48	6.75
3	120	Bulk	148.00	-	-	-	-	-	-	MC862AG	-	-	3.25	3.53	5.00	6.56	13.00	7.38

WIRE ROPE
CHAINS
RIGGING HARDWARE
TRANSPORT TIE-DOWNS
SYNTHETIC SLINGS
WIRE ROPE FITTINGS
CLAMPS
PPE
HOISTS
BLOCKS
SPREADER BAR



Rigid Magnetic No-Touch Safety Tools

For Load Control, Positioning & Lifting/Pulling

SAFE-T-STIK



Fixed length magnetic no-touch safety tool. Guide and position heavy, dangerous steel safely.

Safely guide and position objects such as road plate, trench plate shoring, beams, poles, pipe and other heavy steel components with precision and control.

Part # STS001
Length: Fixed, 5 Feet Weight: 5 LBS
Handle: Adjustable
Grip Force: Over 400 LBS
Package Weight: 7 LBS
Package Size: 61" x 5" x 5"

SAFE-T-STIK SR

Part # STS005



Fixed length magnetic no-touch safety tool. Guide and position heavy, dangerous steel safely.

Our Short Reach model is perfect for guiding and positioning loads being hoisted into and out of position when workspace is congersted for confined.

SAFE-T-STIK XL



Extendable magnetic no-touch safety tool. More reach and adaptability on the job.

The adjustable Safe-T-Stik gives a worker more options and distance without compromising any ability to control heavy steel being hoisted into or out of position.

Part # STS002
Length: Adjustable, 5 to 8 Feet
Weight: 7 lbs
Handle: Adjustable
Grip Force: Over 400 LBS

SAFE-T-STIK mini



Compact, lightweight and super powerful no-touch lifting and pulling tool.

Designed to quickly and easily pull up in ground water valve covers, lids, and grates. Reduce the risk of injury and improve safety on the job.

Part # STS003
Length: Fixed, 30"
Weight: 4 lbs
Handle: Fixed
Lifting Force: Over 400 LBS

Part # STS005
Length: Fixed, 30"
Weight: 4 LBS
Handle: D Handle or Rotating T
Handle Lifting Force: Over 400 LBS
Package Weight: 6 LBS
Package Size: 32" x 5" x 5"

Lifting Eye

Lifting Body ID (Tons)	Safe Work Load (lb)	A (in.)	B (in.)	C (in.)	D (in.)	E (in.)	F (in.)	G (in.)
1-1.3 T	2,000	1.87	2.95	2.80	2.20	2.17	1.30	6.48
1.5-2.5 T	4,000	2.52	3.86	3.35	2.68	2.76	1.65	8.09
3.0-5.0 T	8,000	2.76	4.65	3.45	3.46	3.39	2.24	9.33
6.0-10.0 T	16,000	3.74	10.24	4.76	4.41	4.61	2.87	13.72
12.0-20.0 T	32,000	4.65	7.32	5.91	5.98	6.10	4.33	17.36
25.0-32.0 T	50,000	6.89	10.59	7.44	7.68	8.43	6.02	22.99

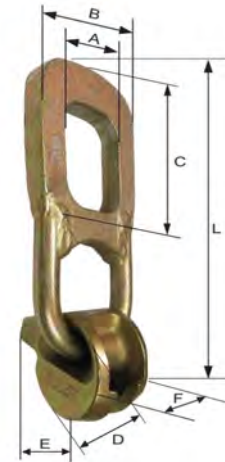

Timber Lifting Tong

Item #	Material Dia. & Max. Opening	Close Ht. "A"	Overall Ht. "C"	Shackle Size	Ring. Size	WLL at Degree of Opening						Approx. Weight
						75°		135°		180°		
						Jaw Open.	WLL (lbs)	Jaw Open.	WLL	Jaw Open.	WLL	
40008	3/4" x 16"	7"	18 3/4"	3/8" N/B*	5/8" x 2 3/4"	3 3/4"	1,500	12"	1,000	16"	750	7.0 lbs.
40218	1" x 20"	9"	23 1/4"	1/2" N/B	3/4" x 3"	4"	2,500	17"	2,000	20"	1,500	16.5 lbs.
40228	1" x 25"	10"	25 1/4"	1/2" N/B	3/4" x 3"	4 1/2"	2,500	20"	2,000	25"	1,500	17.0 lbs.
40458	1 1/4" x 32"	14"	31"	5/8" N/B	7/8" x 3 1/4"	7"	3,000	27"	2,500	32"	2,000	36.0 lbs.
40558	1 1/2" x 36"	16"	37 3/4"	3/4" N/B	1" x 4"	7 1/2"	5,000	32"	4,000	36"	3,000	50.5 lbs.



SKOOKUM® Ground Release Shackle

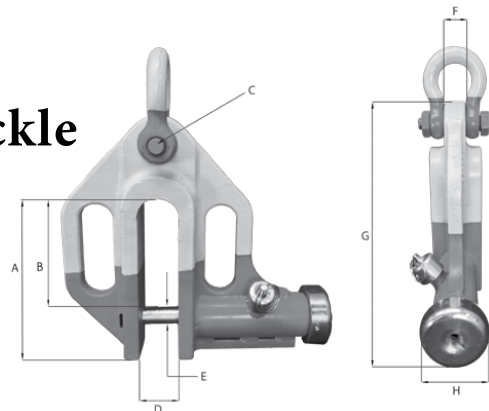

DIMENSIONS (IN)

A	B	C	D	E	F	G	H
9.00	6.38	0.94	2.00	1.13	1.00	11.68	3.50
10.75	8.13	1.19	2.25	1.13	1.50	15.25	4.00

SPECIFICATIONS

PART #	WLL ¹ (TONS)	WEIGHT (LBS)	REPAIR KIT #
615908	8.00	45.00	615908K
615912	12.00	70.00	615912K

¹Design factor is 4 to 1.

²Max opening with pin in open (unlocked) position.

Tons = 2000lbs



Item #	Rated Load	Thread Size	Thread Protrusion (E)	B
38215	10,000 lbs	1 1/4"	1 in	3.20 in
38225	10,000 lbs	1 1/2"	1 1/2 in	3.20 in

LIFTING HOOKS : ALLOY STEEL S-HOOKS

- Manufactured to exceed all ASME B30.20 and OSHA regulations.
- Corrosion resistant finish.
- Durable construction ideally suited to jobsite or warehouse use.
- Made in U.S.A.
- **Maximum use temperature is 400° F.**
- ±4% on dimensions.
- Custom designs available - call for assistance.

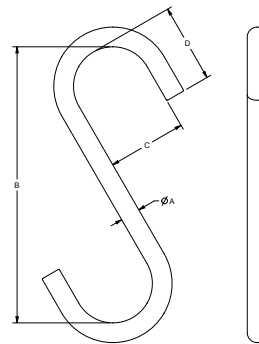

Material ØA in Inches*	Part Number		Standard Alloy Steel S-Hooks				Weight	Working Load Limit in Pounds*
	Style A	A	B	C	D			
1/4	14189	0.25	5.00	1.25	1.25	0.1	100	
5/16	14190	0.31	5.00	1.25	1.25	0.1	250	
3/8	14191	0.38	6.00	1.50	1.50	0.3	365	
1/2	14192	0.50	7.00	2.00	2.00	0.6	650	
9/16	14193	0.56	9.00	2.25	2.25	0.9	800	
5/8	14194	0.63	9.00	2.50	2.50	1.2	1,000	
3/4	14195	0.75	9.00	2.25	2.25	2.1	1,790	
7/8	14196	0.88	10.00	2.63	2.63	3.3	2,440	
1	14197	1.00	11.00	3.00	3.00	5.0	3,190	

*Larger capacities and custom configurations available. Please call for ordering assistance.

LIFTING HOOKS : ALLOY STEEL J-HOOKS EYE STYLE A

- ±4% on dimensions.
- Custom designs available - call for engineering.
- **All eyes welded unless otherwise specified.**
- Manufactured to exceed all ASME B30.20 and OSHA regulations.
- Corrosion resistant finish.
- Durable construction ideally suited to jobsite or warehouse use.
- Made in U.S.A.
- **Maximum use temperature is 400° F.**

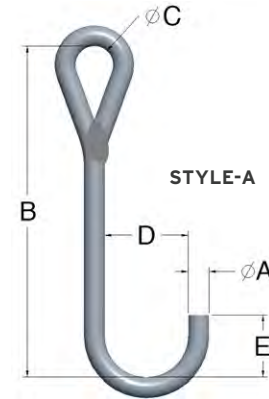

Material ØA in Inches*	Part Number C = D = E =	Standard Alloy Style A Steel J-Hooks - B (length)							
		5"	6"	7"	8"	9"	10"	12"	14"
Ø 1/4" WLL = 100 Pounds	Part Number	11621-5	11621-6	11621-7	11621-8	11621-9	11621-10	11621-12	11621-14
	C =	1.00	1.00	1.00	1.00	1.00	1.00	1.00	1.00
	D =	1.25	1.25	1.25	1.25	1.25	1.25	1.25	1.25
	E =	0.87	0.87	0.87	0.87	0.87	0.87	0.87	0.87
	WEIGHT	0.14	0.9	0.9	0.9	0.9	1	1	1
Ø 5/16" WLL = 250 Pounds	Part Number	11622-5	11622-6	11622-7	11622-8	11622-9	11622-10	11622-12	11622-14
	C =	1.00	1.00	1.00	1.00	1.00	1.00	1.00	1.00
	D =	1.25	1.25	1.25	1.25	1.25	1.25	1.25	1.25
	E =	0.87	0.87	0.87	0.87	0.87	0.87	0.87	0.87
	WEIGHT	0.21	0.9	0.9	0.9	0.9	1	1	1
Ø 3/8" WLL = 365 Pounds	Part Number	11623-5	11623-6	11623-7	11623-8	11623-9	11623-10	11623-12	11623-14
	C =	1.00	1.00	1.00	1.00	1.00	1.00	1.00	1.00
	D =	1.50	1.50	1.50	1.50	1.50	1.50	1.50	1.50
	E =	1.12	1.12	1.12	1.12	1.12	1.12	1.12	1.12
	WEIGHT	1.1	0.37	1.1	1.1	1.1	1.3	1.3	1.3
Ø 1/2" WLL = 650 Pounds	Part Number	11624-5	11624-6	11624-7	11624-8	11624-9	11624-10	11624-12	11624-14
	C =	1.00	1.00	1.00	1.00	1.00	1.00	1.00	1.00
	D =	2.00	2.00	2.00	2.00	2.00	2.00	2.00	2.00
	E =	1.50	1.50	1.50	1.50	1.50	1.50	1.50	1.50
	WEIGHT	1.5	1.5	1.5	0.83	1.6	1.7	1.7	1.8
Ø 5/8" WLL = 1,000 Pounds	Part Number	11625-5	11625-6	11625-7	11625-8	11625-9	11625-10	11625-12	11625-14
	C =	1.00	1.00	1.00	1.00	1.00	1.00	1.00	1.00
	D =	2.50	2.50	2.50	2.50	2.50	2.50	2.50	2.50
	E =	1.87	1.87	1.87	1.87	1.87	1.87	1.87	1.87
	WEIGHT	1.9	1.9	1.9	2	1.5	2	2.1	2.2
Ø 3/4" WLL = 1,450 Pounds	Part Number		11626-6	11626-7	11626-8	11626-9	11626-10	11626-12	11626-14
	C =		1.00	1.00	1.00	1.00	1.00	1.00	1.00
	D =		3.00	3.00	3.00	3.00	3.00	3.00	3.00
	E =		2.25	2.25	2.25	2.25	2.25	2.25	2.25
	WEIGHT		2.3	2.3	2.3	2.4	2.34	2.5	2.6
Ø 7/8" WLL = 1,900 Pounds	Part Number				11627-8	11627-9	11627-10	11627-12	11627-14
	C =				1.00	1.00	1.00	1.00	1.00
	D =				3.50	3.50	3.50	3.50	3.50
	E =				2.62	2.62	2.62	2.62	2.62
	WEIGHT				2.7	2.8	2.9	3.8	3.2
Ø 1" WLL = 2,600 Pounds	Part Number						11628-10	11628-12	11628-14
	C =						1.25	1.25	1.25
	D =						4.00	4.00	4.00
	E =						3.00	3.00	3.00
	WEIGHT						3	3.3	5.75

*Larger capacities and custom configurations available. Please call for ordering assistance.

Turnbuckles

Hot Galvanized, Drop Forged

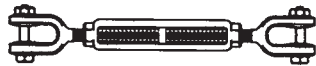

Jaw & Jaw

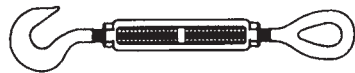

Hook & Eye



Hook & Hook



Eye & Eye

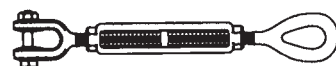

Jaw & Eye

Size (Dia. x Take-up)	Turnbuckles / Hot Galvanized, Drop Forged					Av. Overall Lght. with Ends in Closed Pos.
	Approximate Weight Each in Pounds			Working Load Limit in Lbs.		
	Approximate Weight Each in Pounds	Eyes and / or Hooks	Jaw & Eye	Hook & Hook Hook & Eye	Eye & Eye Jaw & Eye Jaw & Jaw	
1/4"x4"	.3	.3	.4	400	500	8.25
5/16"x4.1/2"	.5	.53	.58	700	800	9.56
3/8"x6"	.75	.82	.93	1,000	1,200	11.88
1/2"x6"	1.50	1.62	1.68	1,500	2,200	13.31
1/2"x9"	1.75	1.82	1.85	1,500	2,200	16.31
1/2"x12"	2.18	2.19	2.20	1,500	2,200	19.31
5/8"x6"	2.63	2.69	2.82	2,250	3,500	15.50
5/8"x9"	3.00	3.01	3.25	2,250	3,500	18.50
5/8"x12"	3.25	3.50	3.75	2,250	3,500	21.50
3/4"x6"	3.75	4.25	4.68	3,000	5,200	17.00
3/4"x9"	4.50	5.00	5.38	3,000	5,200	20.00
3/4"x12"	5.75	5.75	6.12	3,000	5,200	23.00
3/4"x18"	7.00	7.25	7.75	3,000	5,200	29.00
7/8"x12"	8.38	8.88	9.38	4,000	7,200	24.63
7/8"x18"	10.25	10.60	11.44	4,000	7,200	30.63
1"x6"	10.75	11.10	11.80	5,000	10,000	20.63
1"x12"	11.25	12.	12.88	5,000	10,000	26.63
1"x18"	14	14.75	16.1	5,000	10,000	32.63
1"x24"	17	17.75	18.6	5,000	10,000	38.63
1.1/4"x12"	19	21.2	23.6	5,000	15,200	29.88
1.1/4"x18"	24.1	26.0	26.6	5,000	15,200	35.88
1.1/4"x24"	25	28.7	31.2	5,000	15,200	41.88
1.1/2"x12"	27	31.1	35.5	7,500	21,400	32.88
1.1/2"x18"	31.2	36.4	40.7	7,500	21,400	38.88
1.1/2"x24"	38.2	44.2	47.63	7,500	21,400	44.38
1.3/4"x18"	53	57.5	62	-	28,000	41.38
1.3/4"x24"	58	60	64	-	28,000	47.75
2"x24"	90	102	115	-	37,000	51.75
2.1/2"x24"	163	180	200	-	60,000	58.50
2.3/4"x24"	180	214	248	-	75,000	61.50

MACHINERY EYEBOLTS

Drop forged steel. Heat treated after forging. Self-colored, zinc plated, or hot galvanized. Plain or shoulder type, blank or threaded. Threaded will be supplied unless otherwise specified.

- Meets or exceeds all requirements of ASME B30.26 including identification, ductility, design factor, proof load and temperature requirements.
- Material traceability available through Product Identification Code (PIC) System

STANDARD SHANK LENGTHS PLAIN PATTERN



Plain Pattern No.	Bolt Diameter N.C.	Standard Shank Length	Threaded		Blank	
			Part No.	Weight Per 100	Part No.	Weight Per 100
1	1/4"	1"	11605 3	5	11005 1	5.5
2	5/16"	1-1/8"	11625 1	10.5	11025 9	11.5
3	3/8"	1-1/4"	11645 9	15.5	11045 7	16.5
4	7/16"	1-3/8"	11665 7	20.5	11065 5	22
5	1/2"	1-1/2"	11685 5	33	11085 3	35
6	9/16"	1-5/8"	11705 0	44.5	11105 8	45
7	5/8"	1-3/4"	11725 8	64	11125 6	66
8	3/4"	2"	11748 7	90.5	11148 5	97
9	7/8"	2-1/4"	11768 5	135	11168 3	142
10	1"	2-1/2"	11788 3	190.5	11188 1	199
11	1-1/8"	2-3/4"	11808 8	299.5	11208 6	312
12	1-1/4"	3"	11831 6	399	11231 4	412
14	1-1/2"	3-1/2"	11851 4	662.5	11251 2	691

DROP FORGED SNAPHOOKS

Hooks are drop forged steel and heat treated. Latch, spring, machine screw and nut are stainless steel. Vertical loads are based on a design factor of 5 to 1.

HEAT TREATED SNAPHOOKS

Hook Size	Working Load Limit in Pounds	I.D. Eye	Throat Opening	Overall Length	Est. Wt. Per 100	Self-Colored	Galvanized
						Part No.	Part No.
7/16"	750 Lbs.	3/4"	3/4"	3-15/16"	28.8 Lbs.	22905 0	22955 5
9/16"	1000 Lbs.	1-1/8"	13/16"	4-3/4"	57.6 Lbs.	22910 4	22960 9





WLL	B/S	Size
4,700 lbs	18,800 lbs	5/16"x20'
6,600 lbs	26,400 lbs	3/8"x20'
11,300 lbs	45,200 lbs	1/2"x20'



FORGED RATCHET LOAD BINDER GRADES 30, 43, 70, 80, 100

WORKING LOAD LIMIT: 2,600 TO 16,000 LBS.

BENEFITS & FEATURES

- Handle is designed using a self-locking, open pawl allowing for easy removal of unwanted debris such as mud, snow or ice
- Proof tested to 50% of the minimum breaking strength
- Gears are permanently welded to the barrel
- Durable powder coated finish
- Design factor 3:1 or higher



Chain Grade & Size (in.)					Product Code	End Fittings	Standard Package	Working Load Limit (lbs.)
G30	G43	G70	G80	G100				
5/16 & 3/8	5/16 & 3/8	5/16	5/16	-	48365	Hook/Hook	4	5,400
3/8 & 1/2	3/8 & 1/2	3/8	3/8	3/8*	48366	Hook/Hook	4	9,200
1/2 & 5/8	1/2 & 5/8	1/2	1/2	-	48367	Hook/Hook	4	13,000
-	3/8 & 1/2	3/8 & 1/2	3/8 & 1/2	3/8	48458	Hook/Hook	4	12,000

* When used with 3/8 inch G100 chain, this assembly will have a 3:1 design factor

FORGED LEVER LOAD BINDER GRADES 30, 43, 70, 80

WORKING LOAD LIMIT: 2,600 TO 9,200 LBS.

BENEFITS & FEATURES

- All components are forged, not cast
- Forged binders are lighter and stronger than cast binders
- Under equal force a forged handle will yield and bend while a cast handle may break
- Design factor 3:1 or higher



Chain Grade & Size (in.)				Product Code	Working Load Limit (lbs.)	Handle Take Up (in.)	Handle Length (in.)	Weight (lbs.)
G30	G43	G70	G80					
1/4	1/4	-	-	48304	2,600	3.75	11.25	3.0
3/8	3/8	5/16	-	48305	5,400	4.50	16.12	8.1
1/2	1/2	3/8	-	48306	9,200	4.75	16.62	10.6
3/8	3/8	3/8	3/8	48769	7,100	4.50	16.62	8.1

2Inch Webbing Ratchet Assembly with Twin J Hooks



WLL	B/S	Dimension
3,333 lbs	10,000 lbs	2"x30'

2Inch Webbing Ratchet Assembly with Flat Hooks



WLL	B/S	Dimension
3,333 lbs	10,000 lbs	2"x30'

3 to 4 Inch Webbing Assembly with Wire Hooks



WLL	B/S	Dimension
5,000 lbs	15,000 lbs	3"x30'
5,400 lbs	16,200 lbs	4"x30'

3 to 4 Inch Webbing Ratchet Assembly with Flat Hooks



WLL	B/S	Dimension
5,000 lbs	15,000 lbs	3"x30'
5,400 lbs	16,200 lbs	4"x30'

4 Inch Webbing Ratchet Assembly with Delta Rings

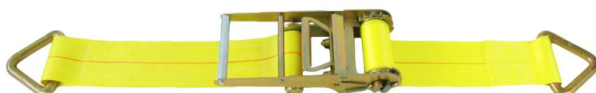

WLL	B/S	Dimension
5,400 lbs	16,200 lbs	4"x30'

Solid Braided Nylon Rope - Reels

Stock # White	Diameter (Inches)	Ft. Per Package	Lbs. Per Package	Working Load Limit	
				Lbs.	Kgs.
2804893	1/4	800	11	160	72
2805332	5/16	600	15	280	127
2804894	3/8	330	11	330	149
2804895	1/2	165	11	400	181
2804892	3/16	1000	9	82	37



Manilla Rope - Reels

Stock # Natural	Diameter (Inches)	Ft. Per Package	Lbs. Per Package	Working Load Limit	
				Lbs.	Kgs.
2880025	3/8	600	25	122	55
2880030	1/2	600	56	240	109
2880035	5/8	600	80	400	181
2880040	3/4	600	95	490	222

Poly Truck Rope - Reels

Stock # Natural	Diameter (Inches)	Ft. Per Package	Lbs. Per Package	Working Load Limit	
				Lbs.	Kgs.
2871290	3/8	600	20	270	122
2871295	1/2	300	15	420	190



3-Strand Poly Dacron Combo Rope



Diameter (Inches)	Ft. Per Package	Color	Working Load Limit (Lbs.)	
			Min.	Max.
3/8"	600'	White with Red Tracer	225	540
1/2"	600'	White with Red Tracer	367	880
5/8"	600'	White with Red Tracer	508	1220
5/8"	1,200'	White with Red Tracer	508	1220
3/4"	600'	White with Red Tracer	700	1680
7/8"	600'	White with Red Tracer	927	2225
1"	600'	White with Red Tracer	1098	2635
1"	1,200'	White with Red Tracer	1098	2635

RoundSlings

ENDLESS (ENR)

RoundSlings are the most basic roundsling, yet they offer great versatility.

Endless roundslings may be used in a vertical, choker or basket type hitch.

ADVANTAGES:

- Reduce cost with less total rigging weight
- Easy handling and storage
- Reduce risk of back and hand injuries
- Cover abrasion will not reduce capacity
- Provides a strong grip on loads
- Provides a tighter choke with an easier release
- Capacities are color coded

ENDLESS ROUNDSLING CAPACITY CHART

	Rated Capacity (lbs.)			Minimum Length	Approx. Diameter	Approx. WT / FT
	Vertical	Choker	Basket			
PURPLE	2,600	2,100	5,200	3'	.625"	0.3 LB
GREEN	5,300	4,200	10,600	3'	.875"	0.4 LB
YELLOW	8,400	6,700	16,800	3'	1.125"	0.5 LB
TAN	10,600	8,500	21,200	3'	1.125"	0.6 LB
RED	13,200	10,600	26,400	3'	1.375"	0.8 LB
WHITE	16,800	13,400	33,600	6'	1.375"	0.9 LB
BLUE	21,200	17,000	42,400	6'	1.625"	1.3 LB
ORANGE	25,000	20,000	50,000	6'	1.750"	1.6 LB
ORANGE	31,000	24,800	62,000	6'	2.125"	2.0 LB
ORANGE	40,000	32,000	80,000	6'	2.350"	2.6 LB
ORANGE	53,000	42,400	106,000	8'	3.150"	3.4 LB
ORANGE	66,000	52,800	132,000	8'	3.950"	4.3 LB
ORANGE	90,000	72,000	180,000	8'	4.800"	5.9 LB
ORANGE	100,000	80,000	200,000	8'	5.520"	6.8 LB

* LARGER SIZES AVAILABLE





WARNING

SLING FAILURE CAN CAUSE
DEATH OR INJURY

SLING FAILURE RESULTS FROM
MISUSE, DAMAGE, AND
EXCESSIVE WEAR

ADHERE TO INDUSTRY
STANDARDS & REGULATIONS



Fully Wrapped Eye



Round Quick Sleeve



Rated Capacity (lbs.)

	Number	(inches)	Vertical	Choker
One Ply	EE191	1	1,600	1,250
	EE192	2	3,200	2,560
	EE193	3	4,800	3,840
	EE194	4	6,400	5,120
	EE196	6	9,600	7,680
	EE198	8	12,800	10,240
	EE1910	10	16,000	12,800
	EE1912	12	19,200	15,360
Two Ply	EE291	1	3,200	2,560
	EE292	2	6,400	5,120
	EE293	3	9,300	7,440
	EE294	4	11,500	9,200
	EE296	6	16,500	13,200
	EE298	8	22,750	18,200
	EE2910	10	28,400	22,720
	EE2912	12	34,100	27,280
Three Ply	EE391	1	4,100	3,280
	EE392	2	8,300	6,640
	EE393	3	12,500	10,000
	EE394	4	16,000	12,800
	EE396	6	23,000	18,400
	EE398	8	30,700	24,560
	EE3910	10	36,800	29,440
	EE3912	12	44,000	35,200
Four Ply	EE491	1	6,200	4,960
	EE492	2	12,400	9,920
	EE493	3	17,000	13,600
	EE494	4	22,000	17,600
	EE496	6	33,000	26,400
	EE498	8	44,000	35,200
	EE4910	10	55,000	44,000
	EE4912	12	66,000	52,800

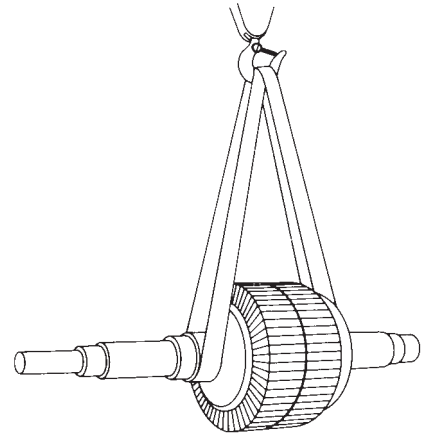

ENDLESS WEB SLING CAPACITY CHART

	Part Number	Web Width (inches)	Rated Capacity (lbs.)			Approximate Sling Weight (lbs.)		
			Vertical	Choker	Vertical Basket	Min. Standard Length (ft)	Base	Adder/ft.
One Ply	EN191	1	3,200	2,500	6,400	3	.40	.12
	EN192	2	6,400	5,000	12,800	3	.80	.25
	EN193	3	8,600	6,900	17,200	3	1.30	.35
	EN194	4	11,500	9,200	23,000	3	1.70	.48
	EN196	6	16,300	13,000	32,600	3	2.50	.70
	EN198	8	19,200	15,400	38,400	3	3.40	.95
	EN1910	10	22,400	17,900	44,800	3	4.20	1.20
	EN1912	12	26,900	21,500	53,800	3	5.0	1.40
Two Ply	EN291	1	6,200	4,900	12,400	3	.80	.25
	EN292	2	12,200	9,800	24,400	3	1.60	.50
	EN293	3	16,300	13,000	32,600	3	2.50	.75
	EN294	4	20,700	16,500	41,400	3	3.30	1.10
	EN296	6	28,600	23,000	57,200	3	4.90	1.50
	EN298	8	30,700	24,500	61,400	3	6.60	2.00
	EN2910	10	33,600	26,800	67,200	3	8.20	2.50
	EN2912	12	37,600	30,000	75,200	3	9.90	3.00
Three Ply	EN391	1	8,000	6,400	16,000	3	1.20	.38
	EN392	2	16,000	12,800	32,000	3	2.40	.75
	EN393	3	21,500	17,200	43,000	3	3.60	1.10
	EN394	4	28,700	23,000	57,400	3	4.80	1.50



The Inside Story

LOUPS™ are the most efficient synthetic slings available and far lighter than steel or conventional round slings. LOUPS bend gracefully. If you look inside a LOUP, you will find just one continuous looped piece of rope (Figure 1), which has been end-for-end spliced to itself.

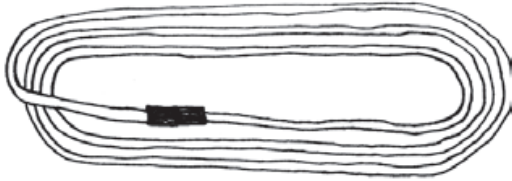
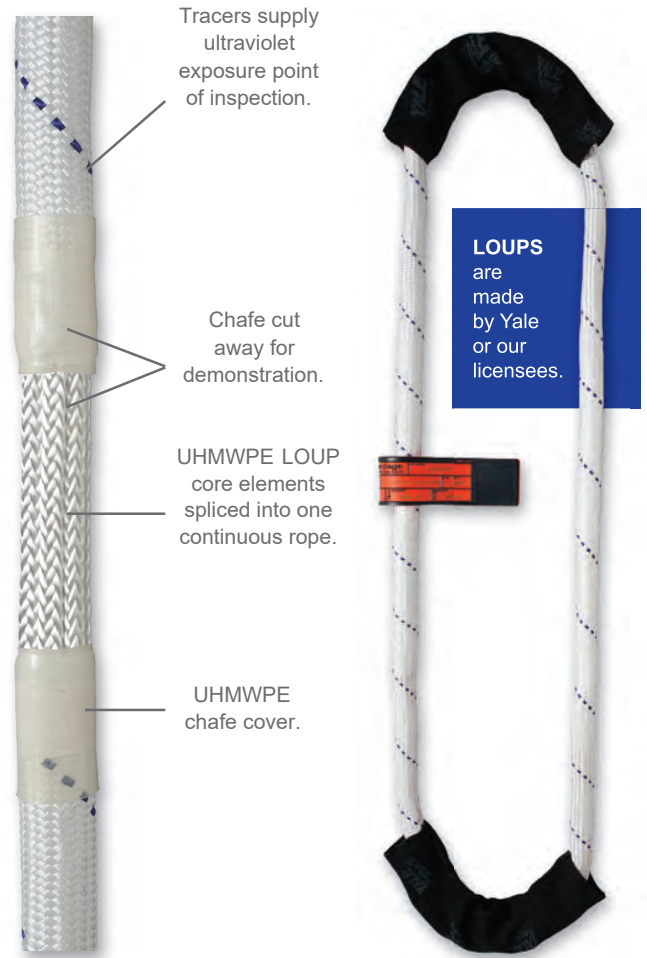

Figure 1

The diameter of the LOUP core and the number of wraps vary by the tensile strength of the LOUP Yale is building. Since the strength element is small, this product has a 1.1:1 D/d ratio (or bending radius) for Vertical WL. Simply put, LOUPS are less affected by sharp bending radii than larger ropes of comparable strength. LOUPS can be produced as small as 3" in length and as large as 5 million lbs. tensile.

LOUPS through Model 13A06 are annealed. Through an exhaustive research and development program, the right combination of stress and heat was identified, which now allows us to ship LOUPS at their full strength potential. LOUPS tell you when the sun has taken its toll. The distinctive tracer strands of LOUPS are, by design, more susceptible to ultraviolet attack than the rest of the sling. So, when the tracer yarns, which are nonload-bearing, start to break and fall out, it is time for you to replace the LOUP.



YALE CORDAGE
Performance. Passion. Possibilities.

LOUPS™

LOUPS high-modulus endless slings, by Yale Cordage or a Yale Cordage licensee, significantly advance the technology of lifting slings by utilizing a strength-optimizing, multiple-strand endless braid of Ultra High Molecular Weight Polyethylene UHMWPE fiber encased in a polyethylene abrasion sleeve.

The completed LOUP then undergoes Yale's proprietary annealing process, which elevates the tensile strength by up to four times that of similar-sized polyester-fiber-based slings. For longer or shorter lengths, call for availability. Optional proof loading available.

Specifications

Model	Diameter		Vertical Capacity*		Choker Capacity*		Basket Capacity*		Base Length	Max. Length
	Inches	(mm)	Lbs	Kg	Lbs	Kg	Lbs	Kg		
4A03	0.39	(10)	4,280	1,941	3,424	1,550	8,560	3,883	2	40
4A04	0.44	(11)	5,700	2,586	4,560	2,070	11,400	5,171	2	40
4A05	0.48	(12)	7,140	3,239	5,712	2,590	14,280	6,477	2	40
7A02	0.54	(14)	8,560	3,883	6,848	3,105	17,120	7,766	2	40
7A03	0.67	(17)	12,800	5,806	10,240	4,645	25,600	11,612	4	40
7A04	0.71	(18)	17,100	7,756	13,680	6,210	34,200	15,513	4	40
7A06	0.83	(21)	25,600	11,612	20,480	9,295	51,200	23,224	4	40
7A07	0.91	(23)	29,800	13,517	23,840	10,820	59,600	27,034	4	40
7A08	0.98	(25)	34,000	15,422	27,200	12,345	68,000	30,844	6	40
13A04	1.18	(30)	50,800	23,042	40,640	18,450	101,600	46,085	6	40
13A05	1.30	(33)	63,400	28,758	50,720	23,025	126,800	57,515	6	40
13A06	1.38	(35)	76,000	34,473	60,800	27,600	152,000	68,946	6	40

* Rated capacity is based on 5:1 Design Factor

Industrial LOUPS™

Industrial LOUPS high-modulus endless slings, by Yale Cordage or a Yale Cordage licensee, significantly advance the technology of lifting slings by utilizing a strength-optimizing, multiple-strand endless braid of UHMWPE fiber encased in a

polyethylene or polyester abrasion sleeve. For longer or shorter lengths, call for availability. Optional proof loading available.

Specifications

Model	Diameter		Vertical Capacity*		Choker Capacity*		Basket Capacity*		Base Length
	Inches	(mm)	Lbs	Kg	Lbs	Kg	Lbs	Kg	
13N08	1.7	(44)	83,776	38,001	67,021	30,425	167,552	76,002	6
13N10	1.9	(47)	104,720	47,501	83,776	38,030	209,440	95,002	6
19N06	2.3	(58)	126,000	57,154	100,800	45,760	252,000	114,307	6
19N07	2.4	(61)	147,000	66,679	117,600	53,390	294,000	133,358	6
19N08	2.6	(65)	168,000	76,205	134,400	61,015	336,000	152,410	6
19N10	2.9	(74)	210,000	95,256	168,000	76,270	420,000	190,512	6
32N05	3.6	(91)	240,800	109,227	192,640	87,455	481,600	218,454	8
32N06	3.9	(99)	288,960	131,072	231,168	104,950	577,920	262,145	8
32N07	4.1	(105)	337,120	152,918	269,696	122,440	674,240	305,835	8
32N08	4.4	(112)	385,280	174,763	308,224	139,930	770,560	349,526	8
32N10	4.9	(124)	481,600	218,454	385,280	174,915	963,200	436,908	10
32N12	5.3	(134)	577,920	262,145	462,336	209,900	1,155,840	524,289	10

* Rated capacity is based on 5:1 Design Factor

Sliding Latch Type Choker Hooks



This hook is designed to choke a secure hold on a load in position. A latch prevents the eye of the sling from disengaging from the hook. Sizes available 3/8" thru 3/4"
 Latch Kits Available.

Stock No. (Hook)	Stock No. (Kit)	Rope Size	Wt. Lbs.	W.L.L.	Thimble Size	A	B	C	D	E ^R	F	G	H
SCH-12L	LK-12	3/8	1-1/4	2,600	3/8	11/16	11/16	5/8	2	7/16	11/16	3-1/8	4-1/4
SCH-16L	LK-16	1/2	1-3/4	3,400	1/2	3/4	3/4	7/8	2-1/8	1/2	3/4	3-5/8	4-13/16
SCH-20L	LK-20	5/8	3-1/4	5,100	5/8	7/8	7/8	1-1/8	2-3/4	9/16	15/16	4-7/16	5-15/16
SCH-24L	LK-24	3/4	5	8,000	3/4	1	1	1-1/8	3-1/8	11/16	1-1/4	4-11/16	6-7/16
SCH-28L	LK-28	7/8	13	12,000	7/8	1-1/4	1-1/4	1-1/4	4-13/16	7/8	1-5/8	6-13/16	9

Sliding Choker Hooks

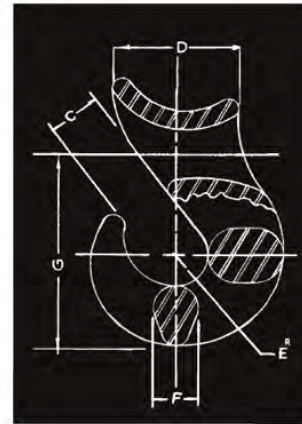
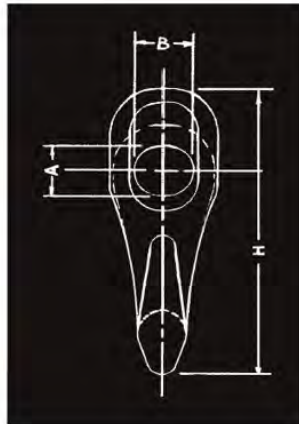

NEWCO sliding hooks afford faster handling on factory made slings for handling pipe, logging, machinery, and in stevedoring. Its free movement permits rapid adjustment of the sling in varying sized loads. "Saddle is rounded to minimize wear" Hook opening is large enough to take a galvanized plow steel thimble in the same size as a hook size.

All Choker Hooks manufactured by Newco Mfg. Co., Inc., used in any other way than the Choker Configuration, will not be warrantied.

Rope Size	Wt. Lbs.	W.L.L.	Thimble SIZE	A	B	C	D	E	F	G	H
*1/4 - 5/16	1	1,500	1/4 - 5/16	9/16	9/16	1/2	1-3/4	3/8	5/8	2-3/4	3-3/4
3/8	1.31	2,600	3/8	11/16	11/16	5/8	2	7/16	11/16	3-1/8	4-1/4
1/2	1.85	3,400	1/2	3/4	3/4	7/8	2-1/8	1/2	3/4	3-5/8	4-13/16
5/8	4	5,100	5/8	7/8	7/8	1-1/8	2-3/4	9/16	15/16	4-7/16	5-15/16
3/4	4.5	8,000	3/4	1	1	1-1/8	3-1/8	11/16	1-1/4	4-11/16	6-7/16
7/8-1	10	15,000	7/8-1	1-1/4	1-1/4	1-1/4	4-1/4	7/8	1-9/16	6-1/16	8-1/8
1-1/8 - 1-1/4	26	23,000	1-1/8 - 1-1/4	2-5/16	2-5/16	2-3/4	5-5/8	1	1-3/4	8-11/16	11-5/8
1-3/8 - 1-1/2	50	30,000	1-3/8 - 1-1/2	2-13/16	2-13/16	2-3/8	7	1-1/4	2	10-5/8	14-1/2

Upson-Walton™ Stainless Steel Closed Swage Sockets

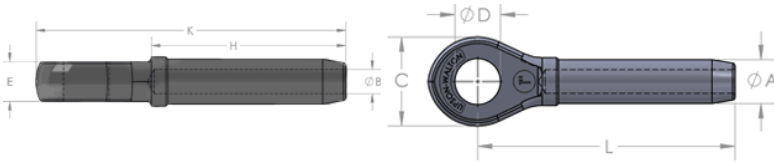

Stock No.	Rope Size	Dimensions								After Swage Min - Max
		A	B	C	D	E	H	K	L	
41025050	1/4	0.495	0.272	1-7/16	0.750	1/2	2-1/8	4-3/8	3-1/2	0.428 - 0.460
41031350	5/16	0.770	0.339	1-11/16	0.875	11/16	3-3/16	5-1/2	4-1/2	0.678 - 0.710
41037550	3/8	0.770	0.406	1-11/16	0.875	11/16	3-3/16	5-1/2	4-1/2	0.678 - 0.710
41043850	7/16	0.982	0.484	2	1.063	7/8	4-1/4	6-15/16	5-3/4	0.865 - 0.910
41050050	1/2	0.982	0.547	2	1.063	7/8	4-1/4	6-15/16	5-3/4	0.865 - 0.910
41056350	9/16	1.257	0.609	2-1/2	1.250	1-1/8	5-5/16	8-3/4	7-1/4	1.115 - 1.160
41062550	5/8	1.257	0.672	2-1/2	1.250	1-1/8	5-5/16	8-3/4	7-1/4	1.115 - 1.160
41075050	3/4	1.545	0.796	3	1.438	1-5/16	6-3/8	10-3/8	8-5/8	1.365 - 1.420
41087550	7/8	1.700	0.938	3-1/2	1.688	1-1/2	7-7/16	12-1/8	10-1/8	1.490 - 1.550
41100050	1-0/0	1.975	1.062	4	2.063	1-3/4	8-1/2	13-3/4	11-1/2	1.740 - 1.800
41112550	1-1/8	2.245	1.188	4-1/2	2.313	2	9-9/16	15-1/4	12-3/4	1.990 - 2.050
41125050	1-1/4	2.525	1.328	5	2.563	2-1/4	10-5/8	17-1/4	14-3/8	2.240 - 2.300

Upson-Walton™ Stainless Steel Open Swage Sockets

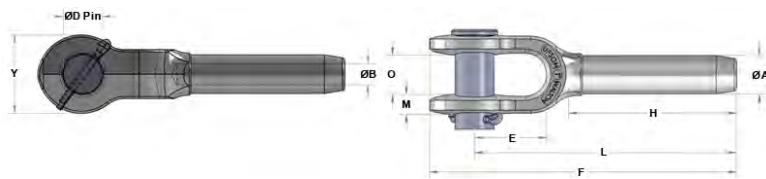

Stock No.	Rope Size	Dimensions										After Swage Min - Max
		A	B	D	E	F	H	L	M	O	Y	
40025050	1/4	0.495	0.272	0.688	1-1/2	4-3/4	2-1/8	4	5/16	11/16	1-3/8	0.428 - 0.460
40031350	5/16	0.770	0.339	0.812	1-3/4	6-1/4	3-3/16	5-5/16	13/32	13/16	1-5/8	0.678 - 0.710
40037550	3/8	0.770	0.406	0.812	1-3/4	6-1/4	3-3/16	5-5/16	13/32	13/16	1-5/8	0.678 - 0.710
40043850	7/16	0.982	0.484	1.000	2	7-13/16	4-1/4	6-11/16	1/2	1	2	0.865 - 0.910
40050050	1/2	0.982	0.547	1.000	2	7-13/16	4-1/4	6-11/16	1/2	1	2	0.865 - 0.910
40056350	9/16	1.257	0.609	1.190	2-1/4	9-9/16	5-5/16	8-1/8	5/8	1-1/4	2-1/2	1.115 - 1.160
40062550	5/8	1.257	0.672	1.190	2-1/4	9-9/16	5-5/16	8-1/8	5/8	1-1/4	2-1/2	1.115 - 1.160
40075050	3/4	1.545	0.796	1.380	2-3/4	11-11/16	6-3/8	10	3/4	1-1/2	3	1.365 - 1.420
40087550	7/8	1.700	0.938	1.630	3-1/4	13-5/8	7-7/16	11-5/8	15/16	1-3/4	3-3/8	1.490 - 1.550
40100050	1-0/0	1.975	1.062	2.000	3-3/4	15-5/8	8-1/2	13-3/8	1-1/32	2	4	1.740 - 1.800
40112550	1-1/8	2.245	1.188	2.250	4-1/4	17-1/2	9-9/16	15	1-3/16	2-1/4	4-1/2	1.990 - 2.050
40125050	1-1/4	2.525	1.328	2.500	4-3/4	19-7/16	10-5/8	16-1/2	1-3/16	2-1/2	5	2.240 - 2.300



WIRE ROPE
CHAINS
RIGGING HARDWARE
TIE-DOWNS
SYNTHETIC SLINGS
WIRE ROPE FITTINGS
CLAMPS
PPE
HOISTS
BLOCKS
SPREADER BAR

Muncy™ Teacup Fittings

Muncy offers an efficient way of lifting concrete pipe in its Tea Cups. Muncy's light weight design (also called a "low profile"), coupled with its lifting handle, make it an easier way to lift pipe. Tea Cups are used with a wire rope sling with a button ferrule on one end.

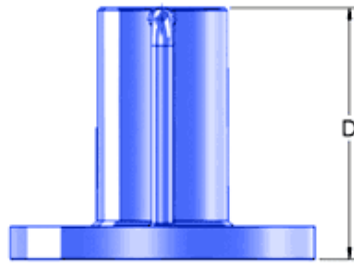
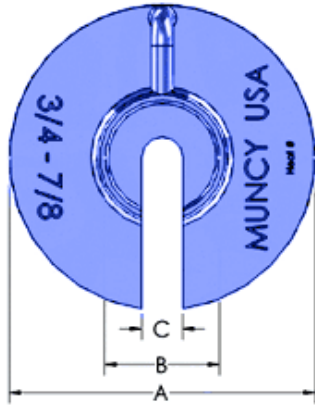

- An efficient way to handle concrete pipes
- Light weight design
- Available with 7" and 12" diameter flanges.
- To be used with our special Muncy™ Machine NB Buttons

Stock No.	Rope Size	Dimensions					Weight	Use With Muncy Button	WLL
		A	B	C	D				
TC-24	3/4 - 7/8	7.00	2.50	0.938	5.75	9.5 lbs	NB-24, NB-28	12,320	
TC-32	1 - 1-1/8	7.00	2.50	1.250	5.75	9.5 lbs	NB-32, NB-36	26,000	
TC-40	1-1/4	7.00	3.00	1.375	5.75	10 lbs	NB-40	31,960	

Stock No.	Rope Size	Dimensions					Weight	Use With Muncy Button	WLL
		A	B	C	D				
TC-24A	3/4 - 7/8	12.00	2.50	0.938	5.75	26 lbs	NB-24, NB-28	12,320	
TC-32A	1 - 1-1/8	12.00	2.50	1.250	5.75	26 lbs	NB-32, NB-36	26,000	
TC-40A	1-1/4	12.00	3.00	1.375	5.75	27 lbs	NB-40	31,960	

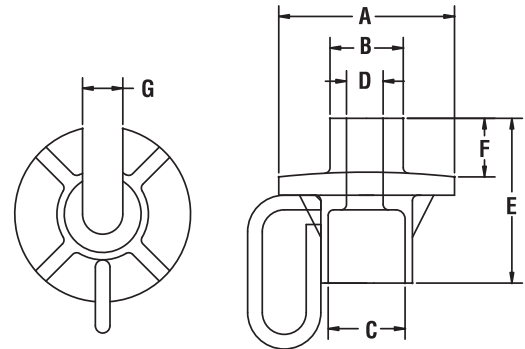

SPECIFICATIONS

Model Number	Rated Capacity (tons)	Dimensions (inches)							Weight (lbs)
		A	B	C	D	E	F	G	
PC-3/4*	6.6	5.56	2	2.13	1.13	4.75	1.75	1.13	9
PC-1	13	6	2.50	2.63	1.38	5.75	1.75	1.38	12
PC-1 1/2	18	8	3	3.25	1.63	7.63	2.75	1.63	22

* Can use "Spoon Handle" with this model

Muncy Uses Premium Steel for its SB Buttons

Muncy specifies material for its buttons stops that is conducive to better swageability and strength. As such, Muncy’s wire rope buttons are time testing, having made for over 50 years. With better swageability comes better die life: less wear on swaging dies.

Muncy Steel Button Ferrule Applications

Carbon Steel Buttons seem to have an eclectic array of product uses, from picking up pipe (with a Muncy Tea Cup) to on a roll-off truck (with a Muncy Roll-off Hook). Some buttons are swaged on cable every few inches for conveyor applications and others used on the end of the rope to be placed inside a drum.



All Muncy Machine and Tool™ fittings are machined from carbon steel specially selected for swaging. Aluminum and stainless steel available upon request.

Stock No.	Rope Dia.	After Swage Dimension					Weight lbs. Each
		A			B		
		Min	Nominal	Max	Approx.		
SB-8	1/4	0.615	5/8	0.625	0.635	1.125	0.09
SB-10	5/16	0.740	3/4	0.75	0.77	1.500	0.17
SB-12	3/8	0.855	7/8	0.875	0.895	1.750	0.27
SB-16	1/2	1.105	1-1/8	1.125	1.16	2.375	0.59
SB-18	9/16	1.230	1-1/4	1.250	1.29	2.625	0.8
SB-24	3/4	1.480	1-1/2	1.500	1.55	3.500	1.46
SB-28	7/8	1.730	1-3/4	1.750	1.75	4.125	2.32
SB-32	1	1.980	2	2.000	2	4.750	3.53
SB-36	1-1/8	2.220	2-1/4	2.250	2.3	5.250	5
SB-40	1-1/4	2.470	2-1/2	2.500	2.56	5.875	6.79

OPERATION



Drop pipe carrier lifting sling through hole in pipe. Align and insert "Tea Cup" pipe carrier into lifting sling.



Once set, you are ready to lift the pipe.

CY HINGED UNIVERSAL PLATE CLAMP

WORKING LOAD LIMIT: 450 TO 6,600 LBS.

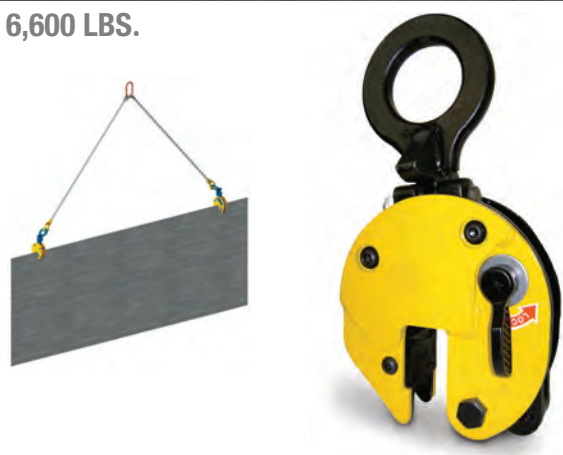

Product Code	Working Load Limit		Jaw Capacity (in.)	Dimensions (in.)								
	Minimum (lbs.)	Maximum (lbs.)		A	B	C	D	E	F	G	H	I
CY1	450	2,200	0 to 3/4	4.961	10.630	1.969	1.929	2.756	3.740	2.480	0.472	0.906
CY2	900	4,400	0 to 1-1/4	7.559	15.039	3.150	2.953	3.780	5.197	3.622	0.787	1.181
CY3	1,350	6,600	0 to 1-1/4	7.559	15.039	3.150	2.953	3.780	5.197	3.622	0.787	1.181

CZ UNIVERSAL PLATE CLAMP

WORKING LOAD LIMIT: 120 TO 66,000 LBS.

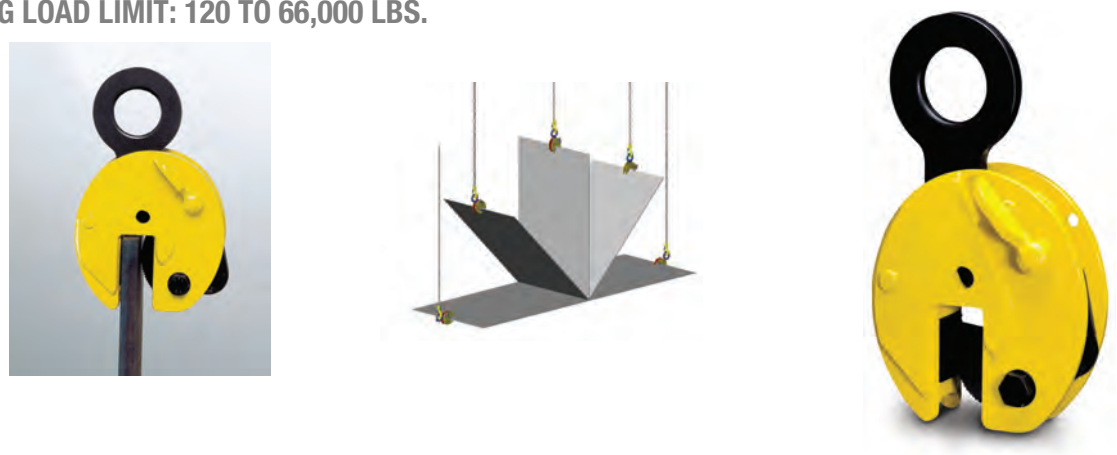

Product Code	Working Load Limit		Jaw Capacity (in.)	Dimensions (in.)								Weight (lbs.)
	Minimum (lbs.)	Maximum (lbs.)		A	B	C	D	E	F	G	H	
92 500	120	1,100	0 to 5/8	3.898	7.677	1.142	1.299	1.850	1.969	0.393	0.433	3.3
92 1500	350	3,300	0 to 3/4	4.961	8.858	1.969	1.929	2.756	3.228	0.472	0.472	6.6
92 2000	450	4,400	0 to 1-1/4	7.559	12.283	3.150	2.953	3.780	3.937	0.787	0.787	17.6
92 3000	675	6,600	0 to 1-1/4	7.559	12.283	3.150	2.953	3.780	3.937	0.787	1.181	22.0
CZ4	1,100	8,800	0 to 1-1/4	7.756	14.606	3.150	2.677	3.661	5.079	0.787	1.181	26.5
CZ4L	1,100	8,800	1-1/8 to	8.976	15.354	3.150	2.677	3.661	5.079	0.787	1.181	39.7
CZ6	1,600	13,200	2-3/8 0 to 2	11.535	19.055	3.504	3.740	5.630	5.079	0.984	1.378	46.3
CZ8	2,150	17,600	0 to 2	11.535	19.370	3.504	3.740	5.630	5.079	0.984	1.654	57.3
CZ8L	2,150	17,600	2 to 4	14.252	20.630	3.504	4.488	5.630	5.079	0.984	1.654	70.5
CZ10	3,350	22,000	0 to 2	11.535	21.457	4.331	3.740	5.630	5.472	0.984	1.772	66.1
CZ10L*	3,350	22,000	2 to 4	14.252	21.457	4.331	4.488	5.630	5.472	0.984	1.772	81.6
CZ15	6,650	33,000	0 to 2	14.173	24.134	5.118	4.921	6.378	8.031	1.772	2.165	165.3
CZ15L*	6,650	33,000	2 to 4	18.110	26.693	5.118	6.890	6.378	8.031	1.772	2.165	194.0
CZ20*	8,850	44,000	0 to 2-1/2	18.189	29.724	5.118	6.496	8.268	9.252	1.772	2.559	271.2
CZ20L*	8,850	44,000	2-1/2 to 5	22.047	31.693	5.118	7.677	8.268	9.252	1.772	2.559	299.8
CZ30*	13,250	66,000	0 to 2-1/2	18.189	28.819	2.362	6.496	8.268	11.614	2.559	-	429.9

*Not Stocked

THK HORIZONTAL PLATE CLAMP

WORKING LOAD LIMIT: 90 TO 19,800 LBS.



Product Code	Working Load Limit		Plate (in.)	Dimensions (in.)						Weight (lbs. per pair)
	Minimum (lbs.)	Maximum (lbs.)		A	B	C	D	E	F	
THK750	90	1,600	0 to 1	4.625	5.375	0.750	1.000	2.875	3.125	6.6
THK1500	200	3,300	0 to 1-3/8	5.375	6.625	1.000	1.250	3.125	3.500	13.2
THK4500*	500	9,900	0 to 1-3/4	8.625	8.625	1.750	4.000	4.375	4.375	35.3
THK6000	700	13,200	0 to 2-3/8	8.375	10.500	1.375	1.875	4.875	4.375	50.7
THK9000	1,000	19,800	0 to 2-3/8	8.750	11.375	1.625	2.250	4.500	5.500	77.2

UBC Universal Beam Clamp



Harrington's UBC Universal Beam Clamp is the perfect accessory when a temporary or semi-permanent hoist anchor point is required. Additionally used as a below-the-hook lifting attachment, this adjustable beam clamp offers an efficient, cost-effective method for most workholding and positioning applications. Available in capacities of 1, 2, 3, 5 and 10 Tons.

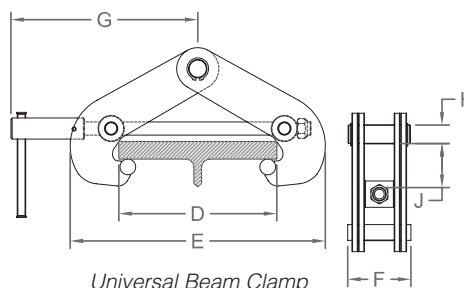

UBC UNIVERSAL BEAM CLAMP — SPECIFICATIONS AND DIMENSIONS

Capacity (Tons)	Product Code	Flange Range D (in)	Max. Beam Flange Thickness (in)	Max. E (in)	F (in)	G (in)	H (in)	J (in)	UBC Suspender Option				Net Weight (lbs)*	Shipping Weight Approx. (lbs)*
									A (in)	B (in)	C (in)	T (in)		
1	UBC010	3.00 to 7.50	0.83	12.25	3.00	9.25	0.88	2.10	0.75	2.00	2.00	0.63	8	10
2	UBC020												9	11
3	UBC030	4.00 to 12.00	1.00	19.75	4.25	11.0	1.25	2.38	1.00	2.50	2.50	1.00	19	22
5	UBC050												22	25
10	UBC100	6.00 to 13.25	1.75	22.50	6.00	14.63	1.75	4.65	1.38	3.75	6.25	1.25	55	60

*The weights listed are for standard universal beam clamps without large suspenders.

WIRE ROPE

CHAINS

RIGGING
HARDWARE

TRANSPORT
TIE-DOWNS

SYNTHETIC
SLINGS

WIRE ROPE
FITTINGS

CLAMPS

PPE

HOISTS

BLOCKS

SPREADER
BARS



7414 Bolt-on D-ring Plate

Permanent



Bolt-on D-ring features 2" x 4½" plated alloy steel anchoring plate and D-ring with ½" bolt holes requiring user-supplied fasteners for permanent installation.

7428 Pass-through Cable Choker

Temporary

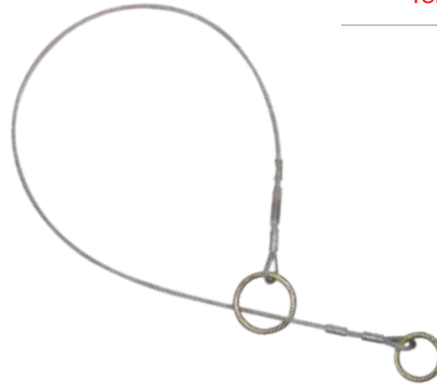

6' pass-through choker anchor features ¼" galvanized steel cable available uncoated and with vinyl coating. Large and medium size O-rings allow simple pass-through choke-on installation leaving smaller O-ring as connection point for lanyard or SRL in temporary installation.

7530 Trailing Beam Clamp

Temporary



Trailing beam anchor features dual-clamp adjustment with aluminum crossbar and steel jaws with nylon slider pads and concealed adjustment latches. Plated steel D-ring remains centered on crossbar and fits 3" to 14" wide beam flanges up to 1¼" thick for temporary and mobile use on horizontal I-beams.

Item #	Length	Materials
7427	4'	¼" Vinyl Coated Galvanized Cable 3" and 2¼" Alloy Steel D-rings
7428	6'	
742808	8'	
7437	4'	¼" Galvanized Cable 3" and 2¼" Alloy Steel D-rings
7438	6'	
743808	8'	

Additional lengths available

7440S Swivel-eye Expansion Wedge

Temporary



Swivel-eye expansion wedge anchor features 5,000 lbs. static strength, requires 3½" min hole depth and allows ¾" max hole diameter for temporary use in cured concrete.

7440 Swaged-eye Expansion Wedge

Temporary



Swaged-eye expansion wedge anchor features 5,000 lbs. static strength, requires 3½" min hole depth and allows ¾" max hole diameter for temporary use in cured concrete.

7451C | Rotating D-ring with Expansion Bolt

Temporary



Rotating D-ring anchor with torque-indicating expansion bolt features plated stainless steel anchoring plate with alloy steel connecting D-ring. Precision-cut bushing provides 360° D-ring rotation for temporary or permanent installation in cured concrete.

7410 | Hinged Reusable

Temporary



Reusable roof anchor features hinged design, 10" x 3" anchoring plates and 2¼" connecting D-ring for temporary reusable installation on wood structures. Includes 16D nails for roof ridge or field installation.

7236 | Cinch-loop Web Choker

Temporary



3' cinch-loop web choker anchor features 1¾" heavy weight polyester web with connection D-ring for temporary reusable installation on properly rated structures. Familiar cinch-loop design provides easy choke-on attachment.

7336 | Pass-through Web Choker

Temporary



3' pass-through web choker anchor with 1¾" load-bearing web and 3" wide wear pad for temporary reusable applications on properly rated structures. Large and medium size D-rings allow simple pass-through choke-on installation leaving smaller D-ring as connection point for lanyards or SRLs.

Additional lengths available up to 40'

Item#	Length
7218	18'
7224	2'
722448	4'
7272	6'

Item#	Length
7324	2'
7348	4'
7372	6'
737208	8'
737210	10'
7373	12'

When it comes to your fall protection equipment, there's nothing more personal, essential or important than your full body harness. While FallTech harnesses are built to meet or exceed ANSI standards and OSHA regulations, we've also designed comfort, support and accessibility into our body wear with continued freedom of movement, sustained safety and productivity for workers at height.

ADVANCED COMFORTECH® GEL



Exclusive Comfort-GEL endoskeleton, dorsal SRL attachment sleeve and aluminum camlock torso adjusters.

Forged aluminum D-rings, Quick Connect buckles and cool-vent lumbar zone

TRADESMAN PLUS



Exclusive dorsal SRL attachment sleeve, tri-layer padded air-mesh shoulder yoke and Quick Connect chest buckles.

Traditional low-profile spring-tension torso adjusters, reinforced waist support and positioning pad and paired lanyard parking keepers.

FLOWTECH® LTE



Proprietary FlowScape venting channels, dorsal SRL attachment sleeve and aluminum camlock torso adjusters.

Forged aluminum D-rings, moisture wicking mesh lining and twist-indicating 2-sided webbing.

TRADESMAN



Established features include forged alloy steel D-rings, friction roller torso adjusters, independent 10" shoulder pads and 9 adjustment position belt on Construction models.

JOURNEYMAN FLEX ALUMINUM



Unique ergonomic reinforced waist support and positioning pad, dorsal SRL attachment sleeve and aluminum camlock torso adjusters.

Forged aluminum D-rings, contoured hip-to-seat leg pads and Quick Connect buckles.

CONTRACTOR PLUS



Exclusive dorsal SRL attachment sleeve, breathable padded air-mesh shoulder yoke and stabilized waist support positioning pad.

Mating Buckle chest closures, low-profile spring-tension torso adjusters and paired lanyard parking keepers.

JOURNEYMAN FLEX STEEL



Preferred padding enhanced throughout shoulders and waist, dorsal SRL attachment sleeve and contoured hip-to-seat leg pads.

Traditional low-profile spring-tension torso adjusters, forged alloy steel D-rings and Quick Connect buckles.

CONTRACTOR



Established features include Mating Buckle torso adjusters, stamped steel D-rings, independent 7" shoulder pads and 9 adjustment position belt on Construction models.

8247ELY3D | Ironman® Lanyard

4½' to 6' Double-Leg

Transverse Load rated
rebar hooks



100% tie-off Ironman® lanyard with elastic legs, steel snap hook for harness attachment and steel rebar hooks for anchorage connections plus, an integral D-ring for SRL connection.

826073 | ViewPack® Lanyard

6' Double-Leg

Transverse Load rated
rebar hooks



100% tie-off lanyard with polyester web, steel snap hook for harness attachment and steel rebar hooks for anchorage connections.

8256 | ViewPack® Lanyard

6' Single-Leg



ViewPack® lanyard with polyester web and steel snap hooks for harness and anchorage connection.

8253: 3' polyester web lanyard.
8254: 4' polyester web lanyard.

8260733FT: 3' 100% tie-off lanyard.
8260734: 4' 100% tie-off lanyard.

8357Y3 | ViewPack® Lanyard

6' Double-Leg

Transverse Load rated
rebar hooks



100% tie-off lanyard with ¼" vinyl coated galvanized steel cable, steel snap hook for harness attachment and steel rebar hooks for anchorage connections.

8357Y: 100% tie-off lanyard with steel snap hooks for harness and anchorage connections.

8240Y3A | ElasTech® Lanyard

4½' to 6' Double-Leg

Transverse Load rated
rebar hooks



100% tie-off lanyard with tubular polyester web and internal elastic, aluminum snap hook for harness attachment and aluminum rebar hooks for anchorage connections.

8240 | ViewPack® Lanyard

4½' to 6' Single-Leg



Lanyard with tubular polyester web and internal elastic, steel snap hooks for harness and anchorage connection.

8240L: Lanyard with choke-loop for harness attachment.
8240Y: Double-leg lanyard with steel snap hooks for harness and anchorage connections.

82063 | Restraint Lanyard

Fixed-Length Web

Transverse Load rated rebar hook



6' restraint lanyard with steel snap and rebar hook.

82033: 3' web restraint lanyard.

82043: 4' web restraint lanyard.

8206Y3: 6' double-leg web restraint lanyard.

8209 | Restraint Lanyard

Adjustable Web



4' to 6' adjustable length jacketed dual-layer web restraint lanyard with steel snap hooks.

82098: 5' to 8' web restraint lanyard.

820910: 6' to 10' web restraint lanyard.

820912: 7' to 12' web restraint lanyard.

82093: 4' to 6' web restraint lanyard with rebar hook

Additional adjustable lengths available.

8250LTW | Rebar Positioning Lanyard

Dual-Layer Web

Transverse Load rated rebar hook



24" lanyard with jacketed dual-layer polyester web, steel snap hooks for hip D-ring attachment and standard non-swivel rebar hook for vertical rebar connection.

8250LTWA: 24" web lanyard with aluminum snap hooks and aluminum standard non-swivel rebar hook.

8250LTWTA: 24" Kevlar® web lanyard with aluminum snap and rebar hooks.

8250LT | Rebar Positioning Lanyard

Welded-Link Chain

Transverse Load rated rebar hook



21" lanyard with 9/32" Grade 80 chain, steel snap hooks for hip D-ring attachment and standard non-swivel rebar hook for vertical rebar connection.

8250LT10LK: 17" chain lanyard with steel snap hooks and standard non-swivel rebar hook.

8358
Rope Adjuster

Hinged Trailing



Hinged trailing rope adjuster with 3' ViewPack® energy absorbing lanyard.

8359: Stainless steel hinged trailing rope adjuster with 3' ViewPack energy absorbing lanyard.

8358LT: Hinged trailing rope adjuster with Soft Pack energy absorbing lanyard.

8366L | D-ring Extender

Choke-Loop



18" extender with 1" polyester web, dorsal choke-loop and steel connecting ring.

83662D: 18" extender with two D-rings for user transition between deceleration devices.

7479 | Rope Adjuster

Hinged Trailing



Alloy steel rope adjuster with hinged trailing mobility and anti-inversion function.

8150T | Premium Vertical Lifeline

Tape-end



50' vertical lifeline features low-stretch premium 5/8" 3-strand twisted polyester rope with integral steel thimble and snap hook on the anchoring end plus a taped trailing end for simple user replacement with manual adjusters.

- 8125T:** 25' lifeline with taped trailing end.
- 8130T:** 30' lifeline with taped trailing end.
- 8200T:** 100' lifeline with taped trailing end.
- 7120:** 5 lb. Lifeline Counterweight also available.

8150 | Premium Vertical Lifeline

Back-Splice



50' vertical lifeline features low-stretch premium 5/8" 3-strand twisted polyester rope with integral steel thimble and snap hook on the anchoring end and the back-spliced trailing end is ideally suited for replacement with hinged adjusters.

- 8125:** 25' lifeline with back-spliced trailing end.
- 8175:** 75' lifeline with back-spliced trailing end.
- 8200:** 100' lifeline with back-spliced trailing end.
- 81505:** 150' lifeline with back-spliced trailing end.

8366 | D-ring Extender

Snap Hook



18" extender features 1" polyester web with steel snap hook and connecting ring.

- 8202:** 14" extender.
- 836616:** 16" extender.
- 836624:** 24" extender.

5071 | SRL Carabiner

Triple-Lock Steel



3 3/8" x 1 1/8" inside dimensions with 1/2" triple-lock gate opening. Includes insert clip for dorsal web and SRL alignment.

5072 alignment clip only.

8447A | Carabiner

Aluminum



8" x 3 3/4" inside dimensions with 2" gate opening.

DuraTech®

DuraTech® SRLs deliver proven performance for reliability that mobile users depend on every day and the reduced activation and arresting distances deliver lower minimum required fall clearances. Built with precision machined aluminum alloy drums and housings, dual internal inertial brake discs, brass pawls, lightweight manganese ratchet centers and aluminum main shafts, DuraTech SRLs are available with galvanized and stainless steel lifeline options in a variety of lengths to fit most all overhead and leading edge fall arrest applications.

7265CLE | DuraTech® 60' LE Cable SRL



Galvanized

DuraTech® Leading Edge SRLs are designed for both overhead and below D-ring anchorage applications featuring an integrated external energy absorber to enhance the internal braking system and preserve lifeline integrity and, a rugged 7/32" galvanized steel cable to resist cuts over sharp and abrasive leading edges. Equipped with a Recoil Spring hand-grip assembly to help prevent lifeline lock-up and provide simple dorsal connection plus, a load-indicating swivel snap hook to provide visual fall event indication and help prevent lifeline twisting. The side-payout housing design produces smooth operation and reduces nuisance lock-up and comes outfitted with an extra large steel anchorage carabiner.

Part #	Length
7226CLE	15'
7227CLE	20'
7232CLE	30'
7265CLE	60'



7268C | DuraTech® 50' Cable SRL

Galvanized

Our improved DuraTech® C-series SRLs also feature the new side-payout housing for uniform operation and reduced wear on the orifice and provides a stackable design for easy storage. Furnished with an internal braking system that delivers positive deceleration, durable 3/16" galvanized steel cable lifeline with load-indicating swivel snap and our Recoil Spring hand-grip assembly helps prevent accidental user lock-up.

Part #	Length
7226C	15'
7227C	20'
7229C	25'
7232C	30'
7268C	50'
7265C	60'

DuraTech® Mini

72706TB3 | DuraTech® Mini 6' SRL

Twin-leg, Steel

Tie-off up to 5' below D-ring
Transverse Load rated rebar hooks



72706TH5 | DuraTech® Mini 6' SRL

Twin-leg, Aluminum

Tie-off up to 5' below D-ring
Transverse Load rated rebar hooks



82710SC1 | DuraTech®10' Web SRL

Single-leg, Steel

727650LE | Contractor 50' LE Cable SRL

Galvanized



Contractor Leading Edge SRLs are designed for both below D-ring and overhead applications featuring an integrated external energy absorber to enhance the internal braking system and preserve lifeline integrity and a rugged 7/32" galvanized steel cable to resist cuts over sharp and abrasive leading edges. Outfitted with a Recoil Spring hand-grip assembly to help prevent lifeline lock-up and provide simple dorsal D-ring connection plus a load-indicating swivel snap hook that provides visual fall event indication and helps prevent lifeline twisting. Contractor Leading Edge SRLs are equipped with a glass-filled nylon housing and anchorage carabiner.

Part #	Length
727620LE	20'
727630LE	30'
727650LE	50'

727650 | Contractor 50' Cable SRL

Galvanized



FallTech® Contractor SRLs support economical solutions for everyday overhead fall arrest applications in construction, maintenance, petro-chem and general industry. All Contractor series SRLs feature 3/16" galvanized steel cable with load-indicating swivel snap hook, Recoil Spring hand-grip, glass-filled nylon housing and anchorage carabiner.

Part #	Length
727620	20'
727630	30'
727650	50'
7276100	100'

6814150K | Rescue and Descent Kit

Self and Assisted Rescue



Rescue and Descent Kits include: UniDrive device, 150' or 300' lifeline, 3 aluminum carabiners, telescoping ratchet lifting handle, drill adapter, 6' pass-through choker sling anchor and 28" weather resistant backpack storage bag.

Part #	Length	Package
6814150K	150'	Standard Rescue and Descent Kit
6814300K	300'	

6050428WR | 5pc. Davit System

60' Winch and SRL-R



Portable system features offset davit arm, 3pc. base and 33" lower mast extension. Offset davit arm adjusts from 12" to 29" and base width adjusts from 38" to 65". Includes 60' 3-way SRL-R and Personnel Winch with galvanized steel cable. Also includes mast-mounted device receiver brackets for FallTech® devices.

7509 | 8' Tripod / SRL-R and Winch

Aluminum



Features 60' galvanized cable SRL-R and Personnel Winch, includes tripod storage bag plus storage bag and leg bracket for each device. Also available with stainless steel cable. (see table for all 8' Tripod kit configurations).

7509S: Kit with Stainless Steel cable.

7281 | 60' SRL-R

Tripod Mount



Dual-function SRL-R with 10' per minute raising/lowering speed, 3/16" galvanized steel cable lifeline with load-indicating swivel snap hook, aluminum housing and internal drum and steel gears, integral mounting bracket for attachment to tripod leg receiver bracket and includes 20" storage bag.

7281S: 60' stainless steel cable.

7297 | 60' Winch

Personnel



Manually operated Personnel Winch for confined space entry and retrieval, with 3/16" galvanized steel cable lifeline with swivel snap hook, secondary braking system for redundancy, 5:1 gear ratio mechanical advantage with 12' per minute average lifting speed, integral mounting bracket for attachment to tripod and davit mast receiver brackets, folding handle for easy storage and includes 20" storage bag. Meets ANSI Z359.4-2013

7297S: 60' stainless steel cable.

7298: 120' galvanized cable.

7298S: 120' stainless steel cable.

LB LEVER HOIST — SPECIFICATIONS & DIMENSIONS

Cap. (Tons)	Product Code	Headroom C (in)	Std. Lift (ft)	Pull to Lift Load* (lbs)	a (in)	b (in)	D* (in)	e (in)	f (in)	g (in)	Load Chain Diameter (mm) x Chain Fall Lines	Net Weight (lbs)	Shipping Weight Approx. (lbs)	Weight for Additional One Foot of Lift (lbs)
3/4	LB008	11.0	5	54 (36)	5.7	4.7	9.6 (14.4)	3.8	1.6	0.9	5.6 x 1	13	13	0.5
1	LB010	11.8		72 (46)								13	14	
1 1/2	LB015	13.2		64 (45)	6.3	5.0	10.4 (14.4)	3.9	1.5	1.3	7.1 x 1	18	18	0.7
2	LB020	14.8		59 (42)	6.8	5.9						4.0	1.8	
2 3/4	LB028			81 (57)			6.3	7.5	16.3 (16.9)	4.4	2.0			10.0 x 2
3	LB030	15.6		69	7.5	8.5						4.4	2.3	
6	LB060	21.3		72			12.0	4.1	2.9	10.0 x 3	88			93
9	LB090	26.8		78										

*Figures in parentheses are for hoists with the optional load limit warning handle.

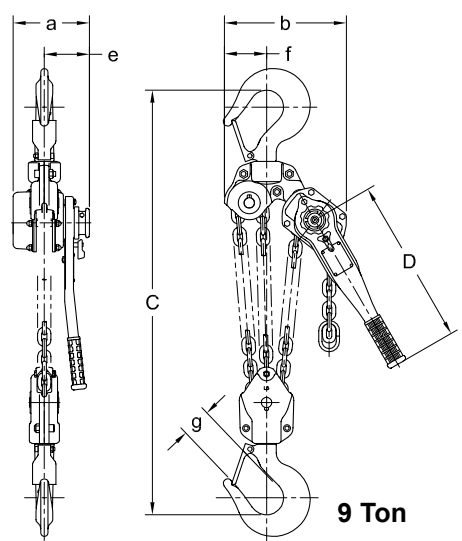
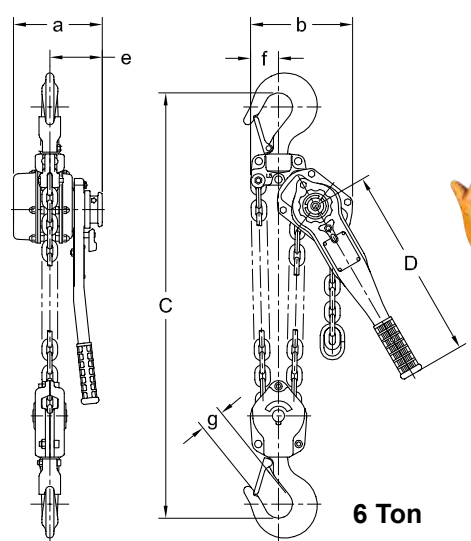
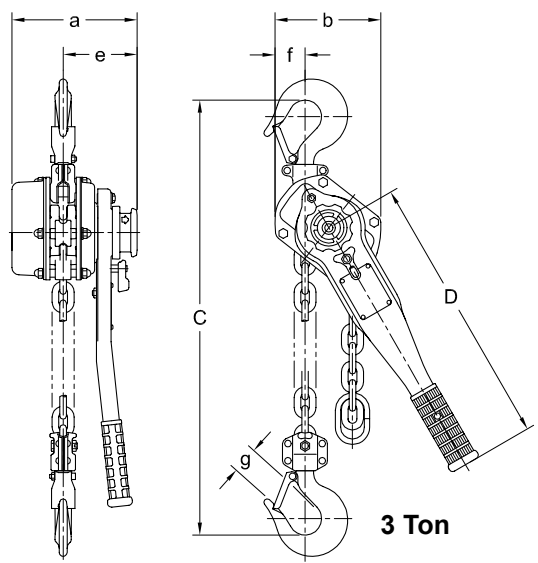
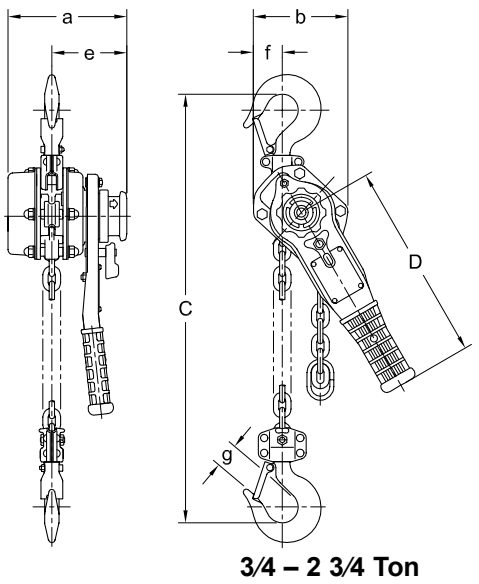

CB Hand Chain Hoist

1/2 through 100 Ton capacity

Harrington CB hand chain hoists combine a rugged exterior shell with machined interior components to handle your most demanding lifting operations. An efficient drive train minimizes manual effort, while double enclosed brake cover, standard slip clutch, and double pawl springs enhance performance and reliability.

Many Benefits from More Features:

- Experience exceptional durability thanks to all-steel construction featuring rugged gear case enclosure and handwheel cover.
- Enjoy increased lifting height thanks to low headroom.
- Compact design results in lightweight and easy portability.
- Minimize manual effort thanks to efficient drive train.
- Standard slip clutch device prevents the hoist from being used to lift damaging loads beyond rated capacity.
- Double pawl springs provide redundancy for reliable operation of brake mechanism.
- Get reliable braking with double enclosed brake cover that keeps out dust, rain, and dirt.

Capabilities to Count On:

- 8-foot standard lift (12-foot for 10 Ton and greater), nonstandard lifts and hand chain drops are also available.
- Grade 100 heat-treated manganese alloy load chain resists abrasion and wear while minimizing chain weight.
- Forged and heat-treated alloy steel hooks are designed to open slowly, without fracturing under excessive loads.
- Test certificate verifies that every hoist has been factory load tested to 125% of rated capacity, in accordance with ASME B30.16 requirements.



CB HAND CHAIN HOIST — SPECIFICATIONS

Cap. (Tons)	Product Code	Headroom C (in)	Std. Lift (ft)	Pull to Lift Load (lbs)	Overhaul Ratio	Load Chain Dia. (mm) x Chain Fall Lines	Net Weight (lbs)	Shipping Weight Approx. (lbs)	Weight for Additional One Foot of Lift (lbs)
1/2	CB005	11.2	8	48	25	5.0 x 1	22	23	1.0
1	CB010	11.6		58	43	6.3 x 1	25	26	1.2
1 1/2	CB015	13.8		70	57	7.1 x 1	32	33	1.4
2	CB020	14.8		72	70	8.0 x 1	41	43	1.6
2 1/2	CB025	16.5		66	99	9.0 x 1	56	58	1.8
3	CB030	20.1		72	114	7.1 x 2	49	53	2.1
5	CB050	23.6		68	198	9.0 x 2	85	89	3.0
8	CB080	30.3		75	297	9.0 x 3	124	131	4.2
10	CB100	29.9	12	72	396	9.0 x 4	186	203	5.5
15	CB150	40.2		74	594	9.0 x 6	346	368	7.9
20	CB200	46.5		72 x 2	396 x 2	9.0 x 8	524	678	10.9
30	CB300	51.2		86 x 2	495 x 2	9.0 x 10	690	889	13.3
40	CB400	58.3			693 x 2	9.0 x 14	1068	1398	18.2
50	CB500	61.4		98 x 2	792 x 2	9.0 x 16	1422	1752	20.6
80	CB800	100.8		86 x 4	693 x 4	9.0 x 28	3392	—	36.3
100	CB1000	125.2		98 x 4	792 x 4	9.0 x 32	6525	—	41.2

Please Note: Special lengths of load and hand chain available upon request. Weights are approximate.

Alloy Snatch Blocks

4 Ton to 20 Ton Working Load Limit



MODEL SHOWN: 8" 15T

Plate Sided Series

- Forged alloy hooks and shackles heat treated for toughness
- Interchangeable hook and shackle connector options
- Available with bronze bushing, composite bushing or roller bearing
- Captured attaching pin allows convenient reeving while block is suspended
- Larger sheaves and WLL available upon request
- ASTM B30.26 Compliant

MODEL #	SHEAVE DIAMETER	BEARING	TAILBOARD D	SWIVEL HOOK#	SWIVEL SHACKLE/EYE PART #	WIRE ROPE MIN	WIRE ROPE MAX	WLL (TONS)	TAILBOARD WEIGHT	SWIVEL HOOK WEIGHT	SWIVEL SHACKLE WEIGHT	SHEAVE #
4"4T	4"	BB	1000135	1000136	1000137	3/8	1/2	4.00	6.30	8.30	9.35	571901
6"8T	6"	BB	1000141	1000142	1000143	5/8	3/4	8.00	15.75	27.15	23.40	1003066
8"8T	8"	BB	1000144	1000145	1000146	5/8	3/4	8.00	23.60	34.60	31.05	1002924
8"15T	8"	BB	1000187	1000700	1000703	3/4	7/8	15.00	29.50	55.85	49.85	1000246
8"20T	8"	BB	1000710	1000711	1000712	1	1-1/8	20.00	51.85	99.55	88.00	1000722
10"8T	10"	BB	1000150	1000151	1000152	5/8	3/4	8.00	35.25	46.80	42.90	1003103
10"15T	10"	BB	1000340	1000341	1000342	3/4	7/8	15.00	38.45	65.00	60.35	1003115
10"20T	10"	BB	1000807	1000808	1000809	1	1-1/8	20.00	69.85	120.00	106.00	1003129

- Tailboard does not include captured attaching pin.
- Please specify Part Number, Sheave Size, Working Load Limit(WLL), Bearing Style and Attaching Style when ordering.
- Ultimate load is four times the WLL.
- Ton equals 2,000lbs.

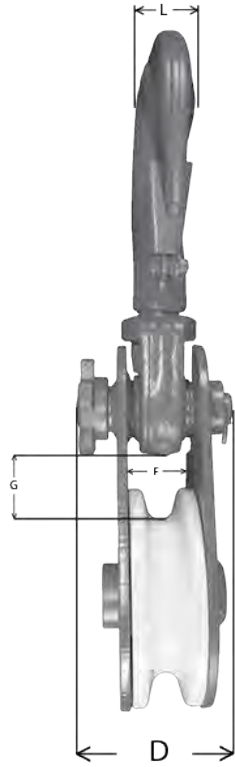
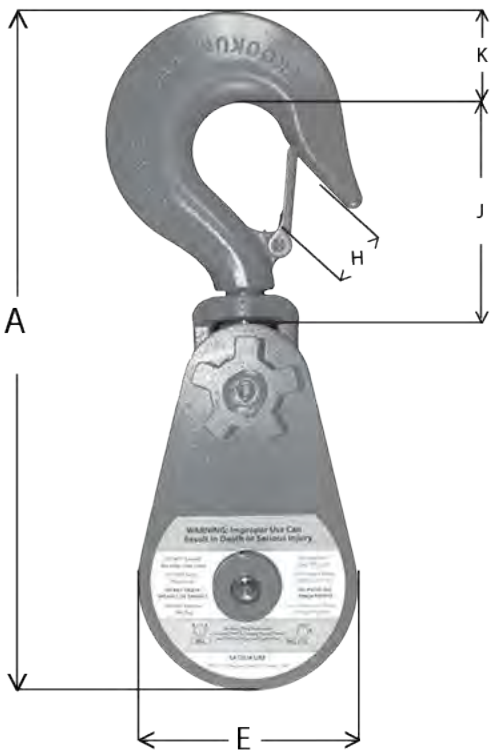

OVERALL HOOK HEIGHT	OVERALL SHACKLE HEIGHT	OVERALL TAILBOARD HEIGHT	OVERALL THICKNESS	OVERALL WIDTH	INSIDE THROAT WIDTH	THROAT WIDTH	HOOK OPENING	HOOK HEIGHT	HOOK TOP HEIGHT	HOOK TOP THICK	SHACKLE HEIGHT
A	NOT SHOWN	NOT SHOWN	D	E	F	G	H	J	K	L	NOT SHOWN
13.6	12.75	6.91	3.3	4.06	1.5	1	1.35	5.2	1.5	1.13	5.22
18.65	16.46	9.94	4.25	6	1.91	1.21	1.7	6.33	2.38	1.5	5.65
20.65	18.46	11.94	4.25	8	1.91	1.21	1.7	6.33	2.38	1.5	5.65
23.85	23.13	12.5	4.43	8.25	1.97	1.13	2.77	8.71	2.64	2.02	9.38
26.73	25.69	13.81	6.19	8.13	2.56	1.26	3.51	9.75	3.15	2.52	10.38
22.65	20.46	13.94	4.25	10	1.91	1.21	1.7	6.33	2.38	1.5	5.65
25.85	25.13	14.5	4.43	10.25	1.97	1.13	2.77	8.71	2.64	2.02	9.38
28.73	27.69	15.81	6.19	10.13	2.56	1.26	3.51	9.75	3.15	2.52	10.38

Half-Sided Blocks

8 Ton to 17.5 Ton Working Load Limit



MODEL SHOWN: T-10S

T Series

- Work hardening manganese steel sheaves maximize wire rope and sheave life
- Recessed sheave prevents wire rope from binding between sheave and block side
- Half side for light weight or full side design to maximize sheave protection
- Versatile draw pin design allows for rapid reeving and exchange of attaching style
- Rugged cast alloy steel sides for demanding environments
- ASTM B30.26 Compliant

MODEL #	SHEAVE DIAMETER	BEARING	REGULAR YOKE PART #	SWIVEL HOOK PART #	SWIVEL SHACKLE PART #	WIRE ROPE MIN	WIRE ROPE MAX	WLL (TONS)	REGULAR YOKE WEIGHT	SWIVEL HOOK WEIGHT	SWIVEL SHACKLE WEIGHT	SHEAVE #	DRAW PIN
T-8	8"	TRB	557903	557901	557902	1/2	5/8	8.00	32.00	36.00	37.25	539103	551420
T-10S	10"	TRB	558003	558001	558002	5/8	3/4	8.00	52.00	56.00	57.25	539903	551420
1010	10"	TRB	553703	—	553702	7/8	1	17.50	75.00	—	87.00	537903	555501
510	10"	BB	565003	—	565002	7/8	1	17.50	70.00	—	82.00	574301	555501
512	12"	BB	565103	—	565102	7/8	1	17.50	80.00	—	97.95	574501	555501

- Please specify Part Number, Sheave Size, Working Load Limit (WLL), Bearing Style and Attaching Style when ordering.
- Ultimate load for swivel attachments is four times the WLL.
- Ultimate load for yoke attachments is five times WLL.
- Ton equals 2,000 lbs.

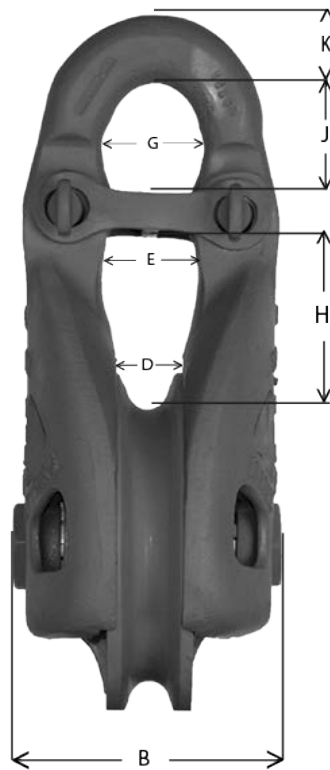
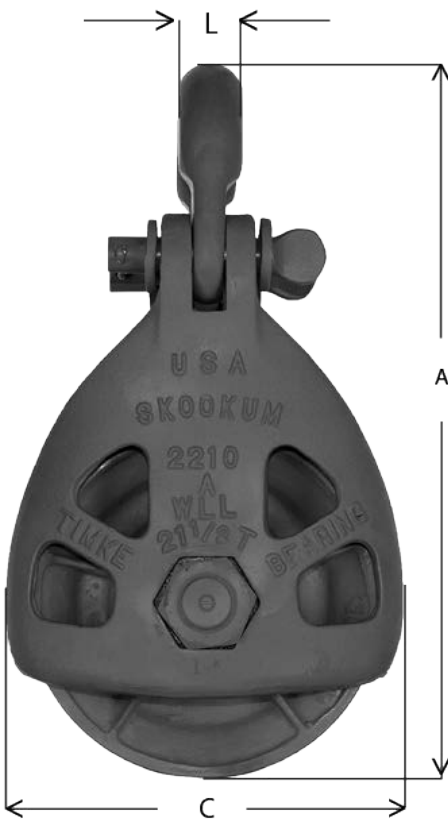

HEIGHT	THICKNESS	WIDTH	THROAT BOTTOM	INSIDE THROAT WIDTH	INSIDE YOKE WIDTH	YOKE WIDTH ABOVE	YOKE WIDTH BELOW	THROAT HEIGHT BELOW	THROAT HEIGHT ABOVE	YOKE BAR HEIGHT	YOKE BAR WIDTH
A	B	C	D	E	NOT SHOWN	G	NOT SHOWN	J	K	L	M
16.00	5.50	8.75	1.00	2.00	1.63	1.38	2.00	4.25	2.50	1.38	1.31
18.00	5.50	10.75	1.38	2.25	1.63	1.63	2.25	4.25	2.50	1.50	1.31
19.00	6.25	11.00	2.00	2.50	2.75	2.75	2.50	2.00	2.50	2.00	1.75
19.00	6.25	11.00	2.00	2.50	2.75	2.75	2.50	3.50	2.50	2.00	1.88
22.00	6.25	13.00	2.00	2.50	2.75	2.75	2.50	3.50	2.75	2.00	1.88

Spreader Beams



Model 30 - Fixed Spreader Beams

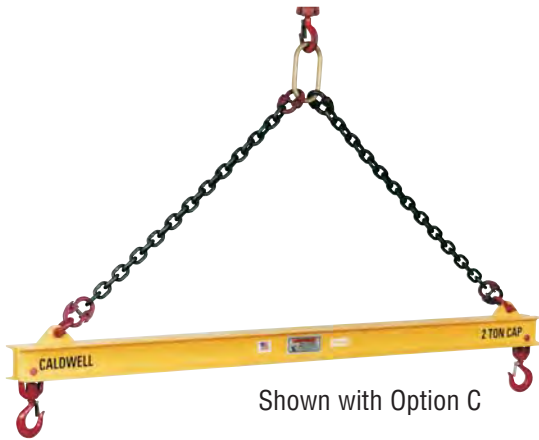

Shown with Option C
Specify Top Rigging

PRODUCT FEATURES:

- Ideal where headroom is not limited.
- Adds stability to lift.
- Available with standard chain or wire rope rigging.
- Available with Adjust-A-Leg® rigging for off center load adjustment (minimum lifting capacity will be approximately 10-15% of beam rating).
- Wide range of additional sizes and capacities available.
- Complies with ASME standards.

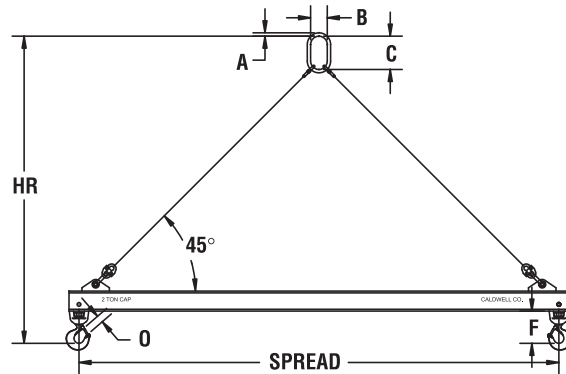

SPECIFICATIONS

Capacity (tons)	Model Number HR Headroom (in.) Weight (lbs.)	Spread (feet)								Other Dimensions (in.)	
		4	6	8	10	12	16	20	24		
2	Model Number	30-2-4	30-2-6	30-2-8	30-2-10	30-2-12	30-2-16	30-2-20	30-2-24	A=1/2	F=4-1/4
	HR Headroom	34	46	58	70	82	106	132	156	B=2-1/2	O=31/32
	Weight	45	60	82	95	115	225	408	445	C=5	
5	Model Number	30-5-4	30-5-6	30-5-8	30-5-10	30-5-12	30-5-16	30-5-20	30-5-24	A=1	F=6
	HR Headroom	37	49	61	73	83	110	134	158	B=3-1/2	O=1-1/16
	Weight	62	78	100	117	168	305	435	661	C=7	
10	Model Number	30-10-4	30-10-6	30-10-8	30-10-10	30-10-12	30-10-16	30-10-20	30-10-24	A=1-1/4	F=8-1/8
	HR Headroom	41	53	64	77	86	113	138	163	B=4-3/8	O=1-1/2
	Weight	100	122	156	180	240	380	532	915	C=8-3/4	
15	Model Number	30-15-4	30-15-6	30-15-8	30-15-10	30-15-12	30-15-16	30-15-20	30-15-24	A=1-1/2	F=9-1/4
	HR Headroom	43	55	65	80	92	116	140	167	B=5-1/4	O=1-3/4
	Weight	126	155	185	242	270	420	665	953	C=10-1/2	
20	Model Number	30-20-4	30-20-6	30-20-8	30-20-10	30-20-12	30-20-16	30-20-20	30-20-24	A=1-3/4	F=9-3/4
	HR Headroom	46	58	69	82	94	118	140	170	B=6	O=2
	Weight	170	200	233	315	350	540	775	1341	C=12	
30	Model Number		30-30-6	30-30-8	30-30-10	30-30-12	30-30-16	30-30-20		A=1-3/4	F=9-3/4
	HR Headroom		60	70	83	95	120	145		B=6	O=2
	Weight		285	402	440	530	888	1390		C=12	
40	Model Number		30-40-6	30-40-8	30-40-10	30-40-12	30-40-16			A=2	F=13
	HR Headroom		65	77	89	102	127			B=7	O=2-3/4
	Weight		563	695	781	1058	1364			C=14	

NOTE: Weight = Beam and hooks only - (no top rigging).

TOP RIGGING OPTIONS

OPTION C

Chain top rigging from beam to crane hook.

OPTION W

Wire rope top rigging from beam to crane hook.

OPTION A

Adjust-A-Leg® sling top rigging for off-center load adjustment.

Spreader Beams

Model 32 - Adjustable Spreader Beams



Shown with Option C

Specify Top Rigging

PRODUCT FEATURES:

- Ideal where headroom is not limited.
- Adds stability to lift.
- Telescopic spread standard.
- Spread adjusts in 1" increments
- available with standard chain or wire rope rigging.
- available with Adjust-A-Leg® rigging for off center load adjustment (minimum lifting capacity will be approximately 10-15% of beam rating).
- Wide range of additional sizes and capacities available
- Complies with ASME standards.

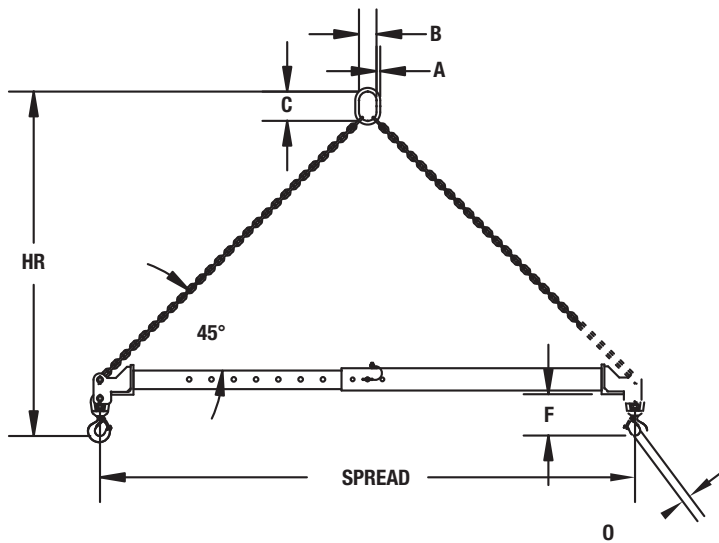

SPECIFICATIONS

Capacity (tons)	Model Number	Spread (ft.) Min./Max.	HR Headroom Min./Max. w/chain (in.)	Weight Beam & Hooks (lbs.)	A Oblong Dia. (in.)	B Oblong Width (in.)	C Oblong Height (in.)	F - Hook To Beam Bottom (in.)	O - Hook Opening w/latch (in.)	Chain Rigging Weight (lbs.)
2	32-2-4/6	4 / 6	48/57	70	1/2	2.36	3.94	5.5	0.97	9
	32-2-6/10	6 / 10	72/88	85						13
	32-2-8/14	8 / 14	96/113	175						17
	32-2-12/20	12 / 20	132/166	245						23
5	32-5-4/6	4 / 6	55/64	105	1	5.38	7.09	8.4	1.41	34
	32-5-6/10	6 / 10	79/95	160						47
	32-5-8/14	8 / 14	102/126	205						61
	32-5-12/20	12 / 20	138/172	670						82
10	32-10-4/6	4 / 6	60/69	130	1-1/4	5.71	10.83	10.6	1.78	49
	32-10-6/10	6 / 10	74/111	175						69
	32-10-8/14	8 / 14	108/132	460						88
	32-10-12/20	12 / 20	144/163	680						118
15	32-15-4/6	4 / 6	64/72	165	1-1/2	5.90	10.5	13.6	2.22	78
	32-15-6/10	6 / 10	87/104	365						111
	32-15-8/14	8 / 14	111/135	478						145
	32-15-12/20	12 / 20	147/180	700						194

TOP RIGGING OPTIONS

OPTION C

Chain top rigging from beam to crane hook with coupler attachment.

OPTION W

Wire rope top rigging from beam to crane hook. WR Lug required for 25-40 TON capacity beams.

CUSTOM SPREADER BEAM END CAP KITS

- Manufactured to exceed all ASME B30.20 and OSHA regulations when assembled to specifications using A53 Grade B Schedule 40 pipe.
- Painted safety yellow for increased visibility.
- **ALL** End Caps shipped with proof load certification paperwork.
- Durable construction ideally suited to jobsite or warehouse use.
- Made in U.S.A.
- Top rigging available - call for details.
- Custom designs available - call for engineering.
- **ALL** lifting equipment individually proof loaded per OSHA requirements.
- Minimum horizontal top rigging angle of 45° - M&W recommends a minimum angle of 60°.

⚠ Prop 65 – See Page 112

End cap kits are designed for use with A53 Grade B, Schedule 40 pipe between the end fittings and must have no weld joint irregularities. This steel pipe is widely available, and also available from M&W. The model 19499 uses a 2-1/2" nominal size pipe, the 19500 uses a 5" nominal size pipe and the 19120 uses an 8" nominal size pipe.

Lengths of pipe between end cap kits must be straight to within +/- 1/8" from each end, and ends of pipe should be cut squarely and cleanly from the centerline of the pipe. Lengths of pipe should be free from any factory defects, irregularities, or damage.

Each end of the length of pipe must have the correct diameter holes drilled through both ends and in proper alignment through both walls of the pipe. The model 19499 uses a Grade 8 hex head cap screw 5/8"-11 with a length of 4-1/2". The model 19500 uses a Grade 8 hex head cap screw 5/8"-11 with a length of 8". The model 19120 uses a Grade 8 hex head cap screw 1"-8 with a length of 11-1/2".



OUTSIDE SPREAD IN FEET / WLL IN POUNDS

Part #	Pipe Size	4'	5'	6'	8	10'	12'	14'	15'	16'	18'	20'	22'	24'	26'	28'	30'	32'	34'	36'	
19499	2 1/2"	15,000	14,000	13,000	11,000	8,000	5,800	4,000	3,000												
19500	5"	34,000	34,000	34,000	34,000	34,000	32,000	30,000	28,000	26,000	24,000	20,000	16,000	14,000	12,000	10,000	9,000				
19120	8"	78,000	78,000	78,000	78,000	78,000	76,000	76,000	72,000	70,000	66,000	62,000	58,000	54,000	50,000	46,000	42,000	38,000	32,000	30,000	

* Minimum horizontal top rigging angle is 45° on all fixed and adjustable spreaders. M&W recommends a minimum horizontal top rigging angle of 60°.



www.maskell-rigging.com

Small Disadvantaged Business (SDB) – sam.gov
Women Business Enterprise (WBE) – sam.gov
Women Owned Small Business (WOSB) – sam.gov
Women Business Enterprise (WBE) – Supplier Clearinghouse

2195 Railroad Street | Corona, CA 92878

(888) 715-RIGG (7444)

