



# FJD FJDZ42P

Autonomous  
Electric Lawn Mower



# Introduction



## Level Up Your Mowing Experience

FJD Vidar, a groundbreaking autonomous electric lawn mower, offers 3 operating modes to bring you maximum flexibility. Based on the RTK positioning system, it can achieve centimeter-level positioning accuracy during path planning to boost your cutting efficiency. It saves costs while delivering superior mowing performance and versatility.

# Application Scenarios



# Application Scenarios



Landscape lawn



Airport Lawn



Race track lawn



Horse race track lawn



# Key Benefits

**50%+**

**Labor cost saving**

---

Operates more than one mower with autonomous mode, eliminating at least 50% labor costs.

**1/10**

**Energy cost\***

---

Cost of electricity is far less than fuel. Mow same size lawn, FJD mower will save 90% energy cost than the gas mower.\*

**Nearly 0**

**Maintenance cost**

---

Electric mower requires less maintenance and investment.

\*Notes: We picked up the energy price of HK area (\$88/ gal & \$1.05/ kWh) and compared the energy cost with a traditional gas mower at the same working condition.

# Key Features



RTK Path  
Planning

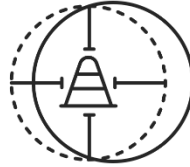

Real-Time Obstacle  
Detection



Breakpoint  
Resumption

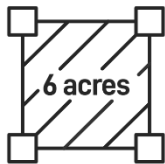

Up to 6 Acres per  
Full-Charge

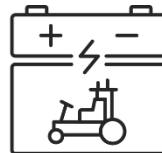

100% Electric  
Control

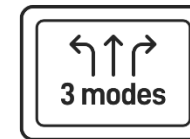

Auto/Manual Mode  
& Remote Control

# Functions

## 3 Operation Modes

### For Your Maximum Flexibility



#### **Autonomous Mode**

Having other tasks to work on?  
Leave them to the autonomous  
mode which is one click away.



#### **Remote Control Mode**

Monitor the mowing status on  
the tablet and keep yourself  
away from heat, noise, and dust.



#### **Manual Mode**

With the advanced touchscreen,  
the mower makes it easy to  
adjust ground speed, deck height  
and blade speed.





# Functions

## Autonomous Mowing Experience

Thanks to the FJD RTK positioning system, Vidar sets up a virtual boundary and creates a map with centimeter-level accuracy. It provides selective paths to avoid overlaps and minimize skips, which significantly improves cutting efficiency.

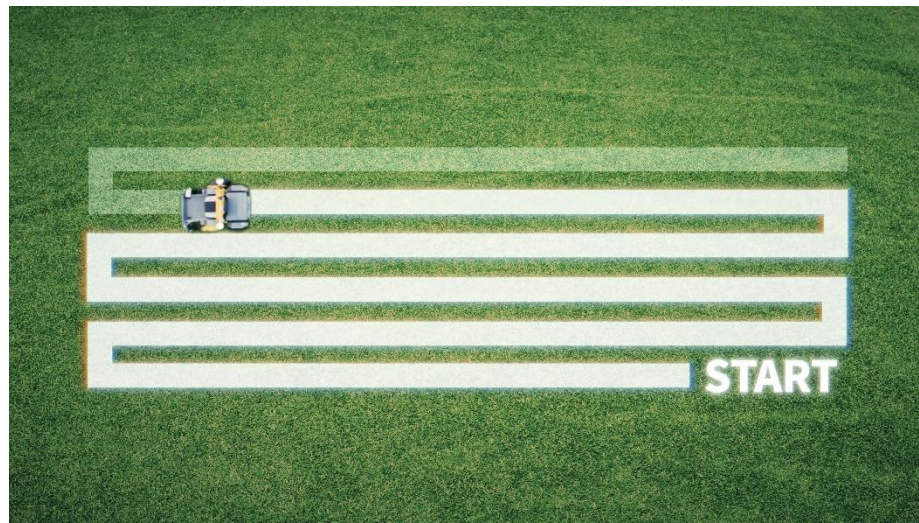

### ✦ RTK Path Planning

Generates a zigzag or spiral path with centimeter-level precision.

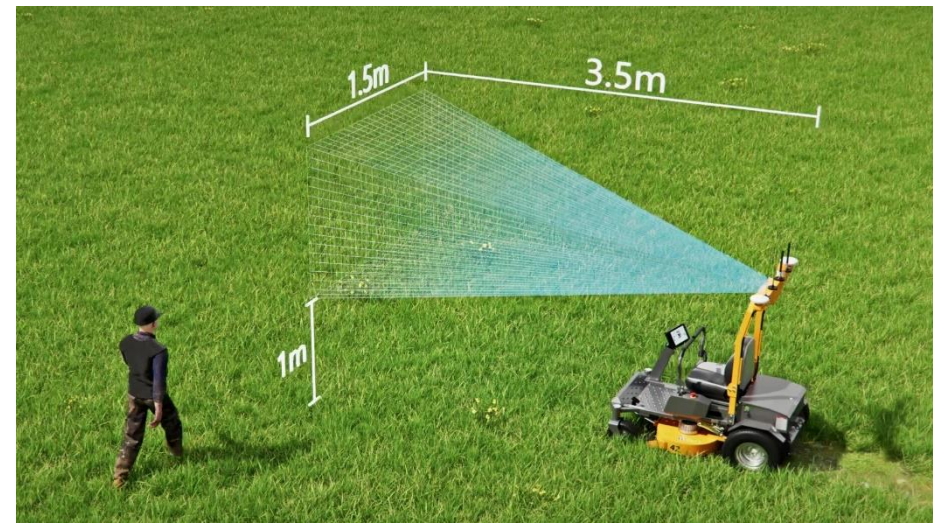

### ✦ Real-Time Obstacle Detection

The vision-based sensor detects obstructions over 1-meter in height within a 3.5-meter distance.



# Functions

## - Auto Mode

Manually mark points and no-go zones and switch to the auto mode. Then, the mower automatically plans the path and starts working.

# Work Flow

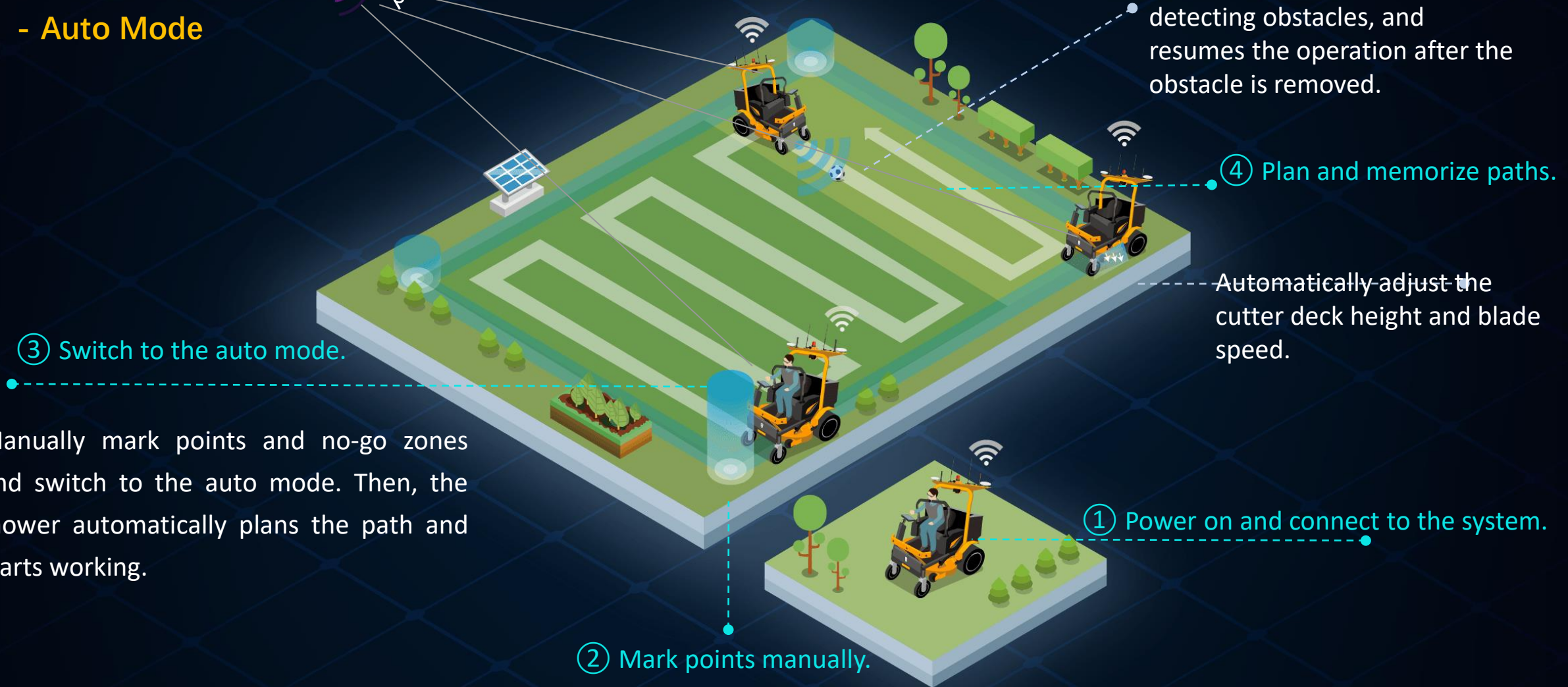
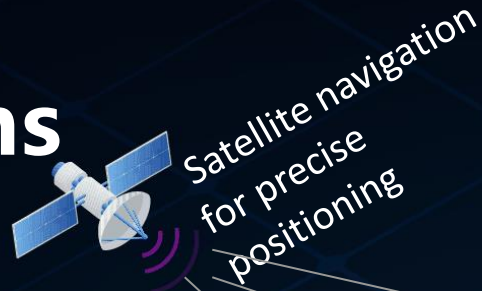

③ Switch to the auto mode.

② Mark points manually.

① Power on and connect to the system.

④ Plan and memorize paths.

The obstacle avoidance system automatically stops the mower and gives an alarm when detecting obstacles, and resumes the operation after the obstacle is removed.

Automatically adjust the cutter deck height and blade speed.

# Functions



## Mow Whenever You Want

With RTK technology and autonomous operation system, FJD mower could operate automatically at some dark or invisible situations like fog, cloudy, even at the dark night.

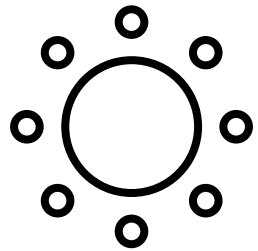

**Day**



**Night**



**Fog**



**Windy**



**Little rain**

# Functions



## All For Safety

### Indicator light

Lights up as a reminder at work.

### Hand brake

Pushes the levers to the sides to stop the mower.

### Foot brake

Stops the mower immediately in emergencies.



### Gravity sensing seat

Triggers the brake within 2 seconds when the operator leaves the seat.

### Emergency stop button

Stops the mower immediately with one push.



# Functions

## 100% Electric Control

### Durability

Covers up to 6 acres per full charge.

### Removable batteries

Extra batteries and chargers available for extended mowing hours.

### Ground ability

Climbs up to 20° slope and park on 16.7° slope.

### Electric deck adjustment

Adjusts the cutting height through the tablet effortlessly instead of manual adjustment.





# Functions

## Flexible Range Choices

### STANDARD

Contains:

Mower x 1;

Charger x 1;

Battery set x 1;

**Charging time**

7.5H (220V)

9H (110V)

**Continuously working time**

2.5~3H



### FAST CHARGE

Contains:

Mower x 1;

Charger x 3;

Battery set x 1;

**Charging time**

2.5H (220V)

3H (110V)

**Continuously working time**

2.5~3H

Each charger charges one battery for saving time

**>5H**

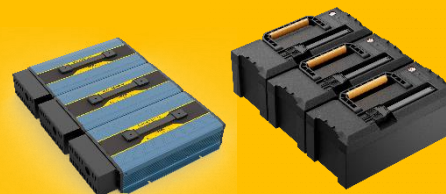

### LONG RANGE

Contains:

Mower x 1;

Charger x 3;

Battery set x 2;

**Charging time**

2.5H (220V)

3H (110V)

**Continuously working time**

A whole day

**24H**

Charge one battery set when another set is being used for mowing at the same time.



# Core Components



Dimension (L * W * H)	5.36 * 4.28 * 7.46 (ft)
	1635 * 1305 * 2273 (mm)
Weight	738 lb ± 22 lb (335 ± 10 kg)
Deck Cutting Width	42" (107 cm)
Number of Blades	2
Cutting Height	1.2"–5.0" (30–127 mm)
Working Area ( Per Full Charge )	6 acres (24,281 m <sup>2</sup> )
Battery Capacity	6.79 kWh
Ground Speed	7.46 mph (12 km/h) max
Ground Capability	Gradeability:20° ; Parking:16.7°
Max Distance of Remote Control	2,624 ft (800 m)
Operation Modes	Manual , Remote Control , Autonomous
RTK Frequency	GPS L1/L2 ; BDS B1/B2/B3 ; Galileo E1/E2/E5a/E5b ; Glonass L1/L2
Certifications	CE/FCC/SGS-NorthAmerica



# Accessories



**RTK Base Station**



**Mulching kit**



**Leaf & Lawn Vacuum Attachment**  
(Coming Soon! )

# New Accessories Coming Soon!



**Snow Blade**



**Snow Blower**



**Snow Sweeper**



# New Features Coming Soon!



FJD 3D LiDAR Scanner



FJD Lawn Mower

To build a 3D map

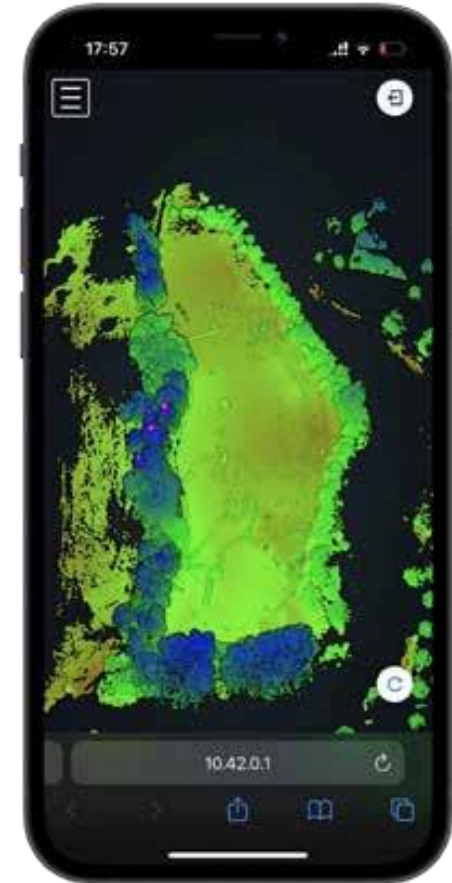

# New Features Coming Soon!



Autonomous Lawnmower Formation  
Upgrade Mowing Efficiency

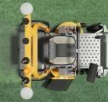
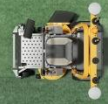



**CREATE FOR  
A BETTER WORLD**

