

Quick Start Guide

myFC PowerTrekK 2.0

Read before use



Welcome to the world of Independence!

We hope you will enjoy using your myFC PowerTrek 2.0 Charger! In this guide, the myFC PowerTrek 2.0 Charger is simply called the Charger.

The Charger is a portable, self-contained charger that uses Fuel cell technology and an internal battery to charge devices.

The Fuel cell produces electrical power using hydrogen created with a combination of ordinary water and a special salt held in a container, the myFC Puck.

The Charger can power a device via the Fuel cell and with the built-in battery pack, or charge the battery via the Fuel cell.

This guide provides the basic information you need to start charging your devices with the myFC PowerTrek 2.0.

Go to www.powertrek.com for more detailed information including FAQ and instruction videos.

Read this first

Follow the instructions for first-time use on page 6–7

The first time you use the Charger, you must follow the specific start-up procedures described on page 6–7. After that, the instructions on pages 8 through 11 explain how you use your Charger on a regular basis. Also make sure to have read pages 12 through 15 that contain important information.

Never use a myFC Puck more than once

NEVER try to use a myFC Puck more than once. Even if you think that it is not fully depleted, do not try this.

Don't remove Puck before it is depleted

Once the myFC Puck is started, DO NOT remove the Puck before the Puck is depleted and the Charger has been turned off.

Contents of the box

Inside the box you will find the following items:

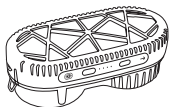

myFC POWERTREKK™ 2.0



myFC Puck
(selected markets only)

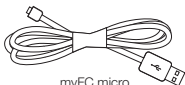

myFC micro
USB cable



Quick
Start Guide



Storage
Tube

Overview of the Charger

Before you start to use your Charger, familiarize yourself with all its components.

myFC PowerTrekk Charger

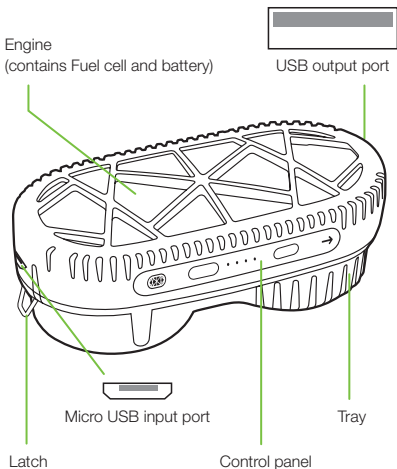

Overview of the Charger

Control panel

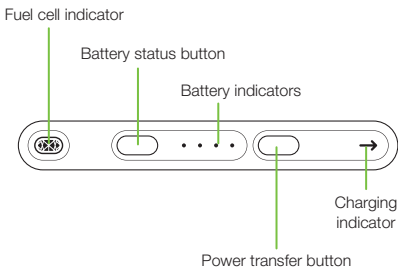

Tray

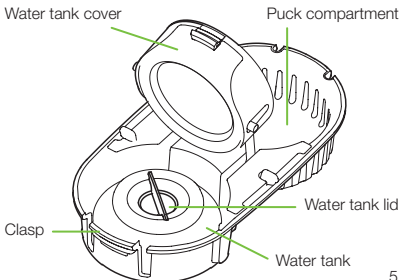

IMPORTANT – First time use

Start-up procedure for the Charger

The first time you use the Charger (or if it has dried out*), you must follow these procedures to achieve optimal performance. After that, for everyday use, follow the procedures on pages 8, 9, 10 & 11.

1) Warm up the Charger

When the Charger is new it needs to be warmed up in order to reach its full potential. Do this:

- A. Follow the procedure “How to start the Fuel cell” on page 8–9.
- B. Let the Charger run on the first myFC Puck until the Fuel cell indicator turns off or for at least two hours. If the Fuel cell indicator is blinking, do not connect a device to the Charger, since device charging is not available during this state.
- C. After the step above – remove the Puck and wait 30 seconds.
- D. If the Fuel cell indicator is blinking during the two hours with the first Puck – repeat the procedure and insert a new myFC Puck. Run the Charger again until the Fuel cell indicator turns off or for at least two hours.
- E. When the Fuel cell indicator starts showing a solid green light – you can start charging your device.

*All Fuel cells are sensitive to dehydration. This can happen if unused for quite some time or if you have not stored it in the Storage tube. If dried out, the Charger may take some time before it starts, and/or the Fuel cell indicator may blink. If this happens repeat the procedure on this page, “Warm up the charger”.

IMPORTANT – First time use

2) Charge the battery

The Charger uses the battery to support the Fuel cell in situations where a high power output is requested. If the battery runs low (one red LED on the Battery Indicators) the Fuel cell will start charging the battery. During this time you can charge your device manually by pressing the Power transfer button. When battery level reaches 25% the Fuel Cell will automatically start charging any connected device. Even if the four Battery indicators are solid green after the procedure above (1 A–E), this indicates that the battery is charged to between 75 and 100%.

It is therefore a good idea to fully charge the battery from an external power source before using the Fuel cell. Follow the procedure “How to charge the battery from an external power source” on page 11 to charge the battery. Now the Charger is ready for everyday use.

Everyday use

How to start the Fuel cell

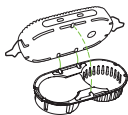

1. Separate the Engine (the green top part) from the tray unit by snapping the latches open.



2. Release the Clasp to open the Water Tank Cover.



3. Open the tank by gently rotating the Water tank lid 1/4 of a turn counter-clockwise.



4. Fill the Water tank completely with ordinary water that is free from particles. It needs a tablespoonful, so be careful to not spill out any water. There is no risk of overfilling the water tank.

Everyday use



5. Very gently replace the lid, without squeezing the Water tank, and carefully rotate it 1/4 of a turn clockwise until it stops. Try not to spill any water – the Fuel cell needs it all.



6. Close the water tank cover and snap it into place.



7. Insert a myFC Puck into the Puck compartment with the seal upwards, then remove the seal.

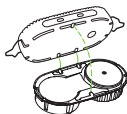

8. Fit the Engine on top of the tray unit – it only fits in one direction, and close the latches securely. The Charger will normally start to generate power within 60 seconds.

Everyday use

How to use the Fuel cell to charge a device

1. Follow the procedure “How to start the Fuel cell”, see pages 8–9.
2. Connect your device to the Charger using the cable supplied with the device. If you disconnect the cable, or when your device becomes fully charged the Fuel cell will reroute the power to the battery after 30 seconds.

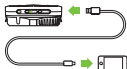

You can at any time switch the output from the Fuel cell to the battery or to a connected device using the Power transfer button.

How to use the Fuel cell to charge the battery

1. Follow the procedure “How to start the Fuel cell”, see pages 8–9.
2. The Charger will start powering the battery after 30 seconds, so you don't need to do anything more.



How to use the battery to charge a device

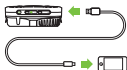

1. Connect your device to the USB output port using the cable supplied with the device.
2. Press the Power Transfer Button to start or stop charging your device. If you disconnect your device, the Charger will stop after 30 seconds.



Everyday use

How to charge the battery from an external power source

1. Connect the Charger to an external power source (e.g. your computer or a power socket with adapter) using the supplied USB cable plugged into the micro USB-B Input port.

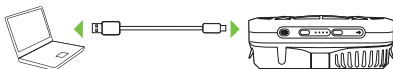

Charging will start automatically and progress will be indicated by the Battery indicators.

2. Once the Battery is fully charged (4–6 hours) charging will stop automatically and the Battery indicators will switch off.



The Charger battery cannot be charged below 0°C (32°F) or above 55°C (130°F).

Everyday use

Tips and hints

Charging a device

- Most smart phones charge faster if you put them into Flight mode.
- Keep the Charger well-ventilated (the Charger needs oxygen) and fairly flat when using the Fuel cell to charge a device or the battery.
- When the Charger is charging a device using the Fuel cell, a slight smell close to the Charger can occur and is absolutely harmless.
- Be aware that the myFC Puck can be hot immediately after use.
- The Charger Fuel cell works best between 5–35°C (41–95°F). It will work at lower or higher temperatures, just not as efficiently.

Storage

- Always remove the myFC Puck from the Charger when you're not using it.
- Always store your Charger in the Storage tube provided or any re-sealable bag approved for food. If the Charger dries out, you will have to use at least one myFC Puck to get it started next time, see page 6–7. Make sure the tube or bag is sealed shut.
- DO NOT store the Charger or myFC Pucks in temperatures above 50°C (122°F), or in direct sunlight.

Everyday use

Alarm

The Charger has a built in alarm for non-optimal Fuel cell operation. If the Fuel cell indicator flashes red, don't panic, the alarm has been triggered by one of the following reasons:

- Temperature of the Charger battery is too high, re-locate the Charger to a cooler spot, and the alarm will stop.
- The Charger battery is fully charged, connect a device to charge, and the alarm will stop.
- The Charger Fuel cell may have dried out, let the charger be and let it recover.

Battery Health

In order to prolong the Charger Battery lifetime:

- Device charging is only possible between -18°C (0°F) and 55°C (130°F)
- Battery charging is only possible between 0°C (32°F) and 55°C (130°F)

Recycling

The Charger should be recycled as electronic waste according to local regulations.

Further information

Find further information on our website at "www.powertrekk.com".

If you have questions regarding your Charger, please contact us at "support@powertrekk.com"

Health and Safety information

ALWAYS OBSERVE THESE HEALTH and SAFETY RULES!

Rules for personal safety

- Be careful when handling the myFC Puck as it may be hot. If the Fuel cell indicator has turned off you may remove the myFC Puck. Remove the myFC Puck by separating the Engine from the tray, then gently shaking the tray upside down until the myFC Puck drops out. Then let it cool.
- Never remove the myFC Puck before the Fuel cell indicator has been turned off. If the myFC Puck was accidentally removed (for example the Charger was dropped) insert the myFC Puck again without refilling the water tank, but be careful as it may be hot.
- Avoid contact with the contents of a myFC Puck. The contents are water-reactive, corrosive, toxic and flammable. In case of ingestion or contact with the eyes, seek immediate medical attention.
- If a myFC Puck is leaking, NEVER put your face near it or touch it with your bare hands.
- NEVER attempt to refill or pierce a myFC Puck. Any such attempts may crack or break it and release its contents.
- If any of the powder from inside a myFC Puck gets onto bare skin, immediately brush it off with a dry cloth or brush. DO NOT use water directly. Only when all the powder is removed can the skin be rinsed with water.
- DO NOT disassemble any part of the Charger as this can disturb normal operations and result in hazardous leakage

Health and Safety information

Rules for safe handling of the Charger

- Use only myFC Pucks in the Charger.
- NEVER restart the Charger using the same myFC Puck, even if it is only partially used. Re-using a myFC Puck can cause overheating of the Puck, leakage of content and irreversible damage to your Charger.
- NEVER try to use a myFC Puck more than once. Even if you think that it is not fully depleted, do not try this. It might cause the myFC Puck to crack or break and leak out its contents. See the Health warnings on the previous page. May contain flammable gas.
- Keep the Charger and myFC Pucks away from children.
- DO NOT charge the battery in other way than is described in these instructions. Never try to use any other charging method.
- DO NOT keep the myFC Puck in the Charger except when charging and cooling off.
- DO NOT expose the Charger or myFC Pucks to temperatures higher than 50°C (122°F) or to open flames.
- DO NOT expose the Charger or myFC Pucks to shock.
- DO NOT immerse the Charger or myFC Pucks in water or other liquids.
- DO NOT expose the Charger or myFC Puck to acids, oxidizers, alcohol or household cleaning products.



Instruction videos

Please scan the QR code for instruction videos
or go to www.powertrekk.com/support

Further information

Go to www.powertrekk.com

for access to all documentation.

This document may change without prior notice.

The myFC POWERTREKK Charger and the myFC
Puck are compliant with IEC 62282-6-1, -100.

The myFC Puck contains Sodium Silicide and
Sodium Borohydride 5g.

Both the Charger and myFC Pucks are approved for
carry-on in aircraft cabins only.

Designed and approved for
home, office and light industry environment.

Contains 3800 mAh Li-Ion battery.

Max output: 6,5 W (5V DC)

Max input: 5 W (5V DC)