

CATALOG

Battery Pack B01 1-4

Cordless Vacuum Cleaner V22 5-8

Pressure Washer V32 9-13

Tire Inflator V150 14-17

Impact Wrench V 700 18-20

Toxic and harmful substances 21

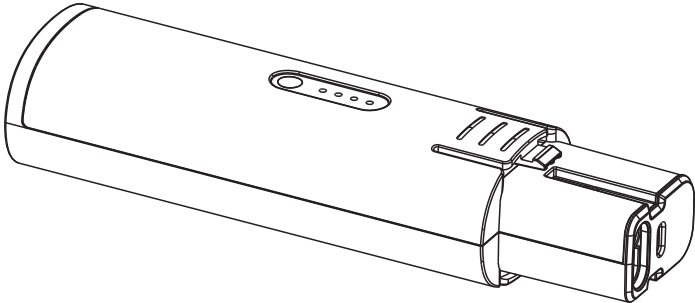

ToolCore B01

Battery Pack Manual

Important information

1. Do NOT open the Battery Pack, it may cause a short circuit
2. Make sure Battery Pack keep away from high temperature. If there is bulging, stop using it immediately
3. This Battery Pack can only be used with original power tools
4. Do NOT charge in dampness or rain
5. The jump-start function of the Battery Pack can only be used for 12V vehicle start
6. DO NOT substitute car batteries for use

Introduction

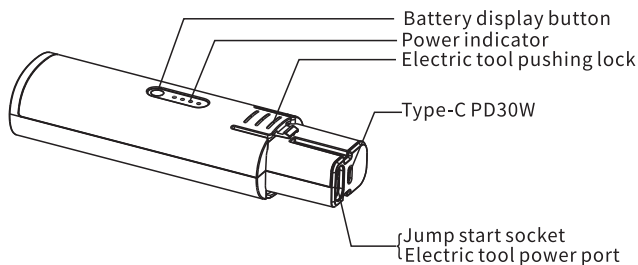

Technical specification

Name	Battery Pack (Standard version)
Model	B01
Weight	0.43kg
Capacity	43Wh
Output	Type-C PD30W, 12V jump start
Input	Type-C PD30W
Peak Current	1500A
Charging temperature	0°C ~45°C
Using temperature	-20°C ~60°C

Operation guidance

Touch the battery display button, it will indicate as follows:

Battery display button	Single indicator flashing	Single long-bright indicator	Two long-bright indicators	Three long-bright indicators	Four long-bright indicators
Battery Pack power	0%	25%	50%	75%	100%

During the process of charging the Battery Pack, the power indicator will flash in cycles. The number of long-bright indicators represents the actual power of the Battery Pack. All four power indicators are off, indicating that the charging is complete.

Charging the Battery Pack

Insert Type-C plug into Battery Pack

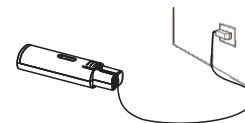

Jump start 12V vehicle instruction:

1. Connect the blue plug fully seated into the Battery Pack.
2. Connect battery clamps to car battery terminals correctly. Red Clamp to the positive(+) battery terminal, Black Clamp to the negative(-) battery terminal.

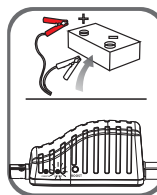
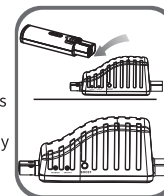

Green light on:

Telling the connection is correct and the circuit is working, you can turn on the engine to jump-start directly.

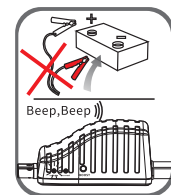

RED light on with buzzing:

Telling the connection is wrong, and buzzing to alarm to correct the clamps as step 2 mentioned above, wait until the green light is on to turn on the engine.

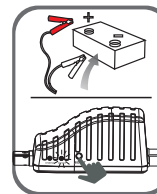

Green light blinking:

saying the vehicle battery is low, press the "BOOST" button, wait green light becomes solid, then turn on the engine within 30s.

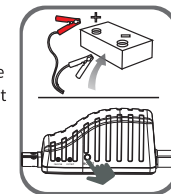

No lights on, no buzzing:

saying the vehicle's battery may be damaged, after confirm the clamps connection is correct, press the "BOOST" button, wait green light is on, and then turn on the engine within 30s.

3. Start the car as usual

4. After the car is started, first unplug the Battery Pack, and then remove the battery clamp from the battery

Charging Cell Phone or Tablet Instruction

1. Plug the switch cable to Battery Pack output port
2. Connect to electronic products such as mobile phones/tablets
3. Tap the battery display button



For power tools

1. Insert the Battery Pack into the power port of the power tool
2. After use, press the locks on both sides of the Battery Pack and pull out

Troubleshooting

Finding	Causes	Remedies
Touch the battery display button, single battery indicator flashes	Insufficient power	Charging Battery Pack

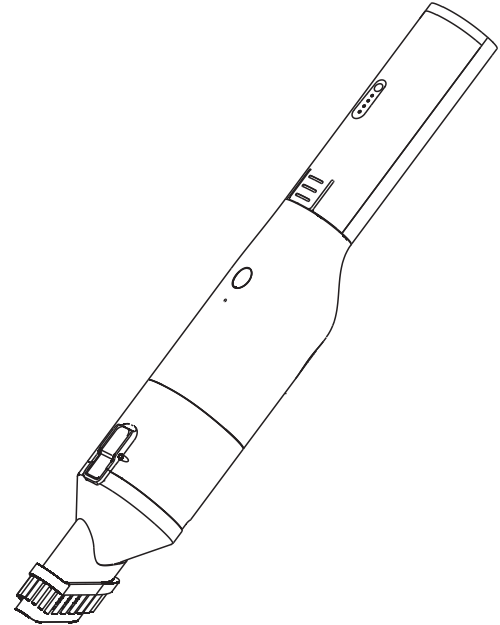

Important information

1. Make sure to keep away from children when using
2. Do NOT aim the suction nozzle at the eyes or ears during use
3. Do NOT immerse the product in water or rinse the host with water

Introduction

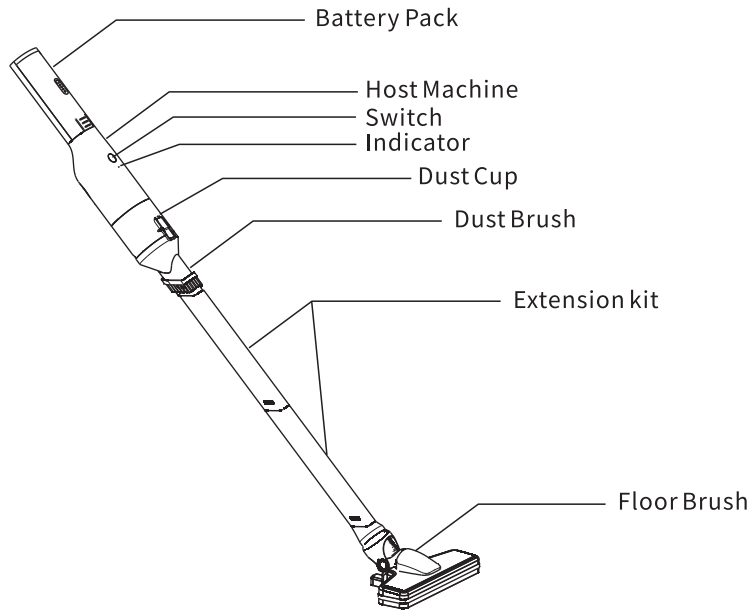

Parts List

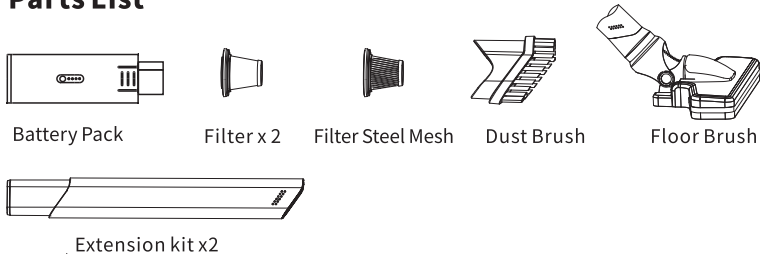

Technical specification

Name	Cordless Vacuum Cleaner
Model	ToolCore V22
Weight	1.2kg
Rated Power	230W
Dust Cup Capacity	0.23L
Suction Power	22kPa(high gear); 12kPa(standard gear)

Installation guidance

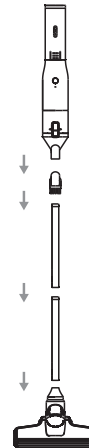

1. Connect the host with the floor brush, press the floor brush buckle into the air inlet of the host, and fix the buckle in the front and back positions. It is done when you hear the “click” sound.
2. Connect the host with the extension kit, the small port of the extension kit is assembled with the air inlet of the host until the connection is completely overlapped.
3. Connect the extension kit with another extension kit, and the large port of the extension kit is assembled with the small port of the other extension kit until the connection is completely overlapped.
4. Connect the extension kit with the floor brush, and the air outlet of the floor brush is assembled with the large opening of the extension kit until the connection is completely overlapped.

Operation guidance

Way of working

1. Long press the switch button for 1s to start, the default low-speed gear, the blue indicator is on
2. After starting, short touch the switch button to switch the working gear
3. In the startup state, press and hold the switch button for 1s to stop working, and the indicator is off

Clean the dust cup

- 1、 Turn off the power after the work is finished
- 2、 Press and hold the dust cup open button, opening the cup cover, and dump the garbage
- 3、 Remove the dust cup and clean the filter
 - a. Rotate the dust cup to the direction where it can be taken out
 - b. Take out the filter for cleaning

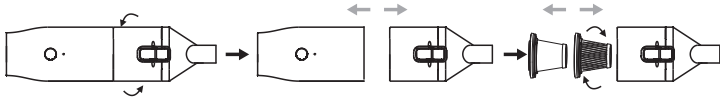
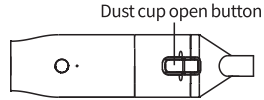

Troubleshooting

Finding	Causes	Remedies
Reduced vacuuming effect	The dust cup is full of dirt	Empty the dirt and clean it
	The filter is full of dirt	Clean or replace the cup
Abnormal noise when working	Inhalation of large particles	Stop using and clean up the debris
	Displacement of internal parts	Stop using and contact after-sales service for repair and replacement
Stop working	Insufficient Battery Pack	Charge it before use
	Overheat protection caused by blockage of air duct	Clean the air duct, restart after cooling with the motor
	The host is damaged	Contact after-sales service for repair
Automatic shutdown	Battery Pack sends out error signal	Re-plug or replace the Battery Pack
	The temperature of the air outlet is too high	Start after the temperature drops

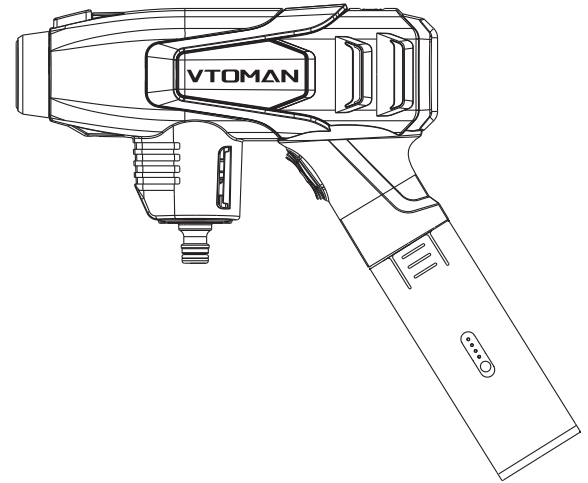

Important information

1. Make sure to keep away from children when using
2. Do NOT aim the suction nozzle at the eyes or ears during use
3. Do NOT immerse the product in water or rinse the host with water

Introduction

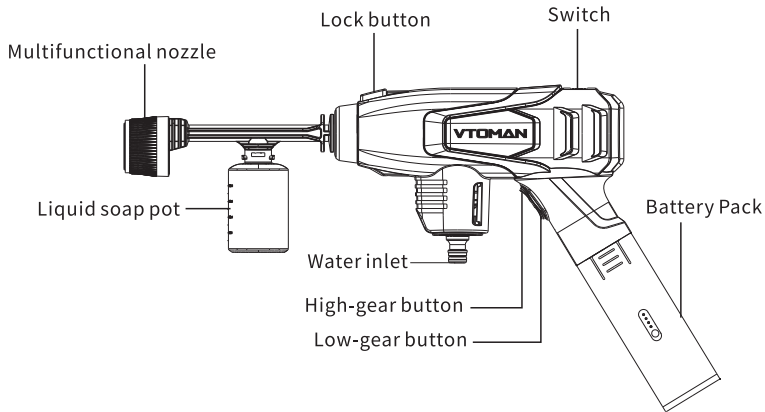

Parts List

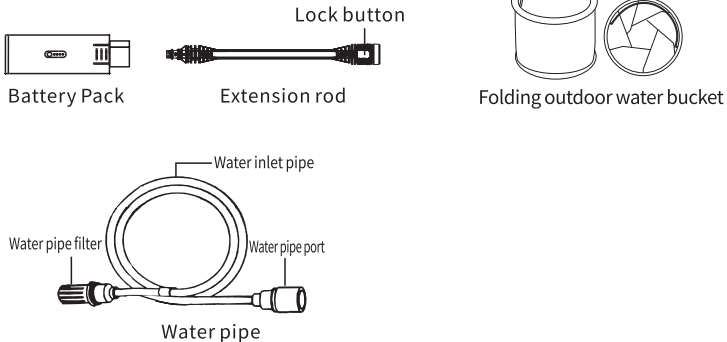

Technical specification

Name	Pressure Washer
Model	ToolCore V32
Weight	1.2kg
Rated power	280W
Maximum inlet water pressure	5Bar
Maximum outlet water pressure	32Bar(High gear); 17Bar(Standard gear)
Flow rate	150L/h

Installation guidance

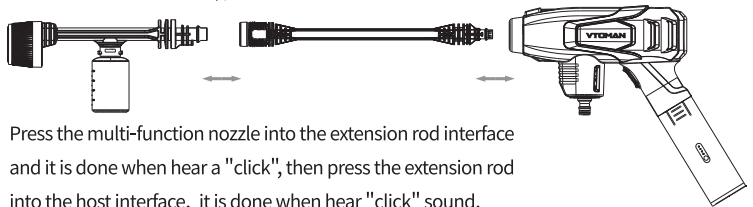
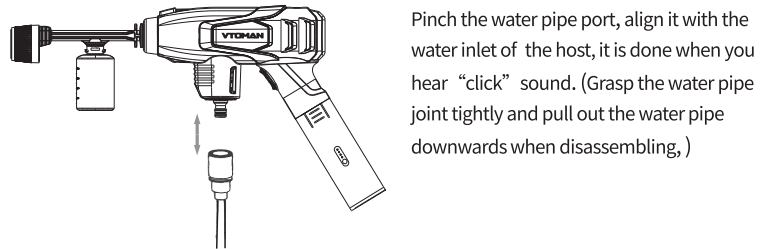
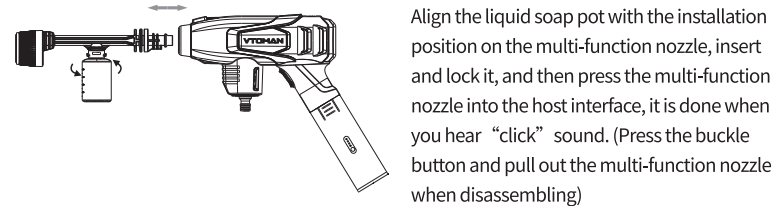

(Press the buckle button and pull out the multi-function nozzle when disassembling)

Operation guidance

Way of working

1. Touch the switch button, the Battery Pack indicator will light up
2. Long press the high-gear button, the host will continue to work at high-gear, release it to stop working
3. Long press the low-gear button, the host will continue to work at low-gear, release it to stop working
4. Rotate the multifunctional nozzle to choose different water outlet methods (0°, 20°, 20° tilt, 40°, foam, scattered)
5. Product will automatically stop if it doesn't work for 30s, restart again and repeat the above steps

Cleaning

Note: Please remove the battery before cleaning.

1. Regularly clean the water inlet filter to prevent blocking the water inlet

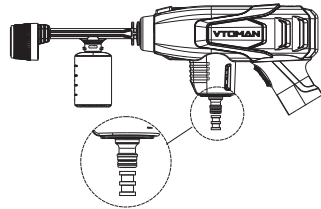

2. Regularly clean the water pipe filter screen

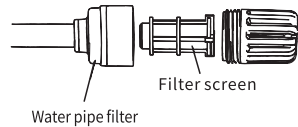

Troubleshooting

Finding	Causes	Remedies
Not working	Insufficient Battery Pack	Use after charging
	Battery Pack is not installed in place	Remove the Battery Pack and reinstall
	Damaged host	Contact after-sales for repair or replacement
Low water output	The filter is clogged causing poor water inflow	Clean the filter
	Bent water inlet pipe	Straighten out the water inlet pipe
	Impurities in the water	Replace clean water
	Clogged nozzle	Clean or replace the nozzle
	Damaged accessories cause water leakage	Replace damaged parts
No water absorption	Poor connection between water pipe joint and water inlet	Connect the water inlet pipe joint to the water inlet of the machine in a proper way
	The hose filter is not fully inserted into the water	Insert the hose filter fully into the water
	The sealing ring of the water inlet is off or damaged	Install or replace the sealing ring
Water leakage at the water outlet	Nozzle or extension rod is not installed in place	Install the nozzle and extension rod or host in a proper way

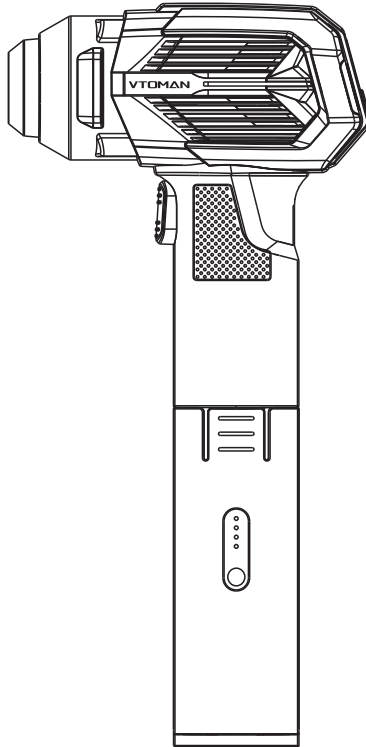

ToolCore V150

Tire Inflator Manual

Important information

1. Make sure to keep away from children when using
2. Make sure to disassemble the air pump after the air pump cools down
3. Do NOT aim the suction nozzle at the eyes or ears during use
4. Do NOT set the pump value higher than the safety range of the device that needs to be pumped

Introduction

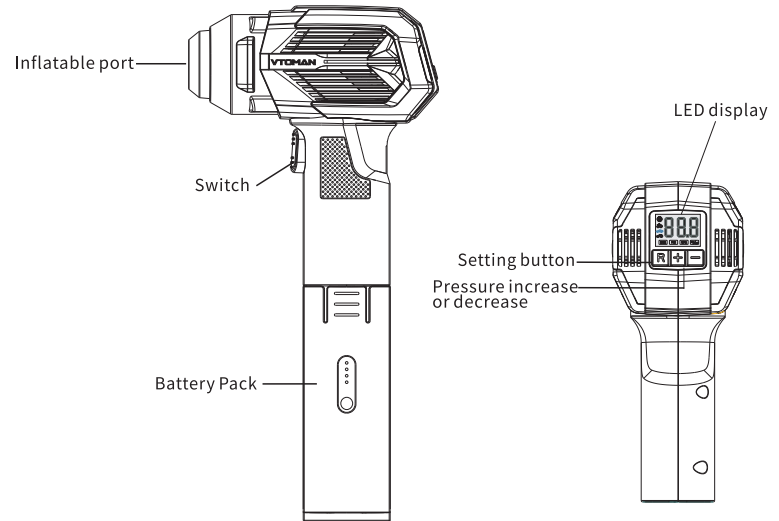

Parts list:



Battery Pack

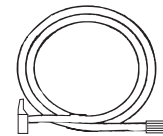

Pump pipe

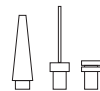

Multi-function nozzle

Technical specification

Name	Tire Inflator
Model	ToolCore V150
Weight	0.7kg
Flow rate	45L/min
Motor speed	19000rpm
Maximum inflation pressure	150PSI

Installation guidance

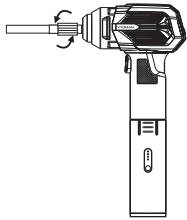

Connect the pump

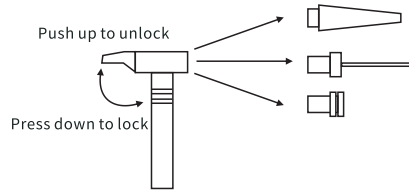

Connect the multi-function nozzle

Operation guidance

Operation Guidance

Short press switch button to activate the host. After setting the specific parameters, then you can press the switch button again to start pumping up (in the setting state of pressing the “R” key, short press the switch button to confirm the function, and then press the switch button again to start pumping up).

The product will automatically shut down after 4 hours the power button is touched by mistake (Note: less than 3PSI does not display).



1. In the power-on state, short press the “R” key is setting mode of switching, the sequence is “pumping object”, “unit” and “air pressure setting value”. When switching to the object that the icon flashes, you can press pressure “+” or “-” keys to set at this time.

2. A total of 5 modes, the pressure range adjusted and preset pressure values by each mode, are shown in the following table:

Mode	Adjustable pressure range	Preset pressure valu	Unit
Free mode	3-150	/	PSI
Ball	5-16	10	PSI
Mountain bike	30-70	30	PSI
Small car	1.8-3.5	2.2	BAR
SUV	1.8-3.8	2.5	BAR

Note: 1BAR≈100KPA≈14PSI≈1Kg/cm²

3. +, - button: Adjust the “setting object”, “unit” and “air pressure value”. When setting the air pressure value, short press “+” “-” keys to increase or decrease, long press for 2S to switch to rapid increase or decrease, KPA gear short press once to increase or decrease 5KPA.

4. Switch button (pump up button)

After setting the specific parameters, connect to the device that needs to be pumped up, press the switch button to start the pump. Short press this button can turn on/off the pump, the product will retain the last set parameters, you can directly turn on the pump without resetting. If the external real-time pressure is greater than the set value, or when the air has been pumped to the set value, it will stop working.

Troubleshooting

Finding	Causes	Remedies
The character "888" flashes	The Battery Pack is not in good contact.	Insert the Battery Pack the proper way
The character "000" flashes	Over-temperature protection of system is started.	Wait for the temperature to cool down
Slow pumping or air pressure does not rise	The air pump is leaking	Replace the pipe tube
	The pump pipe is damaged	Tighten the air pump

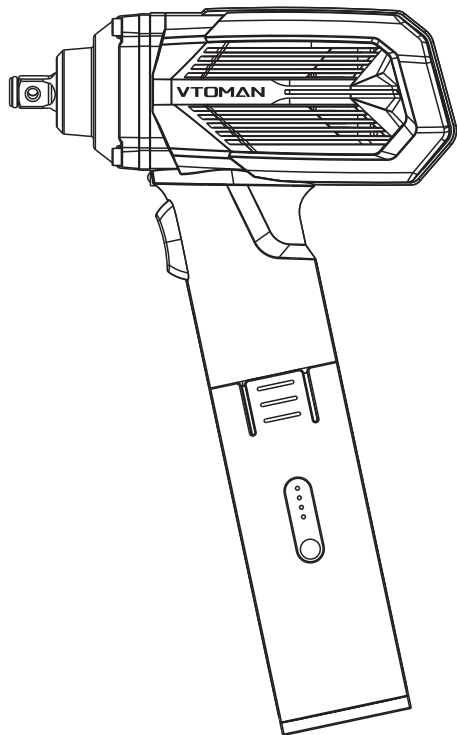

ToolCore V700 Impact Wrench Manual

Important information

1. Make sure to keep away from children when using
2. Make sure that the workplace is clean and bright
3. Do not operate power tools in an explosive environment

Introduction

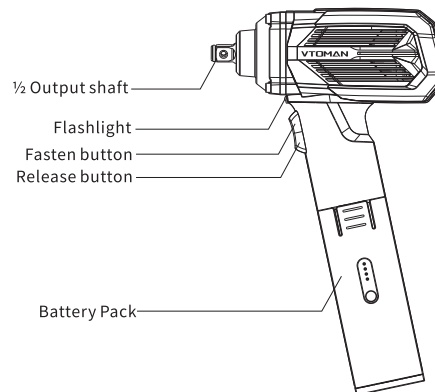

Parts list



Battery Pack

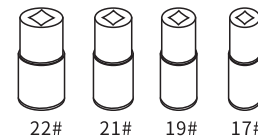

22#
21#
19#
17#

Bolt sleeve



Jack sleeve

Technical specification

Name	Impact Wrench
Model	ToolCore V700
Weight	1.6Kg
Rated power	800W
Maximum torque	700N.m
Rated speed	0-1600 RPM
Shock frequency	0~2200 IPM

Operation guidance

Instructions for Bolt Sleeve

1. Place the bolt/nut on or in the counterpart (for example: the nut is placed on the bolt or the bolt is placed in the threaded hole)
2. Install the bolt sleeve on the electric wrench
3. Hold the machine, long press the key switch, the bolt sleeve will drive the bolt/nut to rotate, when the bolt/nut encounters a reaction force, the machine will have an impact force (reaching a tight state)

Warning: Do not over tighten, the impact force of the electric wrench may damage the bolt/nut; keep the electric wrench and the bolt/nut at the correct angle to prevent damage to the bolt/nut

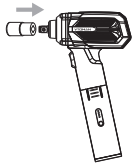

Install bolt sleeve

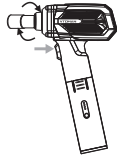

Long press the fasten button to tighten the bolt

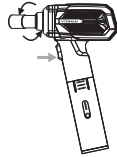

Long press the release button to loosen the bolt

Instructions for jack sleeve

1. Install the jack socket on the output shaft of the electric wrench
2. Connect the electric wrench with the jack socket installed to the jack rocker O-ring
3. Press fasten button on the electric wrench, raising the jack to the required height

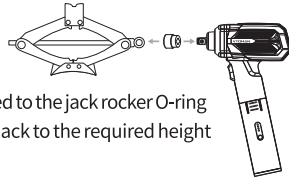

Troubleshooting

Finding	Causes	Remedies
Not working	Insufficient Battery Pack	Charging the Battery Pack
	Mechanical failure	Contact after-sales service for repair or replacement
Abnormal noise	Insufficient Battery Pack	Charging the Battery Pack
	Mechanical failure	Run idling for 10 seconds, then continue to work
Bolt sleeve cannot be installed	The correct bolt sleeve is not used	Use bolt-matching bolt sleeves
Product overheating	The vent is dusty and blocked by foreign objects	Clean the vents, do not cover the vents with your hands during operation
	Overloaded	Use it later

Toxic and harmful substances

Parts Name	Toxic and harmful substances					
	Pb	Hg	Cd	Cr(VI)	PBB	PBDE
Surface	○	○	○	○	○	○
Charger	○	○	○	○	○	○
Battery	○	○	○	○	○	○
Motor	○	○	○	○	○	○
Circuit board	○	○	○	○	○	○
Extension rod	○	○	○	○	○	○
Multi-functional nozzle	○	○	○	○	○	○
Water pipe	○	○	○	○	○	○
Water pump	X	○	○	○	○	○
Air pump	○	○	○	○	○	○
Inflatable hose	○	○	○	○	○	○
Clamp	○	○	○	○	○	○
Dust cup	○	○	○	○	○	○
Dust brush	○	○	○	○	○	○
Extension kit	○	○	○	○	○	○
Floor brush	○	○	○	○	○	○
Sleeve	○	○	○	○	○	○
Others	○	○	○	○	○	○

This form is compiled in accordance with SJ/T 11364.

0 means that the content of the hazardous substance in all homogeneous materials of the part is below the limit requirement specified in GB/T 26572.

X means that the content of the hazardous substance in at least one of the homogeneous materials of the part exceeds the limit requirement of GB/T 26572.

