

Cikkszám	IFS megnevezés EN	Db
AM01078	Filter House - wall two filters	2
ABE0505	Suction 2" chrome thick with seal V2	4
AKU1892	Air Regulator - house led lighted V2	2
ACM0912	Control Panel - IN.K1000 V2	1
AKU1893	On-Off tap house 33 transparent V2	1
AKU1891	Water Diverter 60 - LED lighted V2	1
AKU2101	Fountain laminar V2	6
ACM0874	Speaker 3" (2 way)	4
AJ00250	Jet 7"	4
AKU1720	Suction 48	2
AJ00169	Jet - 20 SB - Ozone 90°	1
ACM0834	Circulation pump PCF100 1100 W without prefilter	1
ABE0417	Turbine housing	1
ACM0857	Control box for tubrine	1
ACM0080	Spa Pump 3 HP - One Speed	1
AJ00217	Jet 3" - transparent 1 Hole Rotation transparent V3 Wellis	18
AJ00214	Jet 2" - transparent 1 Hole transparent V3 Wellis	6
AF00061	Pillow 300x126x54 white ribbed	2
ACM0849	Subwoofer 288W	1
ACM0904	IN.STREAM-2 with quick connector	1
ACM0932	Led control box	1
ACM0867	UV-C control electronics	1
AKU2157	Adapter for swim theter V2	1
ACM0893	UV-C Stainless steel house set 60Hz	1
ASE0079	Spring Clamp	2
ASE0186	Clamp 63	2
AKU2218	Led housing with seal	20
AKU2219	Nut for ledhouse	20
ACM0755	Control box In.YE-3	1

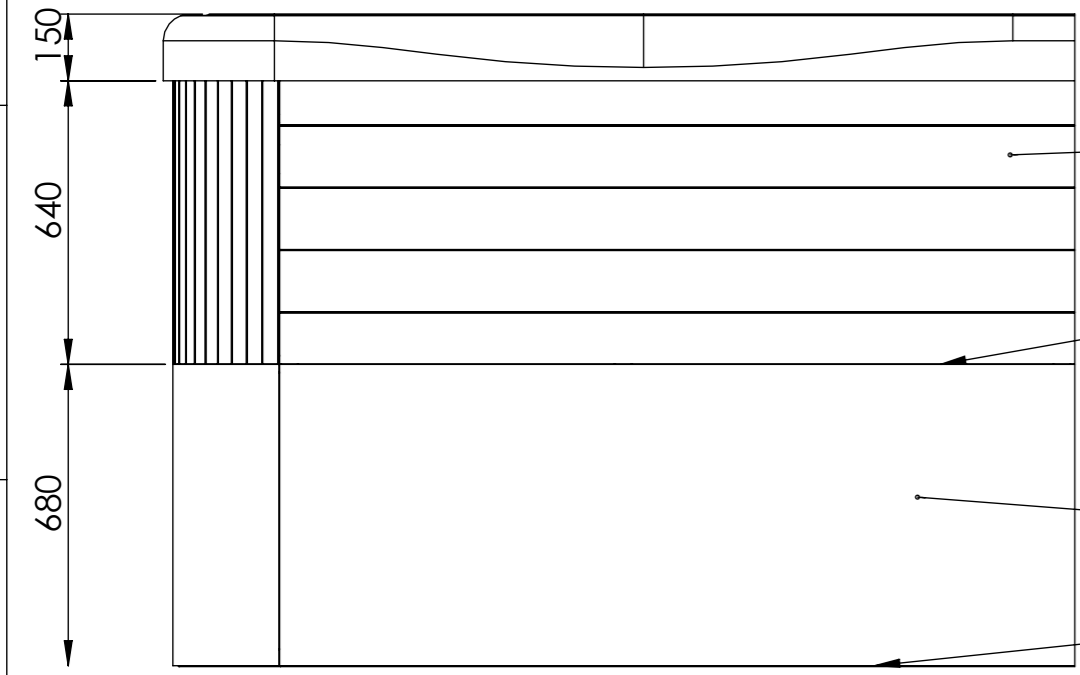

Sidepanel

Sinkable to the abs hight

ABS sidepanel

Doesn't require concrete base, only a 15 cm high gravel bed.

1400 depth

Termékcsalád: SwimLine

Sheet name: Amazonas - 2019 Turbina		Projection		
File name: FJ_WU00035_ENG_Amazonas-2019_Turbina_úszómedence				
Medence sz, h, m: 2350x5500x1470 mm		Elekt. ig. min.: 230 V - 1x25A - 50Hz / Elekt. ig. teljes: 400V - 3x16A - 50Hz		
1 személy ~75 kg	Medence súly: kg	Vezérlő: GECKO YE-3 + K1000		
Víz kiszorítás: 375 kg	Peremmagasság: 150 mm	Approved by: <b>Losteiner Sándor</b>	Pr. No: P-00182 Fa. No:	Number: <b>WU00035</b>
Minimum víz: 8000 liter	Created: 2020. 05. 15.	Drawer: <b>losteiner.sandor - 2020. 05. 14. 15:07:07</b>	A3	M 1:20

## Installation instruction

### **Residual-Current Device (RCD) having a rated operating residual-current not exceeding 30 mA is must**

The stated dimensions are for reference only. The actual dimension may be different from the specified

**L:** Drain diameter: 50 mm

**E:** 3 m cable is required for the electrical connection through the spa skirt.

### Cable length/cross section

- Minimum requirement: cable length is maximum 10 m, 3x4 mm<sup>2</sup> core flex cable is necessary (230V) - In this case the massage motors and the heating won't work at the same time.
- For full operation: cable length is maximum 10 m, 5x4 mm<sup>2</sup> core flex cable is necessary (400V) - In this case the massage motors and the heating work at the same time.

### Attention

**The hot tube will be installed only if the electrical contractor makes declaration of the installation of Residual-Current Device and proper fuses**

## Initial installation

The installation or making any repair are allowed only for properly skilled person.

Disconnecting device has to be installed when the spa is directly connected to the electricity networks.

### 1. Site preparation

#### a. Indoor / Basement installation

If you place your spa indoors, be aware of some special requirements: Water may accumulate around the spa, so the flooring material must have a proper runoff to avoid accumulation of water. When building a new room for the spa, constructing a floor drain is required, or damages may occur due to overflow, overfilling, or technical failure. Our company does not take responsibility for any damage in absence of floor drainage. Humidity will naturally increase in the room where the spa is located and the evaporated water condenses. For this reason ensure that the area has proper ventilation. We recommend installing a dehumidifier in the room.

#### b. Outdoor and patio installation

A solid horizontal foundation is necessary for installation of the spa. We advise using a reinforced concrete foundation at least 10-15cm thick. Ensure that your deck or foundation will support your spa. You must know the maximal load capacity of the foundation. Consult a qualified building contractor or structural engineer. To find out the weight of your spa, its contents and occupants please refer to the spa specification chart. This weight must not exceed the structure's rated capacity per square meter, otherwise serious structural damages could result. If you install the spa outdoors, we recommend a reinforced horizontal concrete pad at least 10-15cm thick.

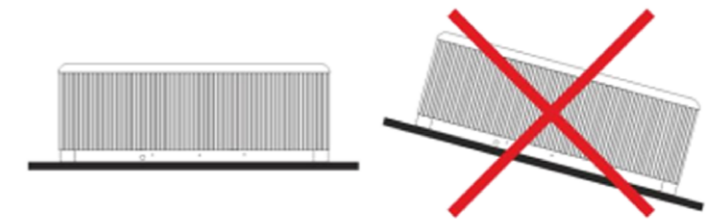

Install floor drains around your spa to lead water away even in heavy rain. When constructing the water drain it is advised to form a 10-15cm deep sloping ditch around the spa which directs water to the drain. Water from the drain must be directed to the canal or a drainage with enough capacity.

**Warning:** Do not expose the spa to direct sunlight (not even empty) without proper coverage. The insulated spa cover preserves the water temperature and provides protection from sunlight and rain. When exposed to sunshine for a longer period it may damage the surface of the spa and the spa equipment. Acrylic rapidly absorbs heat from sun rays, thus reaches a very high surface temperature which may damage the spa. In case of sealed design, if the spa was placed between glass structures, prevent the sun rays from reaching the spa directly through the glass as the temperature may get too high.

#### c. In-Ground / Sunken Spa

In case of sinking the spa into the ground you must make sufficient space for walking around the spa. For completion of maintenance works a minimum of 60cm wide inspection pit must be built around the spa.

The inspection pit's bottom must be under the bearing point of the spa so that water can flow into the pit in case of water leakage. A floor drain or sump pump should be used at the bottom of the pit to ensure continual water drainage.

In case of sinking the spa only the portion below the spa's acrylic edge can be sunk. The air of the inspection pit steams up. To prevent unpleasant odors proper ventilation must be provided (e.g. installing ventilators). The costs of pulling the spa out of the ground are borne by the user. If the aforementioned conditions are not present, setting up the spa may fail.

### 2. Electrical connection

All the above stated electrical preparation must be ensured by the customer. Every product has own connection drawing.

Use only copper wires. Change the fuses always with the same type. The device has to be connected to the equipotential grid.

Product family: **SwimLine**

Sheet name: <b>INFO(2)</b>	Projection	
File name: <b>FJ_WU00035_ENG_Amazonas-2019_Turbina_úszómedence</b>		
Dimension SPA: <b>2350x5500x1470 mm</b>	Min.El. nds: <b>230 V - 1x25A - 50Hz / Opt.El. needs: 400V - 3x16A - 50Hz</b>	
1 person ~75 kg	Weight of the SPA: <b>kg</b>	Control box: <b>GECKO YE-3 + K1000</b>
Water disp.: <b>375 kg</b>	Rim height: <b>150 mm</b>	Approved by: <b>Losteiner Sándor</b>
Minimum water: <b>8000 liter</b>	Created: <b>2020. 05. 15.</b>	Drawer: <b>losteiner.sandor - 2020. 05. 14. 15:07:07</b>
		Pr. No: <b>P-00182</b>
		Fe. No:
		Number: <b>WU00035</b>
		<b>A3</b> <b>M 1:17</b> <b>page 2 / 3</b>

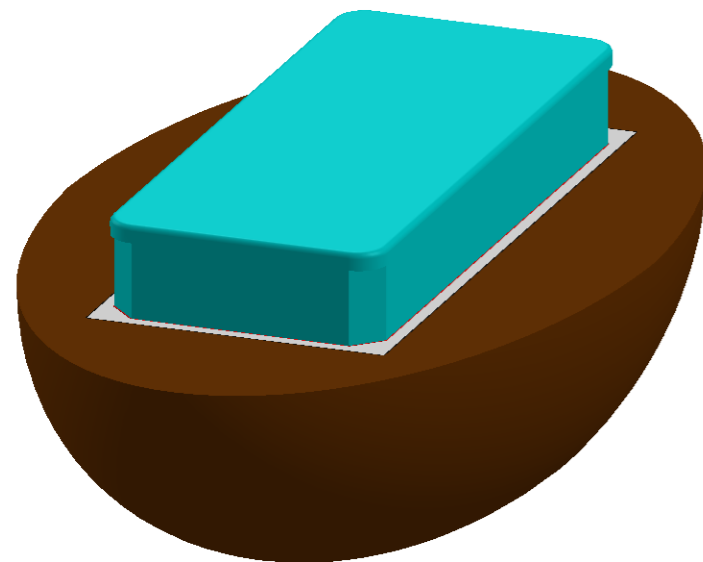
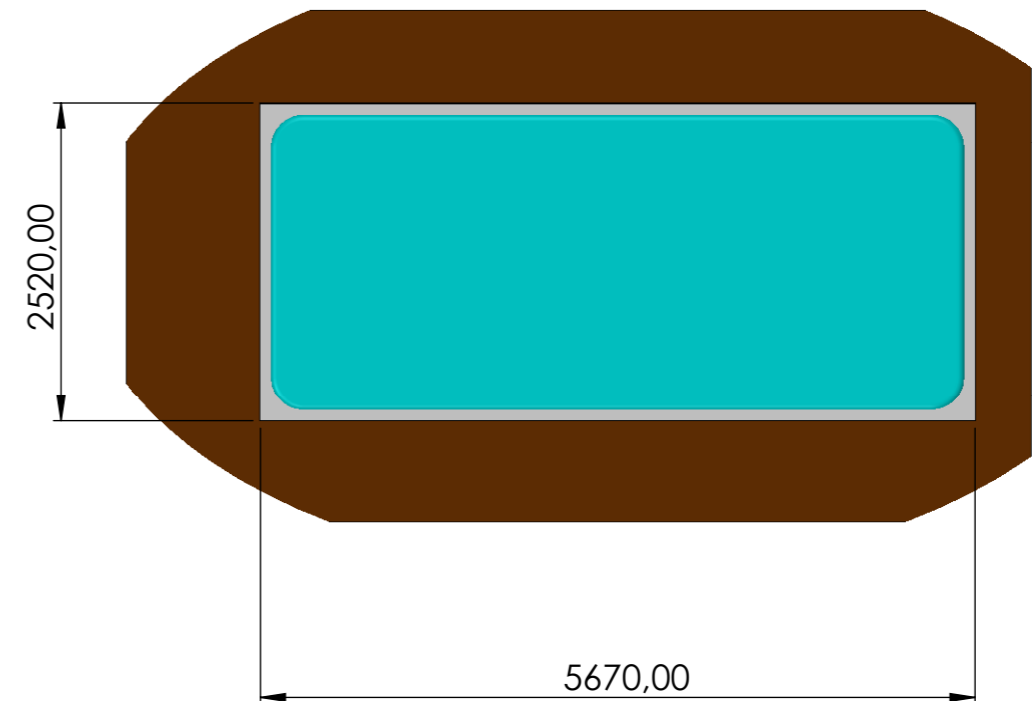
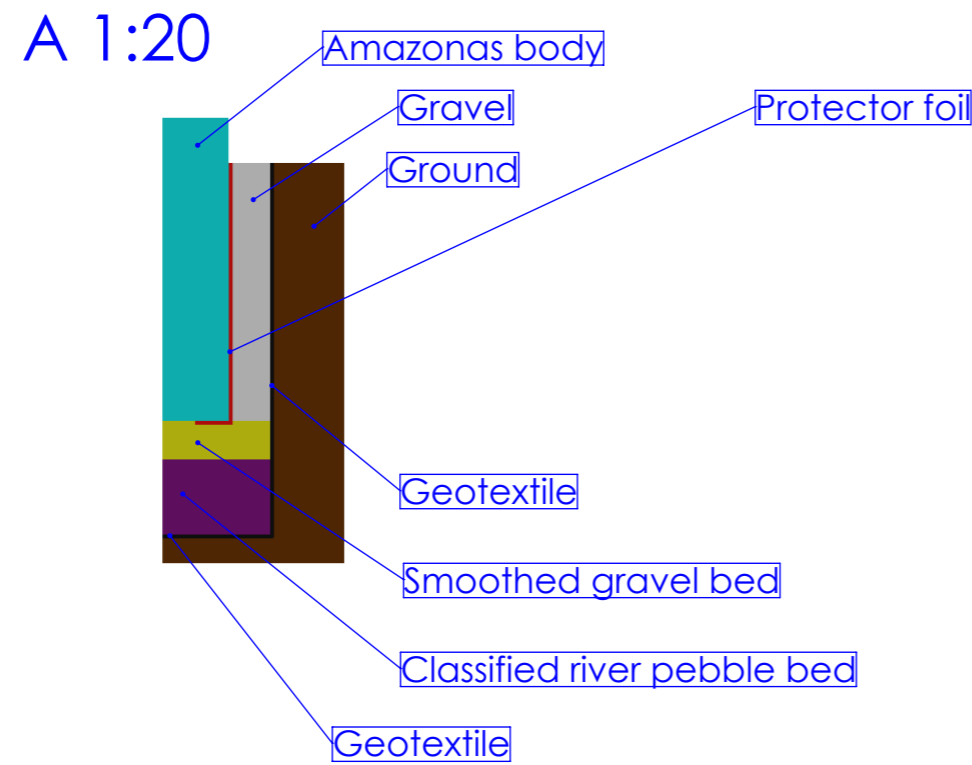
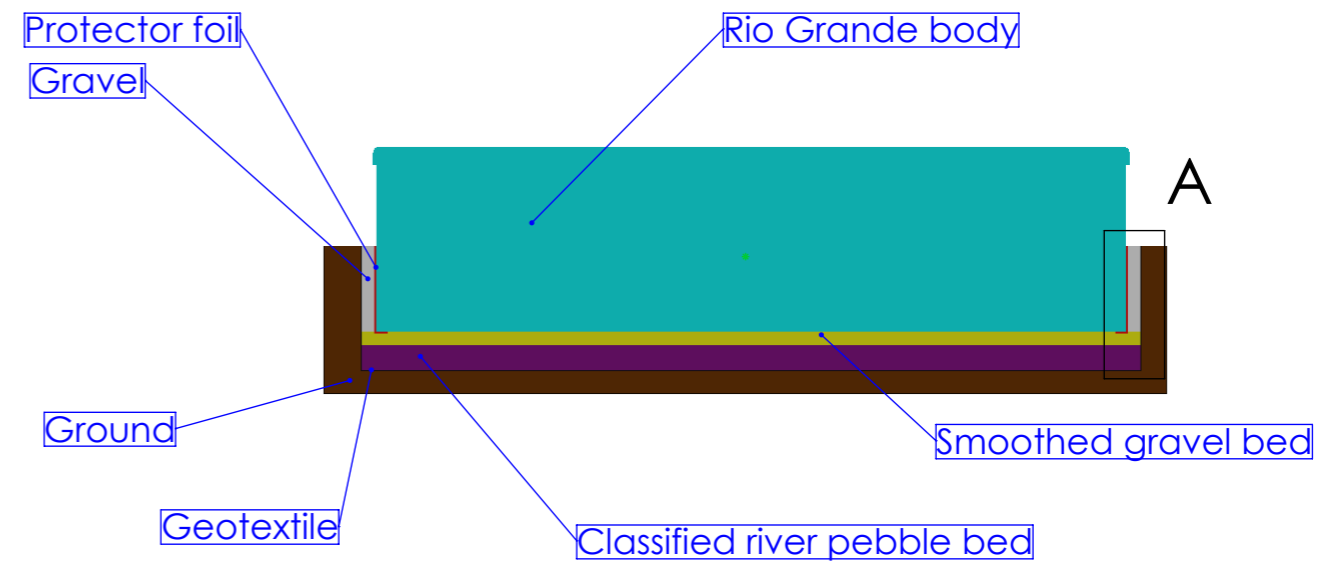
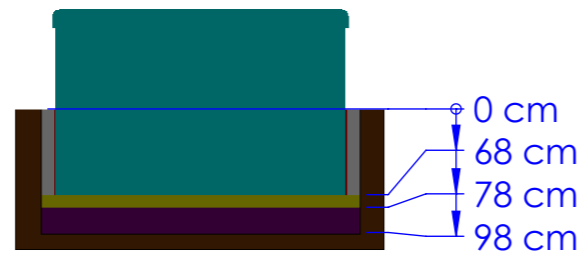

Product family: **SwimLine**

Sheet name: <b>SEMICABINET(2)</b>		Projection			
File name: <b>FJ_WU00035_ENG_Amazonas-2019_Turbina_úszómedence</b>					
Dimension SPA: <b>2350x5500x1470 mm</b>			Min.El. nds: <b>230 V - 1x25A - 50Hz / Opt.El. needs: 400V - 3x16A - 50Hz</b>		
1 person ~75 kg		Weight of the SPA: <b>kg</b>		Control box: <b>GECKO YE-3 + K1000</b>	
Water disp.: <b>375 kg</b>		Rim height: <b>150 mm</b>		Approved by: <b>Losteiner Sándor</b>	
Minimum water: <b>8000 liter</b>		Created: <b>2020. 05. 15.</b>		Pr. No: <b>P-00182</b>	
		Drawer: <b>losteiner.sandor - 2020. 05. 14. 15:07:07</b>		Fe. No: <b>WU00035</b>	
				Number: <b>WU00035</b>	
				A3 M 1:17	
				page 3 / 3	