

Disc Hanging Structure - Vertical 14'

DSC-14-V

Disc tension fabric hanging structures are made in the USA and are of the utmost quality and durability. State-of-the-art zipper pillowcase dye-sublimated stretch fabric coverings are combined with advanced, lightweight aluminum structures to provide unique design, functionality, and style. Hanging structures are offered in a wide variety of shapes and sizes. Stretch fabric graphics are hand-sewn, durable and dry-cleanable.



features and benefits:

- 50mm (2") tubes for shapes 14' diameter and over with internal expanding spigot connectors for unmatched structural integrity
- Engineer certificate available upon request
- Hanging hardware and bag in shipping box
- OCE Expandable rugged molded shipping case is a optional upgrade, please see OCE instruction sheets for more details
- Zippered pillowcase fabric graphic options: unprinted (white or black), single-sided, or double-sided, opaque liner included
- Lifetime hardware warranty against manufacturer defects

dimensions:

Hardware

Approximate dimensions and weights are shown below for a assembled hardware tube frame with the zippered fabric pillowcase.

168" w x 168" h x 1.97" d
4268mm(w) x 4268mm(h) x 50mm(d)

48 lbs / 22 kgs

Shipping

Packs in 1 Expandable Box

Expandable Box length (l) may vary
54" - 96" l x 16" h x 16" d
1372mm-2439mm(l) x 407mm(h) x 407mm(d)

Approximate Expandable Box weight:
2 lbs / 1 kgs

Total Shipping Weight:
50 lbs / 23 kgs

Graphic

Refer to related graphic template for more information.

Visit:
www.exhibitors-handbook.com/graphic-templates

additional information:

Graphic material:
Dye-sublimation zipper pillowcase fabric

When included in a larger kit, a different packaging solution will be listed to accommodate all contents of the kit. Individual packaging no longer provided.

2 person assembly recommended:



We are continually improving and modifying our product range and reserve the right to vary the specifications without prior notice. All dimensions and weights quoted are approximate and we accept no responsibility for variance. E&OE. See Graphic Templates for graphic bleed specifications.

Included In Your Kit

Tools, Components, & Connectors

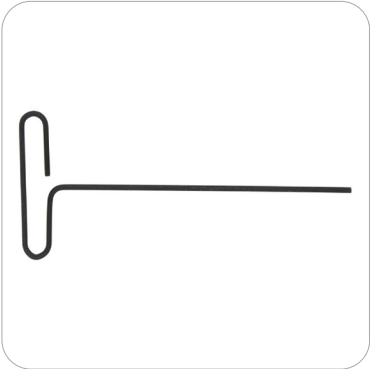

3mm T-Handle Hex Key x1

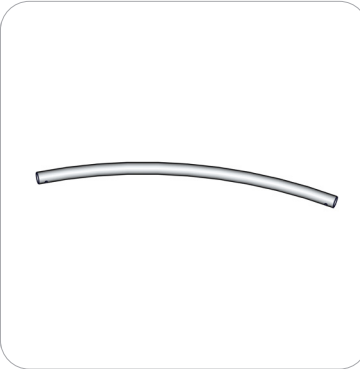

DSC-14-T1 x8

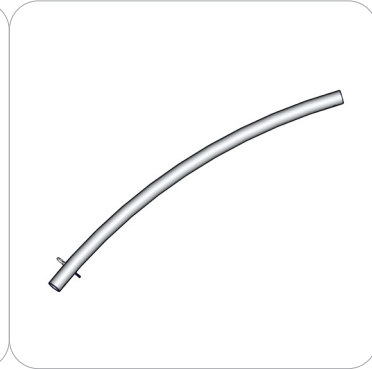

DSC-14-T2 x2

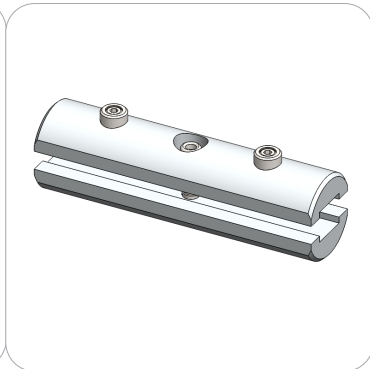

ES50 x10



EYE BOLT x2

Graphics

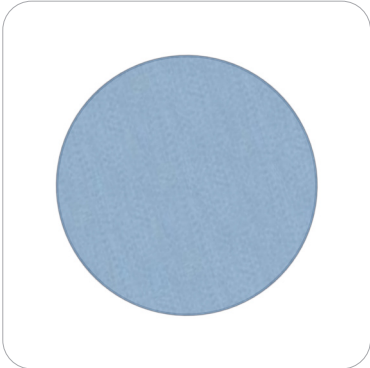

DSC-14-V-G x1

Exploded View

DSC-14-V

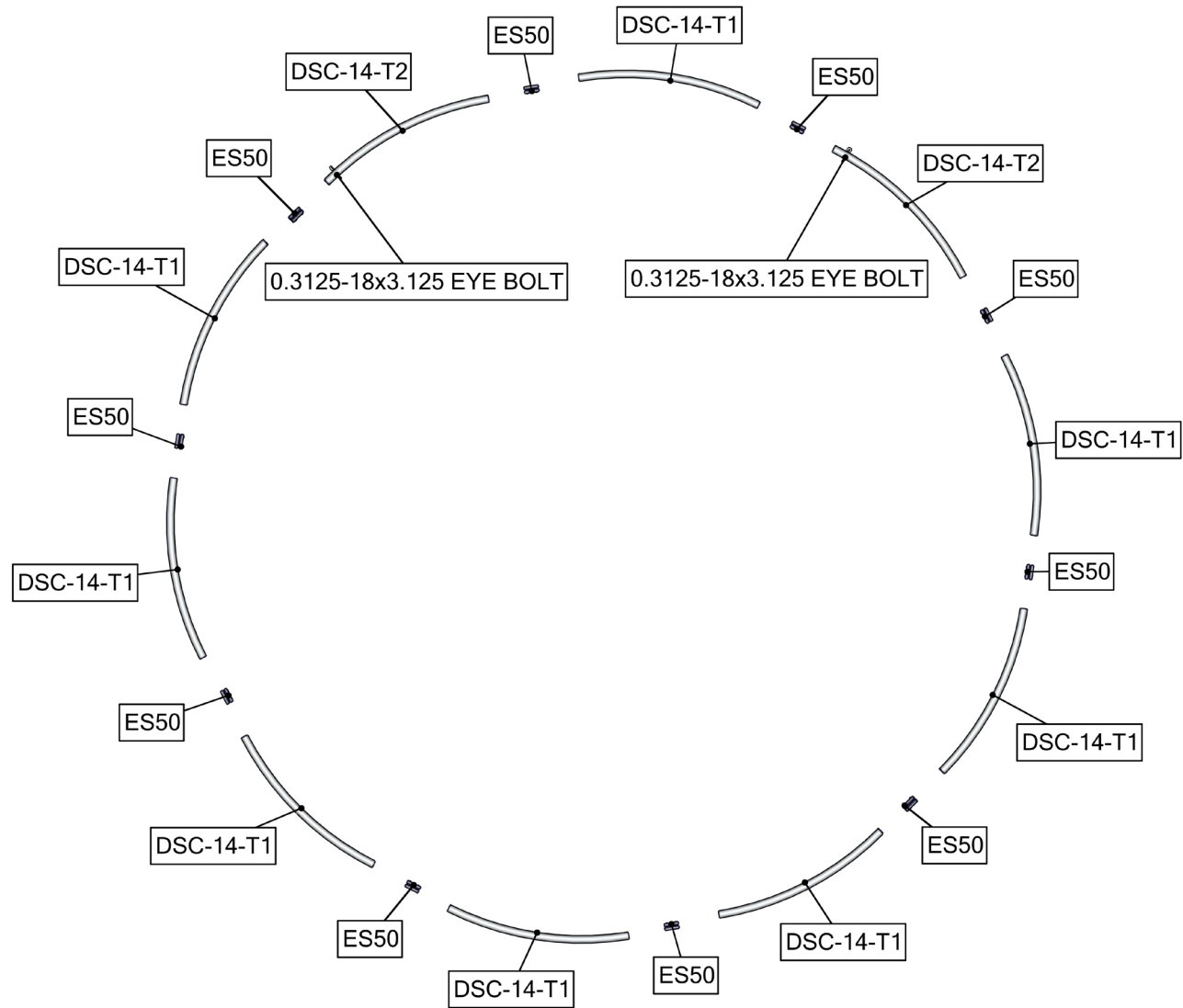

Labeling Diagram

DSC-14-V

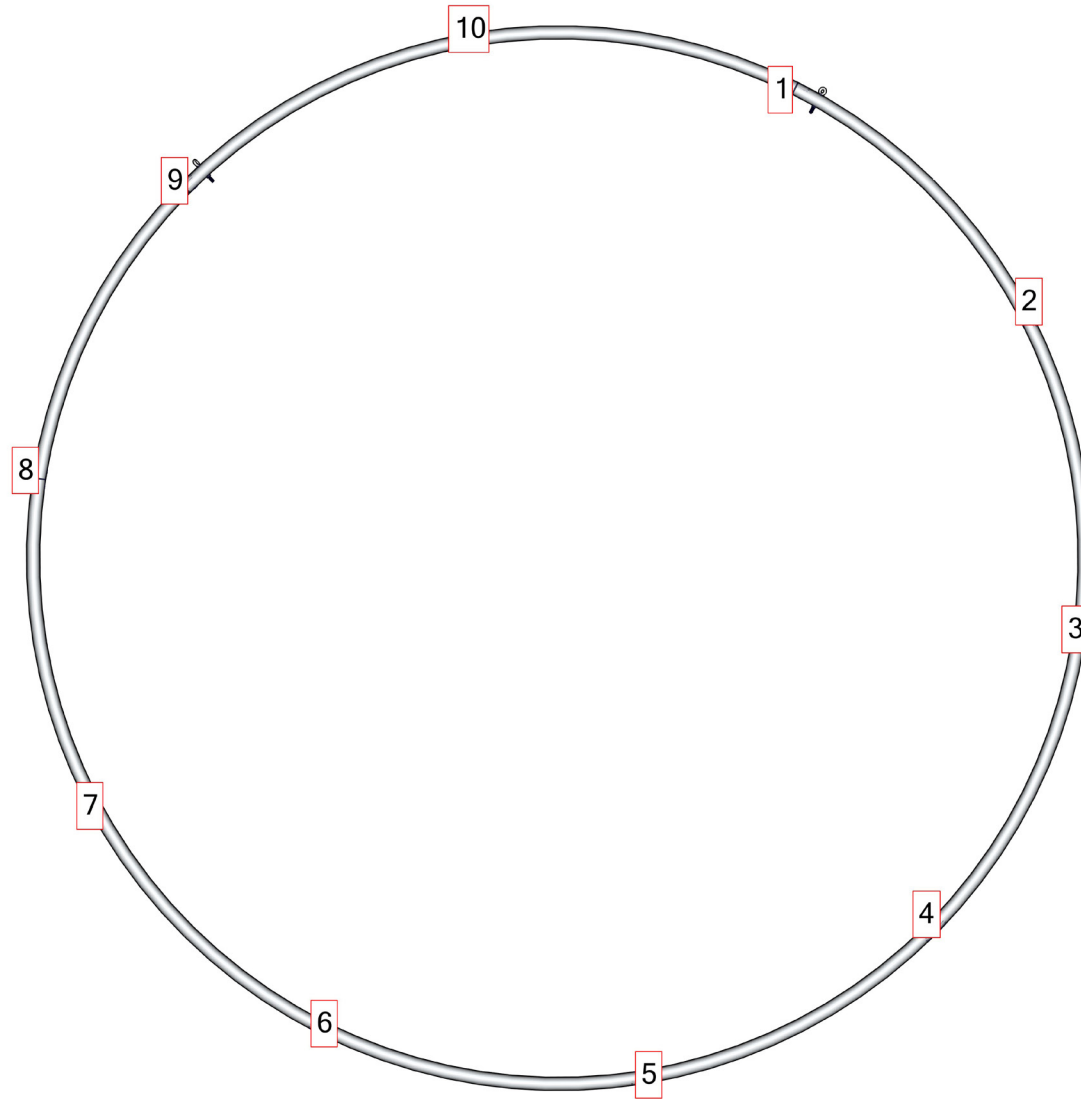

Connection Methods

Connection Method 1: ES50 / ES30 / SNAP BUTTONS

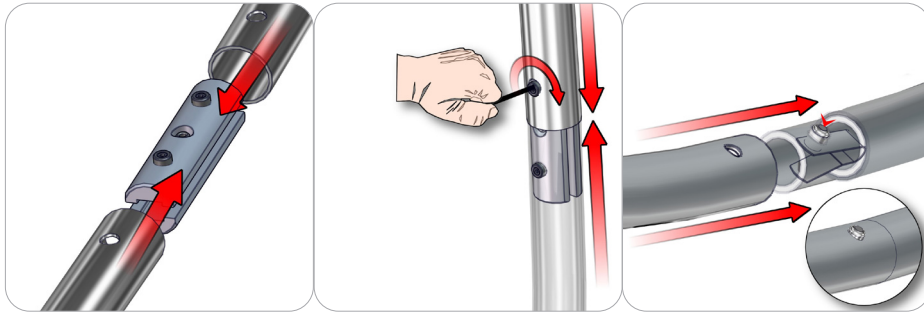

For spigot connections, compress the unlocked connector and slide into the tube lock access hole. Lock both screws carefully using your allen key tool. Be sure to lock securely, but do not over tighten. For snap button connections, locate the snap button on the connector or swage tube. Locate the hole on the corresponding tube. Press the snap button with your thumb and slide the tube and connector together so that the snap button snaps fully into the lock hole. To disassemble, press the snap button and pull apart.

Connection Method 2: Horizontal Disc Zipper Pillowcases

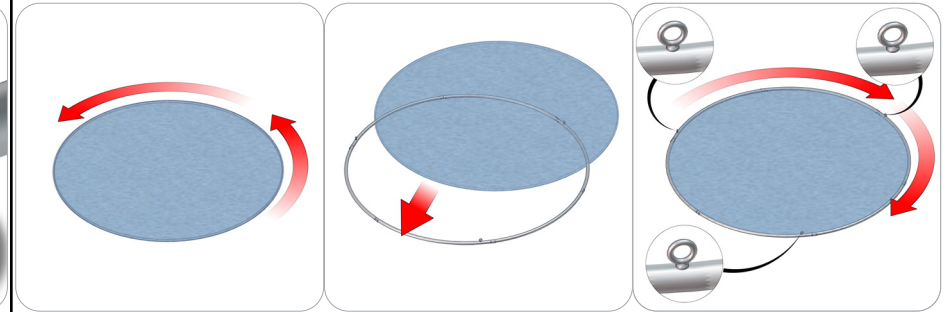

First, unzip the fabric pillowcase, two zippers. Second, pull the pillowcase over the frame. Make sure all eyebolts protrude through the pillowcase holes. Third, close the two zippers leaving the eyebolts exposed.

Connection Method 3: Vertical Disc Zipper Pillowcases

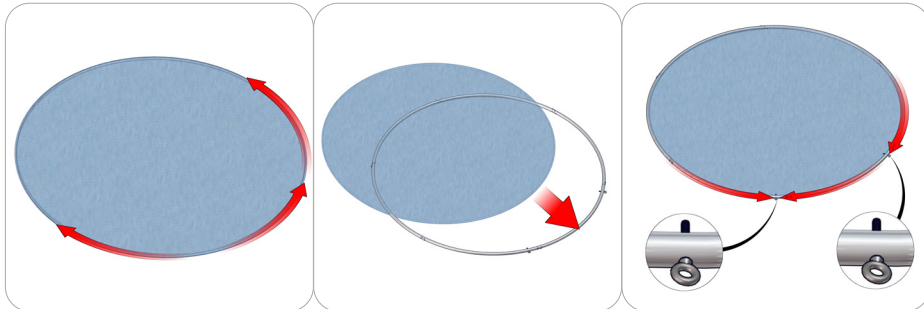

First, unzip the fabric pillowcase, three zippers. Second, pull the pillowcase over the frame. Make sure all eyebolts protrude through the pillowcase inbetween zippers. Third, close the three zippers leaving the eyebolts exposed.

Connection Method 4: Eyebolts & Hanging Cables

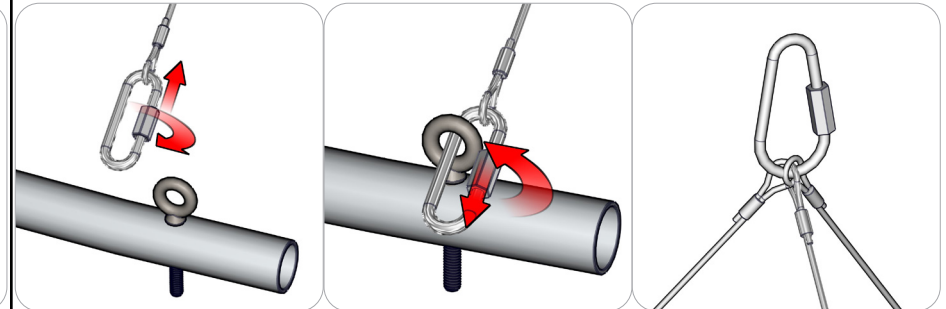

First, open the cable ring threaded slot. Second, apply the cable ring into the eyebolt and close the cable ring. Third, if there are multiple cables, combine them with the pear shaped cable ring.

Kit Assembly

Step by Step

Step 1.

Gather the components to build the tube frame. Use the Exploded View and the Labeling Diagram for part labels.

Reference Connection Method 1 for more details.

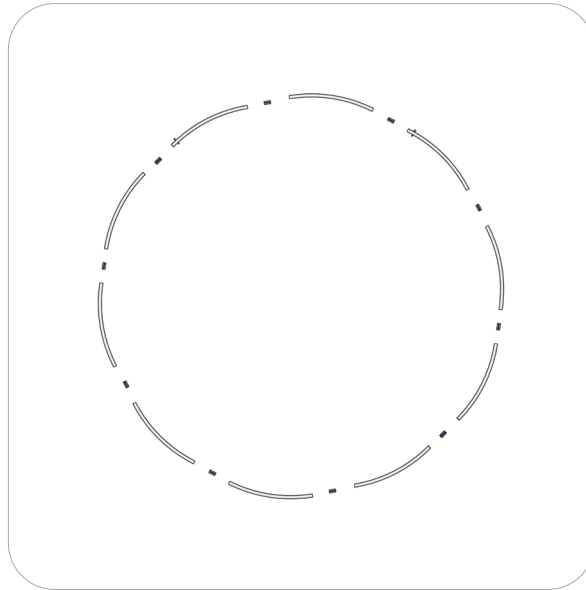
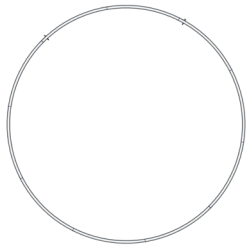

Step 2.

Place the cover graphic around the bottom of the frame and carefully pull the cover over the top and close all the zippers.

Reference Connection Method 3 for more details.

