

## Mazda RX7 Adaptor Kit – CEV5191

CEV5191



### Overview

All adapters retain use of original clutch and fit most NetGain Hyper9, WARP 9 and HPEV AC34/AC35/AC50/AC51 Motors. Some adapter plates may have more or less bolt holes than your make and model of vehicle requires. As some adapters span a broad range of model years the adapter is designed to have enough bolt holes to be compatible with all model designs.

### Specifications

- All adapter kits come with required hardware
- If using a HyPer9 motor, you may also need a shaft collar spacer, which is included
- Fits all rotary powered years

# Dimensions – Mazda RX7 Adaptor Kit – CEV5191

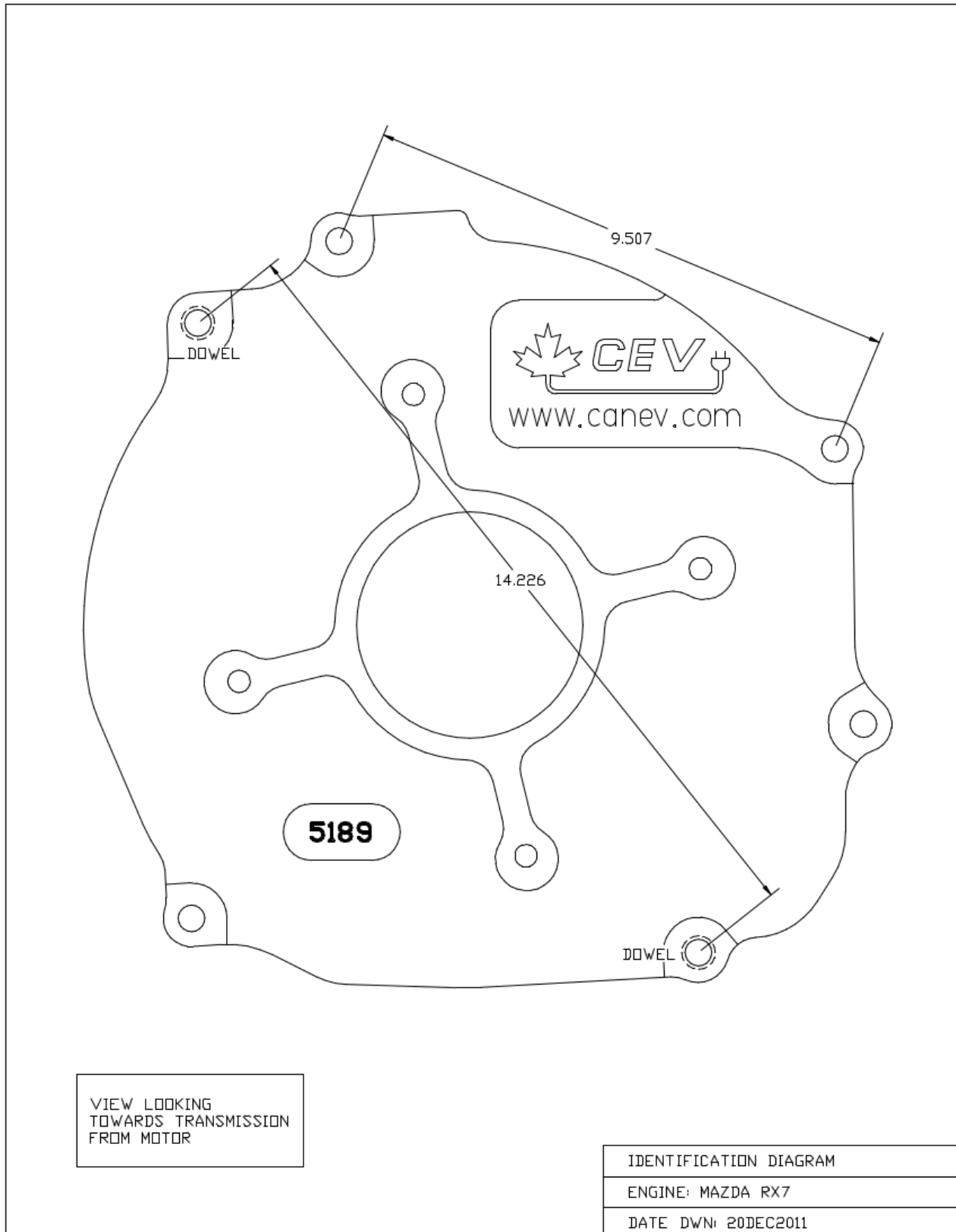

## Dimensions – Mazda RX7 Adaptor Kit – CEV5191 (cont.)

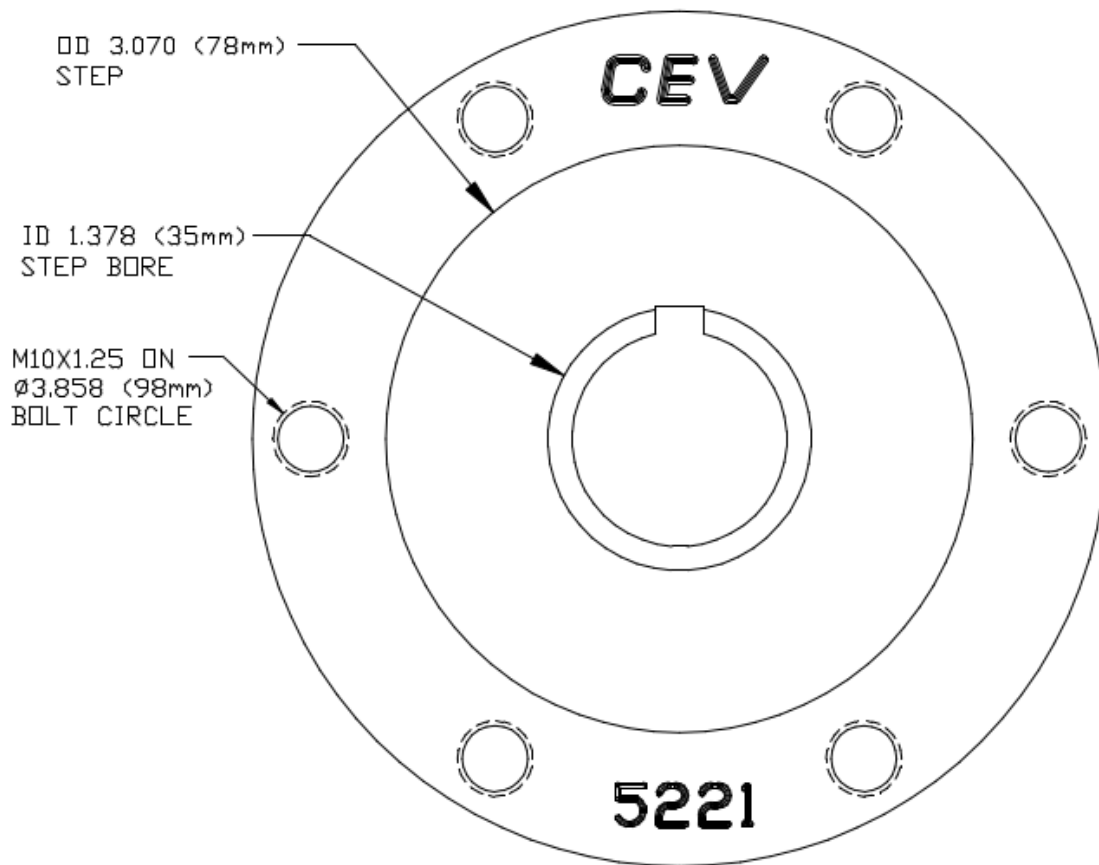

VIEW LOOKING  
TOWARDS MOTOR

HUB IDENTIFICATION DIAGRAM

ENGINE: MAZDA RX8

DATE DWN: 11JUN2014