

Ford Small Block V8 Adaptor Kit – CEV5188

CEV5188



Overview

All adapters retain use of original clutch and fit most NetGain Hyper9, WARP 9 and HPEV AC34/AC35/AC50/AC51 Motors. Some adapter plates may have more or less bolt holes than your make and model of vehicle requires. As some adapters span a broad range of model years the adapter is designed to have enough bolt holes to be compatible with all model designs.

Specifications

- All adapter kits come with required hardware
- If using a HyPer9 motor, you may also need a shaft collar spacer, which is included

Compatible Vehicles

- Ford Small Block V8 vehicles

Dimensions – Ford Small Block V8 Adaptor Kit CEV5188

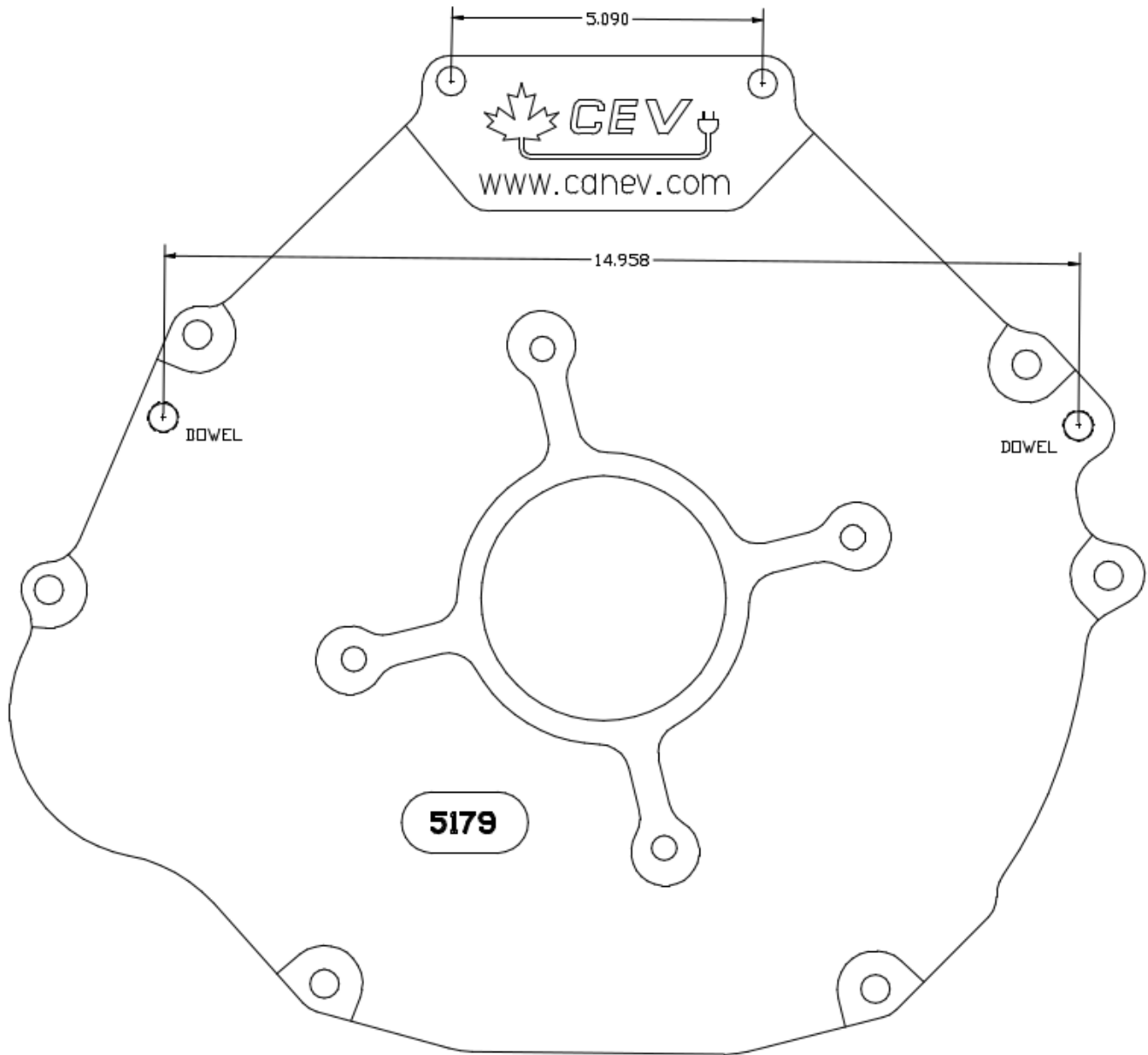

VIEW LOOKING
TOWARDS TRANSMISSION
FROM MOTOR

IDENTIFICATION DIAGRAM
ENGINE: FORD SMALL V8
DATE DWN: 8NOV2011

Dimensions – Ford Small Block V8 Adaptor Kit CEV5188 (cont.)

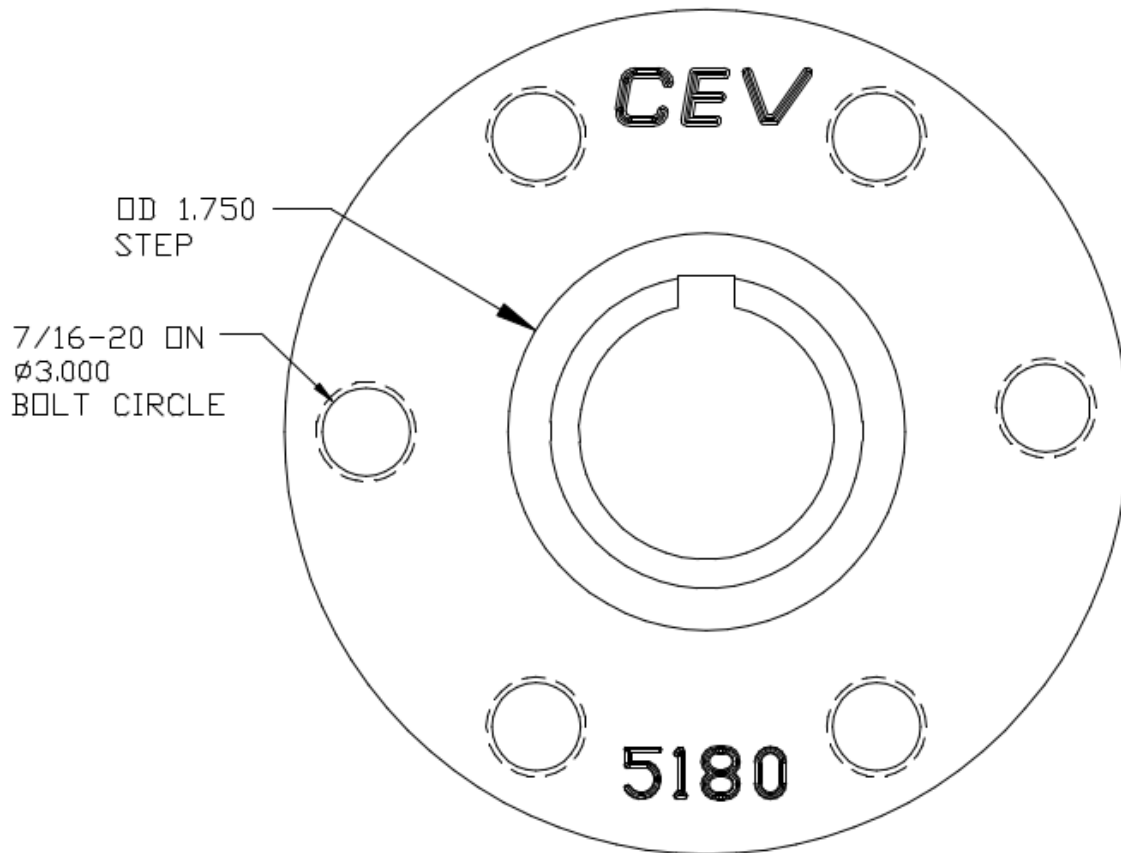

VIEW LOOKING
TOWARDS MOTOR

HUB IDENTIFICATION DIAGRAM

ENGINE: FORD SMALL V8

DATE DWN: 29JUL2012