



Chevy V6-V8 Pre 1986 Adaptor Kit – CEV5024

CEV5031



Overview

canEV adapter kits are designed to simplify your conversion while saving you considerable time and money. Every kit is custom engineered and manufactured in-house to exacting specifications and highest quality standards. Our kits have been used successfully in thousands of conversions for over 2 decades.

canEV's adapters retain the use of original clutch and are designed to be used with "B-Face" motors from NetGain such as the Hyper 9 and WARP 9, and motors from HPEVS like the AC34/AC35/AC50/AC51 Motors.

Some adapter plates may have more or less bolt holes than your make and model of vehicle requires as some kits span a broad range of model years. Some adapters may require trimming or other minor modifications for clearance when used in some applications.

Notes

All adapter kits come with required hardware however some hardware may not be correct or optimal for all applications. Additional hardware or slightly longer or shorter bolts may be required. This is because the bellhousings are not all the same for all possible fitments of some adapters. Flywheel bolts are generally not included as you can reuse the factory flywheel bolts.

If the Pilot Bearing is installed in the crankshaft it is provided in the kit. Alternatively, if the pilot bearing is installed in the flywheel it is assumed that you will be reusing it or sourcing a new one if needed. If using a Netgain HyPer 9 motor, you will need to install the included shaft collar spacer on the shaft before installing the hub. Some hubs are larger than the motor pilot diameter and must be installed after the adapter plate is bolted to the motor.

Specifications

Flywheel Reference Chart – GM V6 & V8								
GM Part #	Outside Diameter	Years	Crank Flange Bolt Pattern	Clutch Diameter	Ring Gear Tooth Count	canEV Kit #	V6 Small Block	V8 Small Block
14085720	12 ¾"	1955-1985	3.58"	10.4"	153	CEV5024		
3986394	14"	1970-1980	3.58"	11"	168	CEV5024		
3991469	14"	1955-1985	3.58"	10.4" or 11"	168	CEV5024		
10105832	14"	1986-1999	3.00"	11" or 11.85"	168	CEV5031		
14088646	12 ¾"	1986-1999	3.00"	10.4" or 11"	153	CEV5031		
14088650	12 ¾"	1986-1999	3.00"	10.4"	153	CEV5031		

Important*

Buyer must confirm fitment using the drawings below. canEV will not be responsible for return shipping costs and returned product is subject to restocking fees

Compatible Vehicles

- 1976-1986 Chevrolet Camaro
- 1980 Chevrolet Corvette (California only)
- 1977-1986 Chevrolet Caprice (includes Impala)
- 1977-1986 Pontiac Parisienne
- 1976-1979 Chevrolet Monza
- 1976-1979 Chevrolet Nova (also GM X-body clones after 1976)
- 1976-1986 Chevrolet Malibu, Chevrolet El Camino, and Chevrolet Monte Carlo
- 1978-1986 Pontiac Firebird
- 1978-1980 Oldsmobile Cutlass (US Market only, Canadian market 1978-1987)
- 1991-1986 Oldsmobile Custom Cruiser
- 1981-1986 Pontiac Grand Prix
- 1975-1979 Buick Skylark
- 1977-1986 Chevrolet/GMC Trucks, SUVs, Vans
- 1991-1986 Cadillac Brougham
- 1978-1986 Buick Regal

Dimensions – Chevy V6-V8 Pre 1986 Adaptor Kit – CEV5024

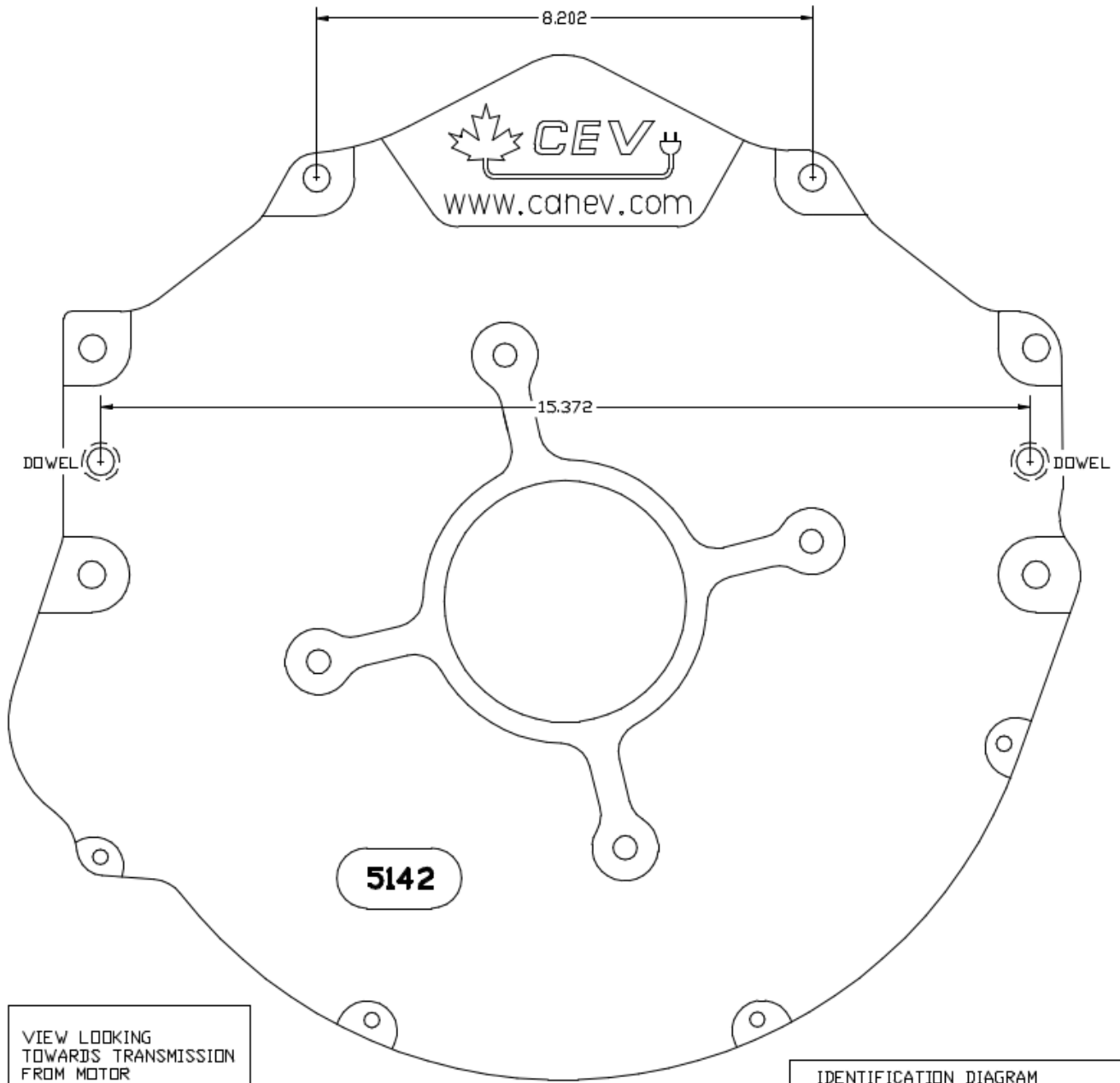

VIEW LOOKING
TOWARDS TRANSMISSION
FROM MOTOR

IDENTIFICATION DIAGRAM
ENGINE: 4.3L CHEV
DATE DWN: 8NOV2011

Dimensions – Chevy V6-V8 Pre 1986 Adaptor Kit – CEV5024 (cont.)

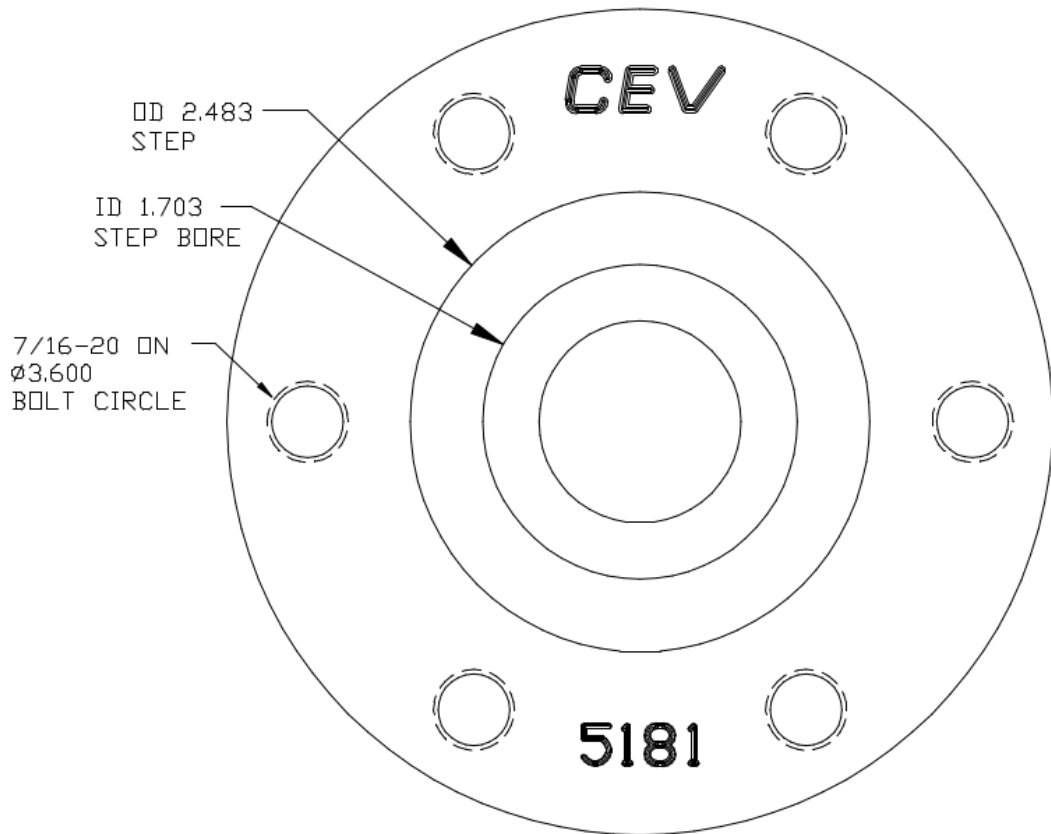

VIEW LOOKING
TOWARDS MOTOR

HUB IDENTIFICATION DIAGRAM
ENGINE: CHEV SMALL V8 PRE-87
DATE DWN: 29JUL2012