

eMeetLink Guide

EMEET Meeting Capsule

Device settings

Firstly, connect the device to the computer via USB cable.
Open the eMeetLink software and enter the setting interface.

1. Enable or release the screen

Preview the video when adjusting the settings.

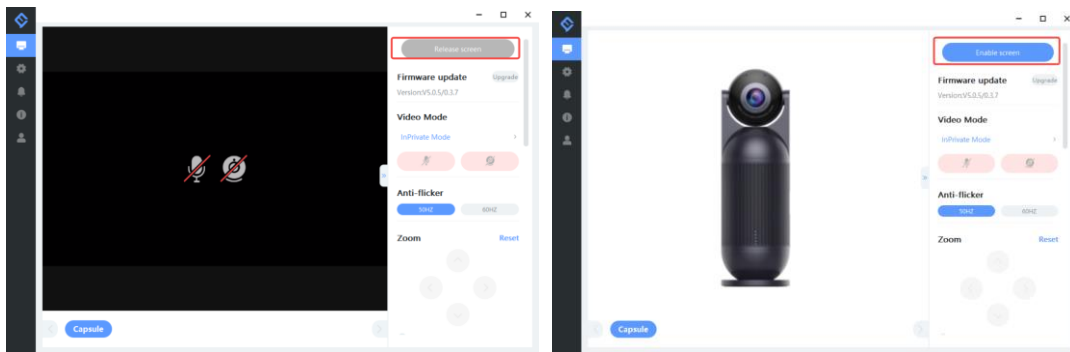

2. Firmware update

In the upper right corner, you can see your device's firmware version.
Also, you can click the "update" button to get the latest version.

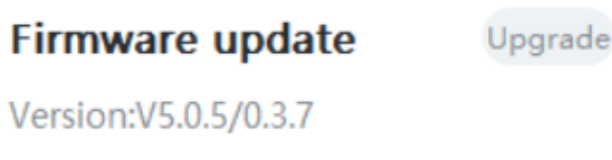

3. Video Mode

1) Easy Switch between 5 modes

There are five conference modes for your choices: Collaboration Mode, Speech Mode, Classic Mode, Spotlight Mode, or InPrivate mode. You can select according to your needs.

Collaboration Mode

Active speakers (up to 3) can be detected by their voices and appear on the screen at the same time. Their faces will be automatically centered.

The lower part of the screen displays a panoramic view of the conference room.

Speech mode

Only one active speaker will be focused and appear on the screen.

The lower part displays a panoramic of the conference room.

Classic mode

In this mode, the camera records a 180-degree wide-angle video.

Spotlight mode

Adopting a 65° field of view, this is a mode designed for one-person use.

InPrivate mode

This mode turns off both the microphones and the camera for privacy protection.

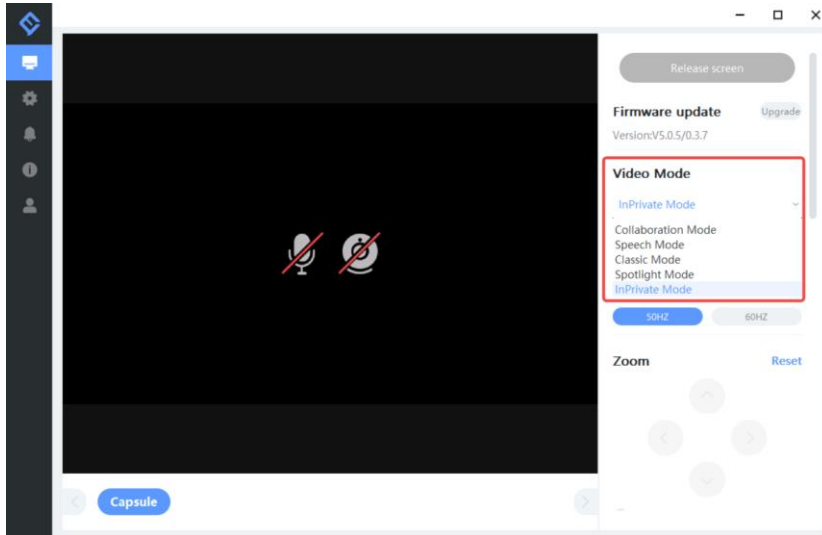

2) Mute microphone or camera

In these 4 modes: Collaboration Mode, Speech Mode, Classic Mode, Spotlight Mode), you can select mute the microphone or camera.

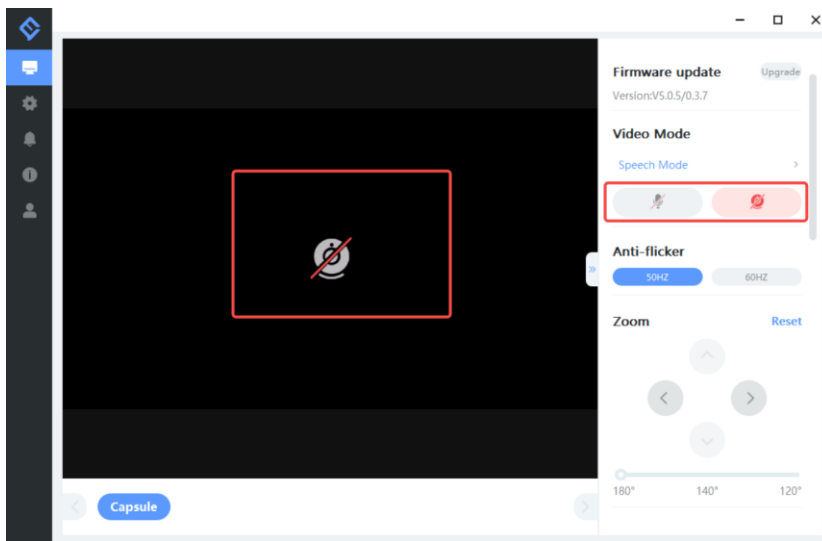

4. Anti-flicker

Most countries use 50HZ as the power grid operating frequency, and some countries such as the United States use 60HZ.

Choose a suitable power frequency to avoid the screen flashing.

Anti-flicker



5. Zoom

In the classic mode, the camera can zoom in or out via eMeetLink. Then you can tune the view up, down, left, and right to adjust what is being framed.

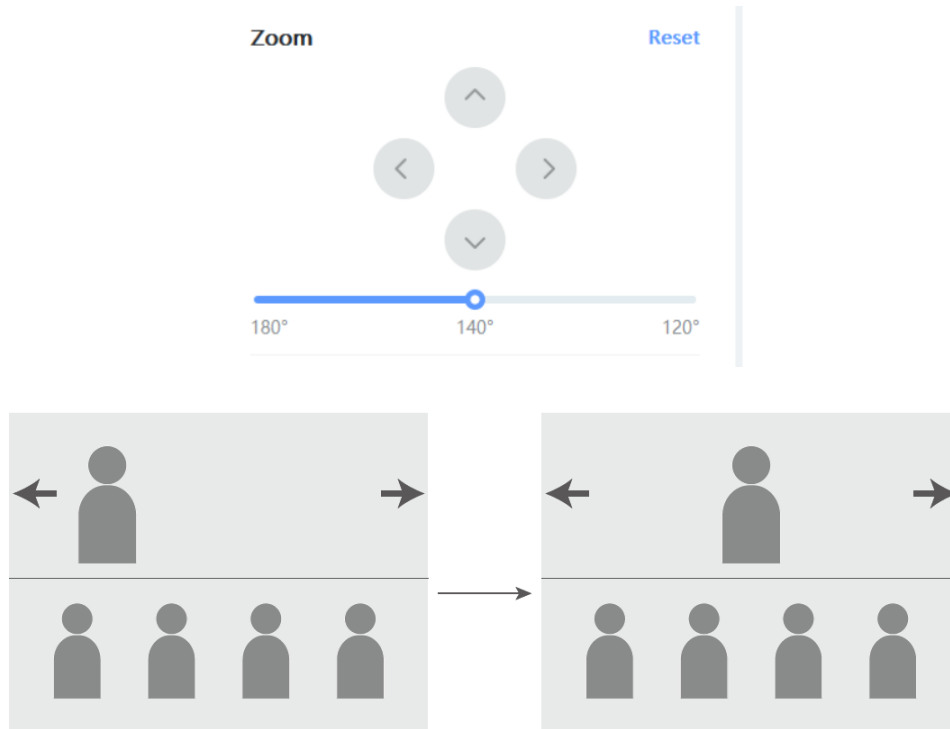

6. Panoramic frame

Each time you turn on the capsule, a panoramic view of the room will be captured by the camera and appear on the screen. You can check or uncheck this button to turn it on or off.

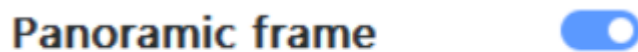

7. Sensitivity modulation

This button can adjust the capture speed of the device, which can be divided into three sensitivities: low, medium, and high. If you choose high, the device will capture the voice and video of the presenter more quickly.

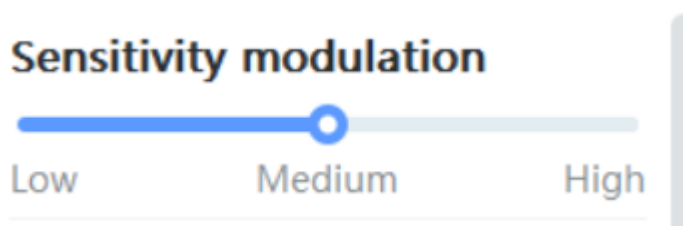

8. Auto white balance

In the customize mode, you can click the “Auto” button to open or close the white balance auto adjustment function.

When the auto button shows blue, the white balance of the image will be adjusted automatically.

When the auto button shows grey, you can adjust the white balance according to your needs.

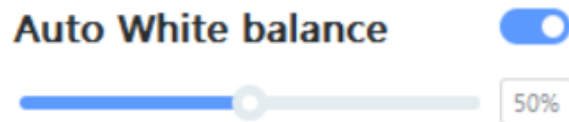

9. Image

you can drag the slider to adjust the image parameters like brightness, contrast, sharpness, and saturation according to your needs.

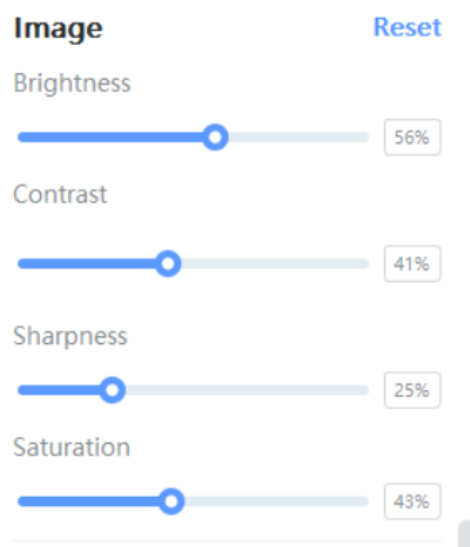

10. Image flip

The image of this device supports flip horizontal or vertical.

Check the “Flip Horizontal” button to validate the horizontal flip of the image.

Check the “Flip Vertical” button to validate the vertical flip of the image.

Image flip

Flip Horizontal

Flip Vertical

11. Angle initial position

This function allows you to adjust the panorama frame at the bottom of the screen. You can control the display center of the panorama frame through eMeetlink.

Click Reset to return to the initial location of the G1 panorama.

Angle initial position [Reset](#)



12. Restore default settings

After restoring default settings, all operating settings will be restored to the factory mode.

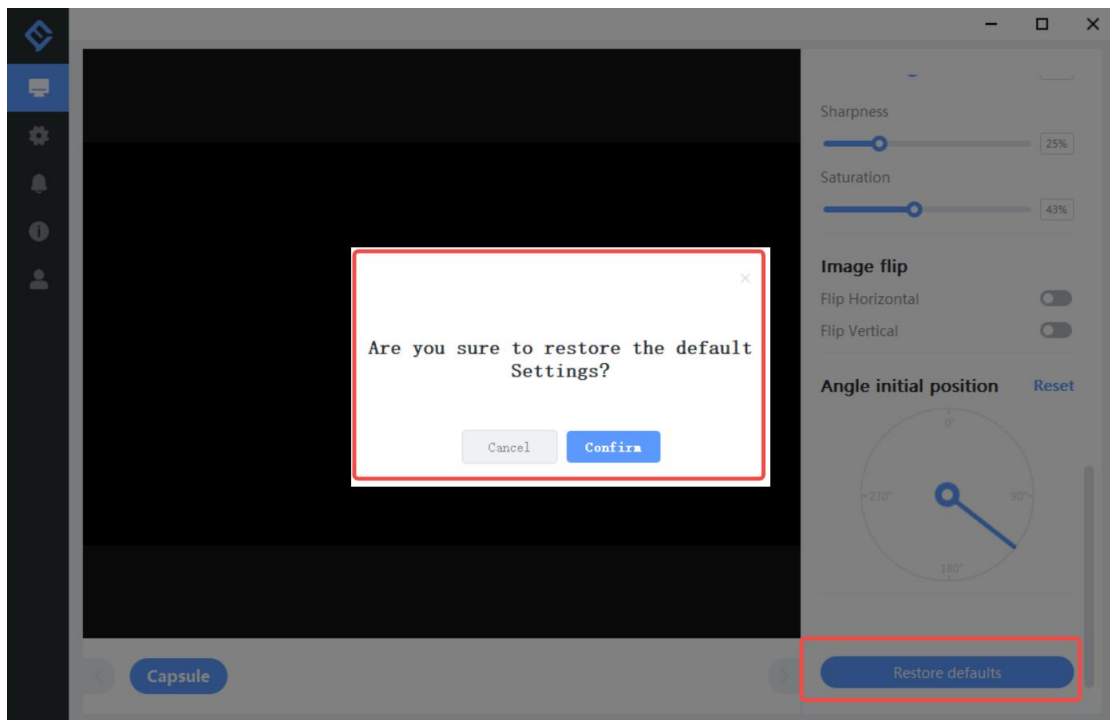

Settings

In this setting interface, you can change the language according to your need. Check your eMeetLink software version and update it.

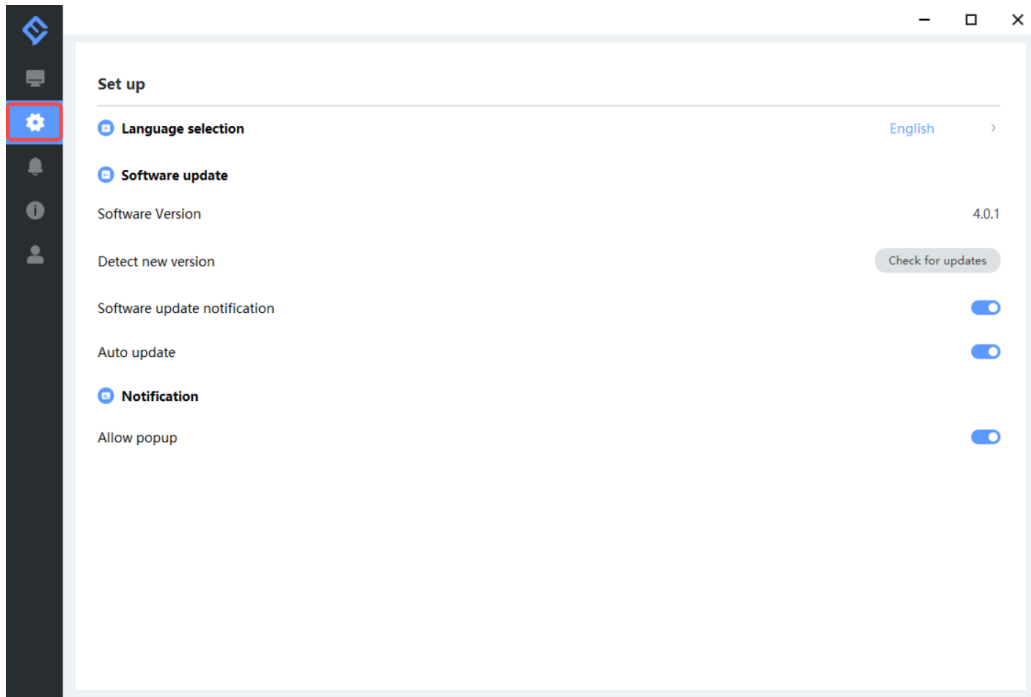

Support

1. Feedback

Write your feedback here to get EMEET customer service support.

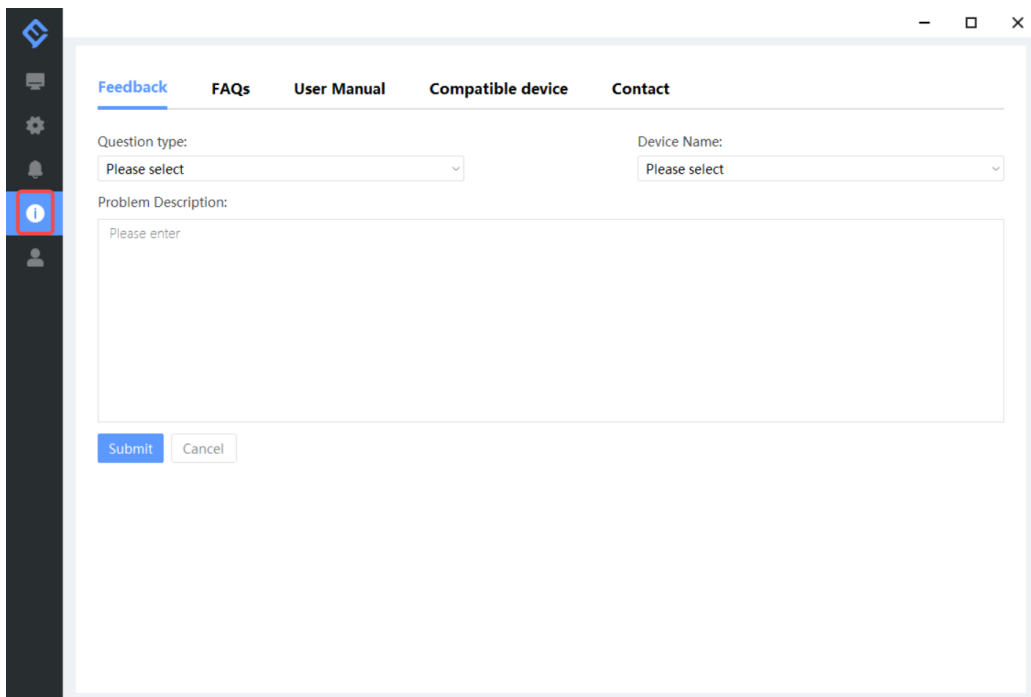

2. FAQs

There are some common questions for your reference.

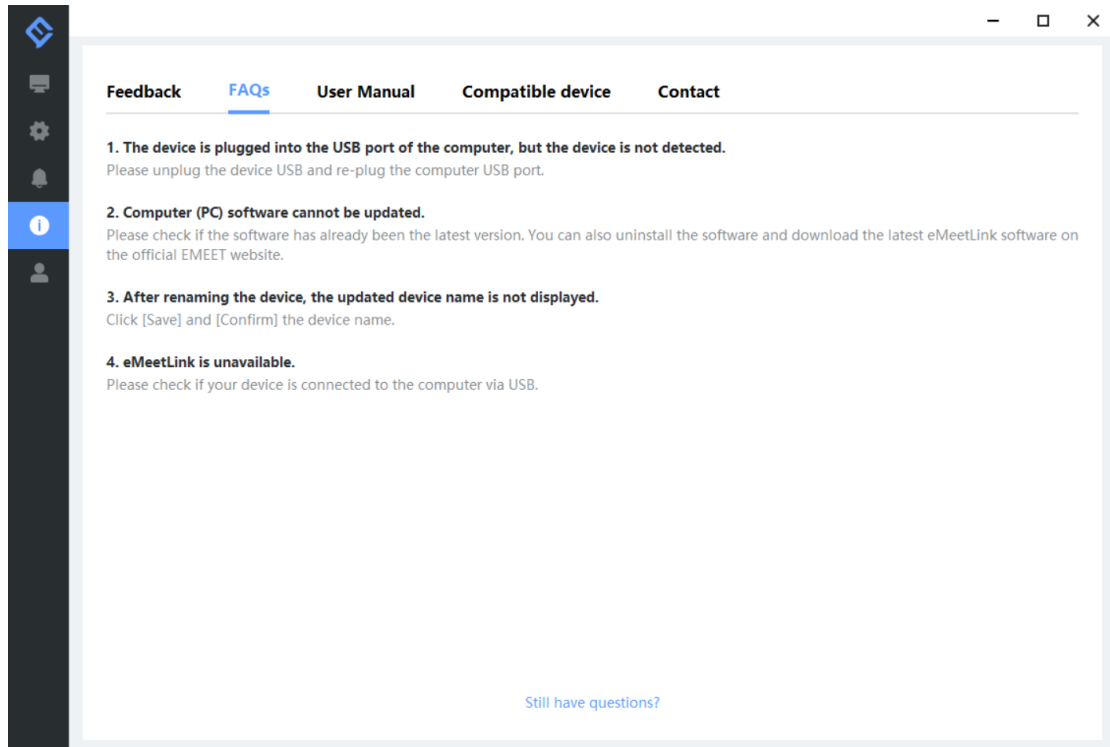

3. User manual

Click the device to enter EMEET's official website and get the user manual.

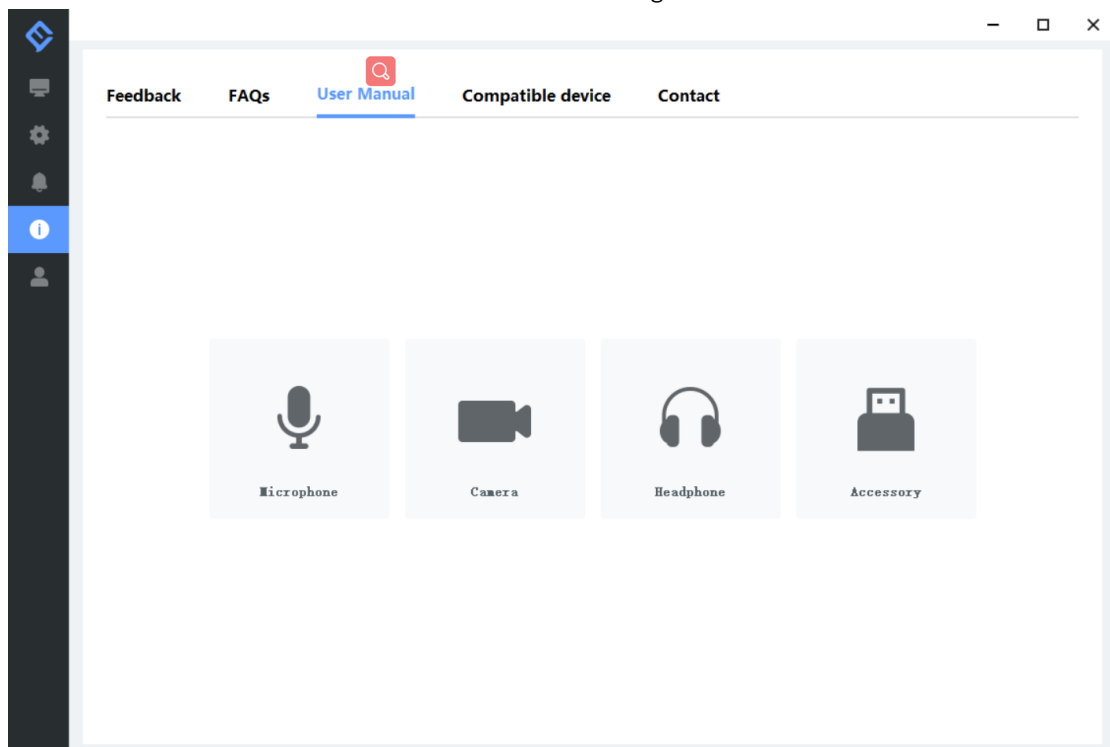

4. Compatible device

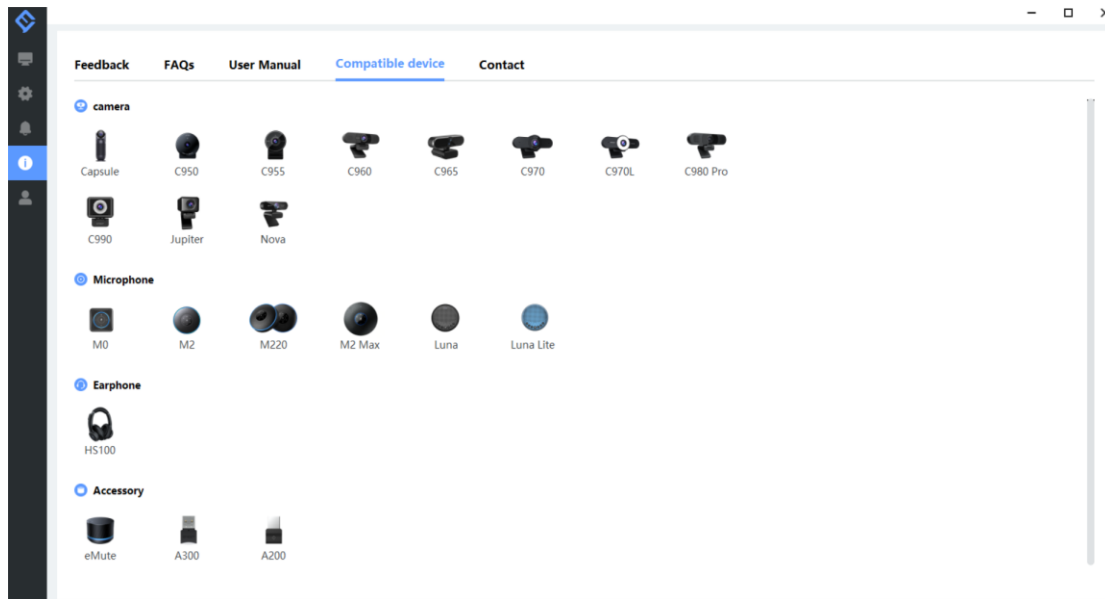

5. Contact info

