

# FRAMED MIRROR



## RECTANGLE

SKU: F1MR2436MB/WT

F1MR3036MB/WT

F1MR4836MB/WT

Colors/Finishes: Matte Black(MB),White(WT)

Nominal Dimension:24W\*1.5D\*36H inches

30W\*1.5D\*36H inches

48W\*1.5D\*36H inches

## FEATURES:

- Durable aluminum frame
- Modern sloping edge design
- Mirror hangs vertically or horizontally
- Long lasting color finish

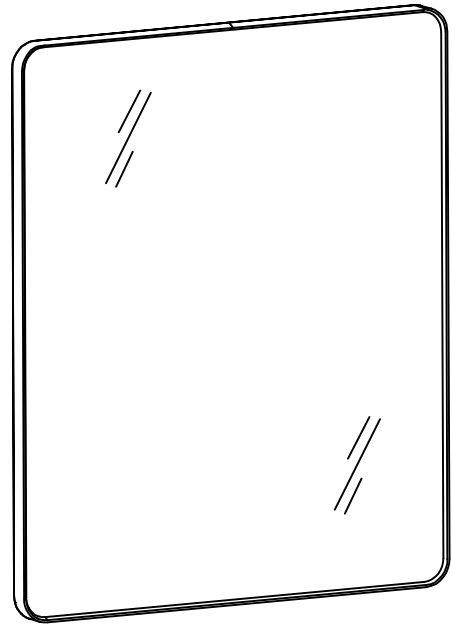

## PRODUCT DIAGRAMS:

Vertical Assembly

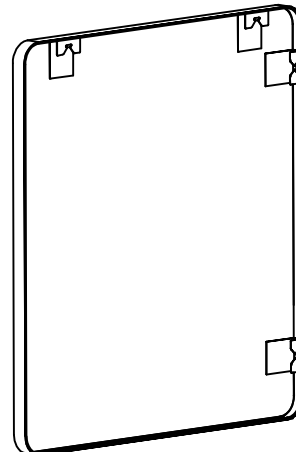
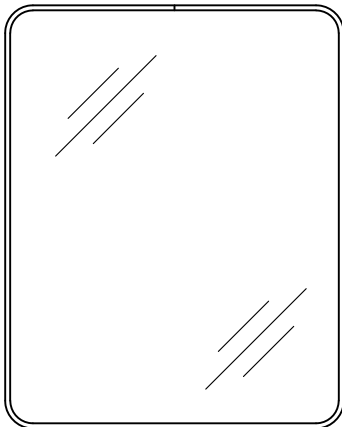

Horizontal Assembly

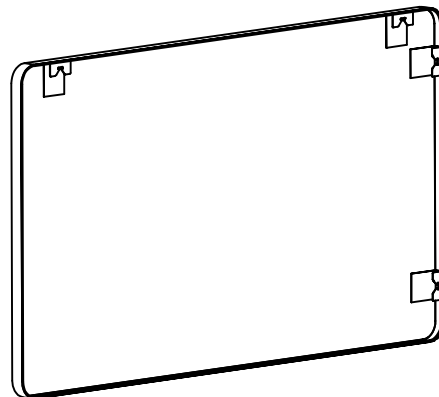
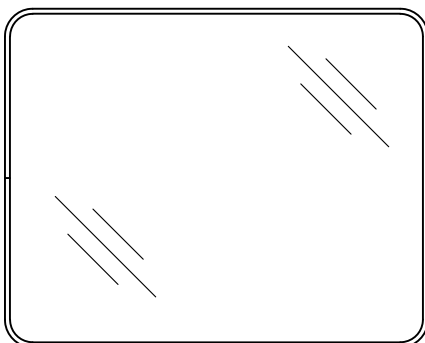

All dimensions and specifications are nominal and may vary. Use actual products for accuracy in critical situations.

# Mirror Installation

## SUGGESTED TOOLS AND MATERIALS



Screwdriver



Level



Drill



Tape Measure

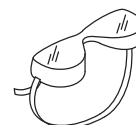

Safety Glasses

## PARTS

①

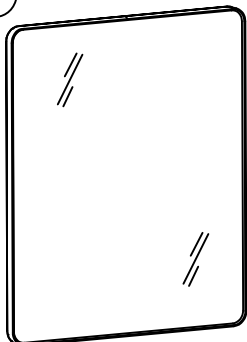

MIRROR(1 PCS)

②

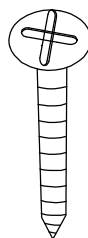

M5\*50(2 PCS)

③

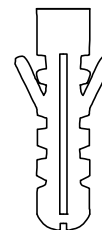

WALL PLUG(2 PCS)

## INSTALLATION INSTRUCTIONS

### STEP 1

Select the desired position of the mirror. Level and mark the location.

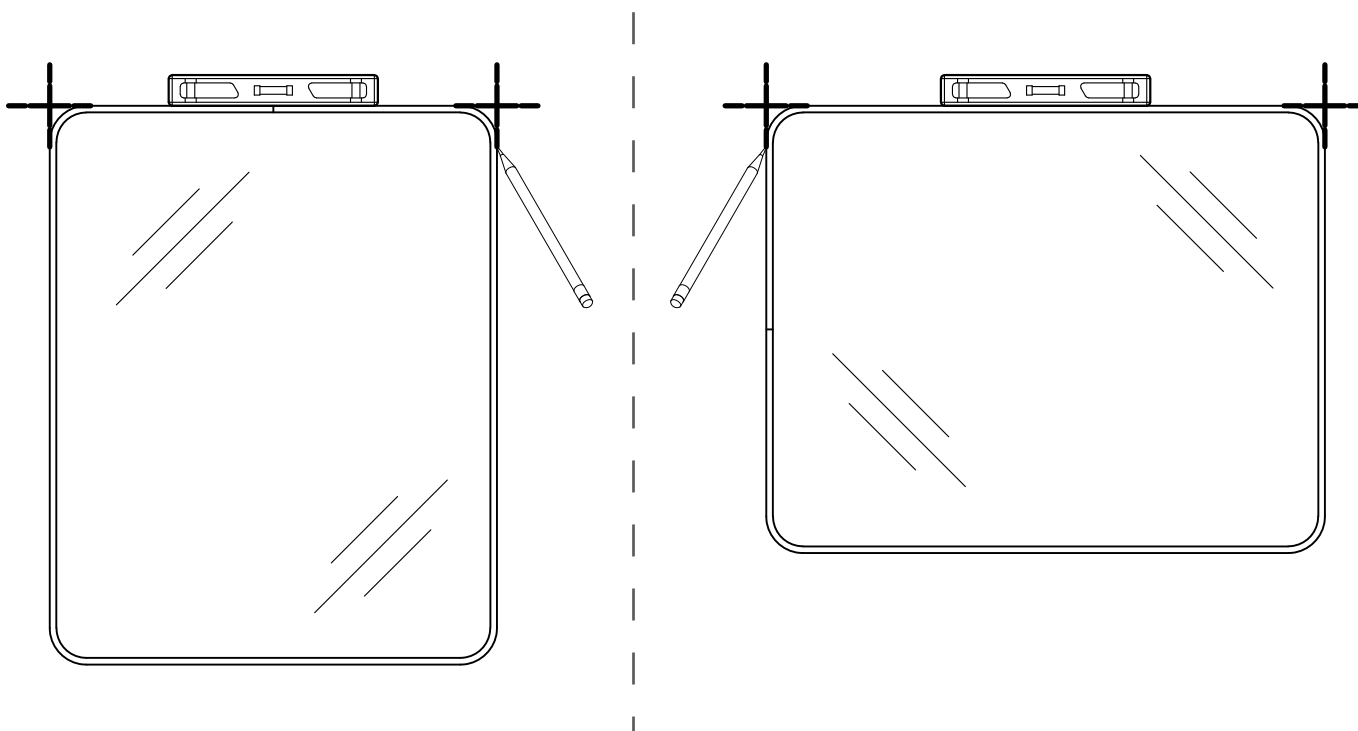

## STEP 2

Mark the drilling locations and ensure marking are leveled, based on vertical or horizontal mounting. See chart below.

Vertical Assembly (A)	Horizontal Assembly (A)
5.9"	5.9"

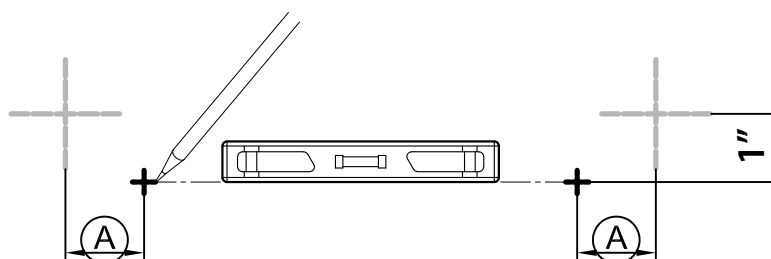

(A) = 5.9" for vertical  
5.9" for horizontal

## STEP 3

3.1 Drill holes about 2" deep at each of the marked locations.

3.2 Insert wall plugs (3).

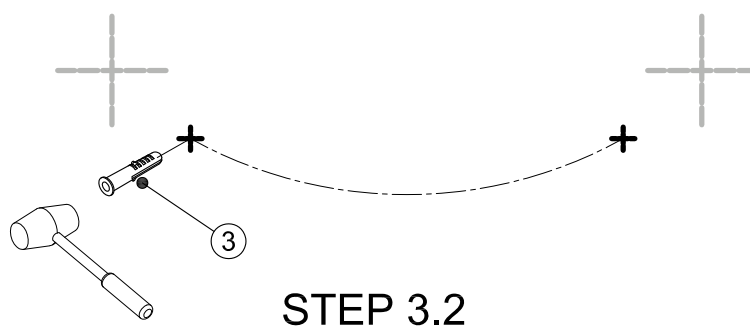
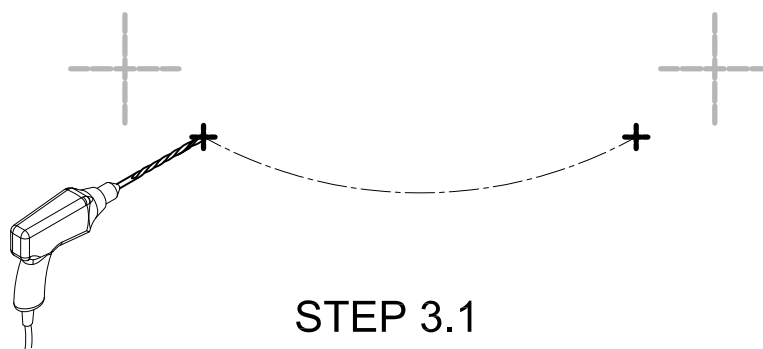

## STEP 4

Install Screw ② . Leave a gap of 1/4" between the head of the screw and the wall.

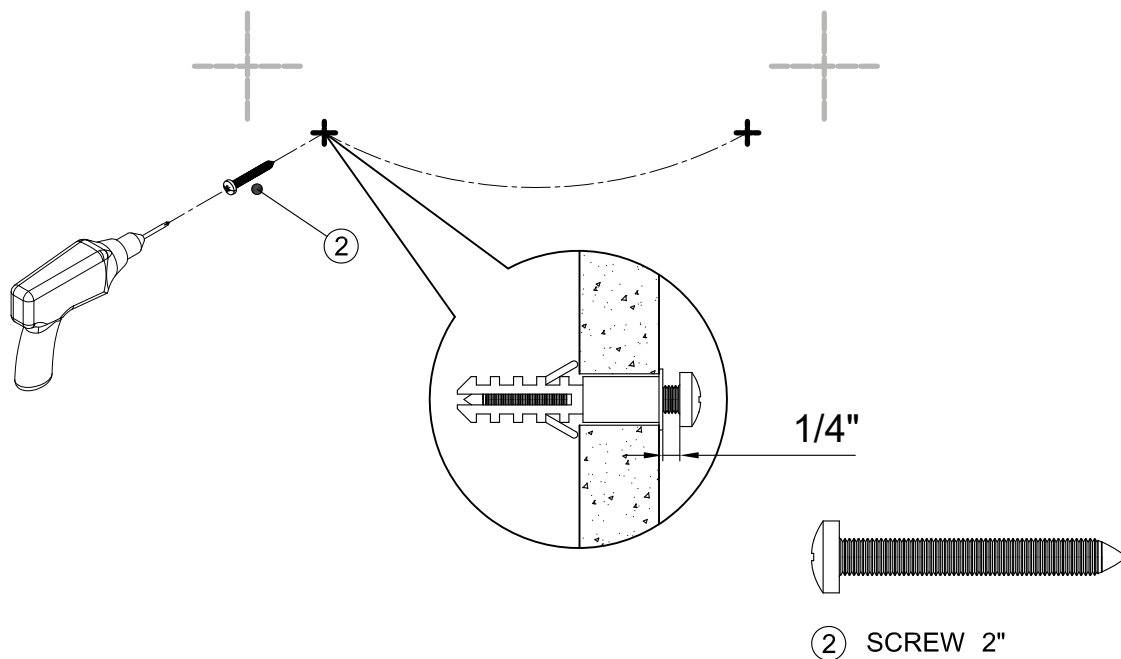

## STEP 5

place the mirror against the wall and slide it down, as shown in Figure 2.

