



RACING®

THANK YOU

It's more than just the ride itself. It's a rehash of the day's events with a group of close riding buddies. It's all the good times had, recalled around the light of a campfire. It's the first tracks at first light after a long winter's rest. It's the fire that burns within, seemingly impossible to extinguish, that yearns for the next time we can be out there. It's the reason we wake up early and work hard five days a week; in the gym, on the track, or on the trail. Our reason for being. Won't you join us?

FLY RACING CREW

CONSTRUCTION

FLY Racing helmets are constructed using only quality materials. Every model we produce has been hand crafted to fit and function at the top of its category. To ensure a long-lasting finish, we use multiple layers of paint with a super-hard UV treated clear coat. Our paint bonds to the helmet shell to provide a durable long-lasting finish. Inside every FLY Racing helmet, we use plush hypo-allergenic liners that are not only very comfortable, but also durable. Every helmet chinstrap is attached with high-strength stainless-steel rivets and is secured with a fastening system. We implement premium removeable liner systems so keeping a fresh clean liner can be a simple task. Our helmet graphics are premium in style and quality on every model. All designs are developed in the USA and created by the top designers in the industry.

HELMET FIT

PROPER FIT

A proper fitting helmet is essential for the proper function of the motorcycle helmet. Please refer to the following sizing guide and tables to determine the most suitable helmet size for your head.

MEASURE YOUR HEAD

Determine the circumference of the widest part of your head by using a flexible tape measure. Generally, the widest part of a person's head is the area 2.5cm (1") above the eyebrows and ears. However, we suggest measuring a few spots above and below that area to determine the greatest measurement before referring to our size tables.

To help determine the starting point of what size helmet you should purchase, see the following chart:

SIZE CHART

SIZE	YS	YM	YL	XS	S	M	L	X	2X	3X
U.S. HAT SIZE	5 7/8 - 6	6 1/8 - 6 1/4	6 3/8 - 6 1/2	6 5/8 - 6 3/4	6 7/8 - 7	7 1/8 - 7 1/4	7 3/8 - 7 1/2	7 5/8 - 7 3/4	7 7/8 - 8	8 1/8 - 8 1/4
INCHES	18.25-19.00	19.00-19.75	19.75-20.5	20.50-21.25	21.25-22.00	22.00-23.00	23.00-23.75	24.00-24.50	24.50-25.25	25.25-26.00
CM	47-48	49-50	51-52	53-54	55-56	57-58	59-60	61-62	63-64	65-66

On most helmets, the interior is designed to be a little extra snug at first, but will break-in after several hours of riding to match the particular shape of your head. It is recommended to be professionally fit by a dealership accessory salesperson at an authorized retail location. As a rule, the helmet should not be able to move around on your head without pulling on your skin. A loose-fitting helmet is very dangerous and may also be noisy and tiring to wear. Most people make the mistake of buying a helmet that's too large. **IMPORTANT:** Make sure that you fasten the chinstrap securely beneath your chin **when trying on a helmet** and that the helmet cannot be removed from your head when fastened in that manner.

CHINSTRAP

One of the most important aspects of helmet function is the chinstrap being securely fastened while the helmet is in use. If the chinstrap is not securely fastened and snug, it may allow the helmet to come off during an accident or fall, **resulting in injury or death**. Do not use helmet if it can be rolled off the head while the chinstrap is fastened. Do not use a chin cup or wear the strap at the end of the chin. The chinstrap must be worn in the proper position to maximize protection. Chinstrap proper position is: chinstrap placed under your chin closest to your throat. To securely fasten the chinstrap, do the following:

- 1) Thread the end of the strap through both D Rings and pull tight. (see Fig. 1)
- 2) Spread D-rings apart and loop strap end back through the gap and under first ring. (see Fig. 2)
- 3) Pull strap snug. (see Fig. 3)
- 4) Secure excess strap length with snap. (see Fig. 4)

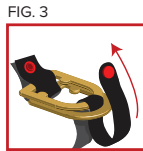
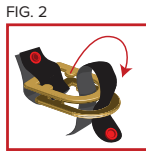
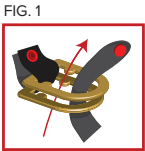

MAKE THE RIGHT DECISION

Most retail stores will not exchange purchased helmets if they've been worn for any length of time. So, take your time, and wear the helmet inside the store for several minutes. Not every brand of helmet can fit every head size and shape.

WEAR THE HELMET

Always wear the helmet in the correct position. (see Fig. 1) Always fasten the chinstrap securely to retain the helmet in the proper position on your head. Not wearing the helmet in the correct position, and not properly securing the chinstrap snugly, can result in **severe head injury or even death**. Helmets must fit snugly, but not painfully tight. While holding the chinstraps outside of the helmet, pull it down over your head, taking care that the chinstraps do not go up inside the helmet. A proper fitting helmet will feel snug and have consistent pressure around the circumference of your head as well as throughout the crown/top of your head. **Always fasten chinstrap snugly before riding.**

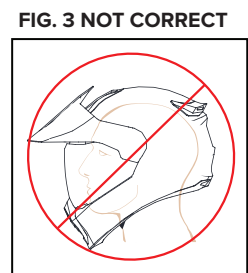
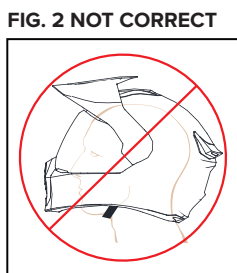
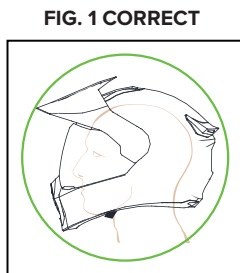

HELMET CARE

GENERAL CARE

Keep your helmet in a secure place when not riding. Be aware that pets are attracted to the accumulated salt from perspiration and may be tempted to chew on the helmet liner. If the helmet won't be used for a long period of time, we suggest that you follow the steps in the care and cleaning section and store your helmet in a cool dry place away from harsh chemicals or solvents. Keep helmet away from fire or heat in excess of 122°F and do not set on or near hot surfaces.

YOUR HELMET MAY BE DAMAGED, POSSIBLY WITHOUT THE DAMAGE BEING VISIBLE, BY ANY OF (BUT NOT LIMITED TO) THE FOLLOWING:

- Exposure to fire or heat in excess of 122°F
- Gasoline, oil, petroleum-based fluids, and solvents
- Harsh or abrasive cleaning compounds
- Paints
- Adhesives, decals, and stickers
- Excessive UV exposure
- Crash
- Impact
- Dropping

CLEANING

The liner system in your new FLY Racing helmet has been designed for years of carefree and comfortable use. You may choose to remove the liner and wash it, or replace it for added freshness. If you choose to do so, please use the following instructions: For best results, we recommend washing the liner by hand and letting it air dry. Use a small amount of mild soap and warm water to clean the liner. Do not machine wash or dry. Gently work the soap into the liner and rinse out the liner using warm water. Remove odors by rinsing inner liner with a solution of bicarbonate soda (baking soda) and water. Do not wring or twist the liner to rid excess water, pat dry with a towel, or hang dry. Do not reinstall the liner until it is completely dry. Chemicals or bleaches used in many cleaners may harm the helmet, EPS, or comfort liner system, and are not recommended. To clean the visor, we recommend that you use mild soap and warm water, and dry with a soft cloth.

SHIELD CLEANING

The helmet shield is made of polycarbonate materials with a polyurethane abrasion resistance coating. It should be cleaned using a light solution of mild soap and warm water. Never use hot water, saltwater thinners, gasoline, or any harsh chemical agents. When deep scratches are visible, it is highly recommended the helmet shield be replaced. Tinted shields are for "Day Time Use Only" and are not suitable for use at night or in conditions of poor visibility.

VENT CLEANING

Dirt and debris can find their way into the vents of your helmet. Low-pressure compressed air can be used to blow the debris from the ventilation system. Take care not to use high pressure compressed air, as this may damage the ventilation components.

WARNING

No helmet can protect the wearer against all possible, foreseeable, or unforeseeable impacts. Nor is it possible to predict if a helmet will protect in any given accident or fall, which may result in severe head injury or even death to the wearer. The function of a helmet is to reduce the chance of severity of a head injury in an accident or fall. A helmet can only protect the portion of the head that is covered by the helmet and will not protect your neck, face, or spine from injury. The helmet must be properly fitted and fit snugly with the retention system "chinstrap" securely fastened and snug **before riding**. For adequate protection, this helmet must fit closely and be securely attached. Failure to follow these instructions, the instructions printed on the helmet, and those contained in this user's manual, may result in the possibility of the helmet coming off during an accident, possibly **resulting in severe head injury or even death**. While riding motorized vehicles and bicycles are fun, it can also be dangerous. Always wear eye protection when riding.

SAFETY

At FLY Racing, we encourage you to enjoy riding responsibly and to always ride within the limits of your abilities. FLY Racing recommends that you check your helmet for damage before every use. Do not use helmet if damaged. If you find cracks or damage to the helmet, stop using the helmet immediately. Be aware that some damage may be unseen. FLY Racing helmets are designed to absorb one impact. Even if the helmet appears to be undamaged, the helmet's inner EPS (Expanded PolyStyrene) liner may have been damaged and the helmet can no longer effectively absorb and disperse further impacts. (See Fig 1) Once this has happened, the helmet is no longer safe to use and must be destroyed. Even without a crash or impact, a helmet may wear out over time, depending on usage and the amount of care that it is given. It is recommended to replace a helmet after three years from the time of purchase, even if there is no visible damage. With hard or frequent use, this time may be reduced. Even with minimal use things like fire, heat, acid, oils in sweat, hair care products, pollution, solvents, cleaners, exposure to ultra violet rays, corrosive dirt or mud, etc. and mishandling affect a helmet.

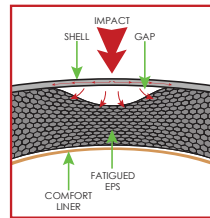

Fig. 1

Never modify your helmet. It is very dangerous to drill holes, cut the shell or liner, or modify the retention system (chinstrap). Never sand or paint the outside of the helmet. Any modifications to your helmet can seriously weaken the integrity of the helmet, rendering the helmet useless in an accident or fall, resulting in severe head injury or even death.

Before wearing your helmet, check your helmet for damage, tighten your visor screws, and do not use any items between your helmet and head. Plastic components and comfort liners may wear out over time, either replace damaged parts with genuine FLY Racing replacement parts or get a new helmet. Visors can fracture or break under impact or in an accident. Do not use a helmet with a fractured or broken visor. Do not hang or mount any rigid objects to the inside or outside of the helmet. Doing so can weaken the helmet or cause injuries to you in an accident, by increasing the force the inside or outside of the helmet. Doing so can weaken the helmet or cause injuries to you in an accident, by increasing the force on the helmet, or the object could become a projectile. Do not wear or purchase a used helmet. Never allow others to use your helmet. Your helmet **MUST** be properly fit, for safety. Your FLY racing helmet should fit snugly. Please refer to "Proper fit" instructions in this manual for more detailed info. **An improperly fitted helmet can result in severe head injury or even death in a fall or accident.**

All FLY Racing helmets are designed to be used in conjunction with eye protecting goggles or built-in face shields. FLY Racing helmets do not include goggles. It is your responsibility to obtain eye protection and use it. Always wear eye protection while riding. Helmets inherently limit vision. It is your responsibility to always check for adequate vision, especially your peripheral vision. Helmets reduce hearing. Be aware of your environment.

Ride responsibly and do not take extra risks because you are wearing a helmet. Always wear a helmet while riding your motorized vehicle or bicycle.

WARNING FOR PARENTS- This helmet should not be used by children while climbing or doing other activities when there is a risk of strangulation/hanging, should the child get trapped by the helmet.

- Never adjust your helmet accessories while riding. Only make adjustments when stopped.
- Never wear anything between your head and your helmet. This may reduce the effectiveness of your helmet.
- Never use insect repellent on or around your helmet. Insect repellent may damage your helmet's shield, shell, protective foam, or other components.
- Always wear eye protection. If you are not using a helmet with a face shield, always wear eye protection when riding.
- Always lock your face shield in place when riding.
- Always be alert for sounds. Your helmet may impair your hearing. However, your helmet is not a form of hearing protection.
- Check your face shield. If your race shield is scratched or damaged, it may reduce the visibility; replace if necessary. Always make sure you can see well enough to safely operate your motorcycle.

CONTACT INFORMATION

AMERICA

FLY RACING

601 E. GOWEN RD.

BOISE, ID 83716 | 208-376-8400

WORLD WIDE

To find a current distributor in your region or territory, please visit us online at FLYRACING.COM or contact the US office listed above.

If your helmet bears a CPSC designation, it meets the standard safety requirements of the Consumer Product Safety Commission. **CPSC 1203** – Safety Standard for Bicycle Helmets for Persons Age 5 and Older.

If your helmet bears a CE designation, it meets the EN 1078 safety requirements of the European Committee for Standardization. **CE EN1078:2012 + A1:2012** – Helmet for pedal cyclists, skateboarders or roller skaters.

If your helmet bears the AS/NZ designation, it meets the AS/NZ 2063 safety requirements of the Council of Standards Australia and the Council of Standards New Zealand.

If your helmet bears an ASTM designation, it meets the standard safety requirements of the American Society for Testing and Materials. **ASTM F1952-15** – For downhill mountain bicycle racing.

NOTIFIED BODY:

SP SWEDISH NATIONAL TESTING AND RESEARCH INSTITUTE

Box 857

SE-501 15 Boras

Sverige

Notified Body No. 0402

IDIADA AUTOMOTIVE TECHNOLOGY

L'Albornar E-43710-Santa

Olive (Tarragonna) Spain

Notified Body No. 0164

KEY FEATURES

- A. HIGH FLOW PEAK VISOR DESIGN
- B. DROP DOWN HIDDEN SUN SHIELD
- C. ROTATING CHIN BAR SYSTEM
- D. TRUE FUNCTION VENTILATION
- E. QWICK-DRY™ COMFORT LINER SYSTEM
- F. PREMIUM ANTIFOG FACE SHIELD
- G. 3D CHEEK PADS FOR MAXIMUM COMFORT

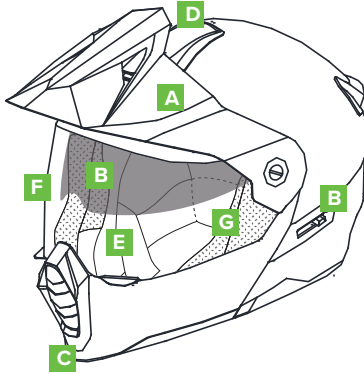

1. To open the chin bar, place your thumb under the front center release button, located on the underside of the chin bar.
2. While pulling down on the release button, the chin bar should release, and can be moved into the open position.
3. To close the chin bar, grasp the front and rotate the chin bar down into the fully closed position.
4. There will be a very audible “click” when the chin bar is engaged into both receivers, as it goes into the locked, fully closed position.

IMPORTANT: To ensure the chin bar is in the locked position, be sure to listen for the audible “click” sound. Then, grasp the chin bar—fully and on both sides—and attempt to move the chin bar to ensure both left and right sides are fully engaged into the receivers. Never ride with the chin bar in the raised or open position. Do not operate the chin bar while riding.

VENT FUNCTION

MOUTH VENT

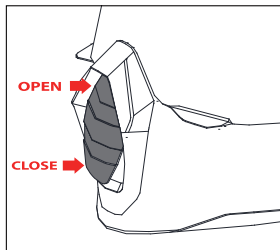

TOP VENT

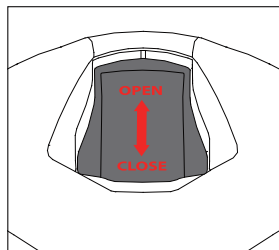

Vents can be operated by placing your finger or hand on the vent, while pressing or sliding the vent open or closed accordingly.

REMOVING THE VISOR

1. This helmet comes with optional side plate covers, which allow you to use the helmet without the visor.
2. To configure your helmet without the visor, you must install the side plates or the shield will not function properly.
3. The side plates can be reinstated by carefully removing the side screws, using a coin or large flat blade screwdriver, and replacing the visor with the side plates. Then, reinstalling the side screws, being careful not to overtighten.

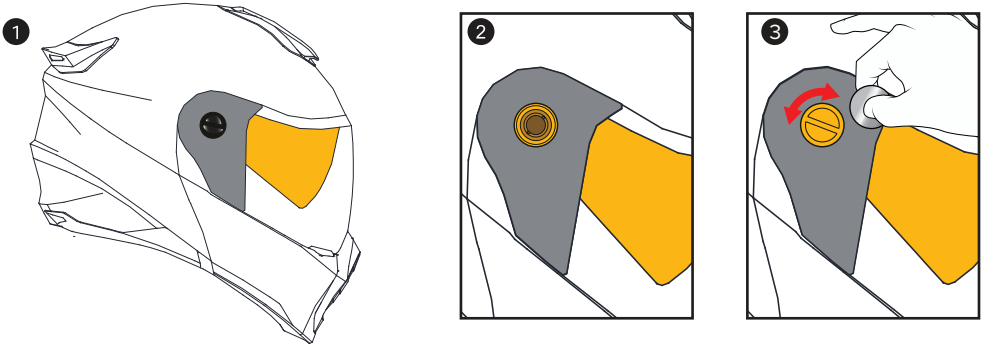

REMOVING THE VISOR

VISOR REMOVAL

1. Carefully unscrew the visor side screws, using a coin or large flat blade screwdriver, taking care as to not damage the screw head.
2. The visor will automatically release from the helmet.

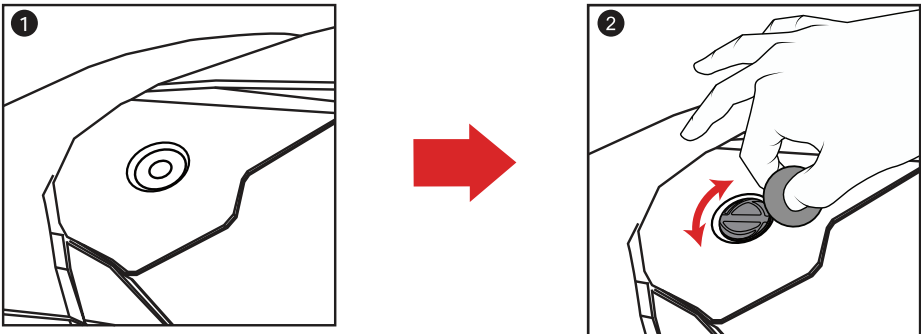

REMOVING OR INSTALLING THE SHIELD

SHIELD REMOVAL

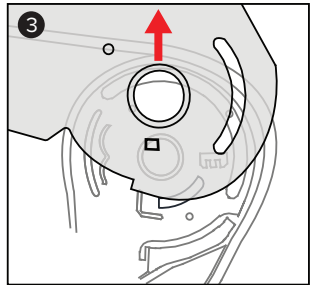
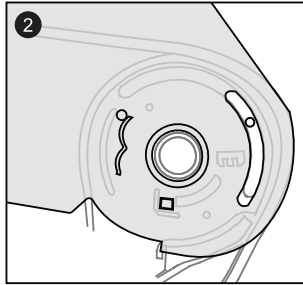
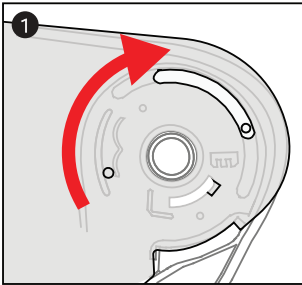

1. Open the shield into the fully opened position without forcing it.
2. Pull shield outward from the ratcheting plate.
3. The shield will automatically release.

SHIELD INSTALLATION

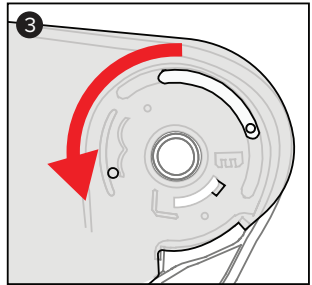
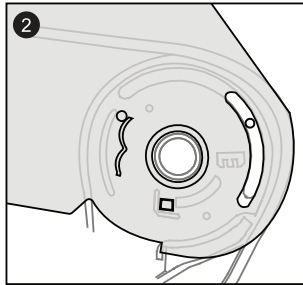
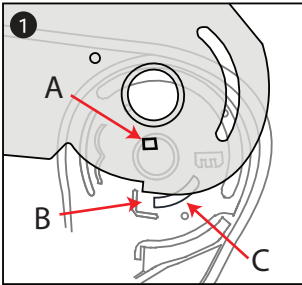

1. With the visor in the fully opened position, place slight pressure on the side of the shield, pressing the shield toward the ratchet plate. With pressure applied, rotate the shield slightly past the fully opened position, allowing the square tab on the shield to snap into the guide. Make sure that all pins are aligned into the correct points on the ratchet plate.
2. Reinstall the visor, or side plates and side screws.
3. Tighten side screws using a coin or large flat blade screwdriver, being careful not to overtighten the screws.

SUN VISOR

FUNCTION

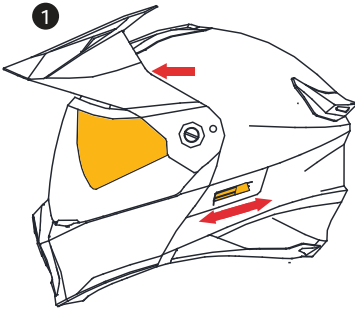

REMOVE

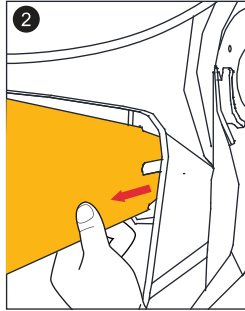

INSTALL

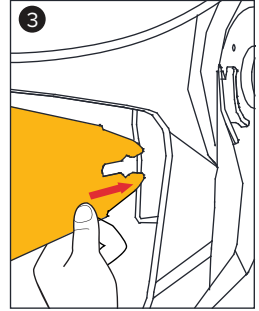

1. The sun shield can be operated by sliding the side lever back, to drop the sun shield down for use, and by sliding the lever forward toward the front of the helmet, to raise the sun shield.
2. To remove the sun shield, slide the lever back to drop the sun shield down. While firmly grasping the edge of the shield, pull the shield directly straight away from the helmet, which will release it from the mechanism.
3. To install the sun shield, firmly grasp the edge of the shield, and align the shield tabs with the mechanism slot. Firmly press the shield back into the helmet, until it is fully engaged.

CHEEK PADS

CHEEK PAD REMOVAL

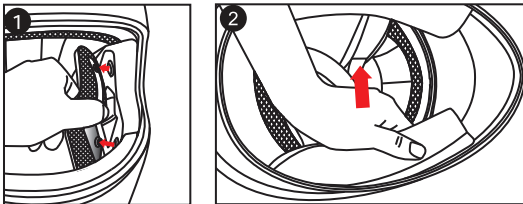

1. Gently pull the cheek pad inward, away from the helmet shell, releasing the snaps. There are three snaps securing each cheek pad in place.

2. Pull the cheek pad fully out of the helmet by sliding the plastic part of the liner out of the helmet shell. The pad will now be separated from the helmet. Repeat on other side.

CHEEK PAD INSTALLATION

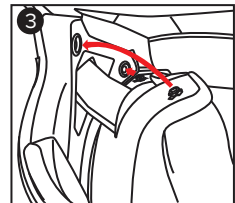
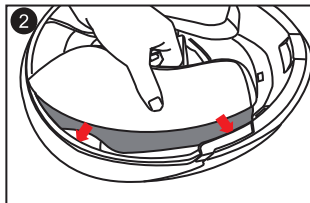
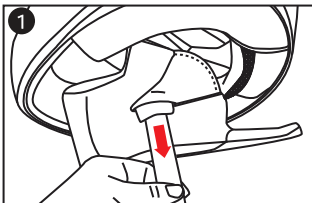

1. Hold the cheek pad for the corresponding side, with the snaps facing the helmet shell. Feed the helmet strap through the hole in the center of the cheek pad.
2. Feed the plastic edge of the cheek pad into the space between the foam material (EPS) and the helmet shell. Plastic will be covered by the rubber edge of the helmet.
3. Align each of the snaps and press down on the cheek pad over each of the three snaps to secure the pad into place.

LINER

CROWN PAD REMOVAL

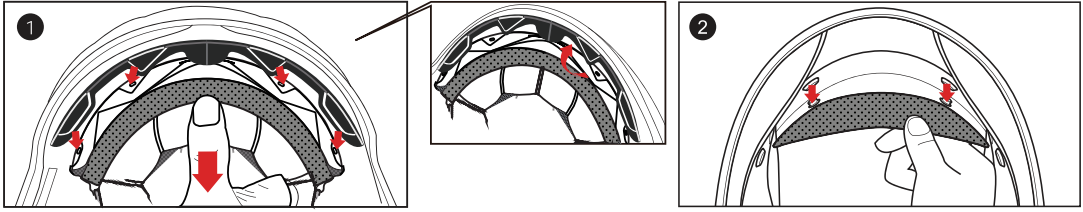

1. Grab the liner in the forehead area, then pull away from the helmet. The rubber edging will separate from the rubber piece attached to the helmet.
2. At the back of the helmet, pull liner away from helmet, unsnapping the two snaps. The liner can now be completely removed from the helmet.

CROWN PAD INSTALLATION

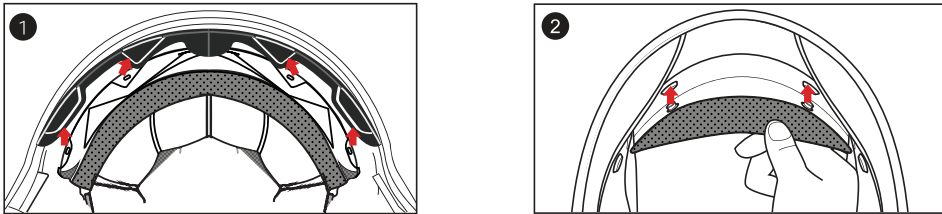

1. At the front of the helmet, align the rubber edge and tabs of the liner with the rubber edge of the helmet. The tabs on the liner will slide under the tabs on the helmet. Weave the edges together to lock into place.
2. At the back of the helmet, align the two snaps from the liner with the snaps on the helmet. Push snaps together until they are secure.

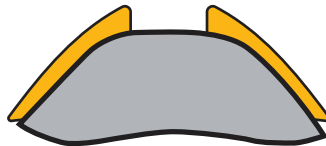
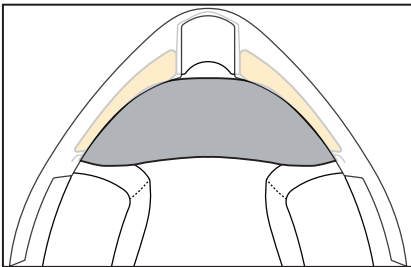

CHIN CURTAIN INSTALLATION AND REMOVAL

1. The chin curtain can easily be removed by gently pulling it away from the chin bar, in an outward motion, and working from side to side.
2. To install the chin curtain, align the plastic portion into the slot between the helmet shell and the interior plastic chin bar structure. Work/press the plastic portion of the chin curtain into the slot, until it is flush and straight.



RACING®