

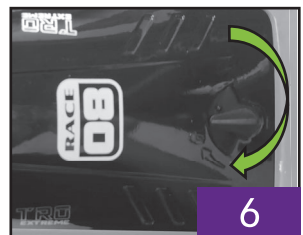

SETTING UP THE WAVE SLICER

1. Turn the latch on the battery cover to open.
2. Place the provided LiPo battery in the battery holder, and push down to secure.
3. Connect the battery wires to the boat power wires.
4. Connect the battery wires to the boat power wires.
5. Replace the battery cover.
6. Turn the latch to secure the cover.

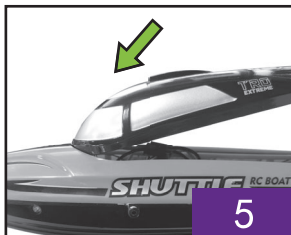
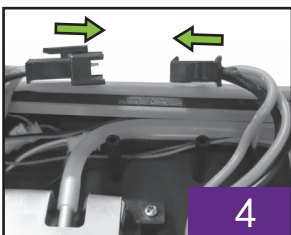
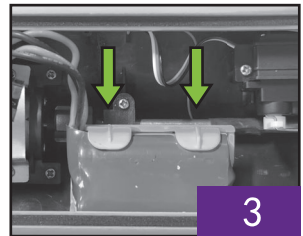
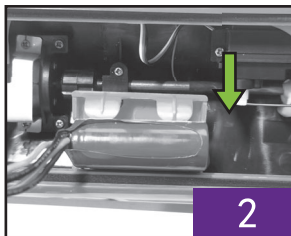
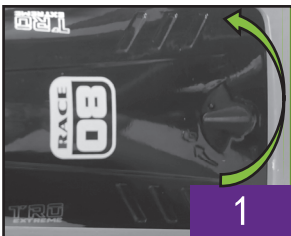

SETTING UP THE REMOTE CONTROL

1. Locate the battery compartment on the base of the remote control and slide the cover to open.
2. Install 4xAA batteries in the compartment taking care to match the correct polarity (+/-).
3. Slide the battery cover back into place.

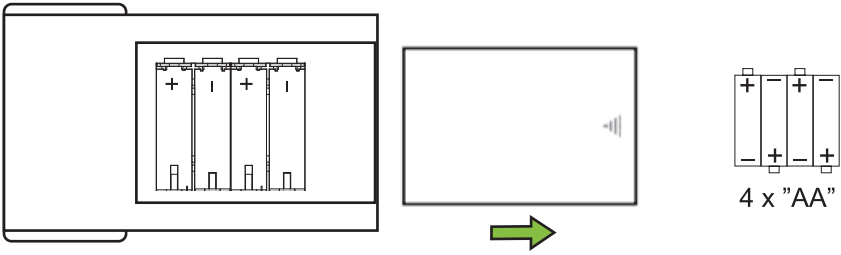

USING THE WAVE SLICER

- Step 1: Place the Wave Slicer in the water. The boat will automatically sense the water and turn the power on. The boat's LEDs will begin to flash.
- Step 2: Turn on the controller. The boat and controller will automatically pair. Once pairing is complete the boat's LEDs will be steady, and beep once.
- Step 3: You can now drive the Wave Slicer. When Wave Slicer's power is low the remote control will beep. Bring the Wave Slicer back to land immediately and recharge the battery.

Controller Functions

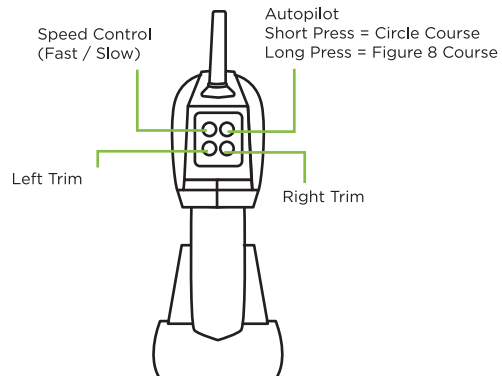
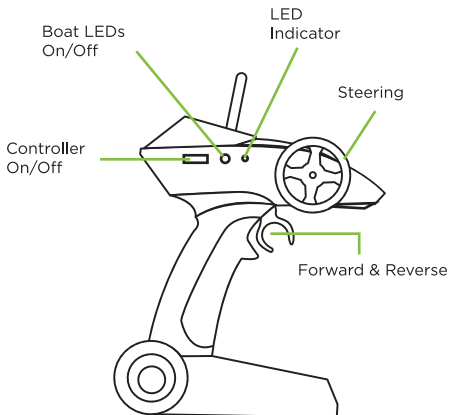

Wave Slicer Movement

Forward

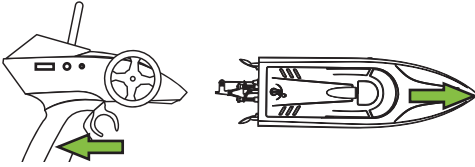

Reverse

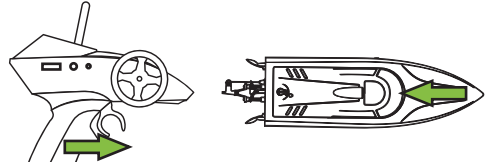

Turn Left

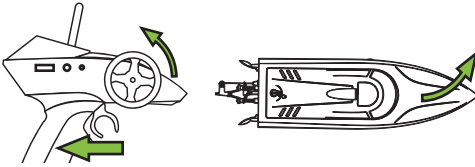

Turn Right

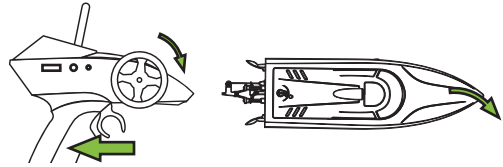

Reverse & Turn Left

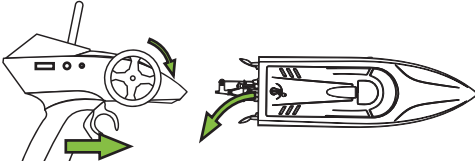

Reverse & Turn Right

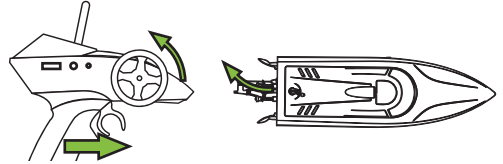

CHARGING THE WAVE SLICER

If the Wave Slicer will not power on when placed in water, or the remote controller beeps. The Wave Slicer's battery will need to be charged.

To charge open the battery cover on the Wave Slicer and disconnect the battery.

Connect one end of the supplied USB charging cord to the battery and the other to a Class 2 USB charging adapter, such as a phone charger or laptop.

The USB plug on the charger will light up red to indicate charging. When the light goes off the battery is fully charged.

Tip. Full charging takes approximately 120 minutes.

Do not leave charger unattended.



ADJUSTING THE TRIM

If during calm water conditions when moving forwards, your Wave Slicer steers to the left or the right without any steering input from the controller you can adjust the trim settings to keep the boat moving straight.

If the Wave Slicer consistently steers LEFT

Drive the Wave Slicer forward with no steering input.

Press the “Right Trim” button repeatedly until the Wave Slicer stops steering left, and travels straight.

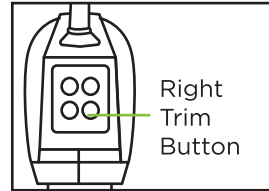

If the Wave Slicer consistently steers RIGHT

Drive the Wave Slicer forward with no steering input.

Press the “Left Trim” button repeatedly until the Wave Slicer stops steering left, and travels straight.

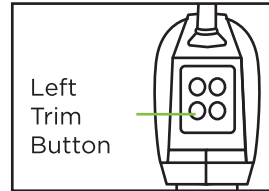

AUTOPILOT MODE

The Wave Slicer can drive on autopilot. Before using this mode make sure the Wave Slicer is in clear water free of any obstacles.

To make the Wave Slicer drive in circles short press the “Autopilot” button. The boat will automatically drive off and start driving in circles. To cancel press any control button.

To make the Wave Slicer drive in figure 8 loops long press the “Autopilot” button for 3 seconds. The boat will automatically drive off and start driving in circles. To cancel press any control button.

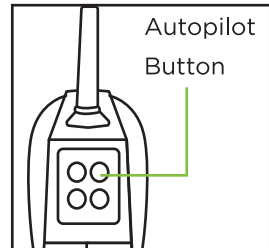

SPEED SETTINGS

The Wave Slicer has two speed settings, Fast and Slow. To change between the speed settings press the “Speed Control” button. The controller beeps once for Slow Speed, and twice for Fast Speed.

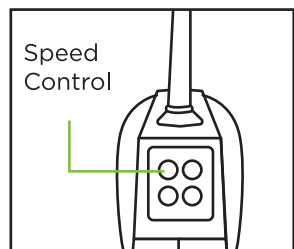

CAUTIONS & WARNINGS

- Suitable for ages 8 and up. Adult supervision is always recommended.
- This product contains small parts which are a choking hazard. Keep away from small children.
- Manufacturers and dealers disclaim all responsibility for damage caused by misuse.
- Keep hair and loose clothing away from the Wave Slicer when powered on.
- If Wave Slicer will be stored and unused for an extended period of time, please remove the batteries.
- Check the batteries regularly for potential leakage or corrosion that may occur.
- When installing the batteries carefully follow the polarity marking +/-.
- Do not mix different battery types.
- Remove exhausted or drained batteries.
- The Wave Slicer's motor can become hot during operation. Use caution after extended use.
- Be aware of your surroundings when you are using the Wave Slicer, and make sure you can retrieve the boat quickly once the low power warning is activated.

CARE & MAINTENANCE

- Do not submerge the unit in any liquids.
- Keep the unit dry.
- Do not place the unit near powerful, un-shielded magnets.
- Do not expose the unit to extreme hot or cold temperatures.
- Do not hit, drop, or smash the unit with extreme force.
- Do not disassemble the unit for any reason.

NOT FOLLOWING THESE PRECAUTIONS WILL VOID YOUR WARRANTY.



For Customer Service please email:
Care@OdysseyToys.com

Please note the units model number and name in your email:
Model no. ODY-1026 • Wave Slicer



Please do not return this product to the store.

For questions or assistance on installation, parts or operation contact: Odyssey Toys at 1-(305)-933-4480.
Hours of operation: 10:00am - 5:00pm EST
Email: Care@OdysseyToys.com
or visit us online at: www.odysseytoys.com/support

60 DAY LIMITED WARRANTY

Odyssey Marketing/ Odyssey Toys warrants to the original purchaser when used in the United States only, that this product shall be free of defects in material and workmanship. This warranty applies within 60 days of the original purchase date with normal home use. This warranty does not apply for commercial use of this product. Use outside of United States is not covered by this warranty. During the warranty period, we will at our discretion, repair or replace this product without charge, as long as the product has not been abused or mishandled as by our determination. Our determination shall be final and be the consumer's sole remedy. ALL RETURNS must be accompanied by a Return Authorization Number which is issued by Odyssey Marketing's Customer Service Department.

Please contact Customer Service BEFORE returning any products or parts thereof. Once you have obtained a Return Authorization Number you will be provided a return address within the Customer Service email.

This warranty does not cover installation, adjustments in the home, nor damage due to accidents, misuse, abuse, fire, or any acts of God, incorrect line voltage, damage to other equipment caused by improper installation, unauthorized or improper modifications. This warranty gives you specific legal rights and you may also have other rights that vary from state to state.

**** THIS WARRANTY IS EXPRESSLY IN LIEU OF ALL OTHER WARRANTIES. EXPRESSED OR IMPLIED INCLUDING THE WARRANTIES OF MERCHANTABILITY AND FITNESS.** ©2021 Odyssey Marketing Corp.**

FCC STATEMENT: This product complies with Part 15 of the FCC Rules. Operation is subject to the following two conditions: (1) This device may not cause harmful interference and (2) this device must accept any interference receiver, including interference that may cause undesirable operation.

MADE IN CHINA

