

SETTING UP THE ROBOT

1. Turn off the power switch.
2. Use a phillips screwdriver to open the battery cover.
3. Install 3x new AAA batteries taking care to match the correct polarity (+/-).
4. Close the battery compartment, reinstall the screw, and switch the power switch to ON.

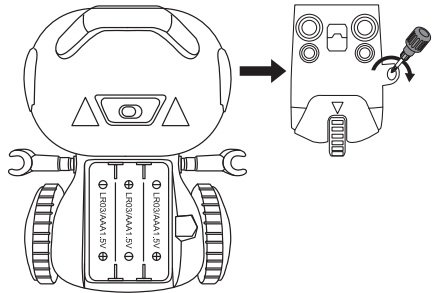

SETTING UP THE REMOTE CONTROL

1. Use a phillips screwdriver to open the battery cover.
2. Install 3x new AAA batteries taking care to match the correct polarity (+/-).
3. Close the cover and reinstall the screw.

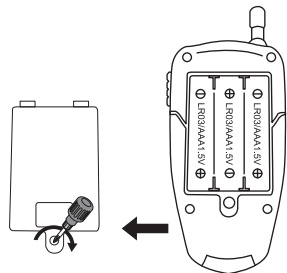

THE WALKIE TALKIE ROBOT REMOTE

- For best results the Walkie Talkie Robot needs to be within a 15' foot range of the controller.



Direction Controls

Move the robot forward / reverse / left / right

Push to Talk (Walkie Talkie)

Press this button and speak into the controller to hear your voice from the robot's speaker.

Select Sound Effects

Use the slide control to select one of three programmed sound effects - cheer / ghost / fart.

Play Sound Effect

Press to play the selected sound effect.

Demo

Press this button to put the robot in demo mode and show off its features.

Select Voice Effects

Use the slide control to change the voice pitch effect used when pressing the push to talk button. Select from low pitched voice, normal and high pitched voice.

Programming Mode

Use this button to pre-program the robots movement.

Step 1 - Press this button once to enter programming mode. The robots eyes will flash and the robot will beep.

Step 2 - Press the direction controls in the order you want the robot to move.

Step 3 - Press the programming button again. The robot will automatically move following the programmed instructions.

Spy Mode

Press this button to listen in on sounds from the robot's location.

On/Off

Turns the robot remote On & Off.

Walkie Talkie Robot Movement

Forward



Reverse



Turn Left



Turn Right



CARE & MAINTENANCE

- Do not submerge the unit in any liquids.
- Keep the unit dry.
- Do not place the unit near powerful, un-shielded magnets.
- Do not expose the unit to extreme hot or cold temperatures.
- Do not hit, drop, or smash the unit with extreme force.
- Do not disassemble the unit for any reason.

NOT FOLLOWING THESE PRECAUTIONS WILL VOID YOUR WARRANTY.



For Customer Service please email:
Care@OdysseyToys.com

Please note the units model number and name in your email:
Model no. ODY-1208 • Walkie Talkie Robot

www.odysseytoys.com/support
1-(305)-933-4480

CAUTIONS & WARNINGS

- Suitable for ages 8 and up. Adult supervision is always recommended.
- This product contains small parts which are a choking hazard. Keep away from small children.
- Manufacturers and dealers disclaim all responsibility for damage caused by misuse.
- Keep hair and loose clothing away from the Walkie Talkie Robot when powered on.
- If Walkie Talkie Robot will be stored and unused for an extended period of time, please remove the batteries.
- Check the batteries regularly for potential leakage or corrosion that may occur.
- When installing the batteries carefully follow the polarity marking +/-.
- Do not mix different battery types.
- Remove exhausted or drained batteries.

60 DAY LIMITED WARRANTY

Odyssey Marketing/ Odyssey Toys warrants to the original purchaser when used in the United States only, that this product shall be free of defects in material and workmanship. This warranty applies within 60 days of the original purchase date with normal home use. This warranty does not apply for commercial use of this product. Use outside of United States is not covered by this warranty. During the warranty period, we will at our discretion, repair or replace this product without charge, as long as the product has not been abused or mishandled as by our determination. Our determination shall be final and be the consumer's sole remedy. ALL RETURNS must be accompanied by a Return Authorization Number which is issued by Odyssey Marketing's Customer Service Department.

Please contact Customer Service BEFORE returning any products or parts thereof. Once you have obtained a Return Authorization Number you will be provided a return address within the Customer Service email.

This warranty does not cover installation, adjustments in the home, nor damage due to accidents, misuse, abuse, fire, or any acts of God, incorrect line voltage, damage to other equipment caused by improper installation, unauthorized or improper modifications. This warranty gives you specific legal rights and you may also have other rights that vary from state to state.

**** THIS WARRANTY IS EXPRESSLY IN LIEU OF ALL OTHER WARRANTIES. EXPRESSED OR IMPLIED INCLUDING THE WARRANTIES OF MERCHANTABILITY AND FITNESS.**** ©2020 Odyssey Marketing Corp.

FCC STATEMENT: This product complies with Part 15 of the FCC Rules. Operation is subject to the following two conditions: (1) This device may not cause harmful interference and (2) this device must accept any interference receiver, including interference that may cause undesirable operation.

MADE IN CHINA

