

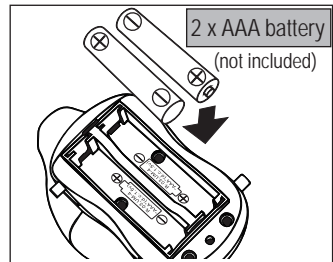

## INSTALLING YOUR TINY MOVER'S BATTERIES

1. Locate the battery compartment on the base of your Tiny Mover.
2. Using a phillips screwdriver remove the screw securing the cover and open.
3. Install 2xAAA batteries taking care to match the correct polarity (+/-).
4. Replace the battery cover and reinstall the screw.



## USING YOUR TINY MOVER



### Moving Forward

Tilt your Tiny Mover's head down.



### Standing Still

Tilt your Tiny Mover's head into the middle position.



### Moving Backwards

Tilt your Tiny Mover's head up.

- ★ Tip. Your Tiny Mover does not have a power switch. When finished playing to stop moving make sure the Tiny Mover's head is in the middle position. If you will not be using the Tiny Mover for some time remove the batteries.

## COLLECT ALL THREE TINY MOVERS!

