

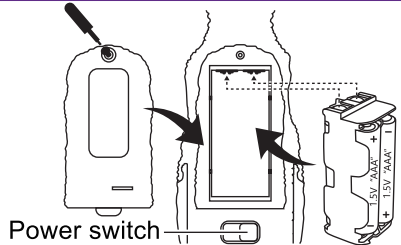

INSTALLING THE RAPID RAPTOR'S BATTERIES

1. Locate the battery compartment on the base of your Rapid Raptor.
2. Using a phillips screwdriver remove the screw securing the cover and open.
3. Install 4xAAA batteries into the battery holder taking care to match the correct polarity (+/-).
4. Replace the battery holder, install the cover and replace the screw.



Uses 4x1.5V AAA non-rechargeable batterie (==) (NOT INCLUDED)

INSTALLING THE RAPID RAPTOR'S REMOTE BATTERIES

1. Locate the battery compartment on the back of the remote.
2. Using a phillips screwdriver remove the screw securing the cover and open.
3. Install 2xAAA batteries taking care to match the correct polarity (+/-).
4. Replace the cover and install the screw.

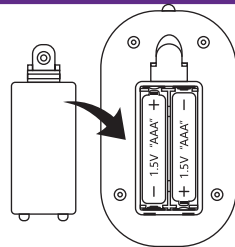

Uses 2x1.5V AAA non-rechargeable batteries (NOT INCLUDED)

USING YOUR RAPID RAPTOR'S REMOTE



- ★ Tip. 1 The Rapid Raptor uses an Infra Red remote. Make sure the you are pointing the remote towards the Raptor for reliable control.
- ★ Tip. 2 Press the sound button to hear the roar of six different dinosaurs. (Tyrannosaurus Rex, Pterosaurus, Trceratops, Idominum Rex, Spinosaurus & Velociraptor).



For Customer Service please email:
Care@OdysseyToys.com

Please note the units model number and name in your email:
Model no. ODY-605• Rapid Raptor

For questions or assistance on installation, parts or
operation contact: Odyssey Toys at 1-(305)-933-4480.
Hours of operation: 10:00am - 5:00pm EST
Email: Care@OdysseyToys.com
or visit us online at: www.odysseytoys.com/support

CAUTIONS & WARNINGS

- Suitable for ages 6 and up. Adult supervision is always recommended.
- This product contains small parts which are a choking hazard. Keep away from small children.
- Manufacturers and dealers disclaim all responsibility for damage caused by misuse.
- Keep hair and loose clothing away when powered on.
- If product will be stored and unused for an extended period of time, please remove the batteries.
- Check the batteries regularly for potential leakage or corrosion that may occur.
- When installing the batteries carefully follow the polarity marking +/-.
- Do not mix different battery types.
- Remove exhausted or drained batteries.

CARE & MAINTENANCE

- Do not submerge the unit in any liquids.
- Keep the unit dry.
- Do not place the unit near powerful, un-shielded magnets.
- Do not expose the unit to extreme hot or cold temperatures.
- Do not hit, drop, or smash the unit with extreme force.
- Do not disassemble the unit for any reason.

NOT FOLLOWING THESE PRECAUTIONS WILL VOID YOUR WARRANTY.

FCC STATEMENT: This product complies with Part 15 of the FCC Rules. Operation is subject to the following two conditions: (1) This device may not cause harmful interference and (2) this device must accept any interference receiver, including interference that may cause undesirable operation.

MANUFACTURED FOR ODYSSEY TOYS
MADE IN CHINA

