

# USER MANUAL



## TAIL LIGHTS

**Model.: WJ2020-0703**

1997-2003 Ford F150 (Excluding 4-Door SuperCrew Cab Models)  
2004 Ford F150 Heritage (Excluding 4-Door SuperCrew Cab Models)  
1997-1999 Ford F-250 Light Duty (7 Lug Nut)  
1999-2007 Ford F-250/F-350/F-450/F-550 Super Duty  
Fits Styleside Models Only

**DO NOT Fit Flareside Models or Crew Cab Models**

# REQUIRED TOOLS

Ratchet

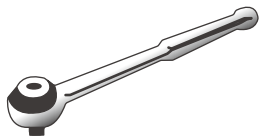

Socket



## Installation Instructions

1



2

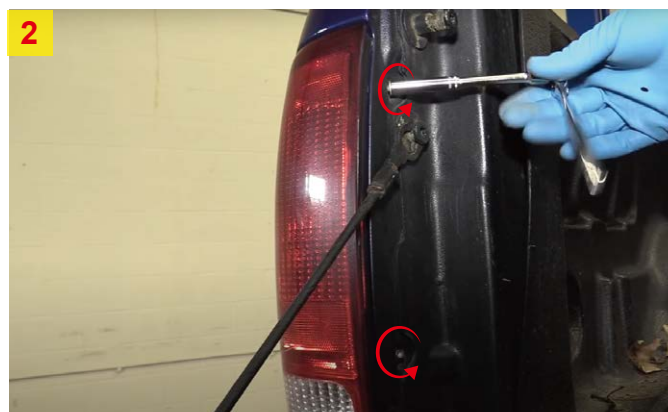

3



4

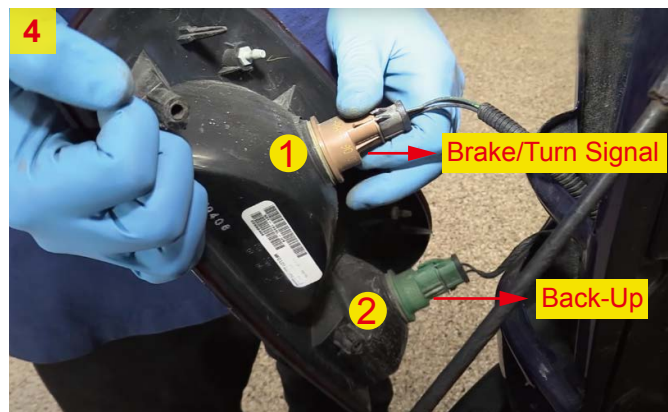

5. Disconnect all the plugs of factory.

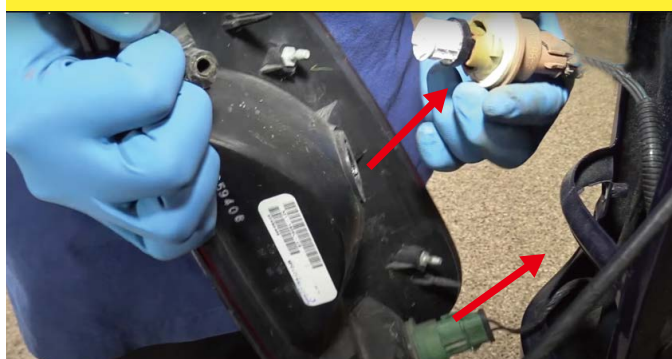

6. Pull out the bulbs.





**7. Connect the resistor.**

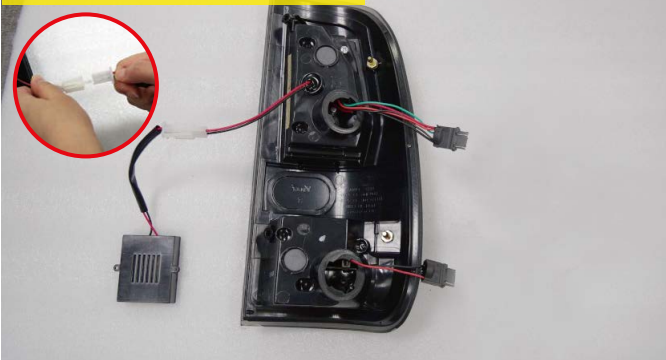

**8. Reuse the factory bulb sockets.**

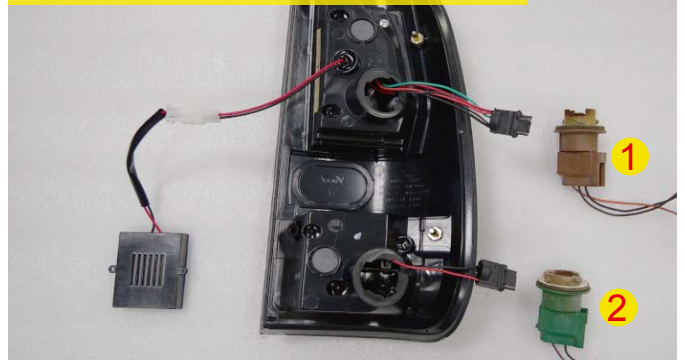

**9. Make Sure (-) is Aligned.**

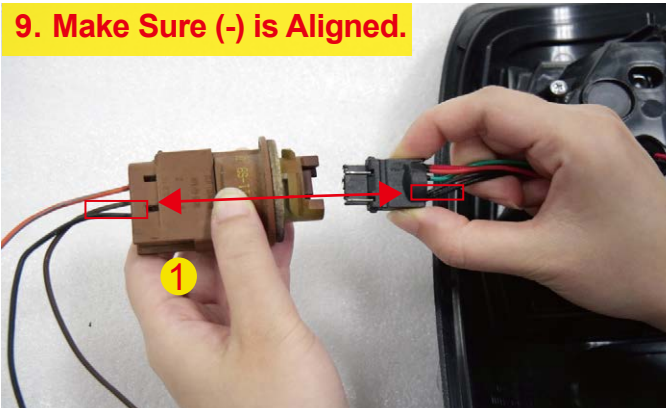

**10. Make Sure (-) is Aligned.**

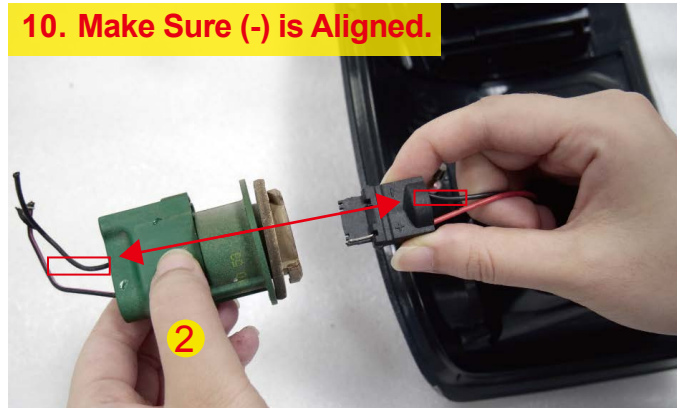

**11. Reinstall the bulb sockets.**

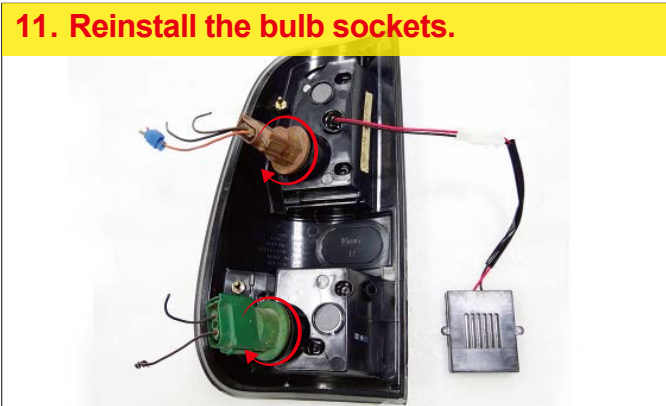

**12. Install the new tail light.**



**13**



**14. Repeat steps 2~13 for the other side.**

