

USER MANUAL

TAIL LIGHTS



Model.: WJ20-0003

Chevy Blazer 1992-1994
Chevy c1500 Pickup 1988-1999
Chevy c1500 Suburban 1992-1999
Chevy c2500 Pickup 1988-2000
Chevy c2500 Suburban 1992-1999
Chevy c3500 Pickup 1988-2000
Chevy k1500 Pickup 1988-1999
Chevy k1500 Suburban 1992-1999
Chevy k2500 Pickup 1988-2000
Chevy k2500 Suburban 1992-1999
Chevy k3500 Pickup 1988-2000
Chevy Tahoe 1995-2000
Gmc c1500 Pickup 1988-1999

Gmc c1500 Suburban 1992-1999
Gmc c2500 Pickup 1988-2000
Gmc c2500 Suburban 1992-1999
Gmc c3500 Pickup 1988-2000
Gmc k1500 Pickup 1988-1999
Gmc k1500 Suburban 1992-1999
Gmc k2500 Pickup 1988-2000
Gmc k2500 Suburban 1992-1999
Gmc k3500 1988-2000
Gmc k3500 Pickup 1998
Gmc Yukon 1992-1999
Cadillac Escalade 1999-2000

REQUIRED TOOLS

Socket



Ratchet



Flathead
Screwdriver

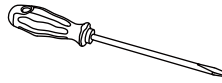

Phillips
Screwdriver

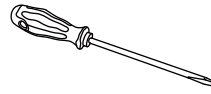

Panel
Remover

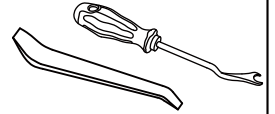

Installation Instructions

1



2. Open the tail gate and locate the two screw and remove them.



3

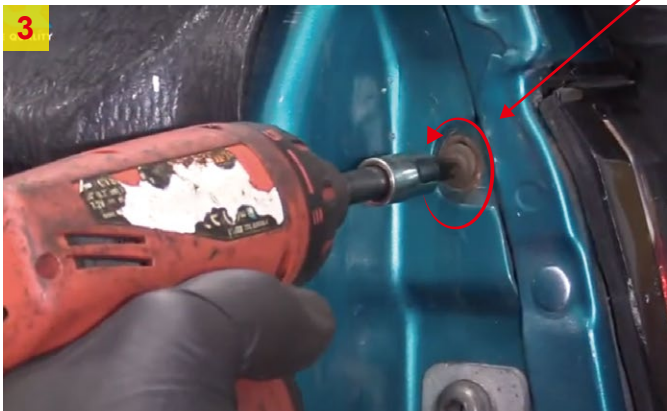

4. Pull the tail light off from the vehicle



5



6. Disconnect the plugs of original

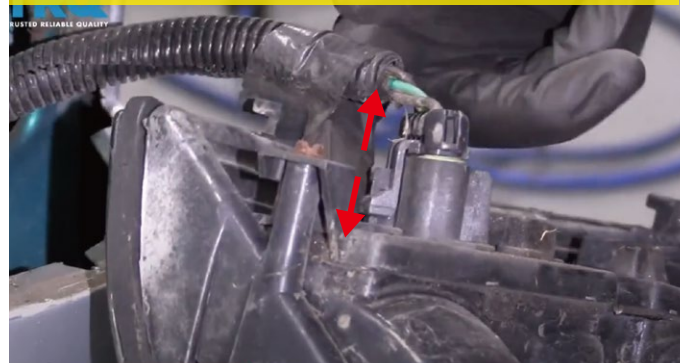

7. Take off the rear connector plate.

Original light



8. Install the rear connector plate onto the back of the new lamp.



9. Reverse the install process



10



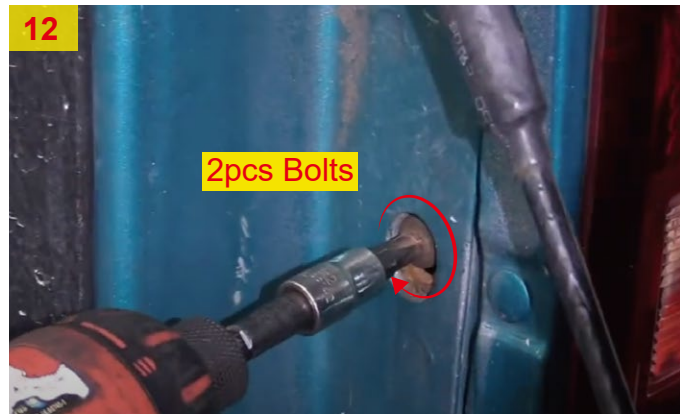

13. Repeat the steps 2~12 for the other side

14. Test all functions to make sure of proper installation before driving

