

USER MANUAL



HEADLIGHTS

Model.: WJ1020-0672

18-20 Ford F-150

REQUIRED TOOLS

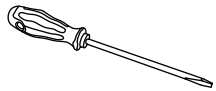
Socket 	Ratchet 	Flathead Screwdriver 	Phillips Screwdriver 	Panel Remover 
---	--	---	--	--

Installation Instructions

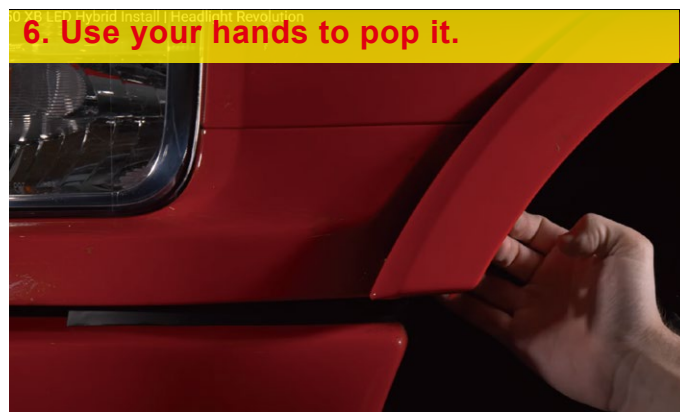
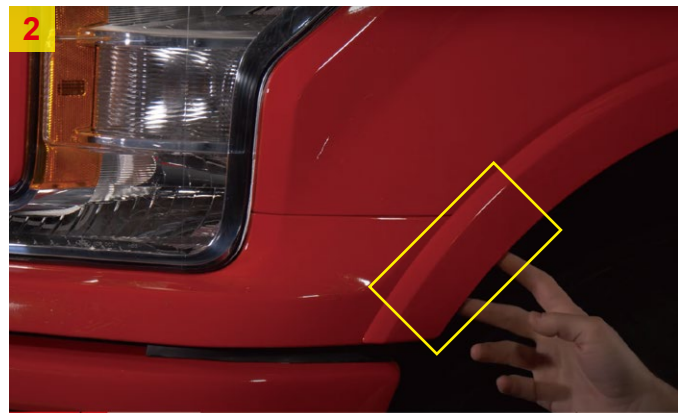

7. Remove the plastic painted piece from below the grill.



8. Two connectors in the center you need to remove



9. Remove the four ten millimeter bolts.



10. Pull the grill toward you.

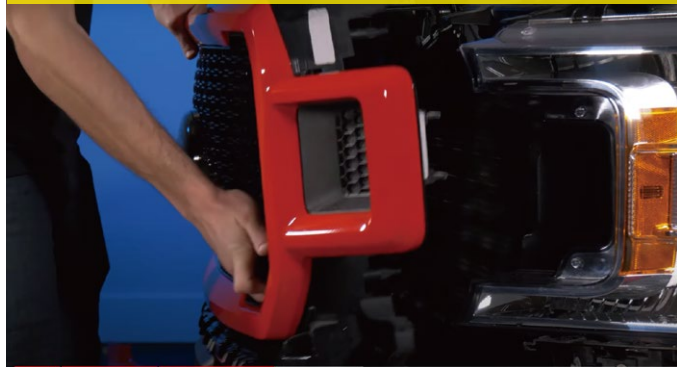

11. Remove the single eight millimeter bolt from the front, the rest of the bolts are ten millimeter.



12. Remove two bolts on the top of the headlight.

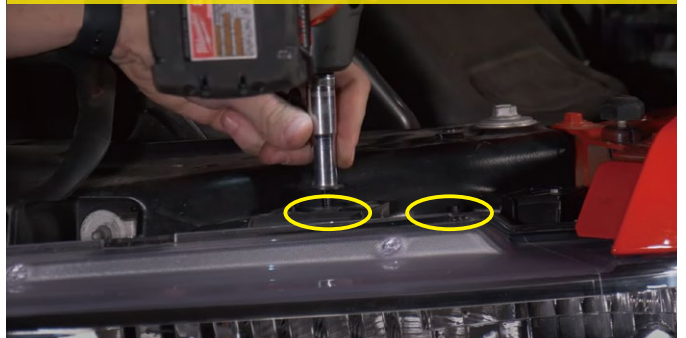

13. Pull the headlight toward you and away from the vehicle.



14. Remove the high beam bulb, low beam bulb and side marker bulb, take them onto the new headlight.





15. Test all functions before driving.

