

USER MANUAL

HEADLIGHTS

2016-2023 toyota tacoma with factory halogen type headlights model
2016-2023 toyota tacoma with factory DRL headlights model
(For factory LED headlight model, need wiring adapters)

Model.: WJ10-0713



W/O DRL
Page3



W/ DRL
Page4

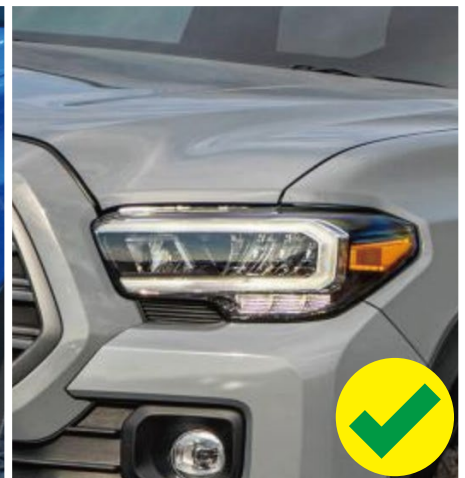

LED
Page5

REQUIRED TOOLS

Socket

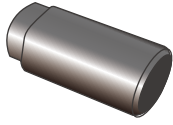

Ratchet



Panel Remover

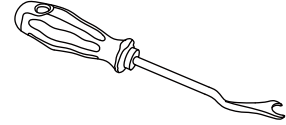

Installation Instructions

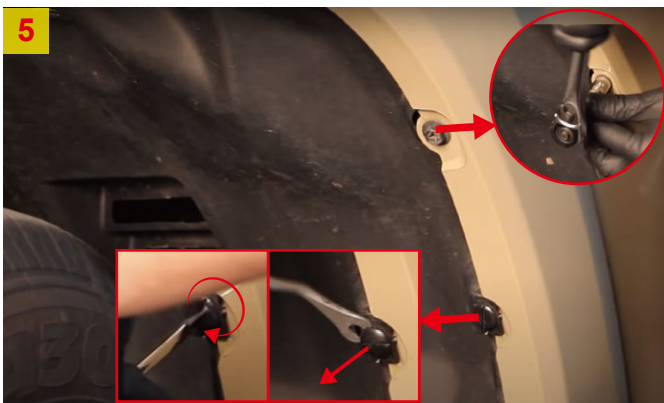
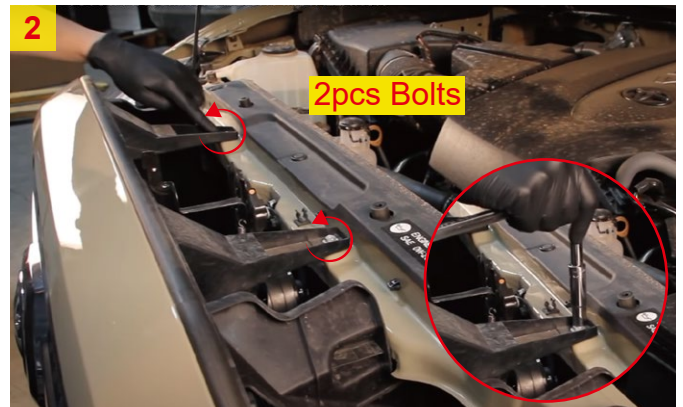

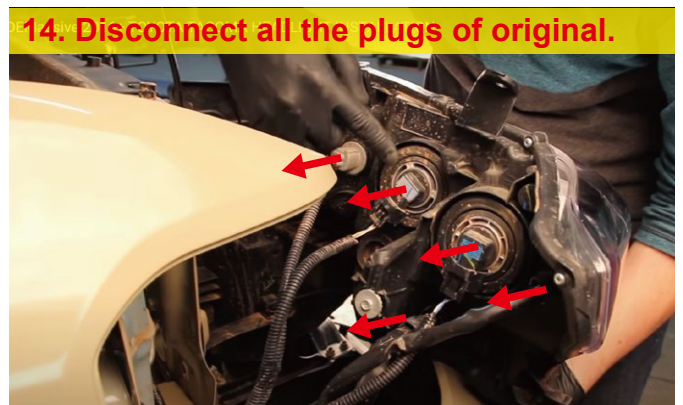
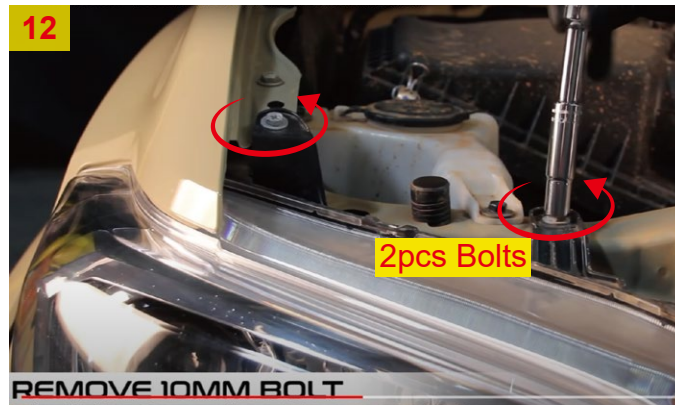
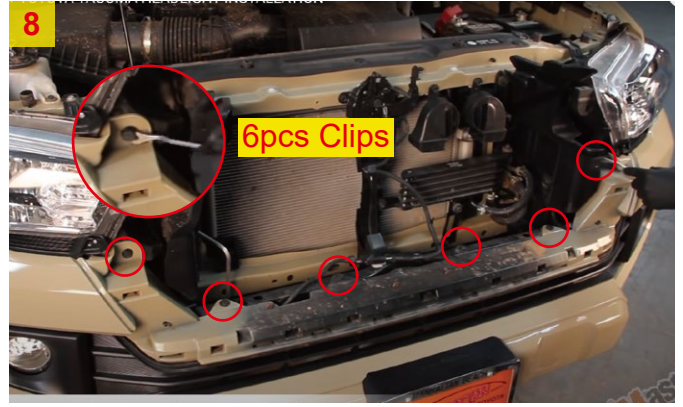

Model with factory headlights w/o DRL

Use the side marker from original light and put it into the new headlight.

original light

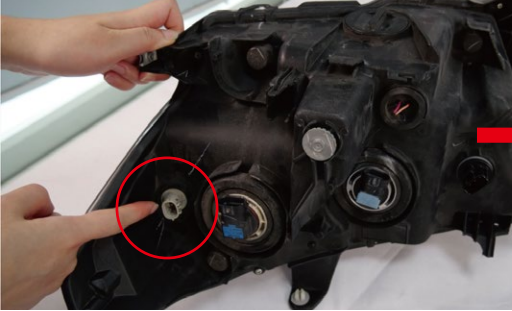

new light

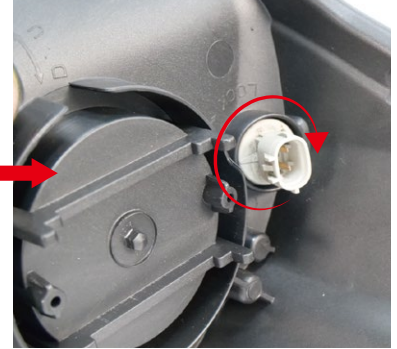

new light

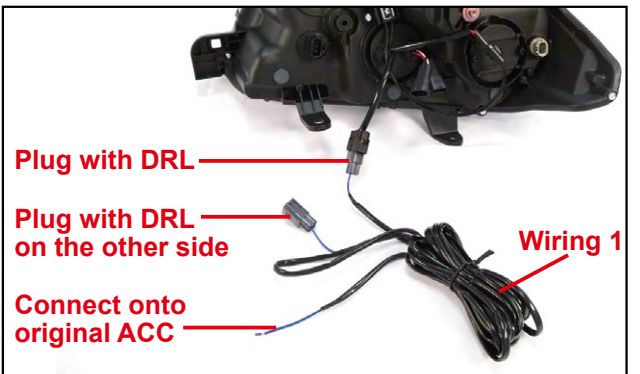

Pull out the black socket of Wiring 2, install it on the signal wire of the new headlight.

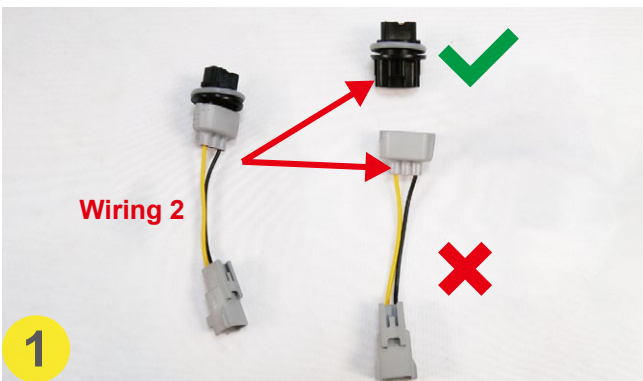

Model with factory headlights w/ DRL

Use the side marker from original light and put it into the new headlight

original light

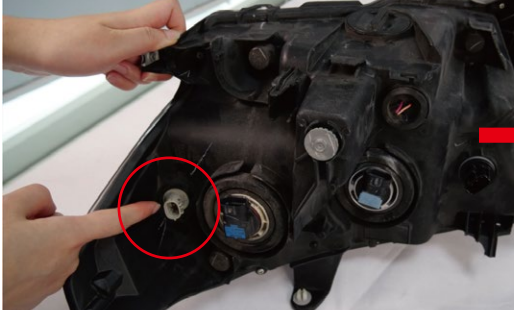

new light

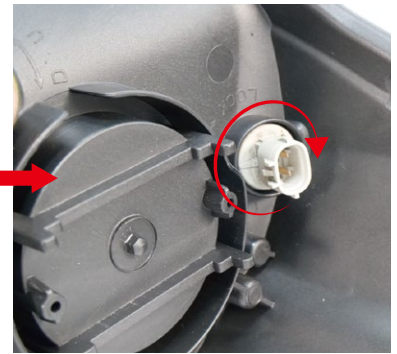

new light



Connect the Wiring 2 to the turn signal wire of the new headlight

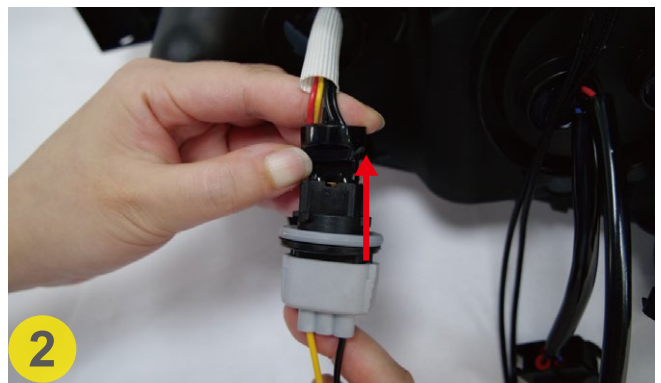
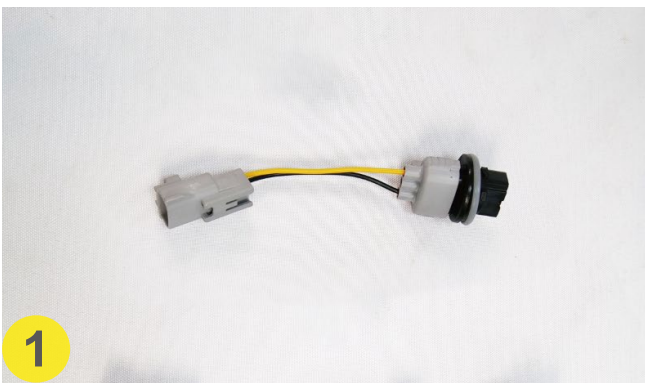

Model with factory LED headlights

For LED type, please use our wiring adapters(NOT INCLUDED).

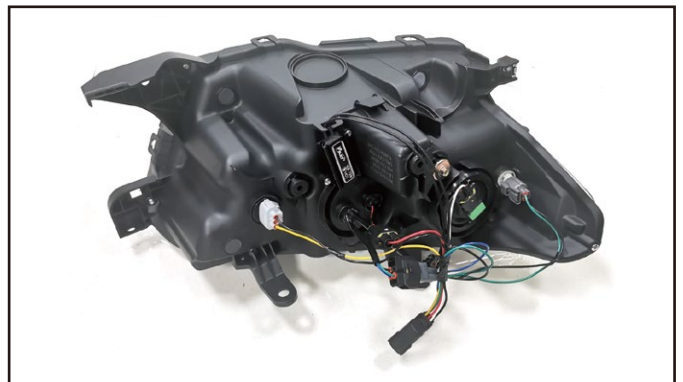
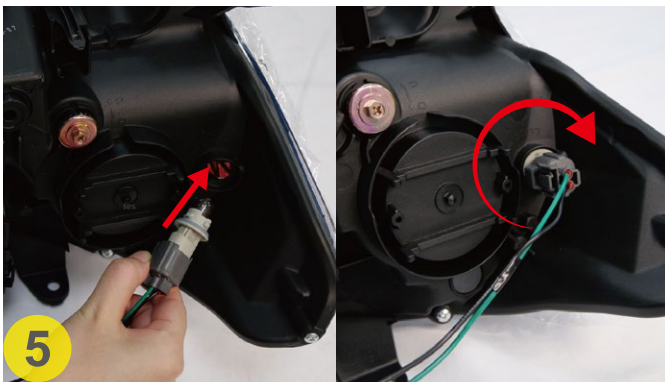
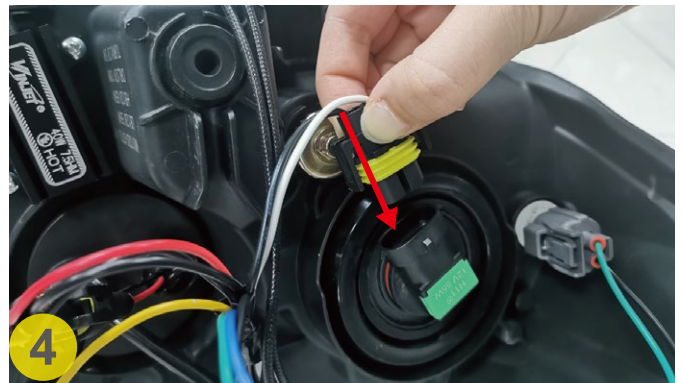
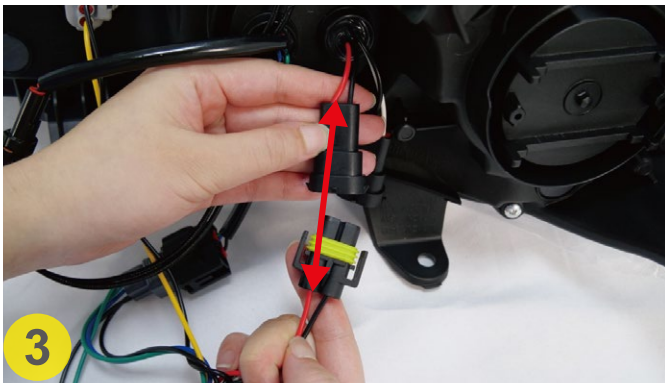
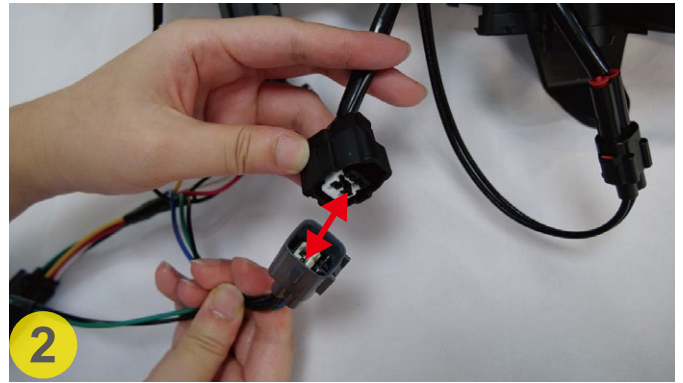
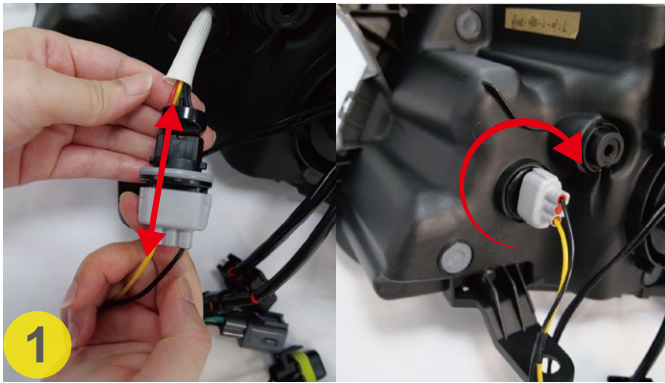

16. Connect all the plugs.

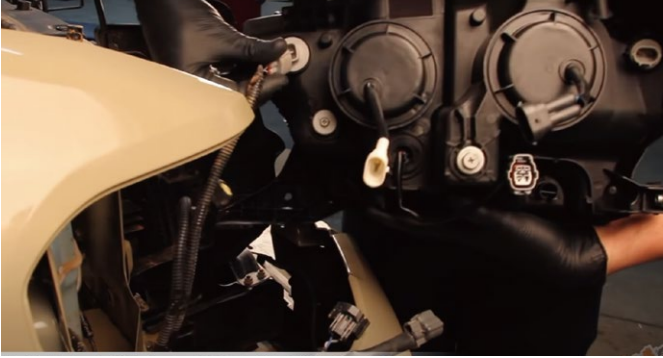

17



18

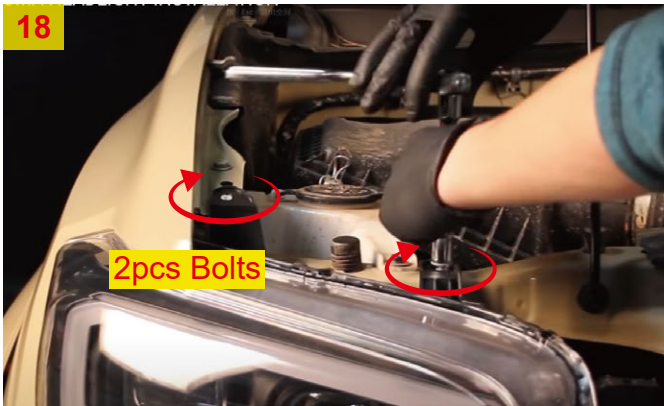

19. Repeat the steps 2~18 for the other side.
20. Reinstall the original removed parts and bolts.

Adjustment steps

Use 10mm wrench socket.



Locate the adjustment
Screw



Same steps for the other side.

Clockwise= UP
Counterclockwise= DOWN

